

ROUTE NO.	SECTION	COUNTY	TOTAL SHEETS	SHEET NO.
T.R. 205	03-01123-00-BR	SHELBY	13	13
ROAD DIST.	ILLINOIS ASH GROVE		CONTRACT NO. 91335	

DESCRIPTION OF INTENDED SEQUENCE OF MAJOR CONSTRUCTION ACTIVITIES WHICH WILL DISTURB EARTH AND LEAD TO POSSIBLE EROSION FOR MAJOR PORTIONS OF THE CONSTRUCTION SITE:

1. PLACEMENT OF PERIMETER EROSION CONTROL FENCE PRIOR TO THE COMMENCEMENT OF ANY ROAD OR BRIDGE WORK. SEE STD. 280001.
2. REMOVAL OF EXISTING STRUCTURE.
3. CONSTRUCTION OF THE REPLACEMENT STRUCTURE.
4. PLACEMENT OF ROADWAY EMBANKMENT TO RAISE THE ROADWAY TO THE PROPOSED GRADE.
5. DRAINAGE STRUCTURES, INCLUDING DITCHES, WILL BE INSTALLED BEFORE AND/OR DURING THE COMPLETION OF THE EMBANKMENT.
6. PLACEMENT AND MAINTENANCE OF TEMPORARY EROSION CONTROL.
7. PLACEMENT OF PERMANENT EROSION CONTROL.
8. REMOVAL AND PROPER CLEAN UP OF TEMPORARY EROSION CONTROL.
9. FINAL GRADING, PLACING AGGREGATE AND OTHER MISCELLANEOUS ITEMS.

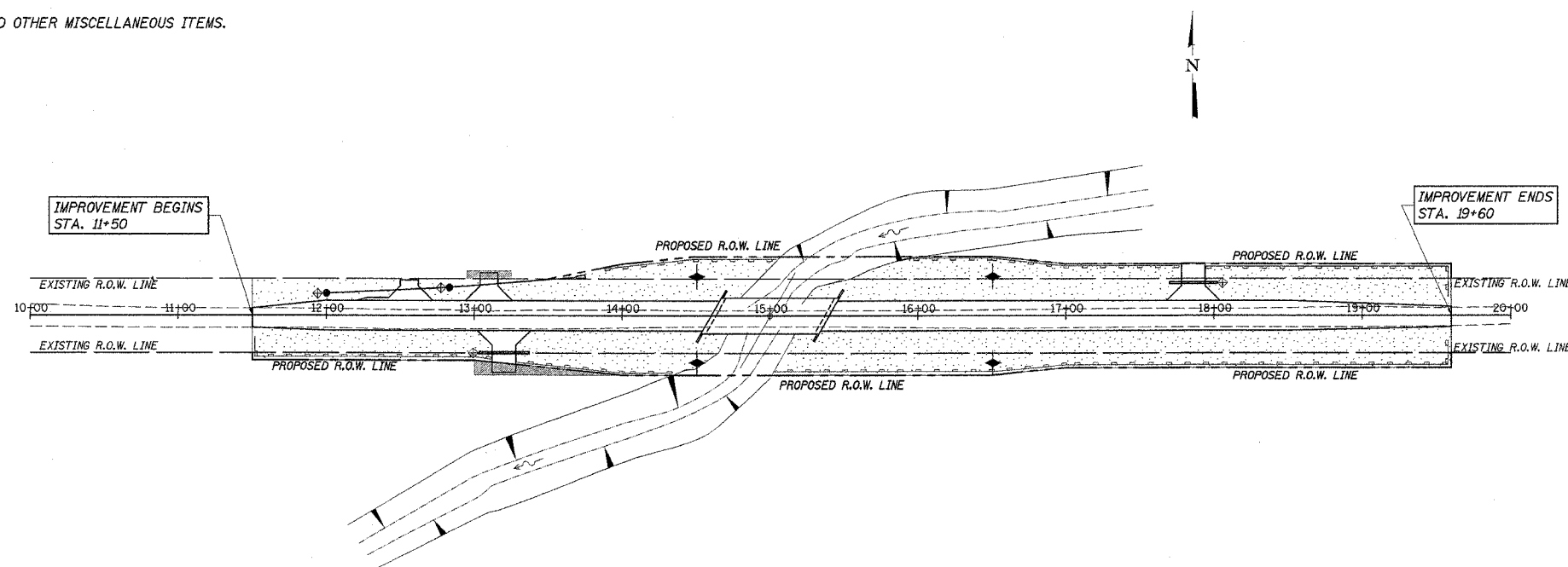

<u>TEMPORARY EROSION CONTROL:</u>	
---	PERIMETER EROSION BARRIER
◆	TEMPORARY DITCH CHECK
◇	INLET & PIPE PROTECTION
<u>PERMANENT EROSION CONTROL:</u>	
■	SEEDING CLASS 2, FERTILIZERS, & MULCH, METHOD 2

TEMPORARY DITCH CHECKS

LT. & RT. STA. 14+25 = 2 EACH
 LT. & RT. STA. 16+50 = 2 EACH
 TOTAL = 4 EACH

INLET & PIPE PROTECTION

LT. STA. 11+98 = 1 EACH
 LT. STA. 12+80 = 1
 RT. STA. 13+00 = 1
 LT. STA. 18+05 = 1
 TOTAL = 4 EACH

BILL OF MATERIAL

ITEM	UNIT	QUANTITY
TEMPORARY EROSION CONTROL SEEDINGS	POUND	300
TEMPORARY DITCH CHECKS	EACH	4
PERIMETER EROSION BARRIER	FOOT	1075
INLET & PIPE PROTECTION	EACH	4

THE ABOVE QUANTITIES ARE ESTIMATES ONLY. ACTUAL QUANTITIES FOR EROSION CONTROL WILL BE DETERMINED BY THE ENGINEER IN THE FIELD AND THERE WILL BE NO ADJUSTMENT IN ANY PRICE DUE TO A CHANGE IN PLAN QUANTITY.

EROSION CONTROL PLAN

SECTION 03-01123-00-BR
 ASH GROVE ROAD DISTRICT
 SHELBY COUNTY
 STATION 15+00

4440 ASH GROVE
 SPRINGFIELD, IL 62711
 (217) 793-8600
 oasino@samvid.com

OZYURT AND STONE, INC.
 CONSULTING ENGINEERS

JOB NO.: 0322
 FILE: 0322ECP.DGN
 DATE: 07/12/05