

| | | | | |
|---------------------|----------------|----------|------------------|-----------|
| FAU. RTE. | SECTION | COUNTY | TOTAL SHEETS | SHEET NO. |
| | 03-P4045-01-BT | COOK | 080 | 019 |
| STA. | | TO STA. | | |
| FED. ROAD DIST. NO. | | ILLINOIS | FED. AID PROJECT | |

CONTRACT NO. 83811

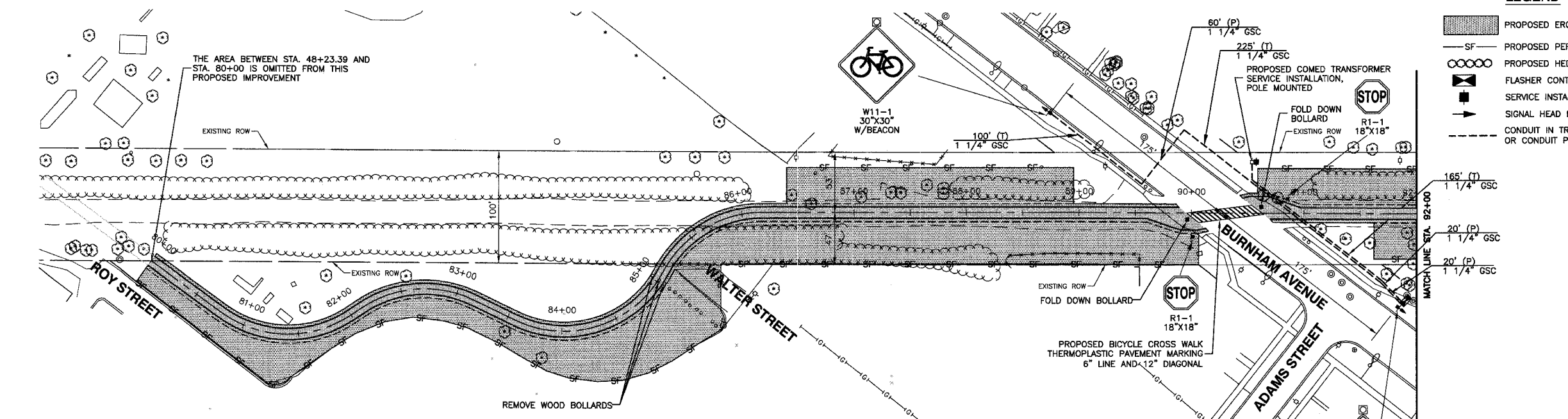
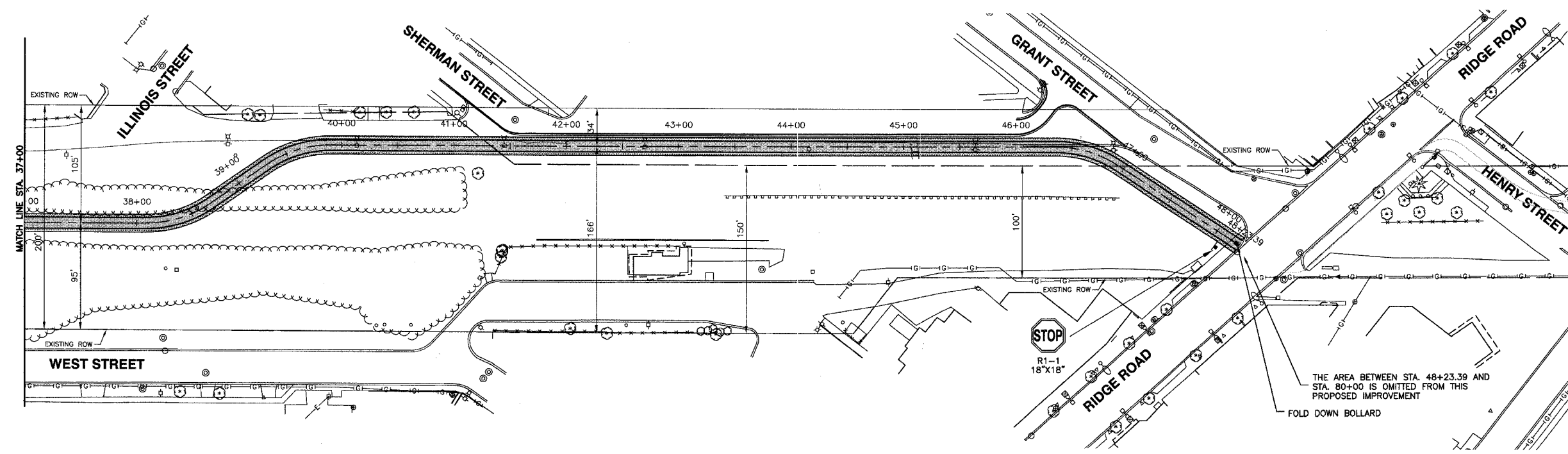

- LEGEND**
- PROPOSED EROSION CONTROL BLANKET
 - PROPOSED PERIMETER EROSION BARRIER
 - PROPOSED HEDGE LINE
 - FLASHER CONTROLLER
 - SERVICE INSTALLATION, POLE MOUNTED
 - SIGNAL HEAD BEACON
 - CONDUIT IN TRENCH, 1 1/4" DIA. GALVANIZED STEEL (T) OR CONDUIT PUSHED, 1 1/4" DIA. GALVANIZED STEEL (P)

THE AREA BETWEEN STA. 48+23.39 AND STA. 80+00 IS OMITTED FROM THIS PROPOSED IMPROVEMENT

THE AREA BETWEEN STA. 48+23.39 AND STA. 80+00 IS OMITTED FROM THIS PROPOSED IMPROVEMENT

ROBINSON ENGINEERING, LTD.
CONSULTING REGISTERED PROFESSIONAL ENGINEERS
AND PROFESSIONAL LAND SURVEYORS
17000 SOUTH PARK AVENUE SOUTH HOLLAND, ILLINOIS 60473
(708) 331-6700 FAX (708) 331-3828
© COPYRIGHT 2005 ILLINOIS DESIGN FIRM REGISTRATION NO. 184001128

SIGNAGE AND EROSION CONTROL PLAN
PENNSY GREENWAY BIKE PATH
STA. 37+00 TO STA. 92+00

| | |
|--------------------|-----------------------|
| Drawn by: LTL | Date: 7/22/05 |
| Checked by: JN/JCP | Scale: 1"=50' |
| Sheet 019 of 080 | Project No. 03-365.02 |