

FAU. NO.	SECTION	COUNTY	TOTAL SHEETS	SHEET NO.
03-P4045-01-BT	COOK	080	012	
STA.		TO STA.		
FED. ROAD DIST. NO.	ILLINOIS	FED. AID PROJECT		

**CONTRACT NO. 83811**

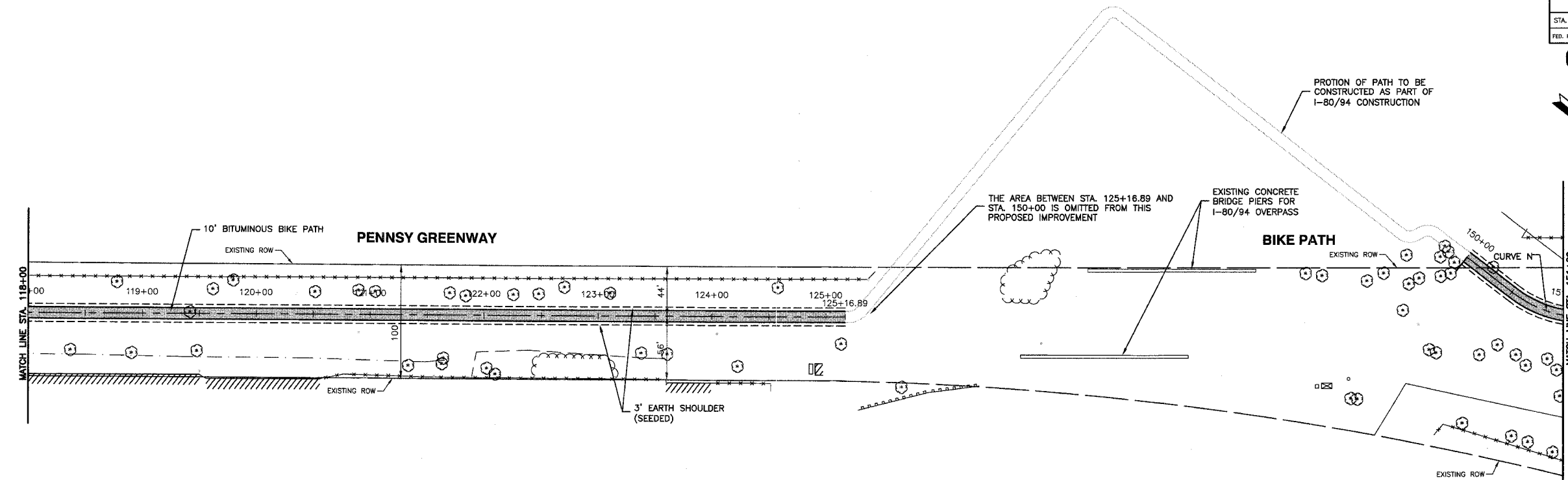

**CURVE N**  
 PC = STA. 150+51.73  
 PT = STA. 151+17.86  
 R = 100'  
 L = 66'

**LEGEND**

- EXISTING DITCH &
- EXISTING TOP OF BANK
- EXISTING FENCE
- EXISTING BUSH / HEDGE LINE
- EXISTING TREE LINE
- EXISTING RIGHT OF WAY
- PROPOSED BIKE PATH CENTERLINE
- 3' EARTH SHOULDER (SEEDED)
- PROPOSED BIT. BIKE PATH

**BENCH MARK: 213**  
 CROSS CUT ON TRAFFIC SIGNAL BASE @ S.W. CORNER 185TH ST. & WENTWORTH AVE.  
 ELEVATION=615.48

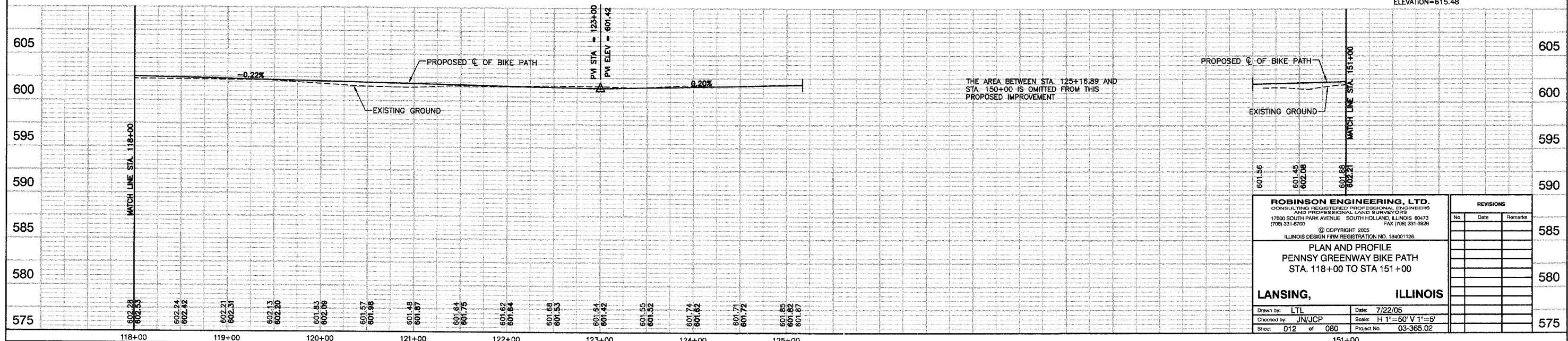

**ROBINSON ENGINEERING, LTD.**  
 CONSULTING REGISTERED PROFESSIONAL ENGINEERS  
 AND PROFESSIONAL LAND SURVEYORS  
 17000 SOUTH PARK AVENUE, SOUTH HOLLAND, ILLINOIS 60473  
 (708) 331-6700 FAX (708) 331-3826  
 © COPYRIGHT 2005  
 ILLINOIS DESIGN FIRM REGISTRATION NO. 184001128

**PLAN AND PROFILE**  
**PENNSY GREENWAY BIKE PATH**  
 STA. 118+00 TO STA 151+00

**LANSING, ILLINOIS**

Drawn by: LTL Date: 7/22/05  
 Checked by: JN/JCP Scale: H 1"=50' V 1"=5'  
 Sheet 012 of 080 Project No. 03-365.02

REVISIONS		
No.	Date	Remarks