

STATE OF ILLINOIS
DEPARTMENT OF TRANSPORTATION

**PLANS FOR PROPOSED
LOCAL AGENCY PAVEMENT PRESERVATION PROJECT
(FAU 2830) MONEE ROAD RESURFACING
WILL COUNTY LIMITS TO WESTERN AVENUE
MFT SECTION: 02-00086-00-RS
PROJECT NO.: M-8003(525)
JOB NO.: C-91-286-05
VILLAGE OF PARK FOREST
COOK COUNTY**

FAU ROUTE NO.	SECTION	COUNTY	TOTAL SHEETS	SHEET NO.
2830	*	COOK	10	1

ILLINOIS PROJECT: M-8003 (525)
CONTRACT NO.: 83809

* 02-00086-00-RS



INDEX OF SHEETS

SHEET NO.	TITLE
1	COVER SHEET
2	SUMMARY OF QUANTITIES, TYPICAL SECTIONS, LEGEND & GENERAL NOTES
3	SCHEDULE OF QUANTITIES
4	MONEE ROAD PLAN SHEET: STA. 11+42.89 TO 20+50
5	MONEE ROAD PLAN SHEET: STA. 20+50 TO 30+46.07
6	IDOT DISTRICT ONE TYPICAL PAVEMENT MARKINGS
7	IDOT PAVEMENT MARKING LETTERS & SYMBOLS FOR TRAFFIC STAGING
8	IDOT BUTT JOINT & BITUMINOUS TAPER DETAILS
9	IDOT TRAFFIC CONTROL & PROTECTION FOR SIDE ROADS, INTERSECTIONS AND DRIVEWAYS
10	IDOT TRAFFIC CONTROL & PROTECTION AT TURN BAYS (TO REMAIN OPEN TO TRAFFIC)

STANDARD NO.

000001-04	STANDARD SYMBOLS, ABBREVIATIONS AND PATTERNS
442201-01	CLASS C AND D PATCHES
701501-03	URBAN LANE CLOSURE, 2L, 2W UNDIVIDED
702001-05	TRAFFIC CONTROL DEVICES
780001-01	TYPICAL PAVEMENT MARKINGS

TRAFFIC DATA

ADT: 2400 (2002)
SPEED LIMIT = 35 MPH

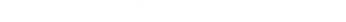
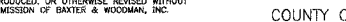
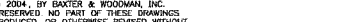
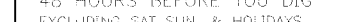
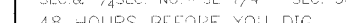
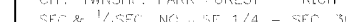
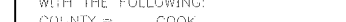
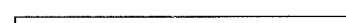
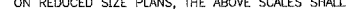
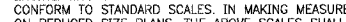
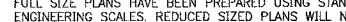
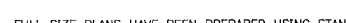
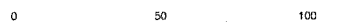
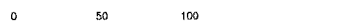
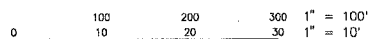

PROJECT LOCATION MONEE ROAD BEGIN RESURFACING: STA. 11+42.89

PROJECT LOCATION MONEE ROAD END RESURFACING: STA. 30+46.07

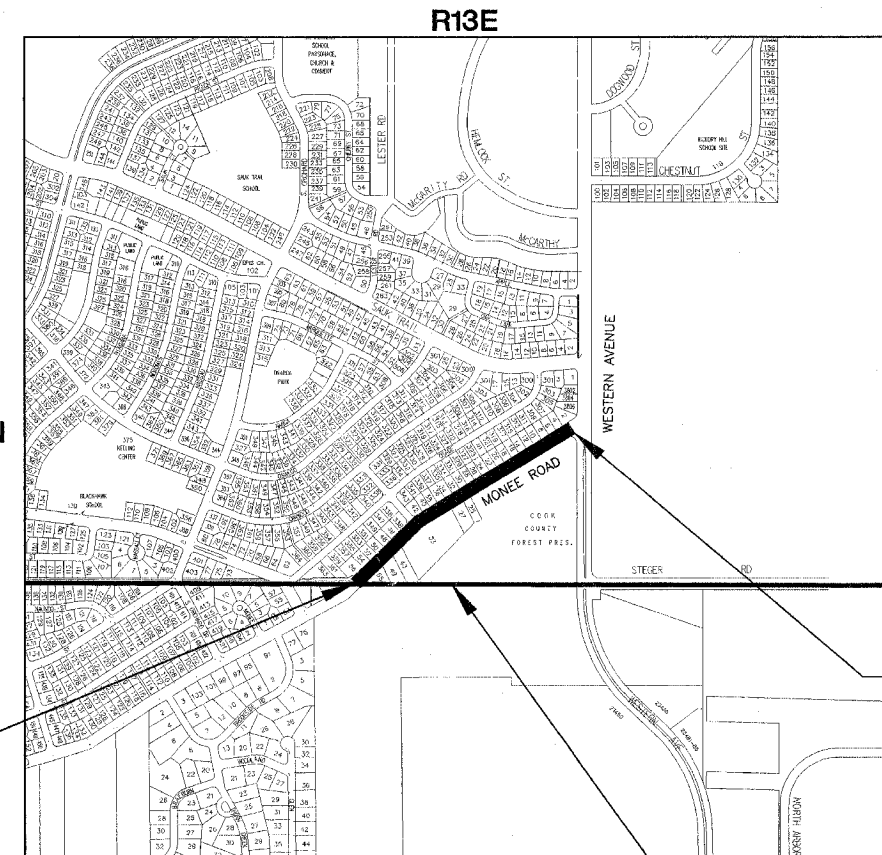

LOCATION MAP

GROSS & NET LENGTH OF PROJECT = 1,903.18 LIN. FT. OR 0.360 MILES

CALL JULIE 1-800-892-0123 WITH THE FOLLOWING:
COUNTY = COOK
CITY-TOWNSHIP = PARK FOREST - RICH TOWNSHIP
SEC. & 1/4 SEC. NO. = SE 1/4 - SEC. 36
48 HOURS BEFORE YOU DIG EXCLUDING SAT., SUN. & HOLIDAYS



Baxter & Woodman

Burlington, Wisconsin 262.763.7834
Crystal Lake, Illinois 815.459.1260
DeKalb, Illinois 815.787.3111
Mokena, Illinois 708.478.2090
(OFFICE WHICH PREPARED PLANS)

PROJECT MANAGER
"LICENSE EXPIRES 11-30-05"

STATE OF ILLINOIS
DEPARTMENT OF TRANSPORTATION
DIVISION OF HIGHWAYS

APPROVED July 19, 2005
James J. O'Sullivan
LOCAL AGENCY REPRESENTATIVE

APPROVED 7/21 2005
John J. O'Sullivan
LOCAL AGENCY REPRESENTATIVE

APPROVED 7/21 2005
Dina O'Sullivan
DEPUTY DIRECTOR OF HIGHWAYS, REGION ENGINEER

PRINTED BY THE AUTHORITY OF THE STATE OF ILLINOIS

CONTRACT NO. 83809

COUNTY COOK SECTION: NUMBER 02-00086-00-RS

I:\PROJECTS\03106\DWG\03106400.dwg
 Plotted: 7-18-05 @ 4:44pm By: jebj
 Copyright © 2005, By: Baxter & Woodman, Inc.
 State of Illinois - Professional Design Firm
 License No. - 184-001121 - Expires 4-30-07
 FEDERAL AID PROGRAM ENGINEER: CHARLES RIDDLE, P.E.

847-705-4406 SCHAUMBURG, IL

FAU ROUTE NO.	SECTION	COUNTY	TOTAL SHEETS	SHEET NO.
2830	*	COOK	10	2

ILLINOIS PROJECT: M-8003 (S25)
CONTRACT NO.: 83809



Baxter & Woodman
Crystal Lake, Illinois 815.459.1260
Burlington, Wisconsin 262.763.7834
Mokena, Illinois 708.478.2090
DeKalb, Illinois 815.787.3111

www.barwood.com

CONSULTANTS

NO.	DATE	REVISIONS	DESCRIPTION
1	7/16/05	PER IDOT COMMENTS	
2	7/14/05	PER IDOT COMMENTS	

* REFER TO EQUIPMENT MANUFACTURER'S SHOP DRAWING

SUMMARY OF QUANTITIES

CODE NUMBER	PAY ITEM	UNIT	TOTAL QUANTITY (1000)
** Z0050800	REMOVE AND RESET RAISED PAVEMENT MARKERS	EACH	100
** 21101615	TOPSOIL FURNISH AND PLACE, 4"	SQ YD	1,269
** 25000400	NITROGEN FERTILIZER NUTRIENT	LBS	15
** 25000500	PHOSPHORUS FERTILIZER NUTRIENT	LBS	15
** 25000600	POTASSIUM FERTILIZER NUTRIENT	LBS	15
** 25200110	SODDING, SALT TOLERANT	SQ YD	1,269
25200200	SUPPLEMENTAL WATERING	UNIT	5
40600980	BITUMINOUS SURFACE REMOVAL - BUTT JOINT	SQ YD	418
40800010	BITUMINOUS MATERIALS (PRIME COAT)	GAL	596
40800030	AGGREGATE PRIME COAT	TON	12
44001700	COMBINATION CONCRETE CURB & GUTTER REMOVAL AND REPLACEMENT	FOOT	60
44201717	CLASS D PATCHES, TYPE II, 6"	SQ YD	49
44201721	CLASS D PATCHES, TYPE III, 6"	SQ YD	51
44201723	CLASS D PATCHES, TYPE IV, 6"	SQ YD	853
44300300	AREA REFLECTIVE CRACK CONTROL TREATMENT, SYSTEM A	SQ YD	5,960
48101200	AGGREGATE SHOULDER, TYPE B	TON	200
60250200	CATCH BASIN TO BE ADJUSTED	EACH	4
60255500	MANHOLES TO BE ADJUSTED	EACH	1
67100100	MOBILIZATION	LSUM	1
70102620	TRAFFIC CONTROL AND PROTECTION - STD 701501	LSUM	1
** 78000100	THERMOPLASTIC PAVEMENT MARKING - LETTERS & SYMBOLS	SQ FT	146
** 78000200	THERMOPLASTIC PAVEMENT MARKING - LINE 4"	FOOT	7,341
** 78000400	THERMOPLASTIC PAVEMENT MARKING - LINE 6"	FOOT	247
** 78000650	THERMOPLASTIC PAVEMENT MARKING - LINE 24"	FOOT	46
** 88600600	DETECTOR LOOP REPLACEMENT	FOOT	336
X0321556	SANITARY MANHOLES TO BE ADJUSTED	EACH	5
X4066765	LEVELING BINDER, (MACHINE METHOD), SUPERPAVE, N50	TON	257
X4066424	BITUMINOUS CONCRETE SURFACE COURSE, SUPERPAVE, MIX 'D' N50	TON	685
X0322551	EDGE TRIMMING	EACH	25

** INDICATE SPECIALTY ITEMS

LEGEND

EXISTING			
SA	SANITARY SEWER OR SERVICE	○ GAS	GAS SERVICE VALVE
ST	STORM SEWER OR SERVICE	---	CENTER LINE
W	WATER MAIN	---	EASEMENT
WS	WATER SERVICE	---	RIGHT OF WAY (ROW)
FM	FORCE MAIN	---	TELEPHONE CABLE
UD	PIPE UNDERDRAIN	---	TELEPHONE DUCT
PD	PIPE DRAIN	---	TELEPHONE VAULT
⊙	MANHOLE	□ TEL	TELEPHONE RISER
○	CATCH BASIN	□ TV	CABLE TELEVISION (BURIED)
□	INLET	□ CTV	CABLE T.V. RISER
□	DRYWELL	□ CTV	CABLE T.V. VAULT
▽	END SECTION	E	UNDERGROUND ELECTRICAL
⊙	FIRE HYDRANT	□ EM	ELECTRIC METER
⊙	WATER VALVE W/ BOX AND COVER	□ ET	PAD MOUNTED TRANSFORMER
□	WATER VALVE VAULT	□ EV	ELECTRIC VAULT
○	CLEANOUT	□ JB	JUNCTION BOX
○	WATER SERVICE BOX	⊙	UTILITY POLE w/ GUY ANCHOR
⊙	WATER METER	⊙	UTILITY POLE w/ LIGHT
⊙	TO BE ABANDONED AND/OR REMOVED	⊙	LIGHT STANDARD
○	GAS LINE	⊙	MAIL BOX
○	GAS VALVE W/ BOX AND COVER	⊙	TRAFFIC SIGNAL POST W/ SIGNAL HEAD
□	GAS VALVE VAULT	⊙	HANDHOLE
⊙	GAS METER	⊙	PAVEMENT CORE LOCATION
○	GAS RISER		

ABBREVIATIONS

GR	GRAVEL
CI	CAST IRON
DI	DUCTILE IRON
CL EL	CENTERLINE ELEVATION
P	POINT
G	GUTTER
C	CURB
BC	BACK OF CURB
EP	EDGE OF PAVEMENT
TF	TOP OF FRAME
TC	TOP OF CURB OR CONCRETE
CP	SURVEY CONTROL POINT
R	STRUCTURE TO BE RECONSTRUCTED
A	STRUCTURE TO BE ADJUSTED

GENERAL NOTES

THE CONTRACTOR SHALL PROTECT AND CAREFULLY PRESERVE ALL SECTION OR SUBSECTION MONUMENTS OR PROPERTY OR REFERENCE MARKERS UNTIL THE OWNER, HIS AGENT OR AN AUTHORIZED SURVEYOR HAS WITNESSED OR OTHERWISE REFERENCED THEIR LOCATIONS.

THE CONTRACTOR SHALL BE RESPONSIBLE FOR CONTACTING THE OWNERS OF ALL EXISTING UTILITIES SO THAT THE UTILITIES AND THEIR APPURTENANCES MAY BE LOCATED AND ADJUSTED OR MOVED, IF NECESSARY, PRIOR TO THE START OF CONSTRUCTION OPERATIONS. THE CONTRACTOR SHALL COOPERATE WITH ALL UTILITY OWNERS AS PROVIDED IN THE STANDARD SPECIFICATIONS.

THE CONTRACTOR SHALL BE RESPONSIBLE FOR THE PROTECTION OF ALL UNDERGROUND OR SURFACE UTILITIES EVEN THOUGH THEY MAY NOT BE SHOWN ON THE PLANS. ANY UTILITY THAT IS DAMAGED DURING CONSTRUCTION SHALL BE REPAIRED TO THE SATISFACTION OF THE ENGINEER OR THE OWNER OR REPLACED. THIS WORK SHALL BE AT THE CONTRACTOR'S EXPENSE.

ALL AGGREGATE USED ON THIS PROJECT SHALL BE CRUSHED GRAVEL OR CRUSHED STONE.

ALL SAW CUTTING SHALL BE INCLUDED IN THE UNIT COST OF THE ITEM INDICATED FOR REMOVAL.

ALL CONSTRUCTION PERSONNEL WILL BE REQUIRED TO WEAR A FLOURESCENT YELLOW / YELLOW-GREEN VEST AT ALL TIMES WHILE ON THE CONSTRUCTION SITE. COMPLIANCE WITH THIS REQUIREMENT SHALL BE INCLUDED IN THE CONTRACT.

NO STREET CLOSURES WILL BE ALLOWED.

THE CONTRACTOR SHALL REPLACE ALL STREET SIGNS AND MAIL BOXES REMOVED DURING CONSTRUCTION AS NEAR AS POSSIBLE TO THEIR ORIGINAL LOCATION OR AS DETERMINED BY THE ENGINEER. THIS WORK SHALL BE INCLUDED IN THE CONTRACT.

ALL OPEN HOLES, BROKEN PAVEMENT AND TRENCHES RESULTING FROM STRUCTURE ADJUSTMENTS, CURB REPAIRS OR STORM SEWER WORK SHALL BE BACKFILLED TO GRADE BY THE END OF THE DAY.

BEFORE STARTING ANY EXCAVATION, THE CONTRACTOR SHALL CALL "JULIE" AT 800-892-0123 FOR FIELD LOCATIONS OF BURIED ELECTRIC, TELEPHONE AND GAS FACILITIES. (48 HOURS NOTIFICATION IS REQUIRED)

10 FEET TRANSITIONS SHALL BE USED TO MATCH PROPOSED CURB AND GUTTER AND MEDIAN ITEMS OF WORK TO EXISTING CURB & GUTTERS AND MEDIANS IN THE FIELD, UNLESS OTHERWISE SHOWN. THE TRANSITIONS SHALL BE PAID FOR AT THE CONTRACT UNIT PRICE FOR THE PROPOSED ITEMS OF WORK SPECIFIED.

THE CONTRACTOR SHALL COORDINATE CONSTRUCTION ACTIVITIES WITH THE UTILITY COMPANIES AND THE VILLAGE OF PARK FOREST ENGINEER, BAXTER & WOODMAN, INC.

BARRICADES: THE CONTRACTOR SHALL PROVIDE AND INSTALL TWO (2) WEIGHTED SANDBAGS ON EACH TYPE I OR TYPE II BARRICADE USED - ONE (1) WEIGHTED SANDBAG ACROSS EACH BOTTOM RAIL.

WHEN MILLED PAVEMENT IS OPEN TO TRAFFIC, THE MAXIMUM GRADE DIFFERENTIAL BETWEEN PASSES OF THE MILLING MACHINE SHALL NOT EXCEED 1 1/2 INCHES WHERE THE SPEED LIMIT IS 45 MPH OR LESS AND 1 INCH WHERE THE SPEED LIMIT IS GREATER THAN 45 MPH.

BUTT JOINTS WILL BE INSTALLED AT THE ENDS OF ALL RESURFACING (WHERE RESURFACING MEETS EXISTING PAVEMENT), IN ACCORDANCE WITH THE "BUTT JOINT AND BITUMINOUS TAPER DETAILS" SHEET INCLUDED IN THE PLANS, UNLESS OTHERWISE SPECIFIED.

ITEM	AC TYPE	VBIDS	RAP
CLASS D PATCHES, 6"			
BIT. CONC. BINDER COURSE, SUPERPAVE, IL-19, N70	PG 64-22	4% @ 70 Gyr	15%
BIT. CONC. SURFACE COURSE, SUPERPAVE, MIX 'D' N50	PG 64-22	4% @ 50 Gyr	15%
LEVELING BINDER (MACHINE METHOD), SUPERPAVE N50	PG 64-22	4% @ 50 Gyr	15%

THE UNIT WEIGHT USED TO CALCULATE THEORETICAL YIELD OF ALL BITUMINOUS SURFACE MIXTURES IS 112 LBS/SQYD/IN

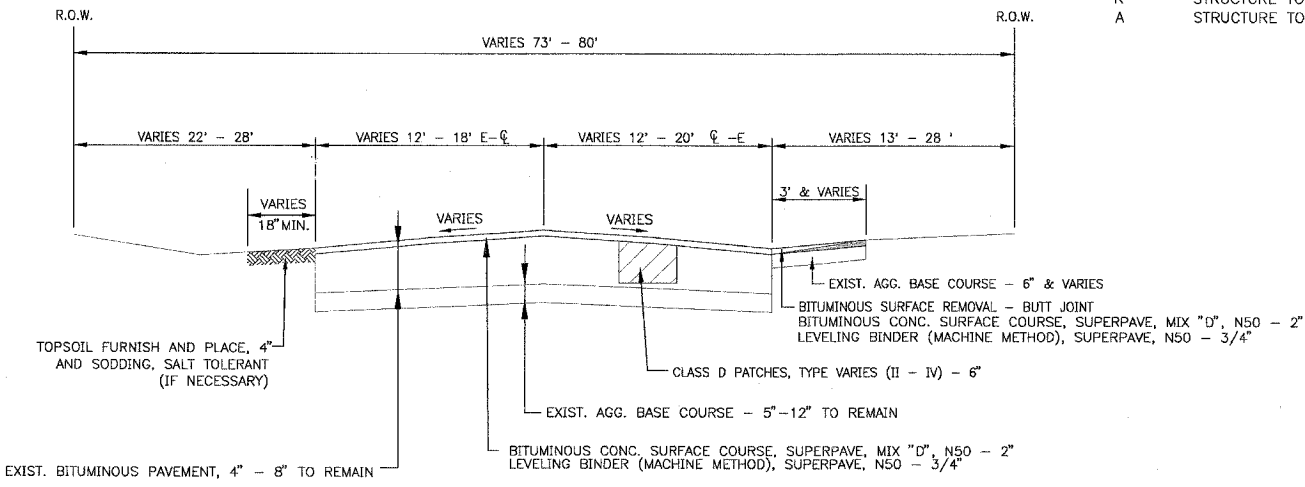

EXISTING AND PROPOSED TYPICAL SECTION

MONEE ROAD
WESTERN AVENUE TO WILL COUNTY LIMITS
(APPROX. 1900' SW)

PLAN SHEET DESIGNATION

C	COVER
G	GENERAL
H	HAZARDOUS MATERIALS
C	CIVIL
L	LANDSCAPE
S	STRUCTURAL
A	ARCHITECTURAL
I	INTERIORS
E	EQUIPMENT
P	FIRE PROTECTION
M	PLUMBING
M	MECHANICAL
E	ELECTRICAL
R	TELECOMMUNICATIONS
R	RESOURCE

PROJECT NO:	031064
DWG FILE:	031064SUM.DWG
SCALE:	AS SHOWN
DRAWING DATE:	06-17-05
DESIGNED BY:	JER / DSD
DRAWN BY:	TJB / DSD
CHECKED BY:	LDH
PLOTTED BY:	DSD 06-17-05

CLIENT

VILLAGE OF PARK FOREST ILLINOIS

(FAU 2830) MONEE ROAD STP (LAPP) PROJECT

SHEET TITLE

**SUMMARY OF QUANTITIES
TYPICAL SECTIONS,
LEGEND, AND
GENERAL NOTES**

I:\PROJECTS\031064\DWGS\031064SUM.DWG
 Plotfile: 7-18-05 @ 4:49pm By: 358jbr
 Copyright: © 2005, By Baxter & Woodman, Inc.
 State of Illinois - Professional Design Firm
 License No. - 184-001121 - Expires 4-30-07

FALL ROUTE NO.	SECTION	COUNTY	TOTAL SHEETS	SHEET NO.
2830	*	COOK	10	3
ILLINOIS PROJECT: M-8003 (525)				
CONTRACT NO.: 83809				
* 02-00086-00-RS				

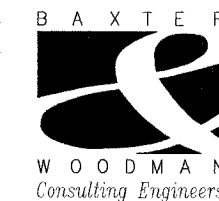

Baxter & Woodman

Crystal Lake, Illinois 815.459.1260
 Burlington, Wisconsin 262.763.7634
 Mokena, Illinois 708.478.2090
 DeKalb, Illinois 815.787.3111

www.baxwood.com

CONSULTANTS

NO.	DATE	DESCRIPTION
1	7/6/05	PER IDOT COMMENTS
2	7/14/05	PER IDOT COMMENTS
REFER TO EQUIPMENT MANUFACTURER'S SHOP DRAWING		

PLAN SHEET DESIGNATION

- G - GENERAL
- H - HAZARDOUS MATERIALS
- C - CIVIL
- L - LANDSCAPE
- S - STRUCTURAL
- A - ARCHITECTURAL
- I - INTERIORS
- D - EQUIPMENT
- F - FIRE PROTECTION
- P - PLUMBING
- M - MECHANICAL
- E - ELECTRICAL
- T - TELECOMMUNICATIONS
- R - RESOURCE

PROJECT NO: 031064
 DWG FILE: 031064SUM.DWG
 SCALE: AS SHOWN
 DRAWING DATE: 06-17-05
 DESIGNED BY: JER / DSD
 DRAWN BY: TJB / DSD
 CHECKED BY: LDH
 PLOTTED BY: DSD 06-17-05

CLIENT

VILLAGE OF PARK FOREST ILLINOIS

(FAU 2830) MONEE ROAD STP (LAPP) PROJECT

SHEET TITLE

SCHEDULE OF QUANTITIES

3 OF 10

ENTRANCES							
STATION	EXIST DRIVE APRONS (TYPE)	RES. OR COMM.	WIDTH @ 3' BACK OF E. O. P. (FT)	WIDTH @ E. O. P. (FT)	LENGTH (FT)	DRIVEWAY PAVEMENT (SY)	
12+22	LT	BIT	RES	22	25	3	7.8
12+64	RT	BIT	RES	20	23	3	7.2
13+00	LT	BIT	RES	14	17	3	5.2
13+24	LT	CONC	RES	-	16	3	-
13+81	RT	BIT	RES	15	18	3	5.5
13+95	LT	CONC	RES	-	17	3	-
14+47	RT	BIT	RES	36	38	3	12.3
14+66	LT	BIT	RES	14	17	3	5.2
15+50	RT	BIT	RES	24	27	3	8.5
15+69	LT	BIT	RES	17	19	3	6.0
16+07	LT	CONC	RES	-	13	3	-
17+12	RT	BIT	RES	16	20	3	6.0
17+98	LT	BIT	RES	24	28	3	8.7
19+12	LT	BIT	RES	14	19	3	5.5
19+28	LT	BIT	RES	12	13	3	4.2
19+42	RT	BIT	RES	27	31	3	9.7
20+31	LT	BIT	RES	14	19	3	5.5
20+40	RT	CONC	RES	-	28	3	-
20+41	LT	BIT	RES	11	13	3	4.0
21+03	RT	CONC	RES	-	25	3	-
21+06	LT	BIT	RES	13	15	3	4.7
22+19	LT	BIT	RES	34	37	3	11.8
23+24	LT	BIT	RES	12	15	3	4.5
23+46	LT	BIT	RES	14	19	3	5.5
24+61	LT	BIT	RES	29	33	3	10.3
25+80	LT	BIT	RES	33	40	3	12.2
26+88	LT	BIT	RES	15	20	3	5.8
27+11	LT	BIT	RES	20	24	3	7.3
28+17	LT	BIT	RES	28	31	3	9.8
28+34	RT	BIT	RES	14	14	3	4.7
28+85	LT	BIT	RES	20	21	3	6.8
29+28	RT	CONC	RES	-	17	3	-
29+52	LT	BIT	RES	15	20	VAR	9.1
TOTAL BITUMINOUS DRIVEWAY PAVEMENT **						193.8	
TOTAL BITUMINOUS SURFACE REMOVAL AT PROJECT LIMITS						224.2	
TOTAL BITUMINOUS SURFACE REMOVAL - BUTT JOINT **						418.0	
** BITUMINOUS PAVEMENT REMOVAL AND REPLACEMENT SHALL BE PAID FOR AS SHOWN IN THE PROPOSED TYPICAL SECTIONS.							

SCHEDULE OF MANHOLE ADJUSTMENTS	
MANHOLES TO BE ADJUSTED	
29+25	13.0' RT
TOTAL	1 EACH

SCHEDULE OF CATCH BASIN ADJUSTMENTS	
CATCH BASINS TO BE ADJUSTED	
25+77	9.0' LT
25+77	14.0' LT
27+31	18.0' LT
30+20	32.0' LT
TOTAL	4 EACH



SCHEDULE OF SANITARY MANHOLE ADJUSTMENTS	
SANITARY MANHOLES TO BE ADJUSTED	
13+54	13.0' RT
16+98	24.0' RT
23+95	13.0' RT
26+97	13.0' RT
28+80	14.0' RT
TOTAL	5 EACH

SCHEDULE OF PAVEMENT PATCHING			
CLASS D PATCHES, TYPE III, 6"			
START	END	WIDTH	AREA
19+74	19+80	24	16.0
20+85	21+15	6	20.0
28+14	28+18	34	15.0
TOTAL			51.0 SQ YD

SCHEDULE OF PAVEMENT PATCHING			
CLASS D PATCHES, TYPE IV, 6"			
START	END	WIDTH	AREA
11+70	12+07	12	50.0
12+48	12+85	6	25.0
12+90	14+03	VARIES	74.0
15+17	15+97	5	44.0
16+77	17+31	VARIES	100.0
18+20	19+08	VARIES	63.0
20+19	20+54	VARIES	27.0
21+50	23+47	6	132.0
23+78	24+08	VARIES	53.0
24+67	25+29	6	42.0
24+88	25+24	12	48.0
25+74	27+22	VARIES	92.0
25+74	26+17	6	29.0
26+68	27+19	13	74.0
TOTAL			853.0 SQ YD

SCHEDULE OF PAVEMENT PATCHING			
CLASS D PATCHES, TYPE II, 6"			
START	END	WIDTH	AREA
11+49	11+65	6	11.0
12+43	12+47	12	6.0
15+32	15+61	4	14.0
16+42	16+53	5	6.0
29+03	29+21	6	12.0
TOTAL			49.0 SQ YD

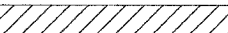
PROPOSED

- SMH-A, MH-A, WV-A, AND WV-A, SANITARY MANHOLE, MANHOLE, WATER VALVE BOX OR WATER VALVE VAULT TO BE ADJUSTED
- MH-R (SP) MANHOLES TO BE RECONSTRUCTED WITH NEW GRATE (SPECIAL)
-  BITUMINOUS SURFACE REMOVAL - BUTT JOINT
-  CLASS D PATCHES, TYPE VARIES (I - IV) - 6" XX SQ. YD.
-  DRIVEWAY REMOVAL & REPLACEMENT

I:\PRJKT\021064\DWGS\031064SUM.DWG
 Plotter: 7-19-05 @ 4:59pm By: 368jer
 Copyright © 2005, By Baxter & Woodman, Inc.
 State of Illinois - Professional Design Firm
 License No. - 184-001121 - Expires 4-30-07

F.A.U. ROUTE NO.	SECTION	5 COUNTY	TOTAL SHEETS	SHEET NO.
2830	*	COOK	10	4
ILLINOIS PROJECT: M-8003 (525)				
CONTRACT NO.: 83809				

* 02-00086-00-RS

BAXTER

WOODMAN
 Consulting Engineers
Baxter & Woodman
 Crystal Lake, Illinois 815.459.1260
 Burlington, Wisconsin 262.763.7834
 Mokena, Illinois 708.478.2090
 DeKalb, Illinois 815.787.3111
 Graylake, Illinois 847.223.5088
 Rockford, Illinois 815.489.1551
 www.baxwood.com

CONSULTANTS

NO.	DATE	DESCRIPTION
1	7/6/05	PER IDOT COMMENTS

REFER TO EQUIPMENT MANUFACTURER'S SHOP DRAWING

PLAN SHEET DESIGNATION

- COVER
- G - GENERAL
- H - HAZARDOUS MATERIALS
- C - CIVIL
- L - LANDSCAPE
- S - STRUCTURAL
- A - ARCHITECTURAL
- I - INTERIORS
- O - EQUIPMENT
- F - FIRE PROTECTION
- P - PLUMBING
- M - MECHANICAL
- E - ELECTRICAL
- T - TELECOMMUNICATIONS
- R - RESOURCE

PROJECT NO:	031064
DWG FILE:	
SCALE:	AS SHOWN
DRAWING DATE:	06-17-05
DESIGNED BY:	JER / DSD
DRAWN BY:	ABN / DSD
CHECKED BY:	LDH
PLOTTED BY:	

CLIENT

VILLAGE OF PARK FOREST ILLINOIS
(FAU 2830) MONEE ROAD STP (LAPP) PROJECT

SHEET TITLE

MONEE ROAD
STA. 11+42.89 TO 20+50
ROADWAY & PAVEMENT MARKINGS
PLAN

4 OF 10

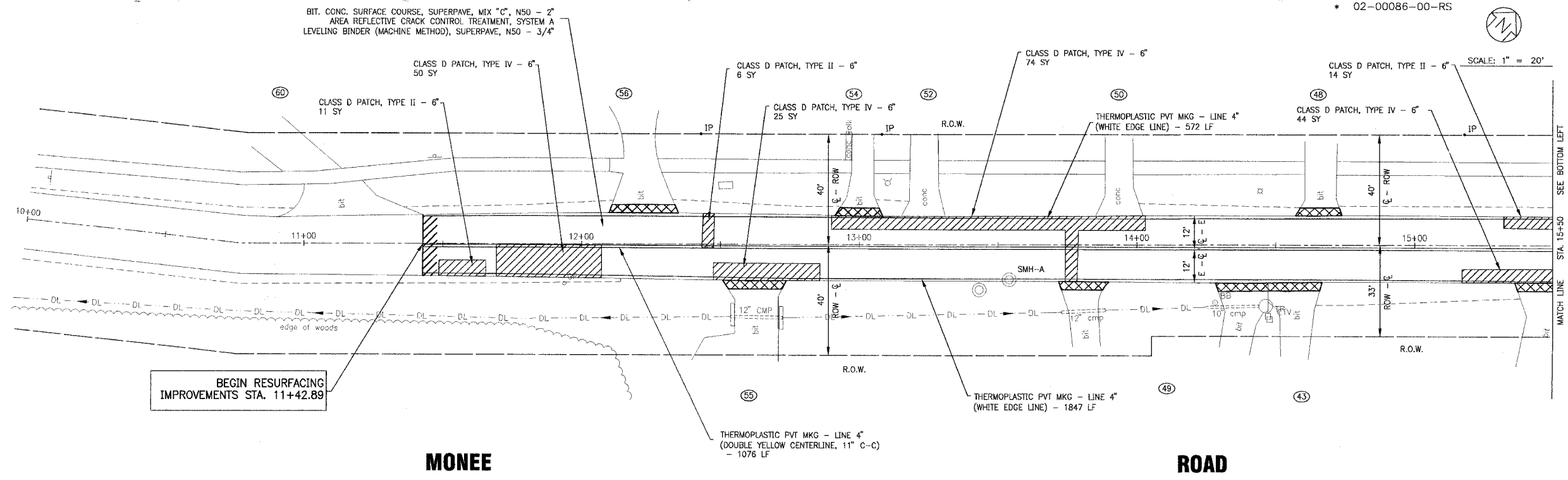

BEGIN RESURFACING IMPROVEMENTS STA. 11+42.89

MONEE

ROAD

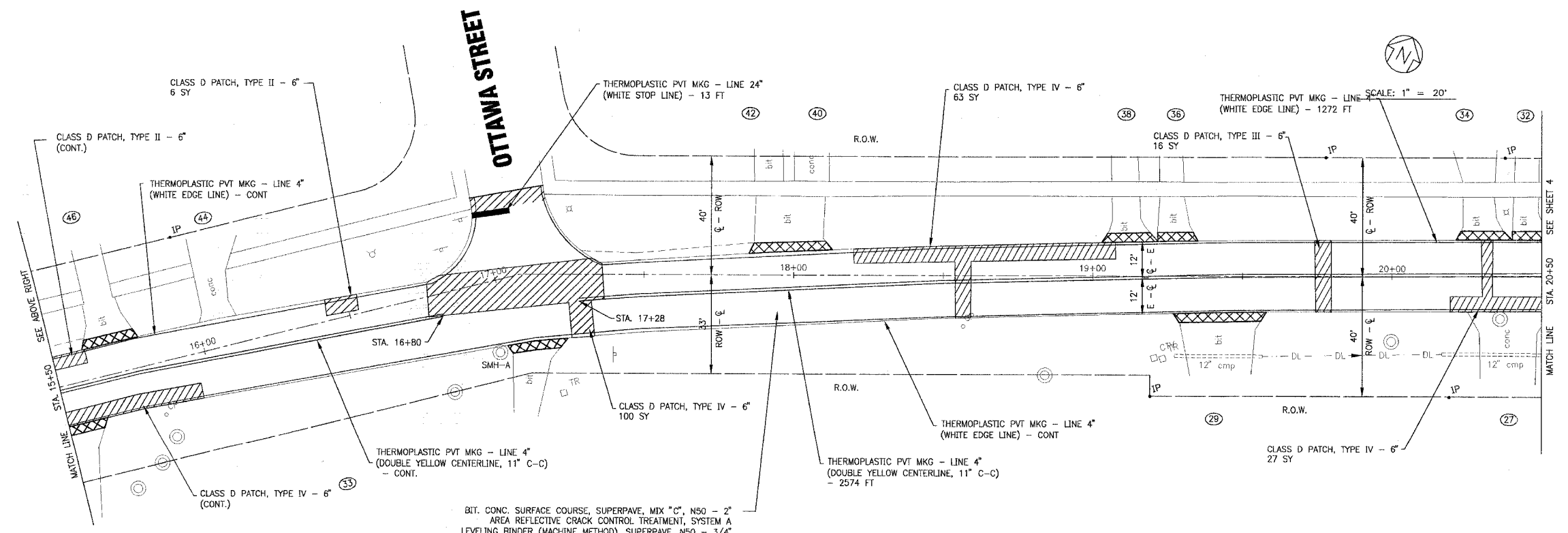

MONEE

ROAD

I:\PRKFT\031064\DWG\31054APL.DWG
 Plotted: 7-19-05 @ 4:50pm By: 368/jer
 Copyright © 2005, By Baxter & Woodman, Inc.
 State of Illinois - Professional Engineer
 License No. - 184-001121 - Expires 4-30-07

F.A.U. ROUTE NO.	SECTION	5 COUNTY	TOTAL SHEETS	SHEET NO.
2830	*	COOK	10	5
ILLINOIS PROJECT: M-8003 (525)				
CONTRACT NO.: 83809				
* 02-00086-00-RS				

BAXTER

WOODMAN
 Consulting Engineers
Baxter & Woodman
 Crystal Lake, Illinois 815.459.1260
 Burlington, Wisconsin 262.763.7834
 Mokena, Illinois 708.478.3090
 DeKalb, Illinois 815.787.3111
 Grayslake, Illinois 847.223.5088
 Rockford, Illinois 815.459.1551
 www.baxwood.com

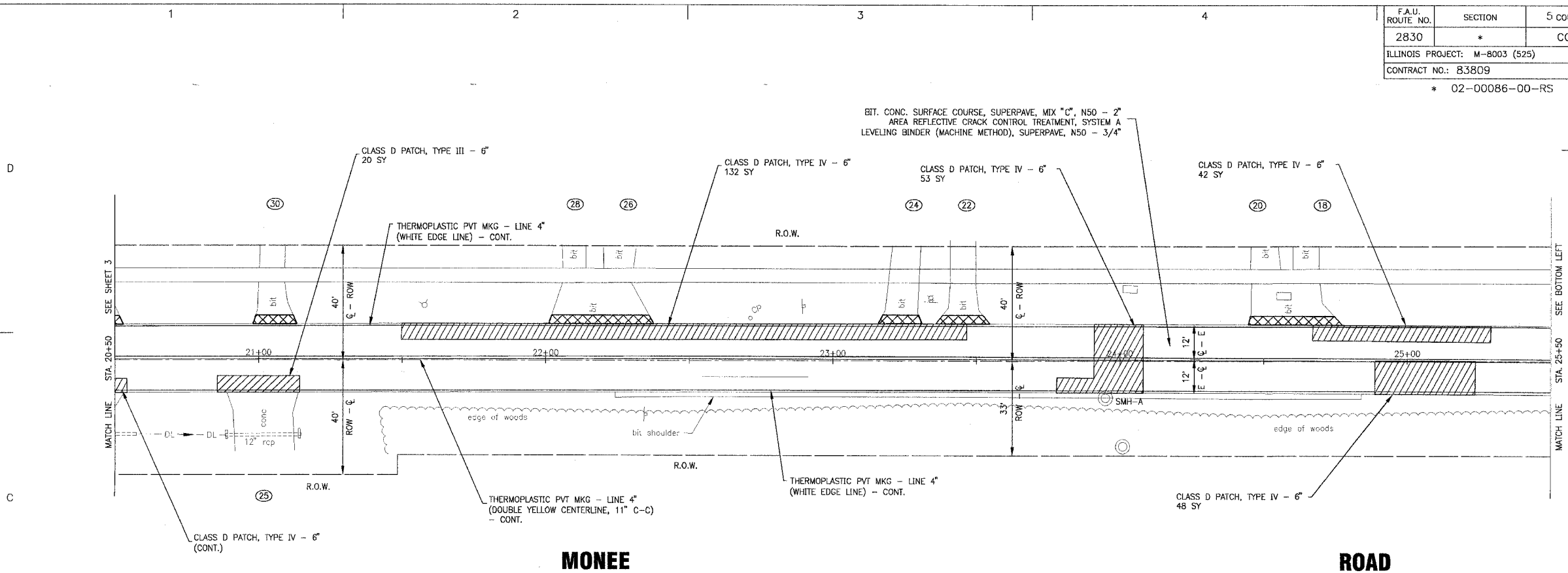

MONEE ROAD

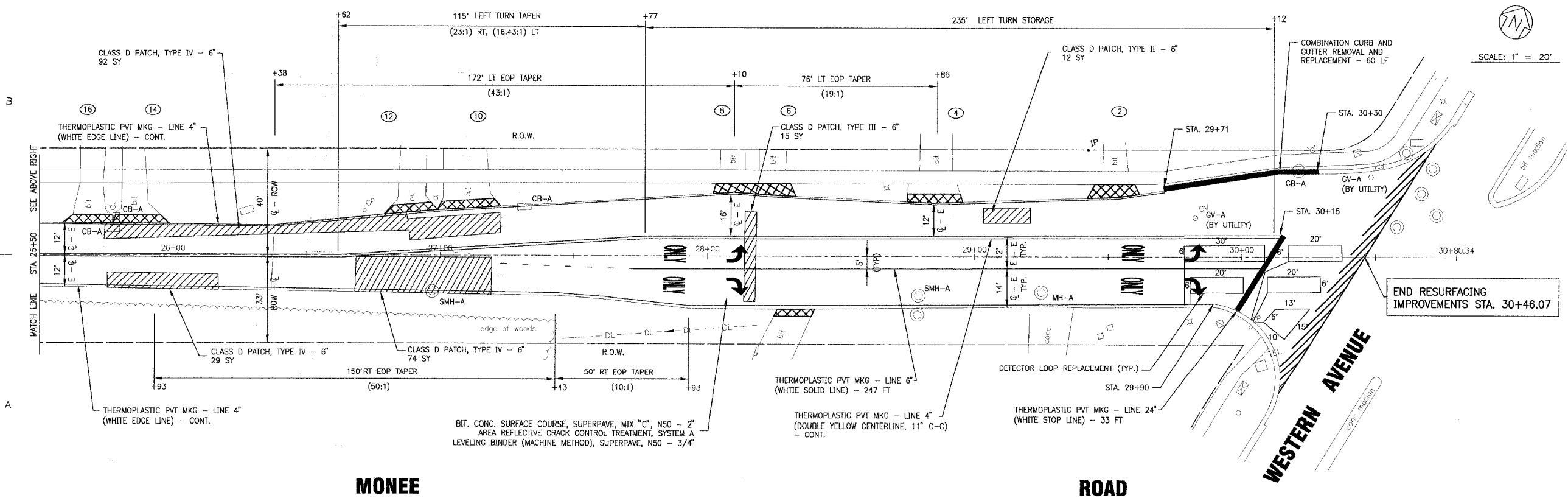

MONEE ROAD

ROAD

SCALE: 1" = 20'

SCALE: 1" = 20'

CONSULTANTS

NO.	DATE	DESCRIPTION
1	7/8/05	PER IDOT COMMENTS

PLAN SHEET DESIGNATION

- COVER
- G - GENERAL
- H - HAZARDOUS MATERIALS
- C - CIVIL
- L - LANDSCAPE
- S - STRUCTURAL
- A - ARCHITECTURAL
- I - INTERIORS
- Q - EQUIPMENT
- F - FIRE PROTECTION
- P - PLUMBING
- M - MECHANICAL
- E - ELECTRICAL
- T - TELECOMMUNICATIONS
- R - RESOURCE

PROJECT NO:	031064
DWG FILE:	
SCALE:	AS SHOWN
DRAWING DATE:	06-17-05
DESIGNED BY:	JER / DSD
DRAWN BY:	ABN / DSD
CHECKED BY:	LDH
PLOTTED BY:	

CLIENT

VILLAGE OF PARK FOREST ILLINOIS

(FAU 2830) MONEE ROAD STP (LAPP) PROJECT

SHEET TITLE

MONEE ROAD STA. 20+50 TO 30+46.07 ROADWAY & PAVEMENT MARKINGS PLAN

I:\PRKTA\031064\DWGS\31064APL.dwg
 Plotted: 7-19-05 @ 4:50pm By: 366ier
 Copyright © 2005, By Baxter & Woodman, Inc.
 State of Illinois - Professional Design Firm
 License No. - 181-001121 - Expires 4-30-07

BAXTER

WOODMAN
 Consulting Engineers
 Baxter & Woodman
 Crystal Lake, Illinois 815.459.1360
 Burlington, Wisconsin 262.763.7884
 Mokena, Illinois 708.478.2000
 DeKalb, Illinois 815.787.3111
 Crystal Lake, Illinois 847.223.5088
 Rockford, Illinois 815.489.1551
 www.baxwood.com

CONSULTANTS

NO.	DATE	DESCRIPTION
1	7/6/05	PER IDOT COMMENTS

PLAN SHEET DESIGNATION

COVER	G - GENERAL
H - HAZARDOUS MATERIALS	C - CIVIL
L - LANDSCAPE	S - STRUCTURAL
A - ARCHITECTURAL	I - INTERIORS
Q - EQUIPMENT	F - FIRE PROTECTION
P - PLUMBING	M - MECHANICAL
E - ELECTRICAL	T - TELECOMMUNICATIONS
R - RESOURCE	

PROJECT NO:	031064
DWG FILE:	AS NOTED
SCALE:	AS NOTED
DRAWING DATE:	3-16-04
DESIGNED BY:	JER
DRAWN BY:	TJB
CHECKED BY:	LDH
PLOTTED BY:	

CLIENT

VILLAGE OF PARK FOREST ILLINOIS
 (FAU 2830) MONEE ROAD STP (LAPP) PROJECT

SHEET TITLE

IDOT DISTRICT 1 TYPICAL PAVEMENT MARKINGS

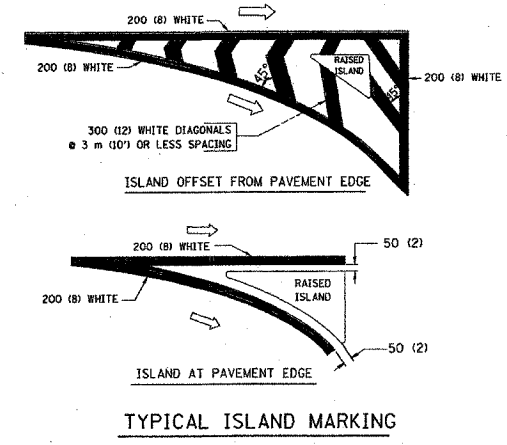
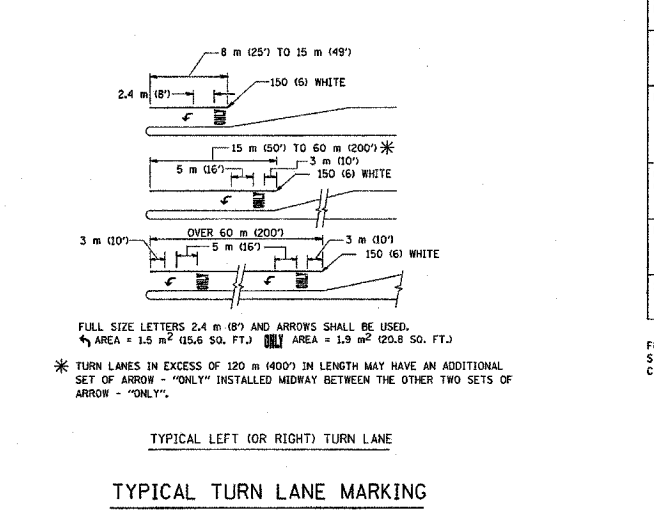
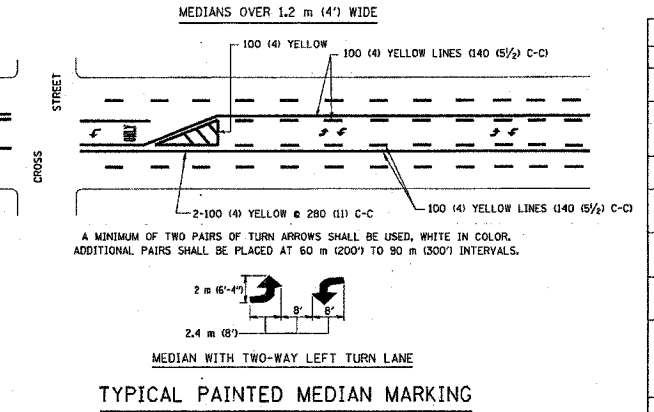
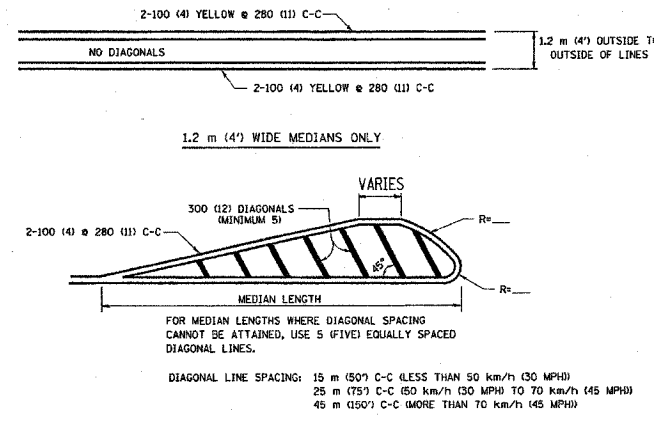
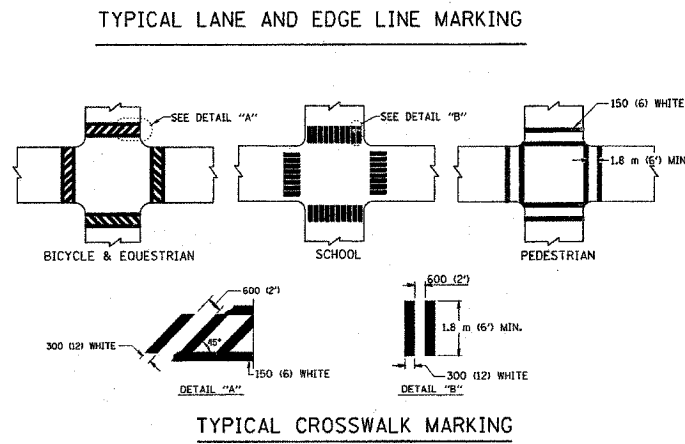
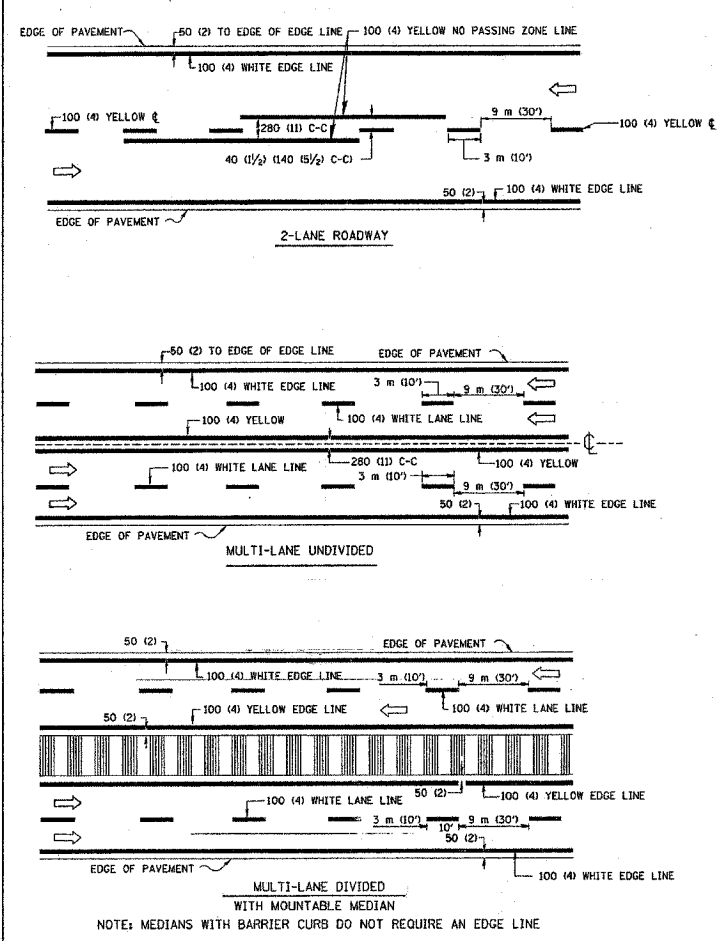

TYPE OF MARKING	WIDTH OF LINE	PATTERN	COLOR	SPACING / REMARKS
CENTERLINE ON 2 LANE PAVEMENT	100 (4)	SKIP-DASH	YELLOW	3 m (10') LINE WITH 9 m (30') SPACE
CENTERLINE ON MULTI-LANE UNDIVIDED PAVEMENT	2 @ 100 (4)	SOLID	YELLOW	280 (11) C-C
NO PASSING ZONE LINES FOR ONE DIRECTION FOR BOTH DIRECTIONS	100 (4) 2 @ 100 (4)	SOLID SOLID	YELLOW YELLOW	140 (5 1/2) C-C FROM SKIP-DASH CENTERLINE 280 (11) C-C OMIT SKIP-DASH CENTERLINE BETWEEN
LANE LINES	100 (4) 125 (5) ON FREEWAYS	SKIP-DASH SKIP-DASH	WHITE WHITE	3 m (10') LINE WITH 9 m (30') SPACE
DOTTED LINES (EXTENSIONS OF CENTER, LANE OR TURN LANE MARKINGS)	SAME AS LINE BEING EXTENDED	SKIP-DASH	SAME AS LINE BEING EXTENDED	600 (2') LINE WITH 1.8 m (6') SPACE
EDGE LINES	100 (4)	SOLID	YELLOW-LEFT WHITE-RIGHT	OUTLINE MOUNTABLE MEDIANS IN YELLOW; EDGE LINES ARE NOT USED NEXT TO BARRIER CURB
TURN LANE MARKINGS	150 (6) LINE, FULL SIZE LETTERS & SYMBOLS 6.4 m (8')	SOLID	WHITE	SEE TYPICAL TURN LANE MARKING DETAIL
TWO WAY LEFT TURN MARKING	2 @ 100 (4) EACH DIRECTION 2.4 m (8') LEFT ARROW	SKIP-DASH AND SOLID IN PAIRS	YELLOW WHITE	3 m (10') LINE WITH 9 m (30') SPACE FOR SKIP-DASH; 140 (5 1/2) C-C BETWEEN SOLID LINE AND SKIP-DASH LINE SEE TYPICAL TWO-WAY LEFT TURN MARKING DETAIL
CROSSWALK LINES (PEDESTRIAN A. DIAGONALS (BIKE & EQUESTRIAN) B. LONGITUDINAL BARS (SCHOOL))	2 @ 150 (6) 300 (12) @ 45° 300 (12) @ 90°	SOLID SOLID SOLID	WHITE WHITE WHITE	NOT LESS THAN 1.8 m (6') APART 600 (2') APART SEE TYPICAL CROSSWALK MARKING DETAILS.
STOP LINES	600 (24)	SOLID	WHITE	PLACE 1.2 m (4') IN ADVANCE OF AND PARALLEL TO CROSSWALK, IF PRESENT. OTHERWISE, PLACE AT DESIRED STOPPING POINT, PARALLEL TO CROSSROAD CENTERLINE, WHERE POSSIBLE.
PAINTED MEDIANS	2 @ 100 (4) WITH 300 (12) DIAGONALS @ 45° NO DIAGONALS USED FOR 1.2 m (4') WIDE MEDIANS	SOLID	YELLOW; TWO WAY TRAFFIC WHITE; ONE WAY TRAFFIC	280 (11) C-C FOR THE DOUBLE LINE SEE TYPICAL PAINTED MEDIAN MARKING.
GORE MARKING AND CHANNELIZING LINES	200 (8) WITH 300 (12) DIAGONALS @ 45°	SOLID	WHITE	DIAGONALS: 4.5 m (15') C-C (LESS THAN 50 km/h (30 MPH)) 5 m (12') C-C (50 km/h (30 MPH) TO 70 km/h (45 MPH)) 9 m (30') C-C (OVER 70 km/h (45 MPH))
RAILROAD CROSSING	600 (24) TRANSVERSE LINES; "RR" IS 1.8 m (6') LETTERS; 400 (16) LINE FOR "X"	SOLID	WHITE	SEE STATE STANDARD 780001 AREA OF: "R"=0.33m ² (3.6 SQ. FT.) EACH "X"=5.0 m ² (54.0 SQ. FT.)
SHOULDER DIAGONALS	300 (12) @ 45°	SOLID	WHITE - RIGHT YELLOW - LEFT	15 m (50') C-C (LESS THAN 50 km/h (30 MPH)) 25 m (75') C-C (50 km/h (30 MPH) TO 70 km/h (45 MPH)) 45 m (150') C-C (OVER 70 km/h (45 MPH))

FOR FURTHER DETAILS ON PAVEMENT MARKING REFER TO STANDARD SPECIFICATIONS FOR ROAD AND BRIDGE CONSTRUCTION AND STATE STANDARD 780001.

ILLINOIS DEPARTMENT OF TRANSPORTATION
 DISTRICT ONE
 TYPICAL PAVEMENT MARKINGS

SCALE: NONE
 DATE: 3/25/02
 DRAWN BY: CADD
 CHECKED BY:

REVISIONS	NAME	DATE
1	EVERS	03-19-90
2	T. RAMMACHER	10-27-94
3	ALEX HOUSEH	10-09-96
4	ALEX HOUSEH	10-17-96
5	T. RAMMACHER	01-06-00

I:\PRKFT\031064\DWGS\031064-6-10.dwg
 Plotted: 7-19-05 @ 4:51pm By: 368jer
 Copyright © 2005, By Baxter & Woodman, Inc.
 State of Illinois - Professional Design Firm
 License No. - 164-001121 - Expires 4-30-07

FAU ROUTE NO.	SECTION	COUNTY	TOTAL SHEETS	SHEET NO.
2830	*	COOK	10	7
ILLINOIS PROJECT: M-8003 (525)				
CONTRACT NO.: 83809				
* 02-00086-00-RS				

BAXTER

WOODMAN
 Consulting Engineers
Baxter & Woodman
 Crystal Lake, Illinois 815.459.1260
 Burlington, Wisconsin 262.763.7884
 Mokena, Illinois 708.478.2090
 DeKalb, Illinois 815.787.3111
 Crystal Lake, Illinois 847.223.5088
 Rockford, Illinois 815.499.1551
 www.baxwood.com

CONSULTANTS

NO.	DATE	REVISIONS DESCRIPTION
1	7/6/05	PER IDOT COMMENTS

* - REFER TO EQUIPMENT MANUFACTURER'S SHOP DRAWING

PLAN SHEET DESIGNATION

- COVER
- G - GENERAL
- H - HAZARDOUS MATERIALS
- C - CIVIL
- L - LANDSCAPE
- S - STRUCTURAL
- A - ARCHITECTURAL
- I - INTERIORS
- Q - EQUIPMENT
- F - FIRE PROTECTION
- P - PLUMBING
- M - MECHANICAL
- E - ELECTRICAL
- T - TELECOMMUNICATIONS
- R - RESOURCE

PROJECT NO:	031064
DWG FILE:	
SCALE:	AS NOTED
DRAWING DATE:	3-16-04
DESIGNED BY:	JER
DRAWN BY:	TJB
CHECKED BY:	LDH
PLOTTED BY:	

CLIENT

VILLAGE OF PARK FOREST ILLINOIS

(FAU 2830) MONEE ROAD STP (LAPP) PROJECT

SHEET TITLE

IDOT PAVEMENT MARKINGS LETTERS AND SYMBOLS FOR TRAFFIC STAGING

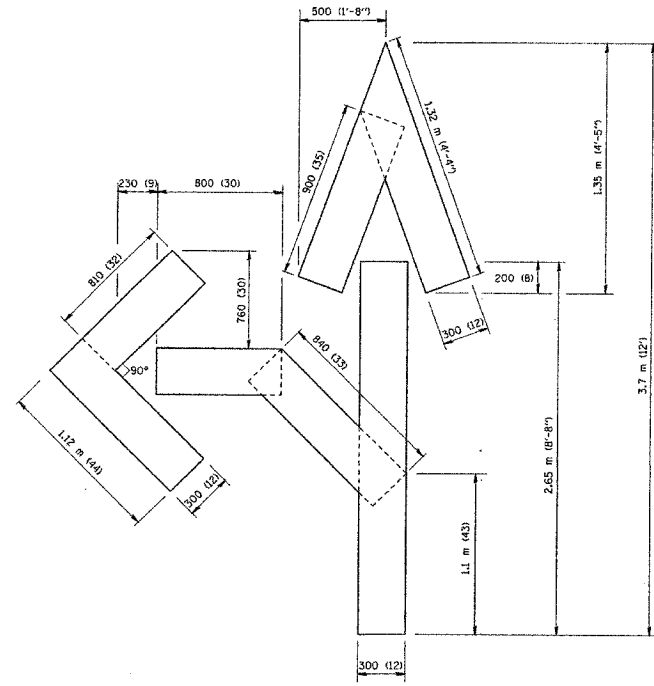
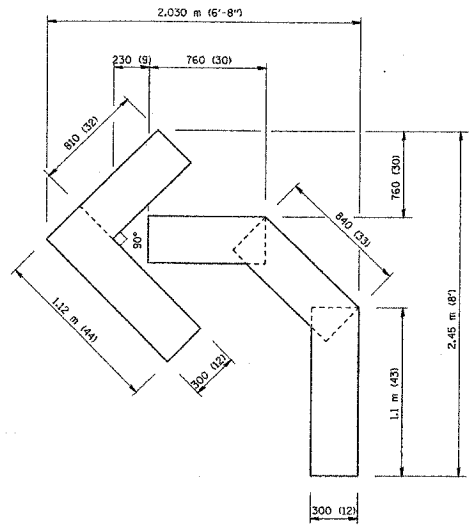
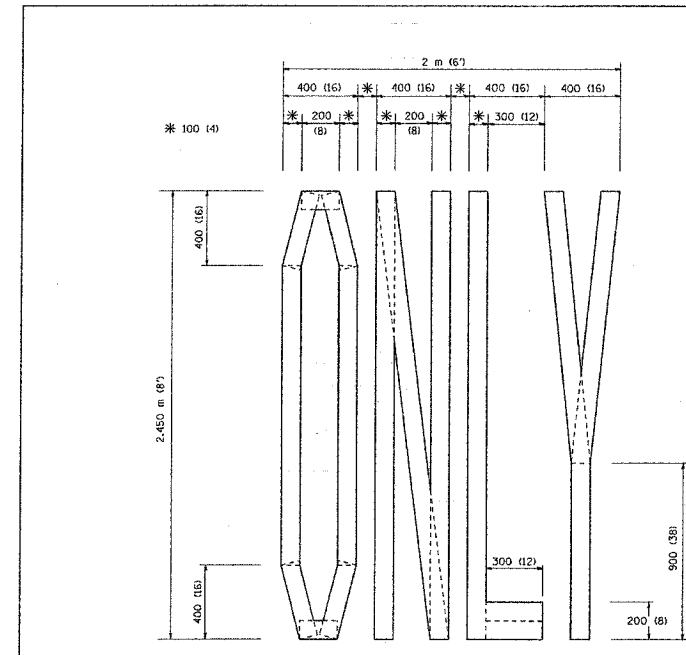

All dimensions are in millimeters (inches) unless otherwise shown.

REVISIONS	NAME	DATE
1	T. RAMMACHER	03/18/04
2	J. OBERLE	06/01/06
3	T. RAMMACHER	06/05/06
4	T. RAMMACHER	11/04/07
5	T. RAMMACHER	03/02/08
6	E. GOMEZ	08/28/00

ILLINOIS DEPARTMENT OF TRANSPORTATION

PAVEMENT MARKING LETTERS AND SYMBOLS FOR TRAFFIC STAGING

SCALE: NONE
 DATE: 11/20/01
 DRAWN BY: CADD
 CHECKED BY: TC-16

I:\PRMT\031064\DWG\031064-6-10.dwg
 Plotted: 7-19-05 @ 4:52pm By: 368jler
 Copyright © 2005, By Baxter & Woodman, Inc.
 State of Illinois - Professional Design Firm
 License No. - 184-001121 - Expires 4-30-07

Tue Nov 20 16:09:07 2001
 \\dca01d\projects\dstated\to16.dgn LV:35
 V:\1616
 ah\to16.prk: 15:50:45 11/20/2001

CONSULTANTS

NO.	DATE	DESCRIPTION	PER IDOT COMMENTS
1	7/6/05		

** REFER TO EQUIPMENT MANUFACTURER'S SHOP DRAWING

PLAN SHEET DESIGNATION

- C - COVER
- G - GENERAL
- H - HAZARDOUS MATERIALS
- C - CIVIL
- L - LANDSCAPE
- S - STRUCTURAL
- A - ARCHITECTURAL
- I - INTERIORS
- Q - EQUIPMENT
- F - FIRE PROTECTION
- P - PLUMBING
- M - MECHANICAL
- E - ELECTRICAL
- T - TELECOMMUNICATIONS
- R - RESOURCE

PROJECT NO:	031064
DWG FILE:	
SCALE:	AS NOTED
DRAWING DATE:	3-16-04
DESIGNED BY:	JER
DRAWN BY:	TJB
CHECKED BY:	LDH
PLOTTED BY:	

CLIENT

VILLAGE OF PARK FOREST ILLINOIS
(FAU 2830) MONEE ROAD STP (LAPP) PROJECT

SHEET TITLE

IDOT BUTT JOINT AND BITUMINOUS TAPER DETAILS

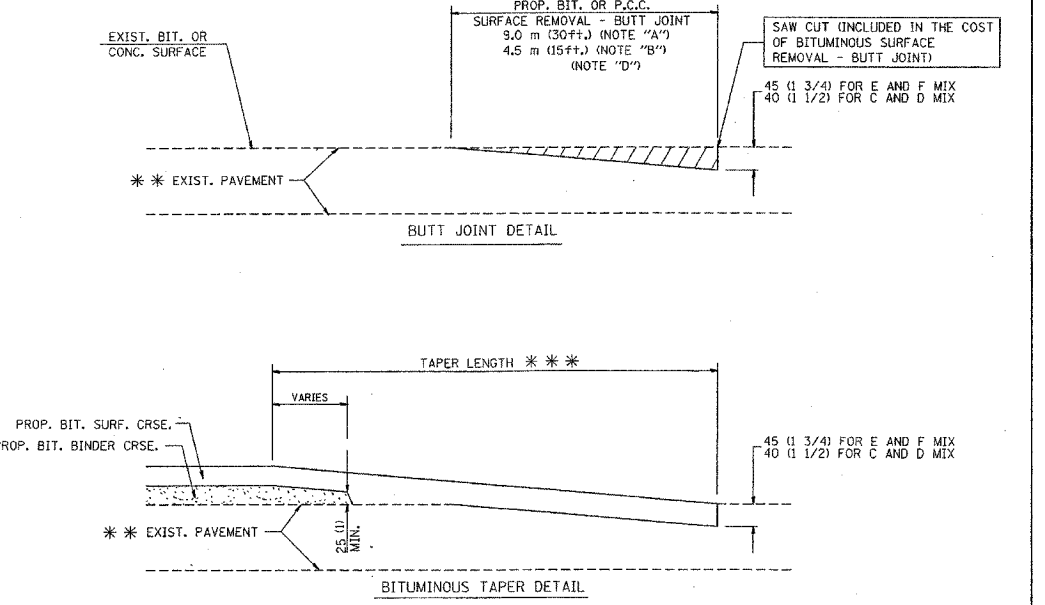
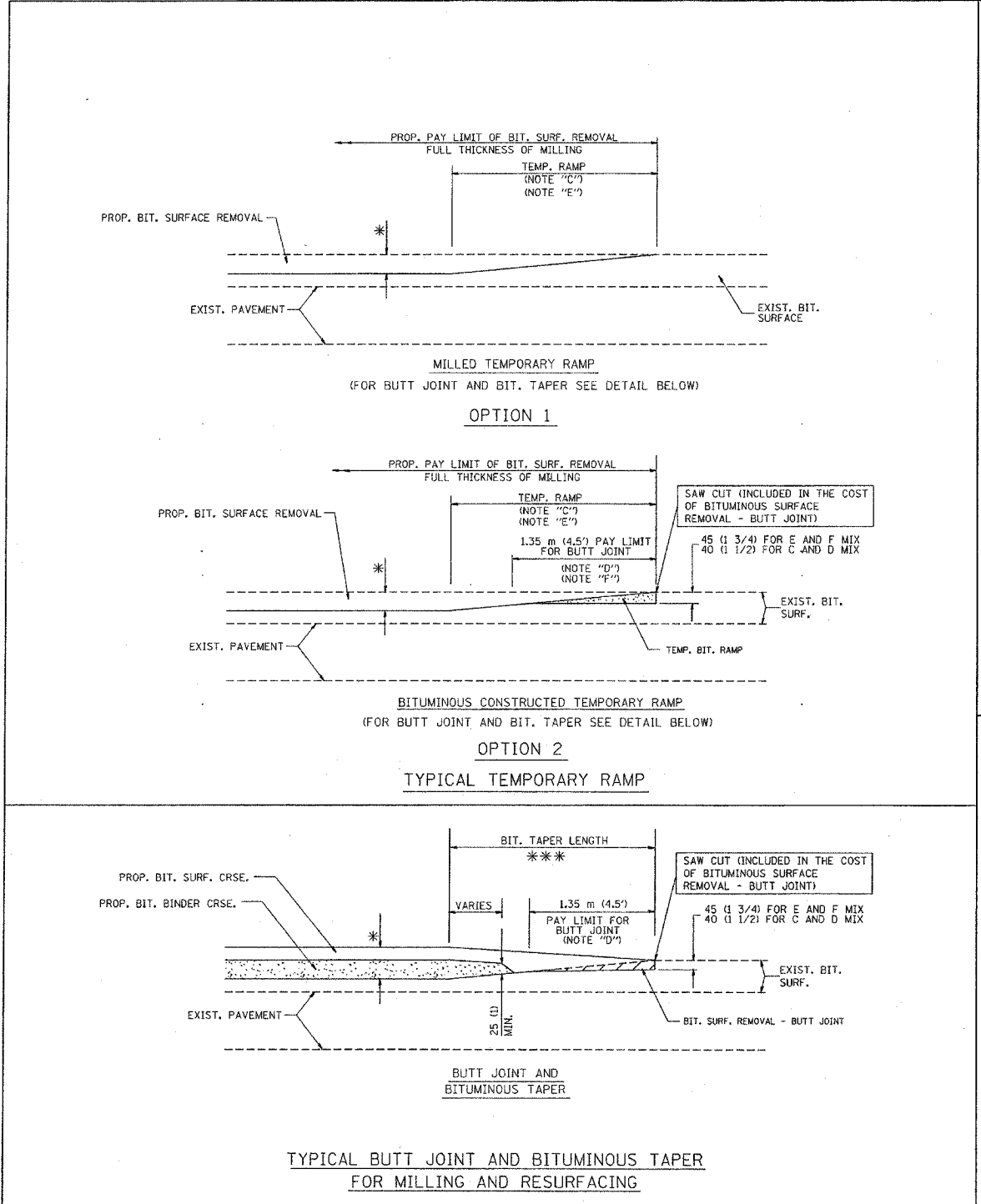

TYPICAL BUTT JOINT AND BITUMINOUS TAPER FOR RESURFACING ONLY

** PC CONCRETE, BITUMINOUS OR BITUMINOUS RESURFACED PAVEMENT.

NOTES

- A: MAINLINE ROADWAYS AND MAJOR SIDE ROADS.
 - B: MINOR SIDE ROADS.
 - C: THE TEMP. RAMP SHALL BE CONSTRUCTED IMMEDIATELY UPON REMOVAL OF THE EXISTING BITUMINOUS SURFACE.
 - D: THE BUTT JOINT SHALL BE CONSTRUCTED IMMEDIATELY PRIOR TO PLACING THE PROPOSED BITUMINOUS COURSES.
 - E: TAPER THE TEMP. RAMP AT A RATE OF 900 (3 FT.) PER INCH OF MILLING THICKNESS.
 - F: INSTALLATION AND REMOVAL OF THE 1.35 m (4.5') TEMP. BIT. RAMP WILL BE PAID AS "BITUMINOUS SURFACE REMOVAL - BUTT JOINT".
 - G: SEE ARTICLE 406.18 AND 406.24 OF THE STANDARD SPECIFICATIONS FOR "BITUMINOUS AND PCC SURFACE REMOVAL, BUTT JOINT".
- ** SEE TYPICAL SECTIONS FOR MILLING THICKNESS.
- *** 6.1 m (20') PER 25 (1) RESURFACING (NOTE "A")
 3.0 m (10') PER 25 (1) RESURFACING (NOTE "B")

ALL DIMENSIONS ARE IN MILLIMETERS (INCHES) UNLESS OTHERWISE SHOWN.

BASIS OF PAYMENT:
 THE BUTT JOINT WILL BE PAID FOR PER SQUARE METER (SQUARE YARD) AS "BITUMINOUS SURFACE REMOVAL - BUTT JOINT" OR AS "PORTLAND CEMENT CONCRETE SURFACE REMOVAL - BUTT JOINT".

REVISIONS	NAME	DATE
	M. DE YONG	6-15-90
	M. DE YONG	7-3-90
	M. DE YONG	3-27-92
	R. SHAH	03/09/94
	R. SHAH	10/25/94
	A. ABBAS	03/21/97
	M. GOMEZ	04/06/01

ILLINOIS DEPARTMENT OF TRANSPORTATION

BUTT JOINT AND BITUMINOUS TAPER DETAILS

SCALE: NONE
 DATE PLOTTED: 11/20/01
 DRAWN BY:
 CHECKED BY:

BD400-05 (V1-B032)

I:\PRJ\031064\DWG\031064-6-10.dwg
 Plotted: 7-19-05 @ 4:52pm By: 368ier
 Copyright © 2005, By Baxter & Woodman, Inc.
 State of Illinois - Professional Design Firm
 License No. - 184-001121 - Expires 4-30-07

BAXTER

WOODMAN
 Consulting Engineers
Baxter & Woodman
 Crystal Lake, Illinois 815.459.1260
 Burlington, Wisconsin 262.763.7834
 Mokena, Illinois 708.478.2090
 DeKalb, Illinois 815.787.3111
 Grayslake, Illinois 847.223.5088
 Rockford, Illinois 815.489.1551
 www.baxwood.com

CONSULTANTS

NO.	DATE	DESCRIPTION	PER IDOT COMMENTS
1	7/6/05		

* - REFER TO EQUIPMENT MANUFACTURER'S SHOP DRAWING

PLAN SHEET DESIGNATION

C	COVER
G	GENERAL
H	HAZARDOUS MATERIALS
C	CIVIL
L	LANDSCAPE
S	STRUCTURAL
A	ARCHITECTURAL
I	INTERIORS
E	EQUIPMENT
F	FIRE PROTECTION
P	PLUMBING
M	MECHANICAL
E	ELECTRICAL
T	TELECOMMUNICATIONS
R	RESOURCE

PROJECT NO:	031064
DWG FILE:	
SCALE:	AS NOTED
DRAWING DATE:	3-16-04
DESIGNED BY:	JER
DRAWN BY:	TJB
CHECKED BY:	LDH
PLOTTED BY:	
CLIENT:	

**VILLAGE OF PARK FOREST
 ILLINOIS**
**(FAU 2830) MONEE ROAD
 STP (LAPP) PROJECT**

SHEET TITLE

**IDOT TRAFFIC CONTROL AND
 PROTECTION AT TURN BAYS
 (TO REMAIN OPEN TO TRAFFIC)**

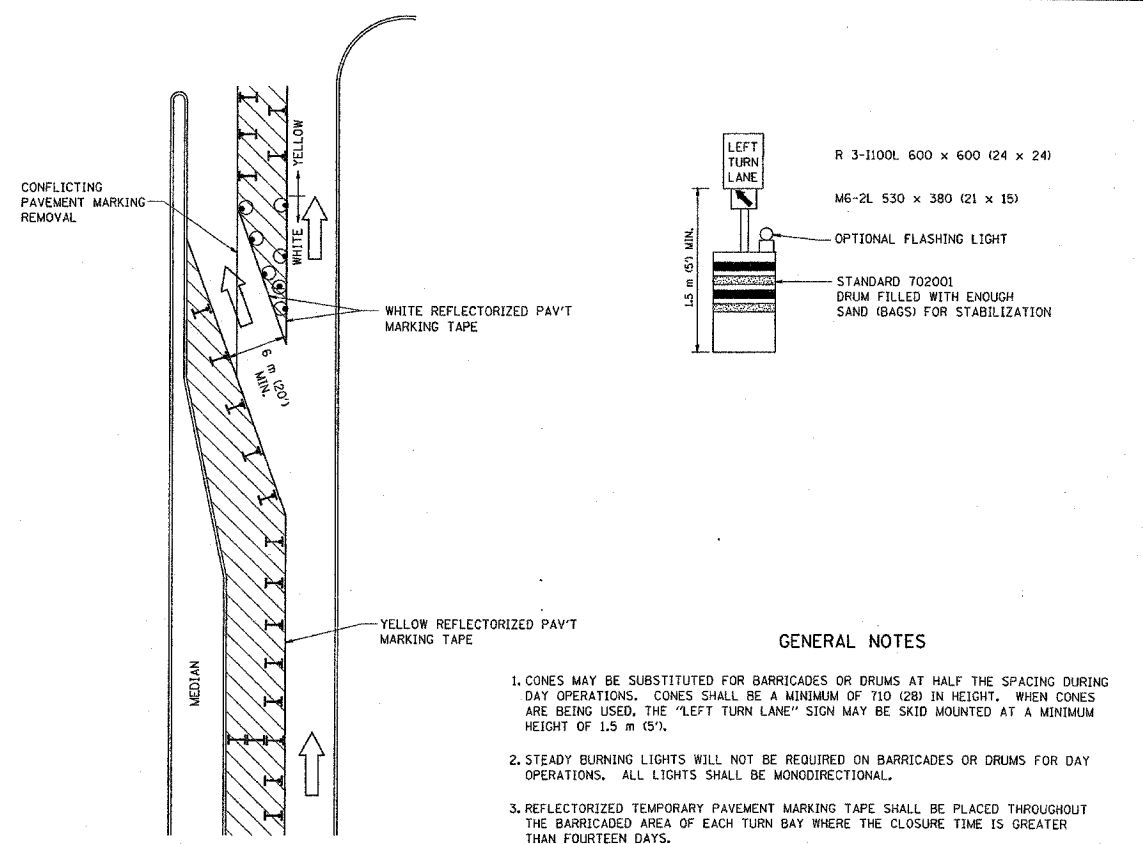

A.A. NO.	SECTION	COUNTY	TOTAL SHEETS	SHEET NO.
STA.		TO STA.		
FED. HIGH DIST. NO.	CLASS.	FED. AID PROJECT		



GENERAL NOTES

- CONES MAY BE SUBSTITUTED FOR BARRICADES OR DRUMS AT HALF THE SPACING DURING DAY OPERATIONS. CONES SHALL BE A MINIMUM OF 710 (28) IN HEIGHT. WHEN CONES ARE BEING USED, THE "LEFT TURN LANE" SIGN MAY BE SKID MOUNTED AT A MINIMUM HEIGHT OF 1.5 m (5').
- STEADY BURNING LIGHTS WILL NOT BE REQUIRED ON BARRICADES OR DRUMS FOR DAY OPERATIONS. ALL LIGHTS SHALL BE MONODIRECTIONAL.
- REFLECTORIZED TEMPORARY PAVEMENT MARKING TAPE SHALL BE PLACED THROUGHOUT THE BARRICADED AREA OF EACH TURN BAY WHERE THE CLOSURE TIME IS GREATER THAN FOURTEEN DAYS.
- THIS APPLICATION ALSO APPLIES WHEN WORK IS BEING PERFORMED IN THE RIGHT LANE(S) AND THE RIGHT TURN BAY IS TO REMAIN OPEN. UNDER THIS CONDITION, "RIGHT TURN LANE" R3-100 600 x 600 (24 x 24) AND M6-2R 530 x 380 (21 x 15) SHALL BE USED.
- THESE CONTROLS SHALL SUPPLEMENT MAINLINE TRAFFIC CONTROL FOR LANE CLOSURES.
- LONGITUDINAL DIMENSIONS MAY BE ADJUSTED TO FIT FIELD CONDITIONS.
- FORM BT 725 IS REQUIRED.
- TRAFFIC CONTROL AND PROTECTION AT TURN BAYS (TO REMAIN OPEN TO TRAFFIC) SHALL BE INCLUDED IN THE COST SPECIFIED TRAFFIC CONTROL STANDARDS OR ITEMS.

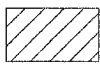
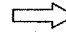
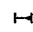
LEGEND

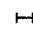
-  WORK AREA
-  LANE OPEN TO TRAFFIC
-  TYPE I OR II BARRICADE WITH STEADY BURN LIGHT
-  DRUM WITH STEADY BURN LIGHT
-  DRUM WITH SIGN (WITH OPTIONAL FLASHING LIGHT) SEE DETAIL
-  TYPE I OR II CHECK BARRICADE WITH FLASHING LIGHT

All dimensions are in millimeters (inches) unless otherwise shown.

ILLINOIS DEPARTMENT OF TRANSPORTATION
 TRAFFIC CONTROL AND PROTECTION AT TURN BAYS (TO REMAIN OPEN TO TRAFFIC)

REVISIONS	
NAME	DATE
T. RAMMACHER	09/08/94
A. HOUSEH	11/07/95
A. HOUSEH	10/12/96
T. RAMMACHER	01/06/00

SCALE: NONE
 DATE: 11/20/01
 DRAWN BY: LHA
 CHECKED BY: LHA

TC-14

I:\PRKFT\031064\DWG\031064-6-10.dwg
 Plotted: 7-19-05 @ 4:53pm By: 386jer
 Copyright © 2005, By Baxter & Woodman, Inc.
 State of Illinois - Professional Design Firm
 License No. - 764-001121 - Expires 4-30-07

Tue Nov 20 16:08:53 2001
 \\dlead\projects\distatd\lcl4.dgn LV:35
 V:\TC14

light14.prk 15-50-32 11/20/2001