

| | | | | |
|---------------------|---------------------------|--------|--------------------|-----------|
| F.A.P. RTE. | SECTION | COUNTY | TOTAL SHEETS | SHEET NO. |
| 360 03-00320-00-TL | | KANE | 33 | 27 |
| STA. | TO STA. | | | |
| FED. ROAD DIST. NO. | ILLINOIS FED. AID PROJECT | | CONTRACT NO. 83808 | |

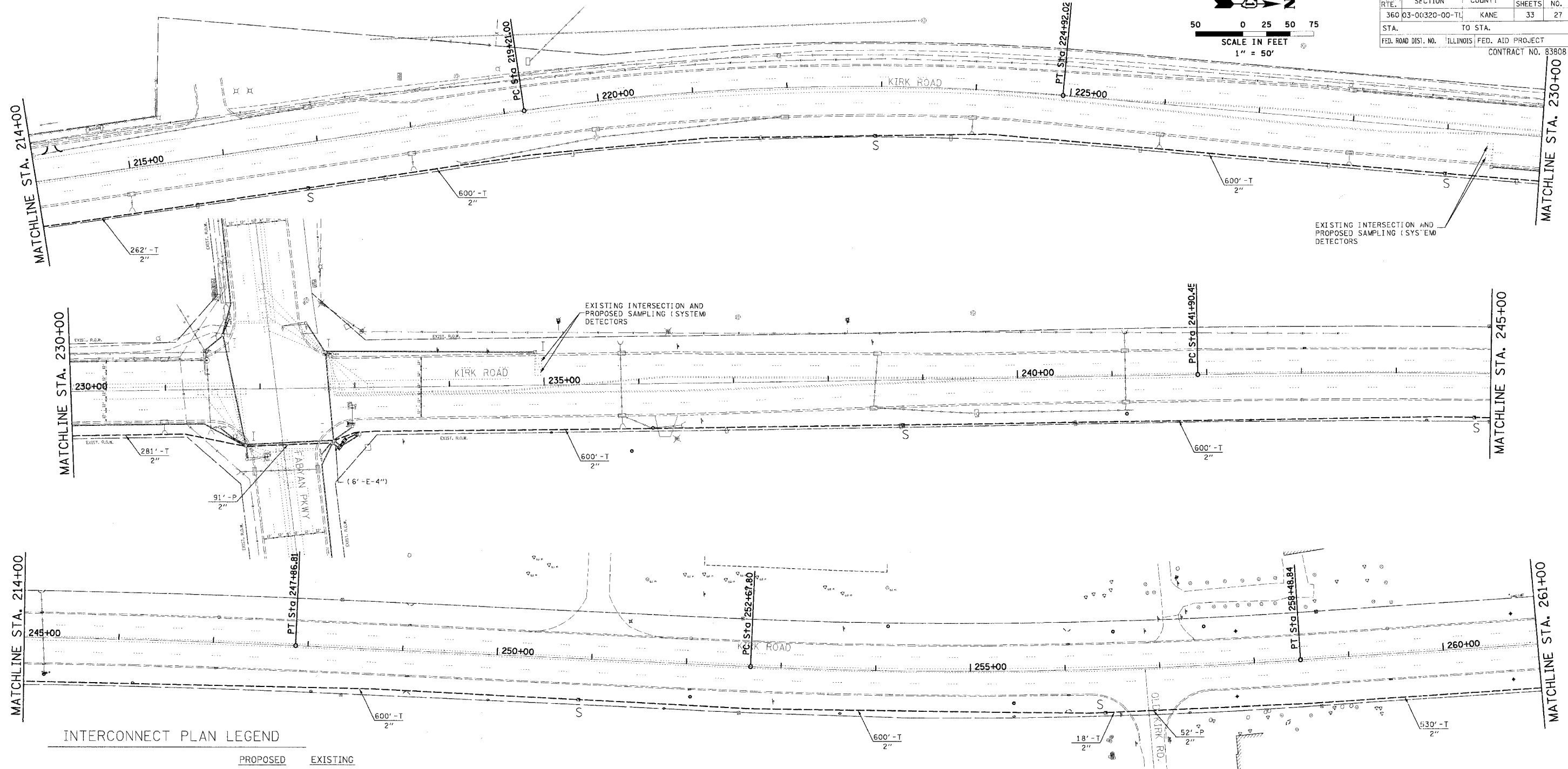
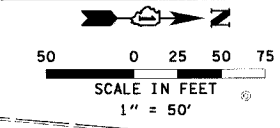

INTERCONNECT PLAN LEGEND

| | PROPOSED | EXISTING |
|--|----------|----------|
| CONTROLLER | | |
| HANDHOLE | | |
| DOUBLE HANDHOLE | | |
| HEAVY DUTY HANDHOLE | | |
| G.S. CONDUIT IN TRENCH (T) OR PUSHED (P) | | |
| DETECTOR LOOP | | |
| UNIT DUCT | UD | |
| SYSTEM | S | |
| INTERSECTION | IP | I |
| COMMON TRENCH | CT | |

NOTE:
THE TRAFFIC SIGNAL CONTROL EQUIPMENT FOR THIS PROJECT SHALL BE "EAGLE" TO MATCH THE EXISTING ADJACENT SYSTEM.

RESTORATION OF WORK AREA. RESTORATION OF THE TRAFFIC SIGNAL WORK AREA SHALL BE INCIDENTAL TO THE RELATED PAY ITEM SUCH AS FOUNDATION, CONDUIT, HANDHOLE, TRENCH AND BACKFILL, ETC., AND NO EXTRA COMPENSATION SHALL BE ALLOWED. ALL ROADWAY SURFACES SUCH AS SHOULDERS, MEDIANS, SIDEWALKS, PAVEMENT, ETC. SHALL BE REPLACED IN KIND. ALL DAMAGE TO MOWED LAWNS SHALL BE REPLACED WITH AN APPROVED SOG, AND ALL DAMAGE TO UNMOWED FIELDS SHALL BE SEEDING IN ACCORDANCE WITH STANDARD SPECIFICATIONS 252 AND 250 RESPECTIVELY.

| REVISIONS | |
|-----------|------|
| NAME | DATE |
| | |
| | |
| | |
| | |
| | |
| | |
| | |

KENIG, LINDGREN, O'HARA, ABOONA, INC.
9575 West Highgate Road, Suite 400
Rosemont, Illinois 60018
(847) 518-9990 FAX (847) 518-9987

ILLINOIS DEPARTMENT OF TRANSPORTATION
INTERCONNECT PLANS
KIRK RD.
FROM PINE ST. TO IL RTE 64
(SHEET 3 OF 7)

SCALE: 1" = 50'
DATE: 07/19/05
DRAWN BY: DMS
DESIGNED BY: DMS
CHECKED BY: DMS