

EXISTING TYPICAL CROSS SECTION
PFEIFFER ROAD - STA. 36+26.58 TO STA. 47+70.00

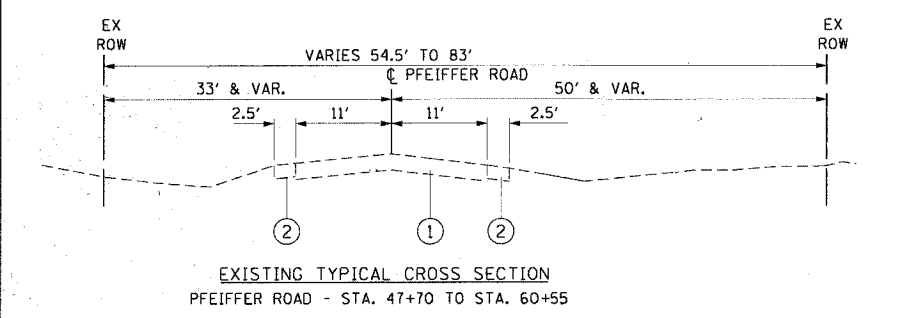

EXISTING TYPICAL CROSS SECTION
PFEIFFER ROAD - STA. 47+70 TO STA. 60+55

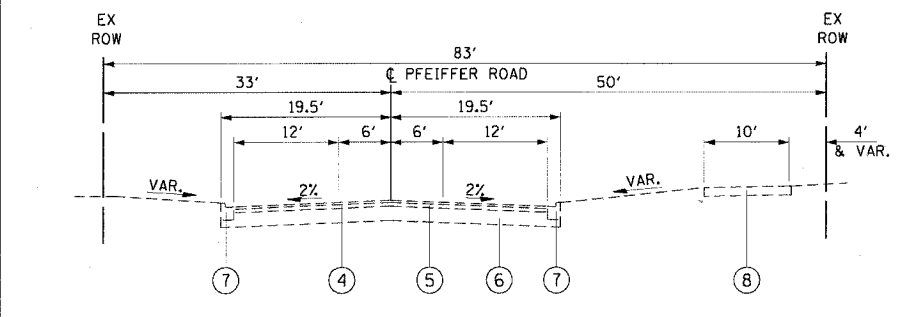

EXISTING TYPICAL CROSS SECTION
PFEIFFER ROAD - STA. 60+55 TO STA. 63+24.80

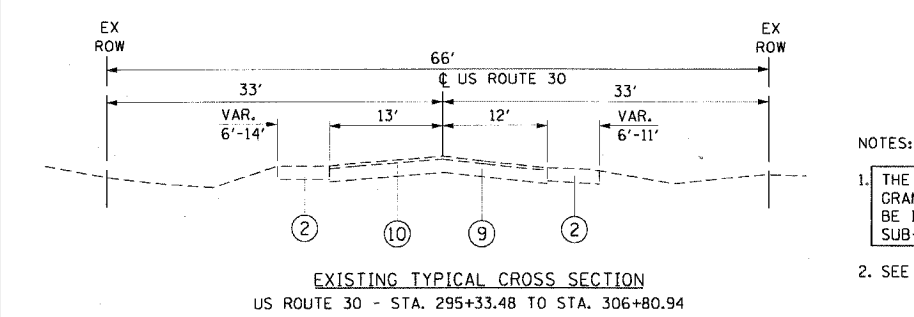

EXISTING TYPICAL CROSS SECTION
US ROUTE 30 - STA. 295+33.48 TO STA. 306+80.94

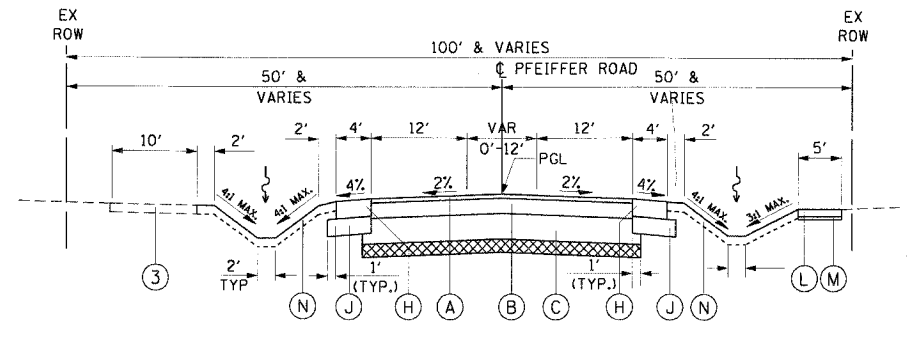

PROPOSED TYPICAL CROSS SECTION
PFEIFFER ROAD - STA. 37+00.00 TO STA. 39+40.00

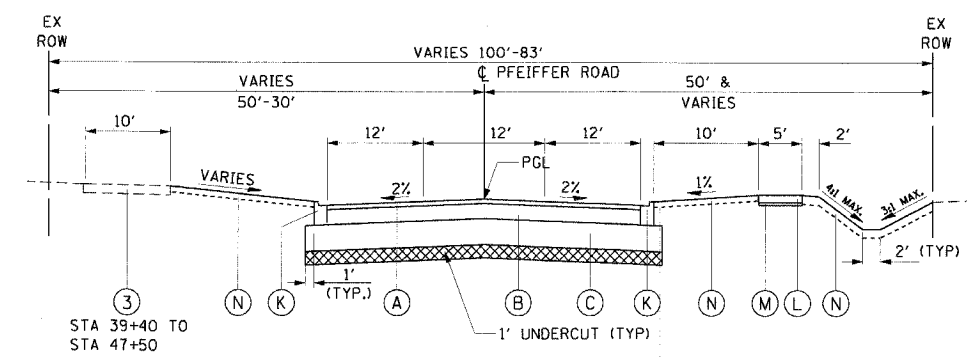

PROPOSED TYPICAL CROSS SECTION
PFEIFFER ROAD - STA. 39+40.00 TO STA. 63+24.80

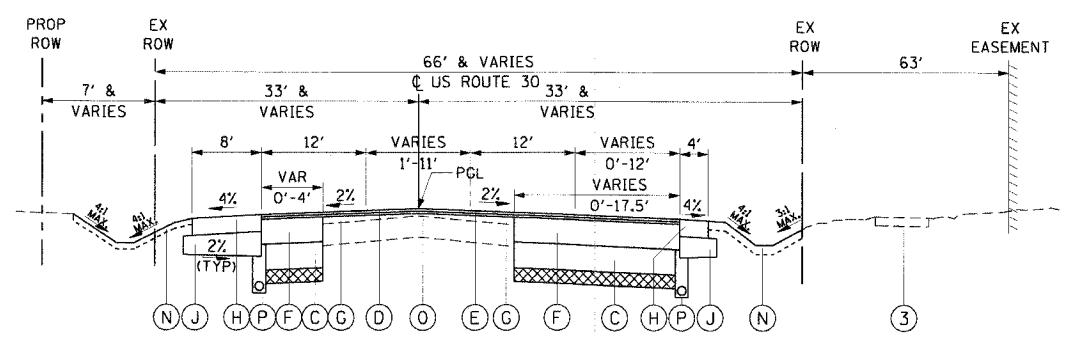

PROPOSED TYPICAL CROSS SECTION
U.S. ROUTE 30 - STA. 295+25.84 TO STA. 297+55.84

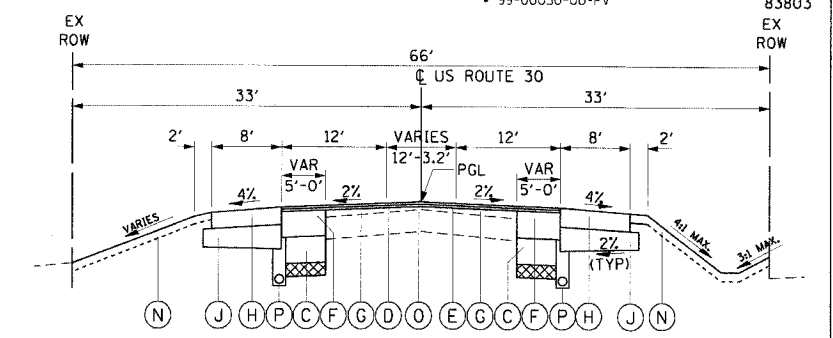

PROPOSED TYPICAL CROSS SECTION
U.S. ROUTE 30 - STA. 301+16.66 TO STA. 307+24.69

- EXISTING LEGEND**
- ① BITUMINOUS CONCRETE SURFACE - 3"
 - ② GRANULAR BASE COURSE - 8"
 - ③ AGGREGATE SHOULDER
 - ④ BITUMINOUS MULTI-USE PATH
 - ⑤ BITUMINOUS CONCRETE SURFACE COURSE - 1 1/2"
 - ⑥ BITUMINOUS CONCRETE BASE COURSE - 2 1/2"
 - ⑦ GRANULAR BASE COURSE - 10"
 - ⑧ COMBINATION CONCRETE CURB AND GUTTER
 - ⑨ PORTLAND CEMENT CONCRETE SIDEWALK
 - ⑩ BITUMINOUS CONCRETE SURFACE - 10"
 - ⑪ GRANULAR BASE COURSE - 2"
 - ⑫ BITUMINOUS SURFACE REMOVAL 2 1/4"

- PROPOSED LEGEND**
- A BITUMINOUS CONCRETE SURFACE COURSE, SUPERPAVE, MIX "D", N50, 2"
 - B BITUMINOUS CONCRETE BINDER COURSE, SUPERPAVE, IL-19, N50, 7"
 - C SUB-BASE GRANULAR MATERIAL, TYPE B 12"
 - D BITUMINOUS CONCRETE SURFACE COURSE, SUPERPAVE, MIX "D", N70, 1 1/2"
 - E POLYMERIZED LEVELING BINDER (MACHINE METHOD), SUPERPAVE, IL-4.75, N50, 3/4"
 - F BITUMINOUS CONCRETE BINDER COURSE, SUPERPAVE, IL-19, N70, 1 1/2"
 - G LEVELING BINDER (MACHINE METHOD), SUPERPAVE, N70
 - H BITUMINOUS SHOULDERS SUPERPAVE 8"
 - J SUB-BASE GRANULAR MATERIAL, TYPE B 8"
 - K COMBINATION CONCRETE CURB AND GUTTER, TYPE B-6.12
 - L PORTLAND CEMENT CONCRETE SIDEWALK 5 INCH
 - M AGGREGATE BASE COURSE, TYPE B, 2"
 - N SODDING, SALT TOLERANT AND TOPSOIL FURNISH AND PLACE, 4"
 - O BITUMINOUS SURFACE REMOVAL 2 1/4"
 - P PIPE UNDERDRAINS 4"

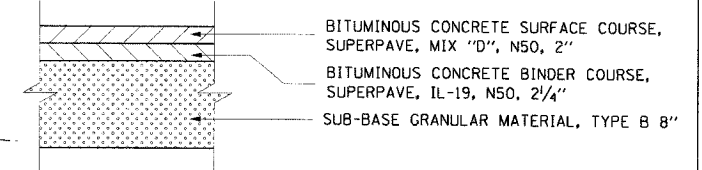

DRIVEWAY COMPOSITION DETAIL

- NOTES:**
1. THE ADDITIONAL THICKNESS OF THE SUB-BASE GRANULAR MATERIAL UNDER THE SHOULDER SHALL BE INCLUDED IN THE COST PER SQ YD OF THE SUB-BASE GRANULAR MATERIAL, TY B 8".
 2. SEE GENERAL NOTES FOR UNDERCUT LOCATIONS.

BITUMINOUS MIXTURE REQUIREMENT

ITEM	AC TYPE	VOIDS	RAP %
BITUMINOUS CONCRETE SURFACE COURSE, SUPERPAVE, MIX "D", N50	PG 64-22	4% @ 50 Gyr.	15
BITUMINOUS CONCRETE BINDER COURSE, SUPERPAVE, IL-19, N50	PG 58-22	4% @ 50 Gyr.	25
BITUMINOUS CONCRETE SURFACE COURSE, SUPERPAVE, MIX "D", N70	PG 64-22	4% @ 70 Gyr.	10
POLYMERIZED LEVELING BINDER (MACHINE METHOD), SUPERPAVE, IL-4.75, N50	SBS/SBR PG 76-28	2.5% @ 50 Gyr.	0
BITUMINOUS CONCRETE BINDER COURSE, SUPERPAVE, IL-19, N70	PG 64-22	4% @ 70 Gyr.	15
LEVELING BINDER (MACHINE METHOD), SUPERPAVE, N70	PG 64-22	4% @ 70 Gyr.	10
BITUMINOUS SHOULDERS SUPERPAVE 8"	PG 58-22	2% @ 30 Gyr.	50

PFEIFFER ROAD PAVEMENT DESIGN INFORMATION

STRUCTURAL DESIGN TRAFFIC:	YEAR 2020
PV= 3,688	SU= 144 MU= 0
ROAD/STREET CLASSIFICATION:	CLASS 2
P= 50%	S= 50% M= 50%
TRAFFIC FACTOR:	ACTUAL TF= 0.16 AC TYPE= 10
	MINIMUM TF= 0.13
PG GRADE:	BINDER= SURFACE=
SUBGRADE SUPPORT RATING:	
SSR=	(STA TO STA)
SSR=	(STA TO STA)

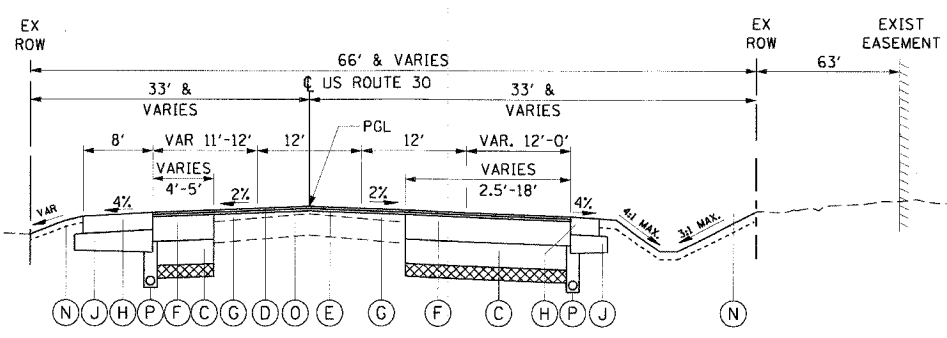

PROPOSED TYPICAL CROSS SECTION
U.S. ROUTE 30 - STA. 297+55.84 TO STA. 301+16.66

REVISIONS	NAME	DATE

ILLINOIS DEPARTMENT OF TRANSPORTATION
PFEIFFER ROAD IMPROVEMENT
TYPICAL SECTIONS

SCALE: NTS
DATE: JUNE 06, 2005

DRAWN BY: Njh
DESIGNED BY: Njh
CHECKED BY: RMG