

FAI ROUTE	SECTION	COUNTY	TOTAL SHEETS	SHEET NO.
64	82-6K-1	ST. CLAIR	188	98

CONTRACT NO.: 76815
SHEET NO 1 OF 9

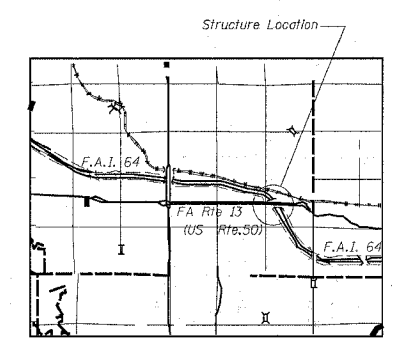

LOCATION PLAN
SN 082-0179

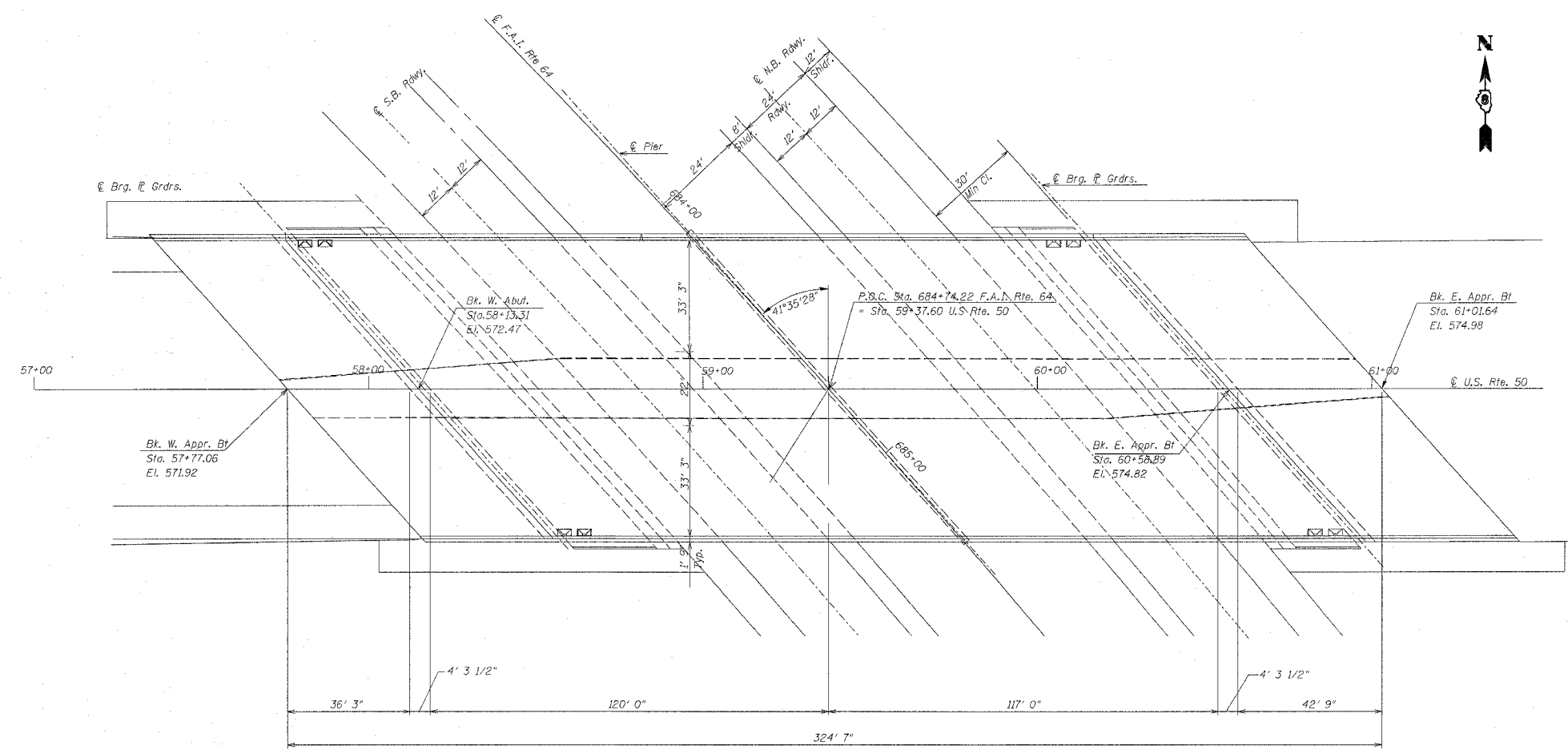
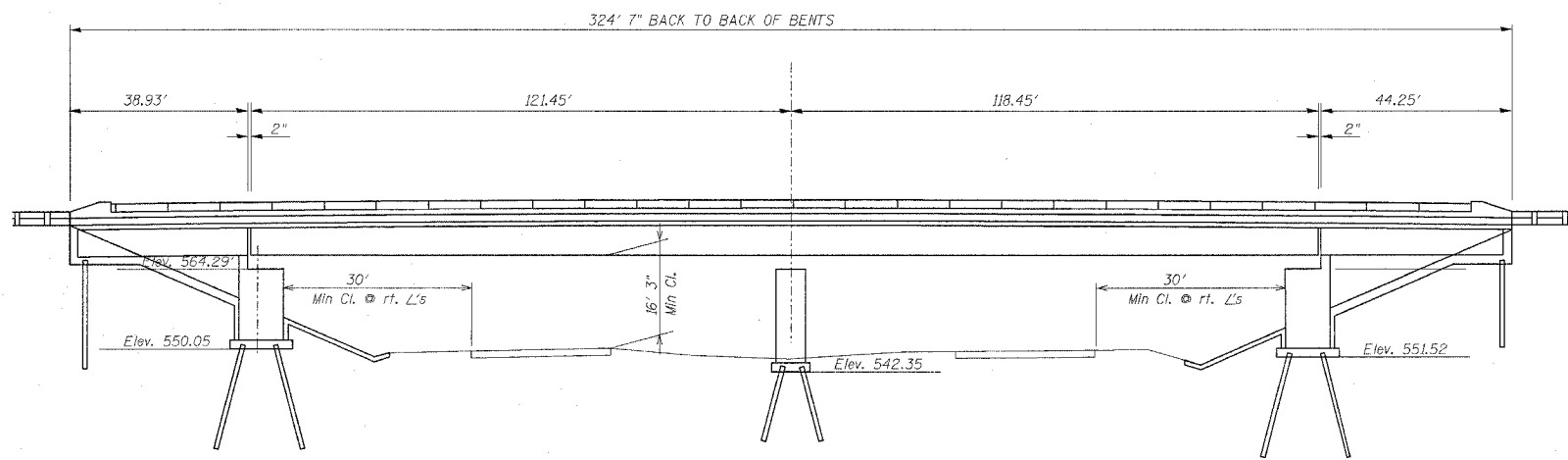
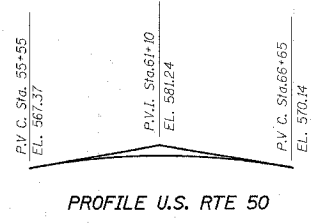

PROFILE U.S. RTE 50

EXIST. CURVE CL64-1
PI STA. 677+13.64
 $\Delta = 43^\circ 33' 02''$ (RT)
T = 1525.87'
R = 3819.72'
L = 2903.37'
E = 293.49'

ALL DIMENSIONS ARE IN mm
UNLESS DESIGNATED OTHERWISE

REVISIONS	
NAME	DATE

ILLINOIS DEPARTMENT OF TRANSPORTATION
STRUCTURE REPAIR DETAILS
GENERAL PLAN
SN 082-0179
FAI ROUTE 64
SECTION 82-6K-1
ST. CLAIR COUNTY
DRAWN BY:

PLOT DATE: 7/1/2005

4/10/2005
 7/1/2005
 c:\projects\76815\plan\bridge-repair.dgn
 REF-
 REF-