

| FAI ROUTE | SECTION | COUNTY | TOTAL SHEETS | SHEET NO |
|---------------------------|---------|-----------|--------------|----------|
| 64 | 82-6K-1 | ST. CLAIR | 188 | 82 |
| STA. _____ TO STA. _____ | | | | |
| CONTRACT NO.: 76796 70B15 | | | | |

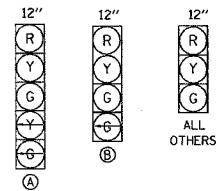

EXISTING AND PROPOSED TRAFFIC SIGNAL FACES

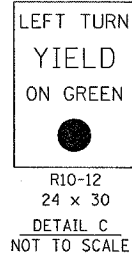

DETAIL E NOT TO SCALE

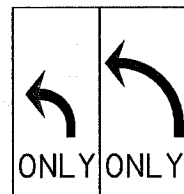

36" x 30" DETAIL D NOT TO SCALE

| | |
|---------------------------|------|
| PLAN | DATE |
| SURVEYED | |
| PLOTTED | |
| CHECKED | |
| BY | |
| NO. OF SHEETS | |
| NO. OF SHEETS CHECKED | |
| NO. OF SHEETS NOT CHECKED | |
| ADD. FILE NAME | |

MATCHLINE STA. 61+88.5

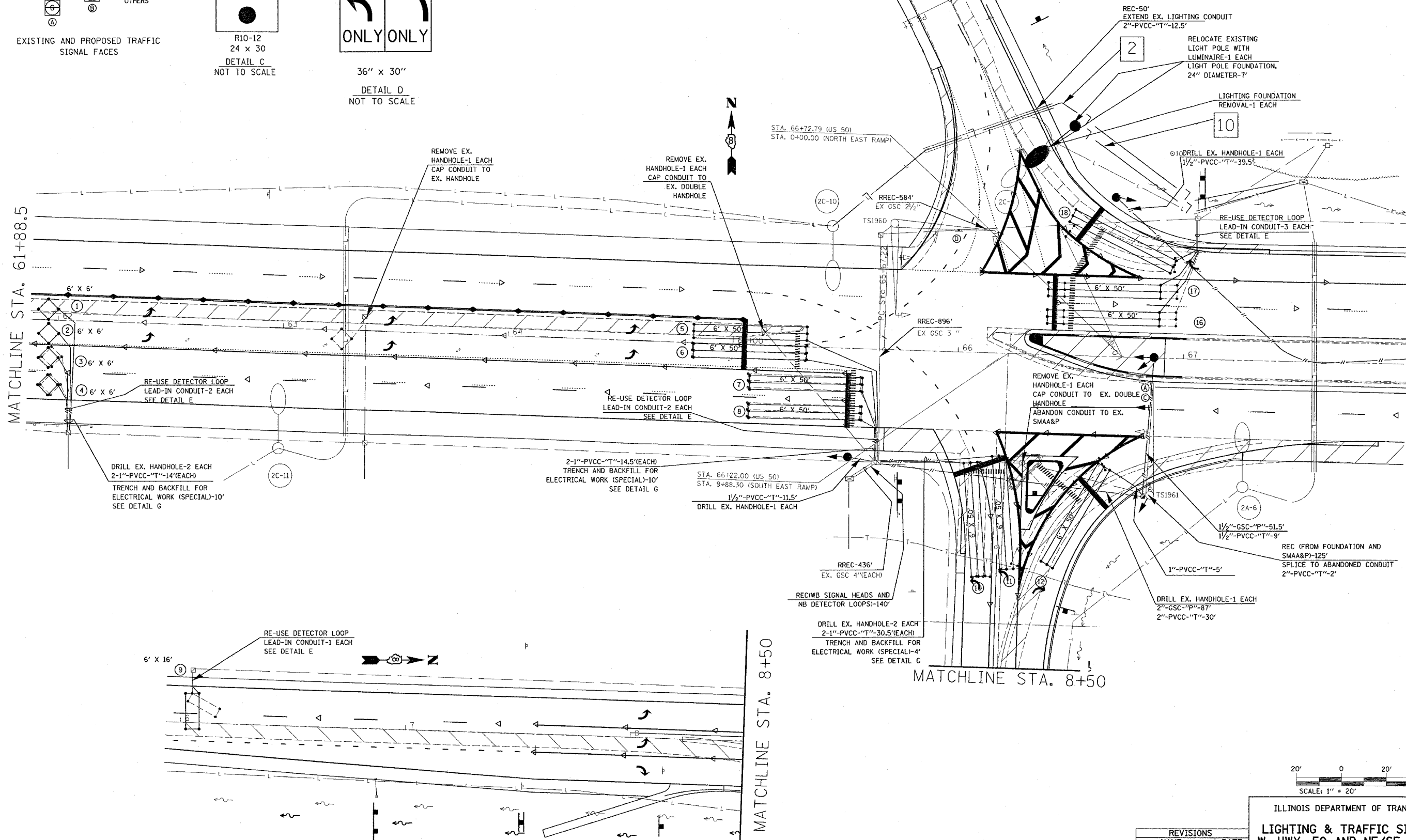

MATCHLINE STA. 8+50

MATCHLINE STA. 8+50

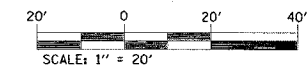

| REVISIONS | |
|-----------|------|
| NAME | DATE |
| | |
| | |
| | |
| | |
| | |

ILLINOIS DEPARTMENT OF TRANSPORTATION
LIGHTING & TRAFFIC SIGNAL PLAN
 W. HWY. 50 AND NE/SE I-64 RAMP
 FAI 64
 SECTION 82-6K-1
 ST. CLAIR COUNTY

DRAWN BY:
 PLOT DATE: J/1/2005

DATE: 7/1/2005
 PROJECT: 76796 70B15
 REF: 487