

FILE NO.	SECTION	COUNTY	TOTAL SHEETS	SHEET NO.
64	82+6K-1	ST. CLAIR	188	68
STA. 4+00		TO STA. 9+50		
CONTRACT NO.: 76815				

PLAN	EXISTS	DATE
NO. _____	NO. _____	NO. _____
BY _____	BY _____	BY _____
DATE _____	DATE _____	DATE _____

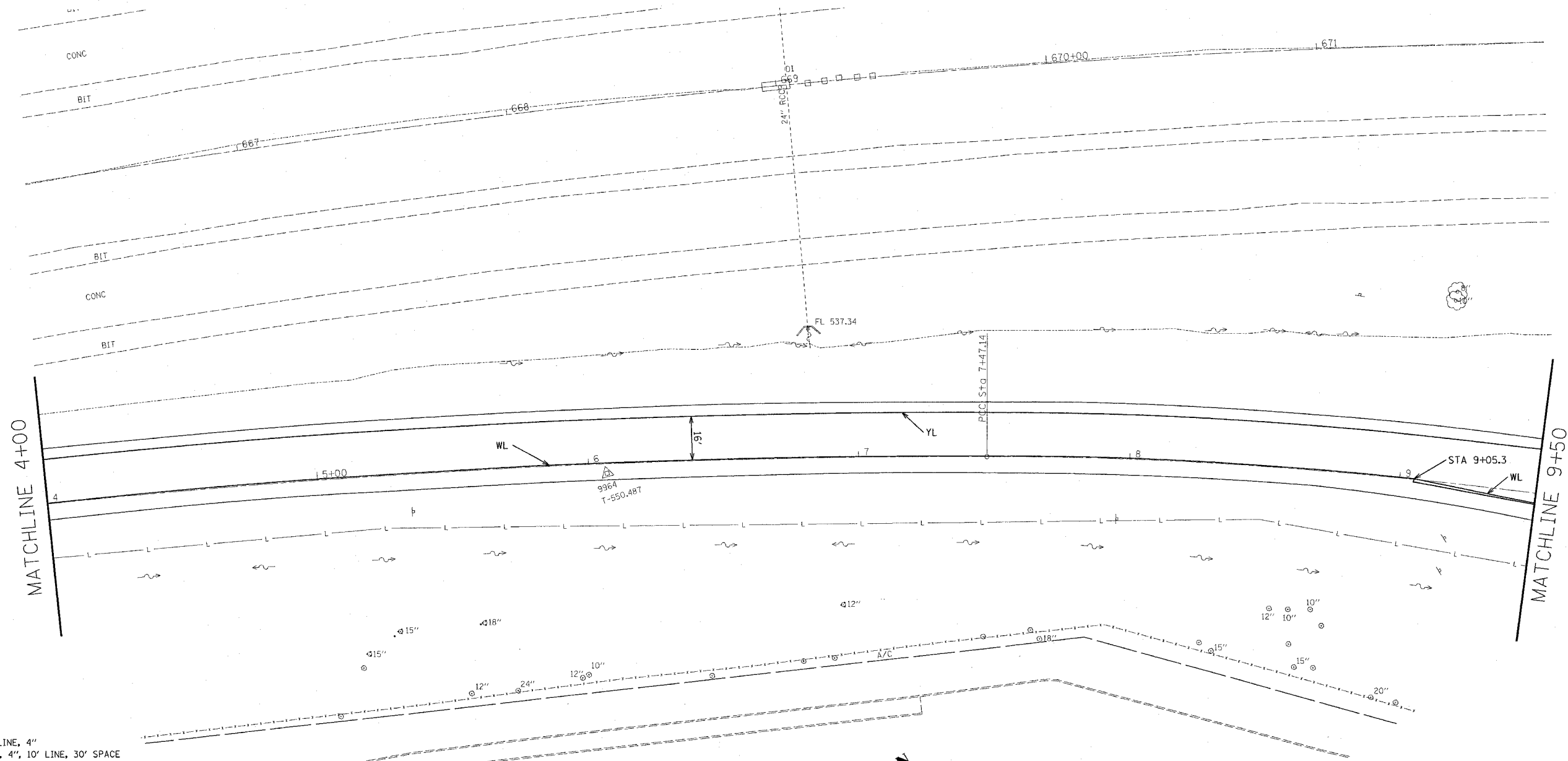

**PAVEMENT MARKING LEGEND**

- WL - WHITE THERMOPLASTIC LINE, 4"
- YL - YELLOW THERMOPLASTIC LINE, 4"
- WL8 - WHITE THERMOPLASTIC LINE - 8"
- DYL - DOUBLE YELLOW THERMOPLASTIC LINE, 4"
- WSD - WHITE THERMOPLASTIC SKIP-DASH, 4", 10' LINE, 30' SPACE
- 2-6WSD - WHITE THERMOPLASTIC SKIP-DASH, 4", 2' LINE, 6' SPACE
- WYT - WHITE THERMOPLASTIC YIELD TRIANGLES, 2' W x 3' H
- WC10 - WHITE THERMOPLASTIC CHEVRONS, 12", 10' SPACE
- WD10 - WHITE THERMOPLASTIC DIAGONALS, 12" 10' SPACE
- WD15 - WHITE THERMOPLASTIC DIAGONALS, 12" 15' SPACE
- WD20 - WHITE THERMOPLASTIC DIAGONALS, 12", 20' SPACE
- YD20 - YELLOW THERMOPLASTIC DIAGONALS, 12", 20' SPACE
- WSB - WHITE THERMOPLASTIC STOP BAR, 24"
- LTA - WHITE THERMOPLASTIC LEFT TURN ARROW
- RTA - WHITE THERMOPLASTIC RIGHT TURN ARROW
- WTL - WHITE THERMOPLASTIC LETTERS
- PWL - WHITE POLYUREA LINE TYPE 1, 4"
- PYL - YELLOW POLYUREA LINE TYPE 1, 4"
- PDYL - DOUBLE YELLOW POLYUREA LINE TYPE 1, 4"
- PWSD - WHITE POLYUREA SKIP-DASH, 4", TYPE 1, 10' LINE, 30' SPACE
- PYD20 - YELLOW POLYUREA DIAGONALS, TYPE 1, 12", 20' SPACE
- PLTA - WHITE POLYUREA, SPECIAL, LEFT TURN ARROW
- PRTA - WHITE POLYUREA, SPECIAL, RIGHT TURN ARROW
- OC80 - ONE-WAY CRYSTAL, 80' CENTERS
- OC40 - ONE-WAY CRYSTAL, 40' CENTERS
- OC20 - ONE-WAY CRYSTAL, 20' CENTERS
- OA40 - ONE-WAY AMBER, 40' CENTERS
- OA20 - ONE-WAY AMBER, 20' CENTERS
- TA40 - TWO-WAY AMBER, 40' CENTERS
- TA20 - TWO-WAY AMBER, 20' CENTERS
- OCB80 - ONE-WAY CRYSTAL, BRIDGE, 80' CENTERS
- OCB40 - ONE-WAY CRYSTAL, BRIDGE, 40' CENTERS
- OAB40 - ONE-WAY AMBER, BRIDGE, 40' CENTERS
- OAB20 - ONE-WAY AMBER, BRIDGE, 20' CENTERS
- TAB20 - TWO-WAY AMBER, BRIDGE, 20' CENTERS

EXIST. CURVE W50RNW.C1  
 PI STA. = 3+75.19  
 $\Delta = 13^\circ 01' 26''$  (RT)  
 $D = 1^\circ 44' 35''$   
 $R = 3,286.89'$   
 $T = 375.19'$   
 $L = 747.14'$   
 $E = 21.34'$   
 $e = \text{---}$   
 T.R. =  $\text{---}$   
 S.E. RUN =  $\text{---}$   
 P.C. STA. = 0+00.00  
 P.T. STA. = 7+47.14

EXIST. CURVE W50RNW.C2 BIT  
 PI STA. = 9+32.71  
 $\Delta = 12^\circ 56' 05''$  (RT)  
 $D = 3^\circ 30' 00''$   
 $R = 1,637.02'$   
 $T = 185.57'$   
 $L = 369.56'$   
 $E = 10.48'$   
 $e = \text{---}$   
 T.R. =  $\text{---}$   
 S.E. RUN =  $\text{---}$   
 P.C. STA. = 7+47.14  
 P.T. STA. = 11+16.70

\*SEE DETAILS FOR THE APPLICATION OF PRISMATIC CURB REFLECTORS AND POLYUREA PAVEMENT MARKING TYPE 1-CURB AND POLYUREA PAVEMENT MARKING TYPE 1-RAISED MEDIAN

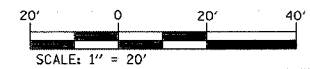

REVISIONS	
NAME	DATE

ILLINOIS DEPARTMENT OF TRANSPORTATION  
**PAVEMENT MARKING**  
**NW RAMP**

FAI ROUTE 64  
 SECTION 82-6K-1  
 ST. CLAIR COUNTY

DRAWN BY: \_\_\_\_\_  
 PLOT DATE: \_\_\_\_\_

DATE-TIME  
 REF: 8/16/05 10:45