

FILE NO.	SECTION	COUNTY	TOTAL SHEETS	SHEET NO.
64	82-6K-1	ST. CLAIR	188	40
STA. 8+00 NE RAMP		TO STA. 12+50 NE RAMP		
CONTRACT NO.: 76815				

PLAN	SURVEYED	DATE
NOTE BOOK	PLOTTED	
NO. _____	BY _____	
	DATE _____	
	BY _____	
	DATE _____	
	BY _____	
	DATE _____	

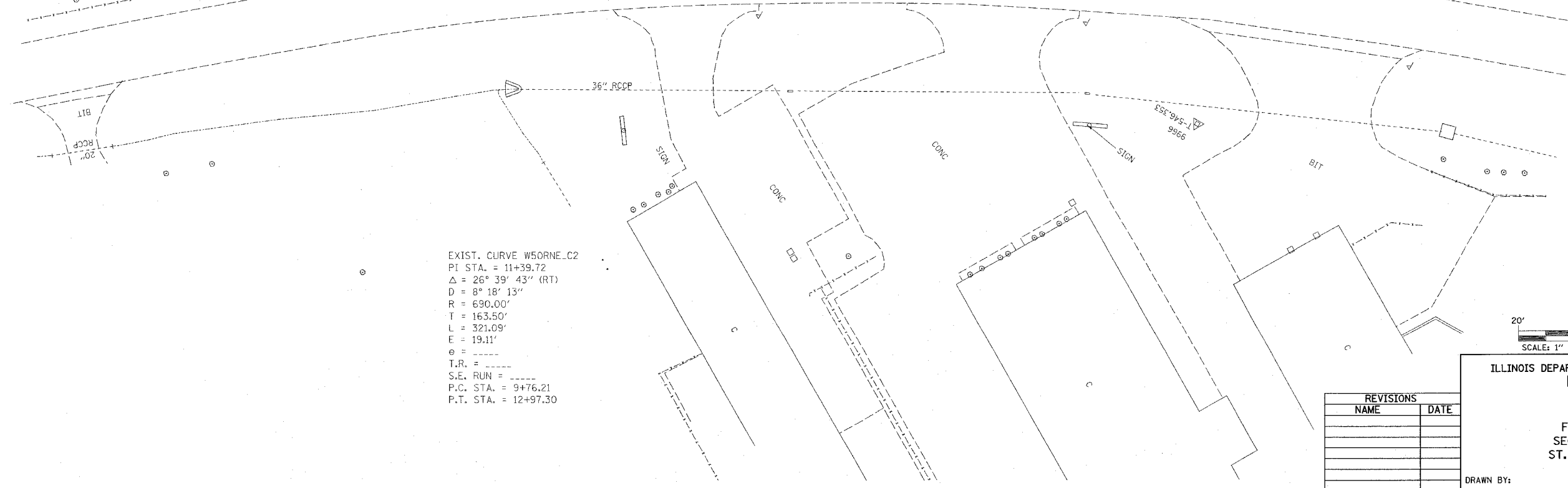

EXIST. CURVE W50RNE.C2
 PI STA. = 11+39.72
 $\Delta = 26^\circ 39' 43''$ (RT)
 $D = 8^\circ 18' 13''$
 $R = 690.00'$
 $T = 163.50'$
 $L = 321.09'$
 $E = 19.11'$
 $e =$
 $T.R. =$
 $S.E. RUN =$
 P.C. STA. = 9+76.21
 P.T. STA. = 12+97.30

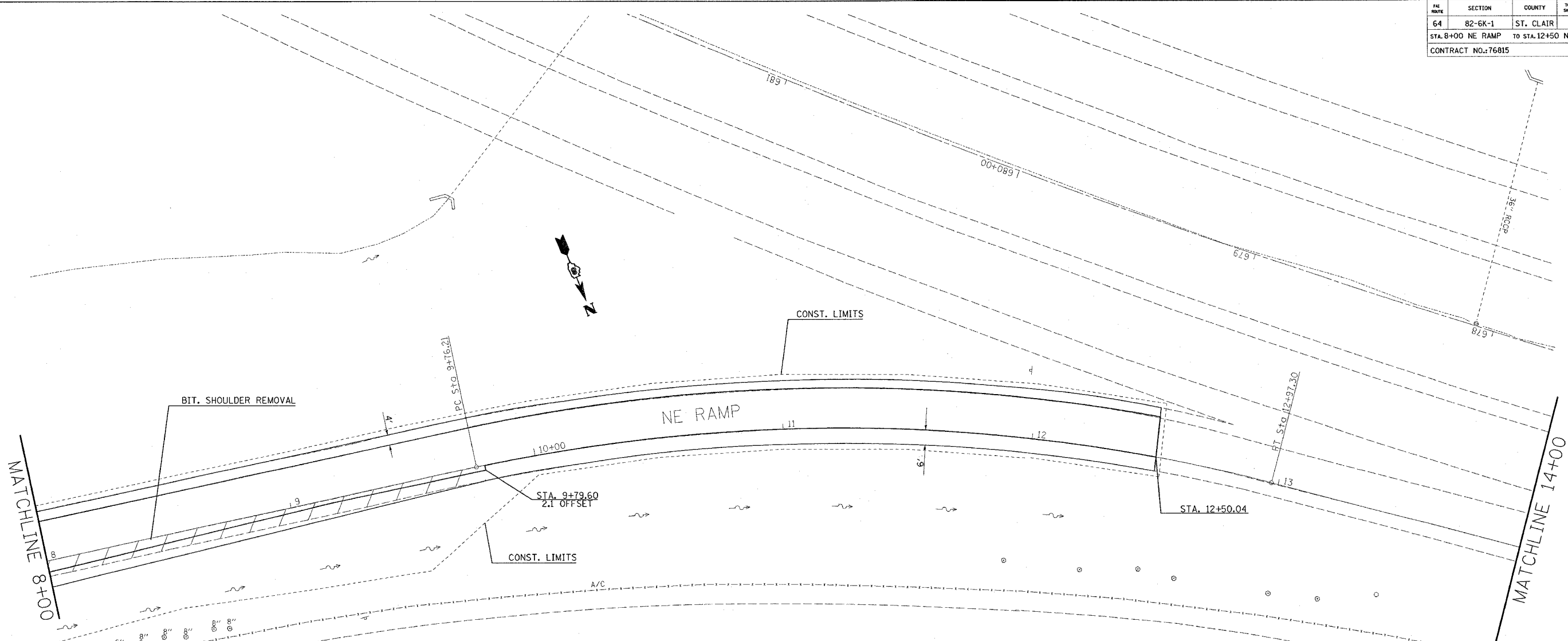
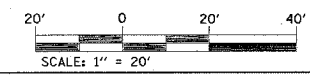

REVISIONS	
NAME	DATE

ILLINOIS DEPARTMENT OF TRANSPORTATION
PLAN VIEW
NE RAMP
 FAI ROUTE 64
 SECTION 82-6K-1
 ST. CLAIR COUNTY
 DRAWN BY:
 PLOT DATE: 7/1/2005

4/20/05
 7/1/2005
 c:\projects\76815\plan\p1406694a.dgn
 REF: 112 1000 6000 4
 REF: 112 1000 6000 4