

FAI ROUTE	SECTION	COUNTY	TOTAL SHEETS	SHEET NO.
64	82-6K-1	ST. CLAIR	188	38
STA. 14+00 SW RAMP TO STA. 14+10.29 SW RAMP				
CONTRACT NO.: T6815				

EXIST. CURVE W5ORSE_C1
 PI STA. = 2+00.50
 $\Delta = 29^\circ 11' 26''$ (RT)
 $D = 7^\circ 26' 28''$
 $R = 770.00'$
 $T = 200.50'$
 $L = 392.29'$
 $E = 25.68'$
 $e =$
 $T.R. =$
 $S.E. RUN =$
 $P.C. STA. = 0+00.00$
 $P.T. STA. = 3+92.29$

9970
 T-552.329

PLAN	DATE
NO. _____	_____
BY _____	_____
DESIGNED BY _____	_____
CHECKED BY _____	_____
DATE PLOTTED _____	_____
ALIGNED FILE NAME _____	_____
ANNOTATED FILE NAME _____	_____
ADD FILE NAME _____	_____

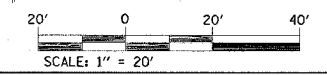
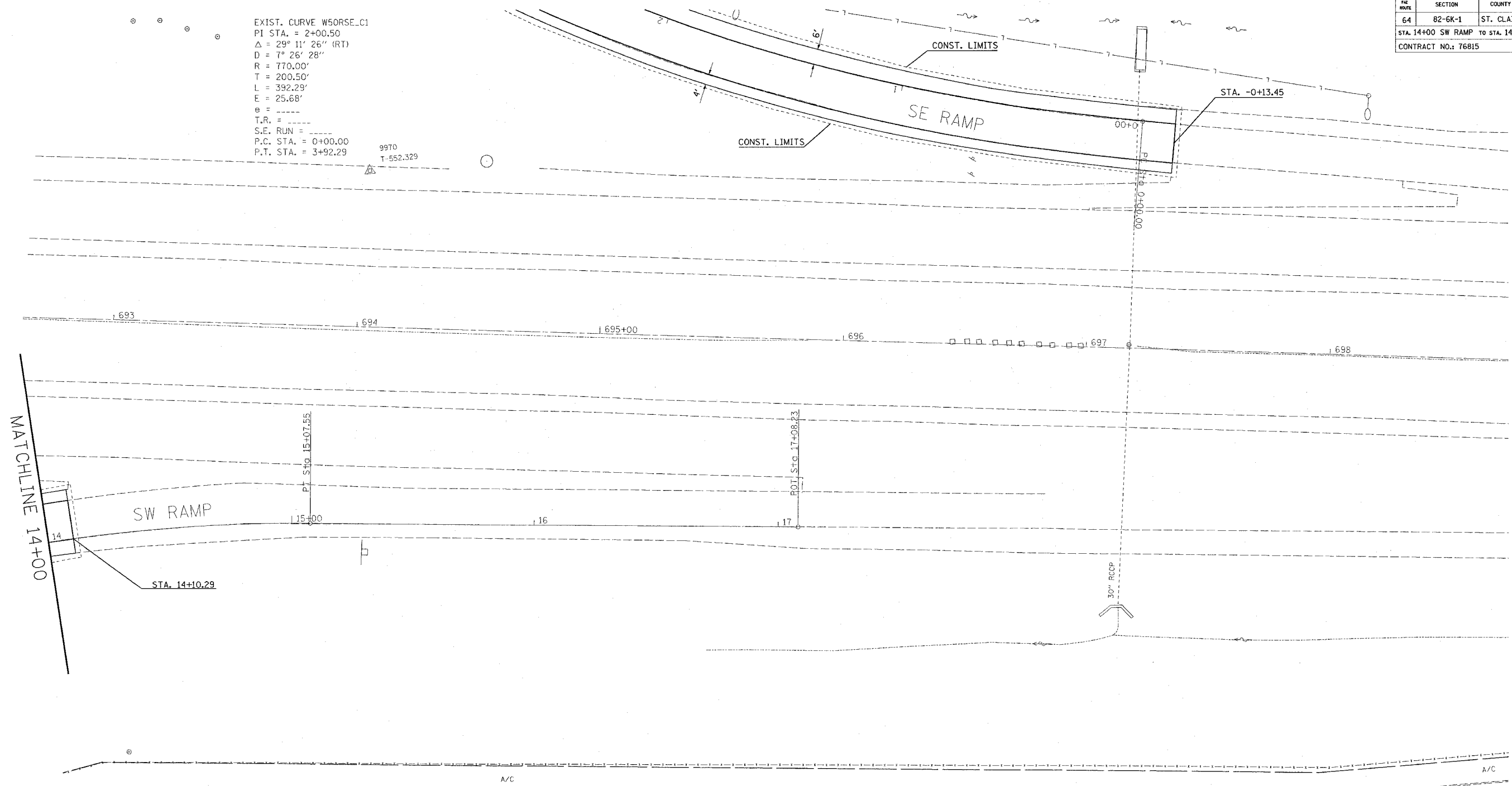

REVISIONS	
NAME	DATE

ILLINOIS DEPARTMENT OF TRANSPORTATION
PLAN VIEW
SW RAMP
 FAI ROUTE 64
 SECTION 82-6K-1
 ST. CLAIR COUNTY
 DRAWN BY:
 PLOT DATE: 7/1/2005

STATE: IL
 COUNTY: ST. CLAIR
 PROJECT: 82-6K-1
 SHEET: 38 OF 188