

FAI ROUTE	SECTION	COUNTY	TOTAL SHEETS	SHEET NO.
64	82-6K-1	ST. CLAIR	188	35
STA. 9+50 NW RAMP TO STA. 15+50 NW RAMP				
CONTRACT NO.: 76815				

PLAN	DATE	BY
DESIGNED		
CHECKED		
APPROVED		
NO. _____		
ADD. FILE NAME		

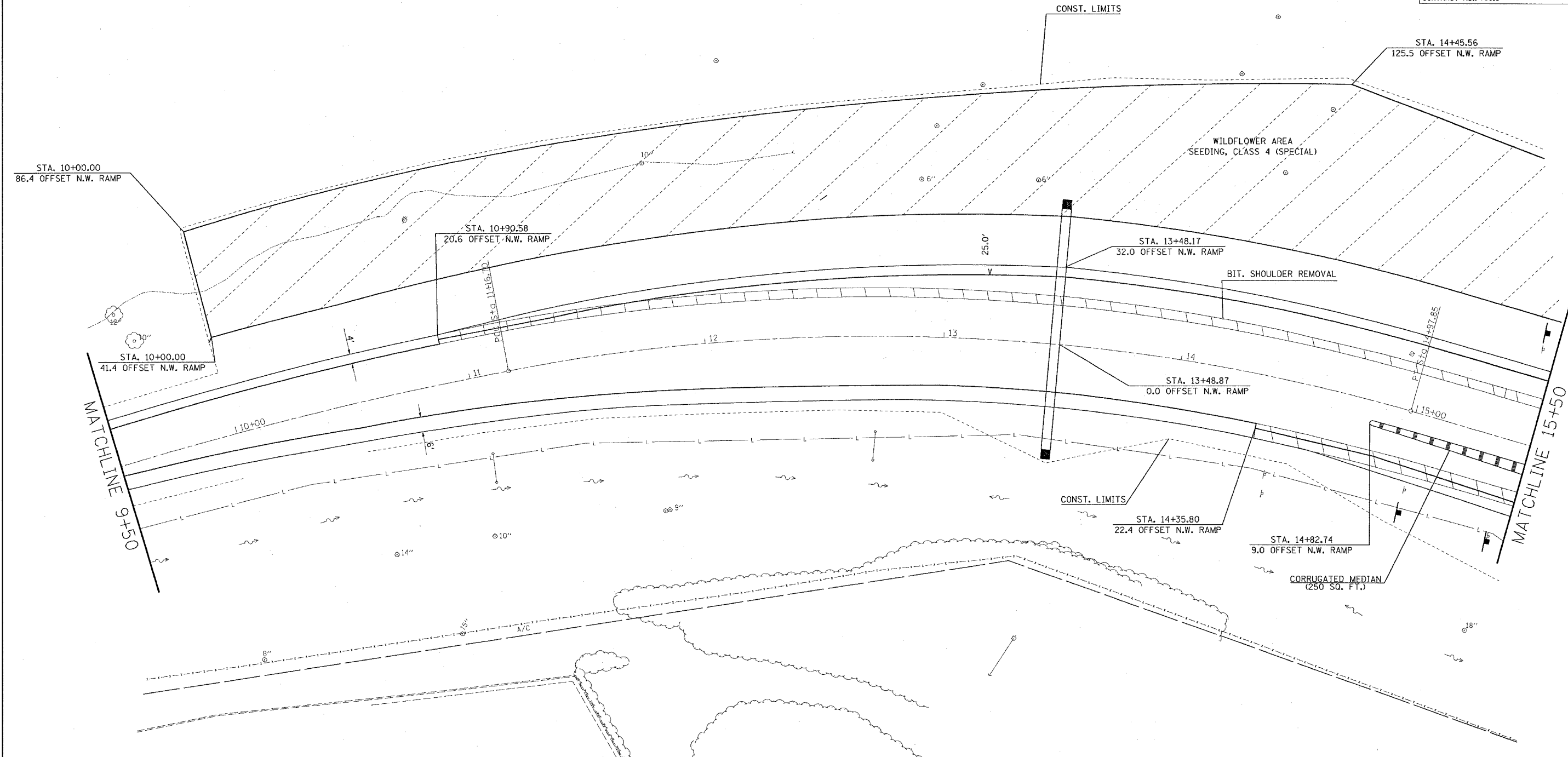

EXIST. CURVE W50RNW_C3
 PI STA. = 13+10.80
 $\Delta = 26^\circ 40' 50''$ (RT)
 $D = 7^\circ 00' 00''$
 $R = 818.51'$
 $T = 194.10'$
 $L = 381.15'$
 $E = 22.70'$
 $e = \text{-----}$
 $T.R. = \text{-----}$
 $S.E. RUN = \text{-----}$
 $P.C. STA. = 11+16.70$
 $P.T. STA. = 14+97.85$

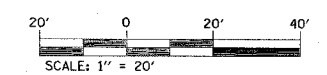

REVISIONS	
NAME	DATE

ILLINOIS DEPARTMENT OF TRANSPORTATION
**PLAN VIEW
 NW RAMP**
 FAI ROUTE 64
 SECTION 82-6K-1
 ST. CLAIR COUNTY
 DRAWN BY:
 PLOT DATE: 1/1/2005

9/15/05
 C:\pwork\82-6K-1\plan\p17.dwg
 REF: p17.dwg
 REF: p17.dwg