

PROP. ACCESS ROAD

F.A. RTE.	SECTION	COUNTY	TOTAL SHEETS	SHEET NO.
103	27-1R	ST. CLAIR	382	347A
STA.		TO STA.		
FED. ROAD DIST. NO.		ILLINOIS FED. AID PROJECT		
CONTRACT NO. 76300				

FINAL SURVEY	DATE
BY	
DESIGNED	
NOTED	
TEMPLATE	
AREAS CHECKED	
NO.	

ORIGINAL SURVEY	DATE
BY	
DESIGNED	
NOTED	
TEMPLATE	
AREAS CHECKED	
NO.	

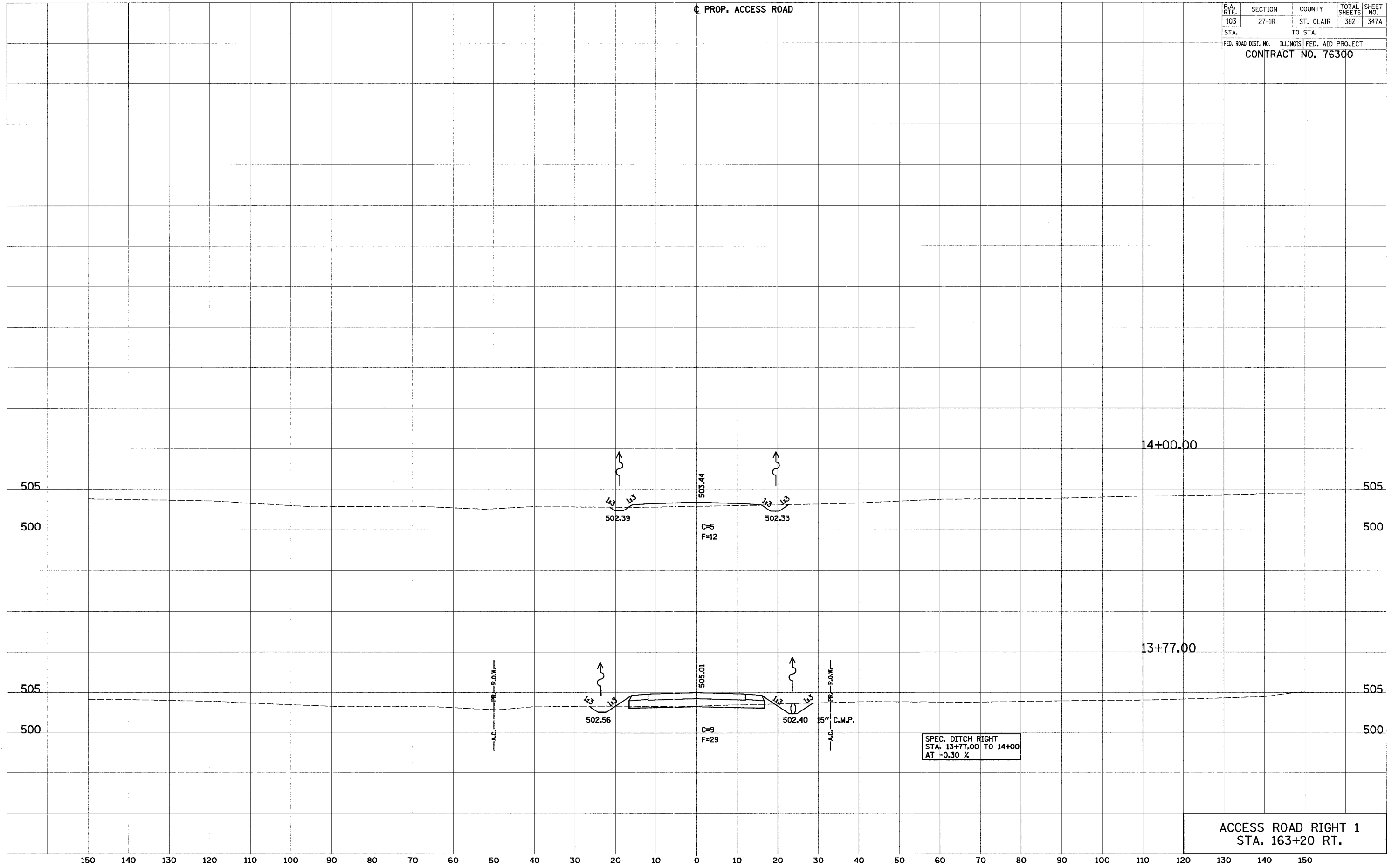

ACCESS ROAD RIGHT 1  
STA. 163+20 RT.