

160 150 140 130 120 110 100 90 80 70 60 50 40 30 20 10 0 10 20 30 40 50 60 70 80 90 100 110 120

F.A. RTE.	SECTION	COUNTY	TOTAL SHEETS	SHEET NO.
103	27-1R	ST. CLAIR	382	250
STA.		TO STA.		
FED. ROAD DIST. NO.		ILLINOIS FED. AID PROJECT		
CONTRACT NO. 76300				

PROP. F.A.P. 103

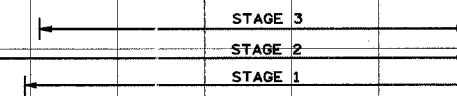

BY	DATE
SUPERVISED	DATE
NOTED	DATE
AREAS CHECKED	

BY	DATE
SUPERVISED	DATE
NOTED	DATE
AREAS CHECKED	

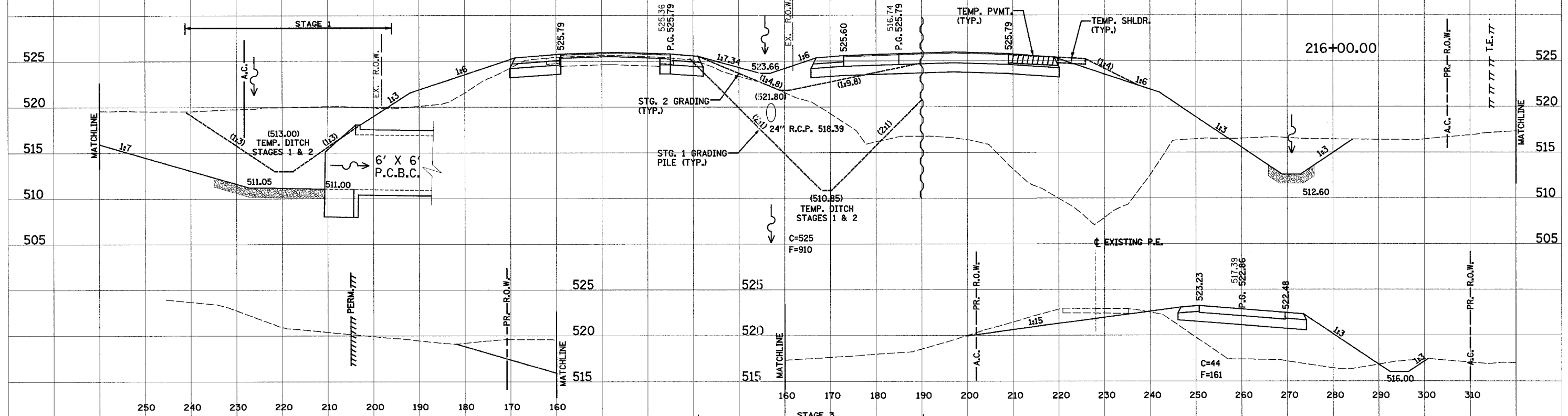

SPEC. DITCH LEFT
STA. 215+94 TO 218+00
AT +0.88 %

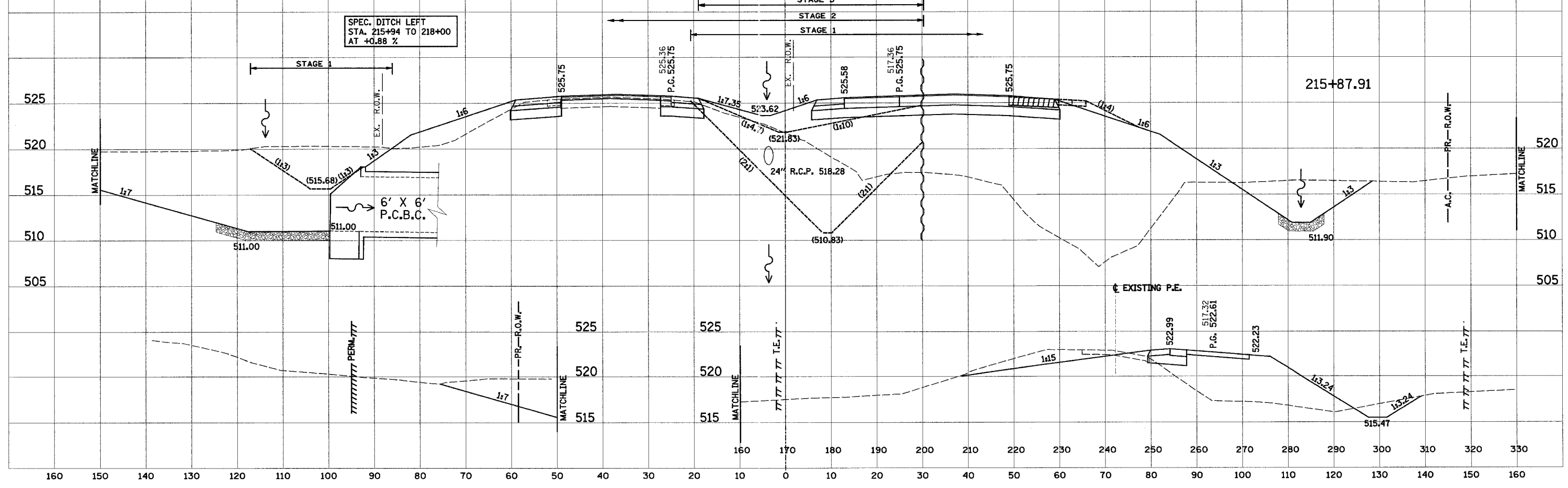

160 150 140 130 120 110 100 90 80 70 60 50 40 30 20 10 0 10 20 30 40 50 60 70 80 90 100 110 120 130 140 150 160