

F.A. RTE.	SECTION	COUNTY	TOTAL SHEETS	SHEET NO.
103	27-1R	ST. CLAIR	382	217
STA.	TO STA.			
FED. ROAD DIST. NO.	ILLINOIS	FED. AID PROJECT		CONTRACT NO. 76300

FINAL SURVEY	DATE
BY	
SURVEYED	
TEMPLATE	
AREAS CHECKED	

ORIGINAL SURVEY	DATE
BY	
SURVEYED	
TEMPLATE	
AREAS CHECKED	

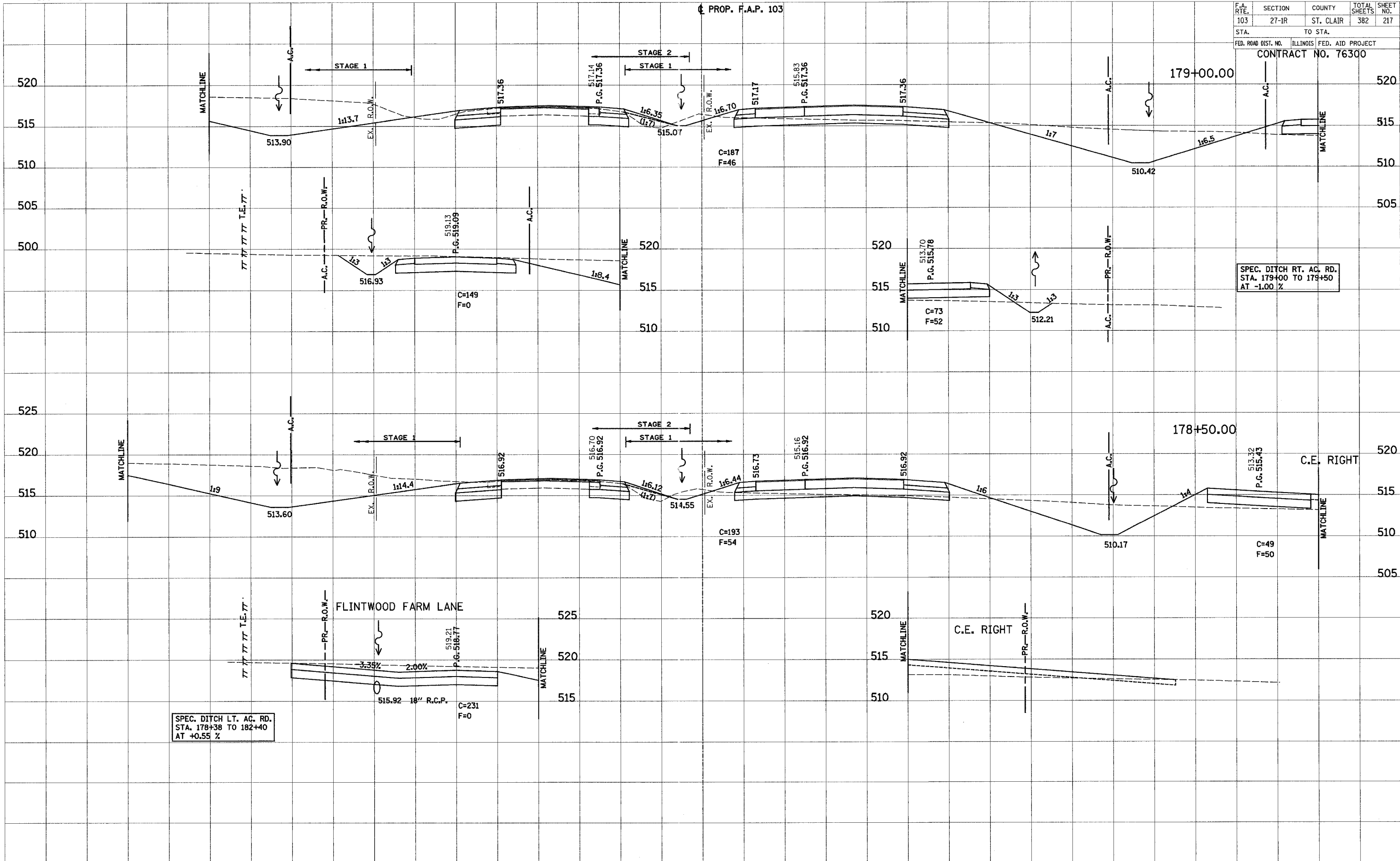

SPEC. DITCH RT. AC. RD. STA. 179+00 TO 179+50 AT -1.00%

SPEC. DITCH LT. AC. RD. STA. 178+38 TO 182+40 AT +0.55%