

F.A. RTE.	SECTION	COUNTY	TOTAL SHEETS	SHEET NO.
103	27-1R	ST. CLAIR	382	169
STA.		TO STA.		
FED. ROAD DIST. NO.		ILLINOIS FED. AID PROJECT		
CONTRACT NO. 76300				

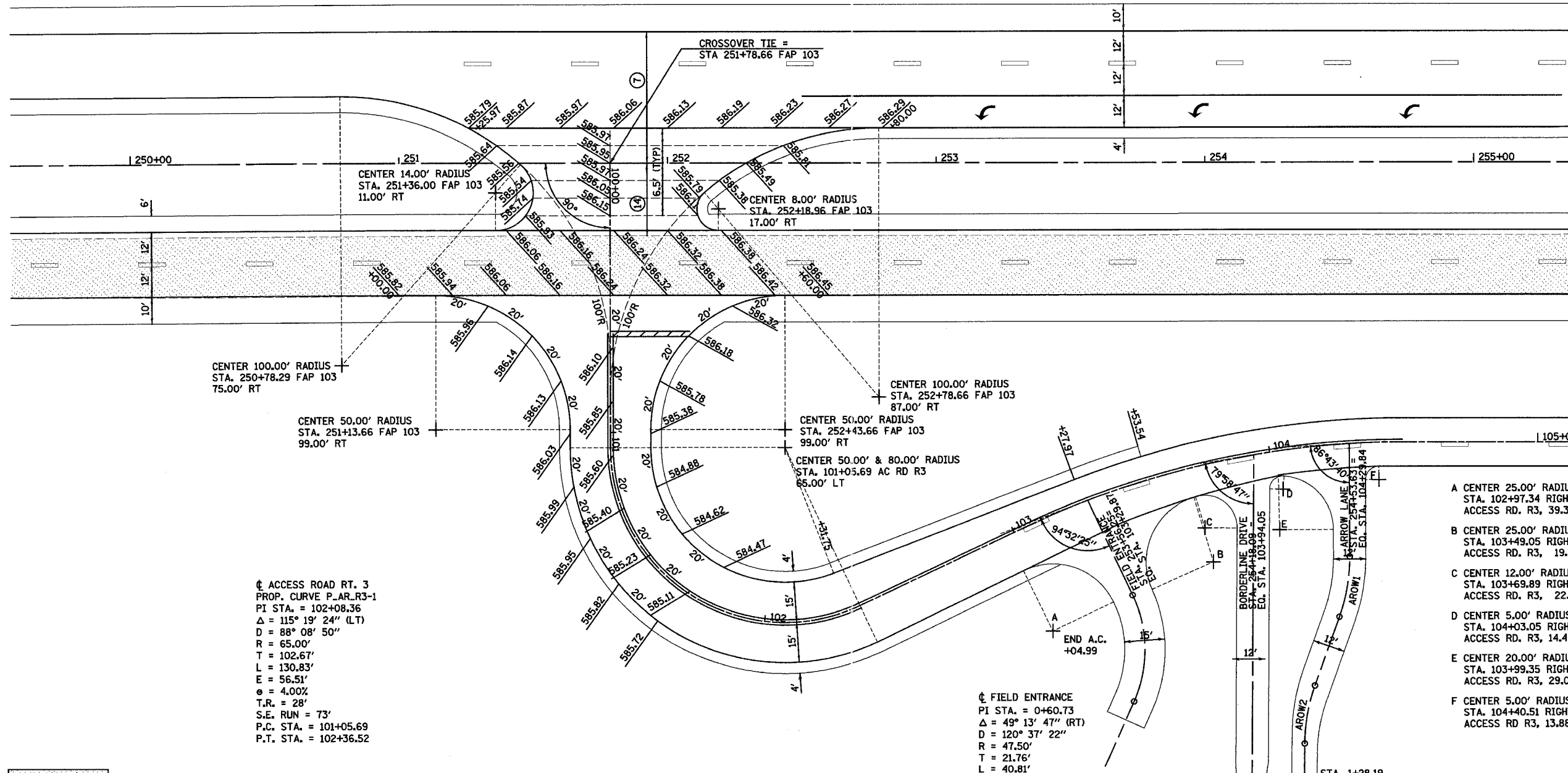

③ ACCESS ROAD RT. 3  
 PROP. CURVE P\_AR\_R3-1  
 PI STA. = 102+08.36  
 Δ = 115° 19' 24" (LT)  
 D = 88° 08' 50"  
 R = 65.00'  
 T = 102.67'  
 L = 130.83'  
 E = 56.51'  
 e = 4.00%  
 T.R. = 28'  
 S.E. RUN = 73'  
 P.C. STA. = 101+05.69  
 P.T. STA. = 102+36.52

④ FIELD ENTRANCE  
 PI STA. = 0+60.73  
 Δ = 49° 13' 47" (RT)  
 D = 120° 37' 22"  
 R = 47.50'  
 T = 21.76'  
 L = 40.81'  
 E = 4.75'  
 P.C. STA. = 0+38.97  
 P.T. STA. = 0+79.78

- A CENTER 25.00' RADIUS  
STA. 102+97.34 RIGHT  
ACCESS RD. R3, 39.38' RT
- B CENTER 25.00' RADIUS  
STA. 103+49.05 RIGHT  
ACCESS RD. R3, 19.75' RT
- C CENTER 12.00' RADIUS  
STA. 103+69.89 RIGHT  
ACCESS RD. R3, 22.87' RT
- D CENTER 5.00' RADIUS  
STA. 104+03.05 RIGHT  
ACCESS RD. R3, 14.40' RT
- E CENTER 20.00' RADIUS  
STA. 103+99.35 RIGHT  
ACCESS RD. R3, 29.00' RT
- F CENTER 5.00' RADIUS  
STA. 104+40.51 RIGHT  
ACCESS RD R3, 13.88' RT

① ARROW LANE  
 PROP. CURVE AROW1  
 PI STA. = 0+53.47  
 Δ = 19° 49' 46" (RT)  
 D = 86° 48' 42"  
 R = 66.00'  
 T = 11.54'  
 L = 22.84'  
 E = 1.00'  
 P.C. STA. = 0+41.93  
 P.T. STA. = 0+64.77

② ARROW LANE  
 PROP. CURVE AROW2  
 PI STA. = 1+02.99  
 Δ = 19° 06' 29" (LT)  
 D = 86° 48' 42"  
 R = 66.00'  
 T = 11.11'  
 L = 22.01'  
 E = 0.93'  
 P.C. STA. = 0+91.88  
 P.T. STA. = 1+13.89

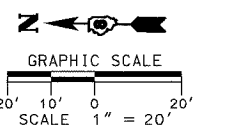

DENOTES EXISTING PAVEMENT

- ⑦ PROPOSED BITUMINOUS CONCRETE PAVEMENT (FULL-DEPTH) SUPERPAVE, 14"
  - ⑭ PROPOSED BITUMINOUS CONCRETE BINDER COURSE, SUPERPAVE, IL - 19.0, N90 - 12-1/2"
- SEE TYPICAL SECTIONS FOR ADDITIONAL INFORMATION

REVISIONS	
NAME	DATE

ILLINOIS DEPARTMENT OF TRANSPORTATION  
**INTERSECTION DETAIL**  
**CROSSOVER STA 251+78.66**  
 F.A.P. 103 (IL. RTE. 13/15)  
 SECTION 27-1R - ST. CLAIR CO.  
 SCALE: 1" = 20'  
 DATE **February 11, 2005**  
 DRAWN BY **KEB**  
 CHECKED BY **RCY**

J:\2005\020505\000\CH\IN\46\INTERACT-INTL\03-05.dwg 3/7/2005 8:32:27 AM