

F.A. RTE.	SECTION	COUNTY	TOTAL SHEETS	SHEET NO.
103	27-1R	ST. CLAIR	382	68
STA. 147+00.00		TO STA. 179+00.00		
FED. ROAD DIST. NO.		ILLINOIS FED. AID PROJECT		
CONTRACT NO. 76300				

PLAN	DATE
NO.	
BY	
REVISIONS	
NO.	
DATE	
BY	
REVISIONS	
NO.	
DATE	
BY	

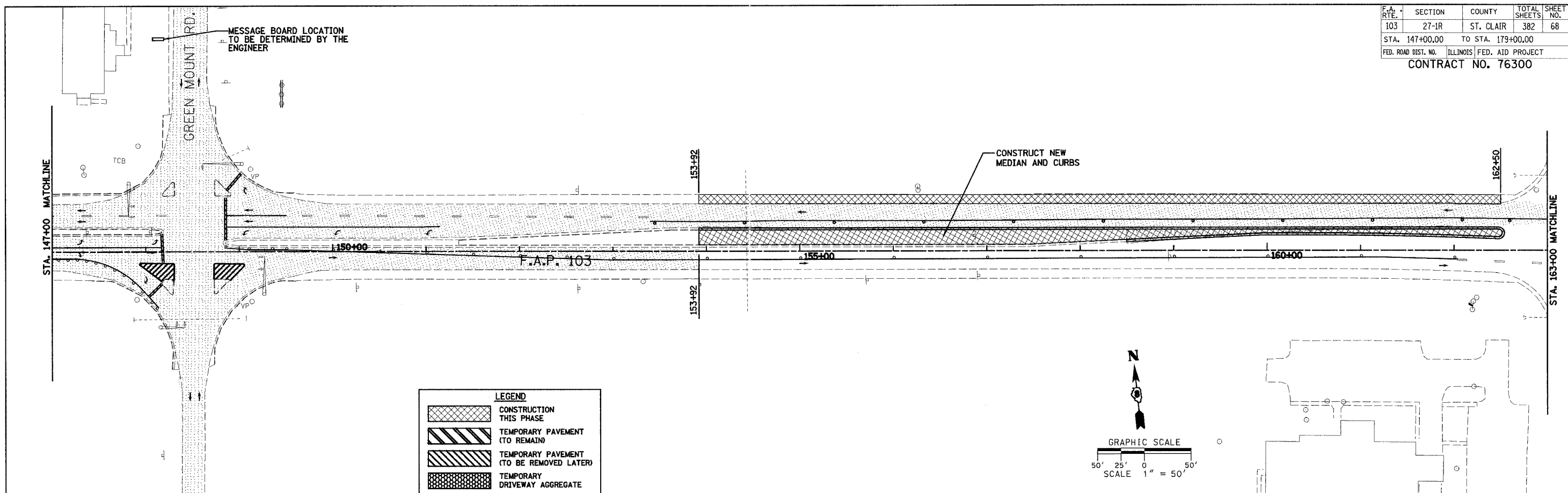

**LEGEND**

	CONSTRUCTION THIS PHASE
	TEMPORARY PAVEMENT (TO REMAIN)
	TEMPORARY PAVEMENT (TO BE REMOVED LATER)
	TEMPORARY DRIVEWAY AGGREGATE
	EXISTING PAVEMENT
	DIRECTION OF TRAFFIC FLOW THIS STAGE
	TYPE III BARRICADE
	DRUM OR BARRICADE W/ STEADY BURN LIGHTS
	TEMPORARY DITCH
	PROPOSED DITCH

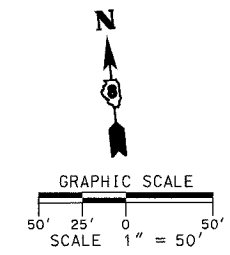

PLAN	DATE
NO.	
BY	
REVISIONS	
NO.	
DATE	
BY	
REVISIONS	
NO.	
DATE	
BY	

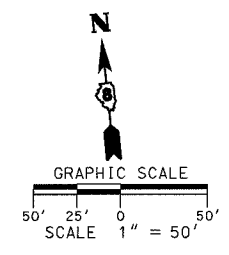
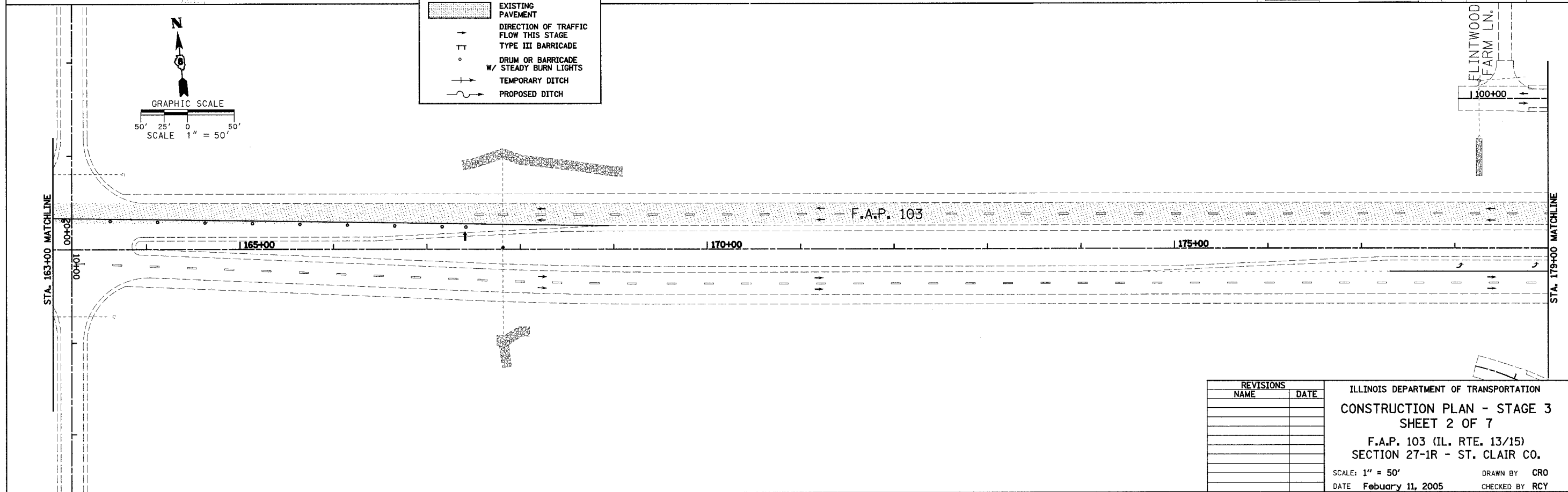

REVISIONS	DATE
NAME	

ILLINOIS DEPARTMENT OF TRANSPORTATION  
**CONSTRUCTION PLAN - STAGE 3**  
**SHEET 2 OF 7**  
 F.A.P. 103 (IL. RTE. 13/15)  
 SECTION 27-1R - ST. CLAIR CO.  
 SCALE: 1" = 50'  
 DATE February 11, 2005  
 DRAWN BY CRO  
 CHECKED BY RCY

J:\2002\020559\0000\civ\vdgm\stage3.const1.dwg 3/9/2005 10:46 PM