

F.A. RTE.	SECTION	COUNTY	TOTAL SHEETS	SHEET NO.
103	27-1R	ST. CLAIR	382	63
STA. 211+00.00		TO STA. 243+00.00		
FED. ROAD DIST. NO. ILLINOIS FED. AID PROJECT				
CONTRACT NO. 76300				

PLAN	SURVEYED	DATE
NOTE BOOK NO.	LOCAL CHECKED	
	RT. OF WAY CHECKED	
	CONTRACT FILE NAME	

PLAN	SURVEYED	DATE
NOTE BOOK NO.	LOCAL CHECKED	
	RT. OF WAY CHECKED	
	CONTRACT FILE NAME	

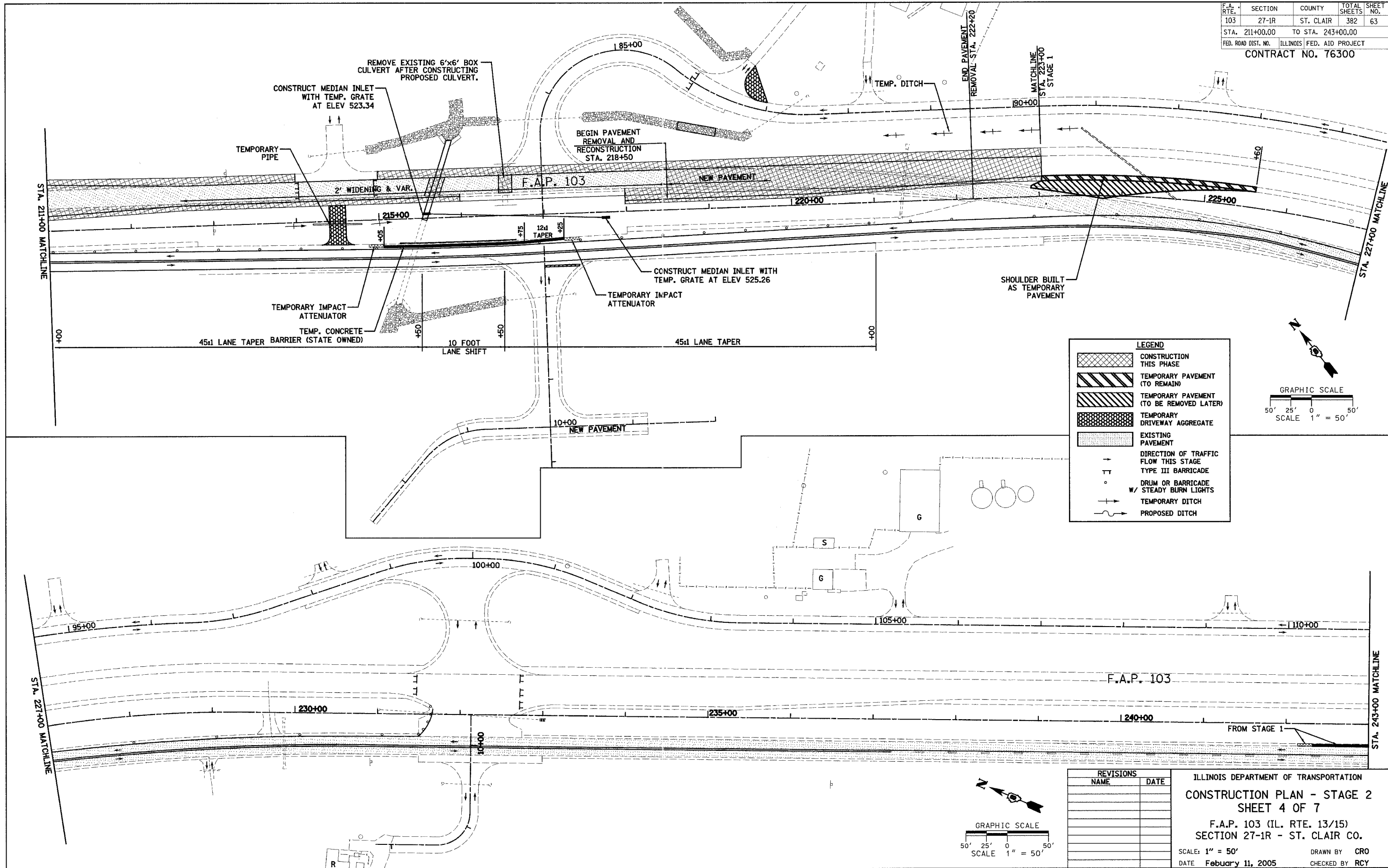

LEGEND

- CONSTRUCTION THIS PHASE
- TEMPORARY PAVEMENT (TO REMAIN)
- TEMPORARY PAVEMENT (TO BE REMOVED LATER)
- TEMPORARY DRIVEWAY AGGREGATE
- EXISTING PAVEMENT
- DIRECTION OF TRAFFIC FLOW THIS STAGE
- TYPE III BARRICADE
- DRUM OR BARRICADE W/ STEADY BURN LIGHTS
- TEMPORARY DITCH
- PROPOSED DITCH

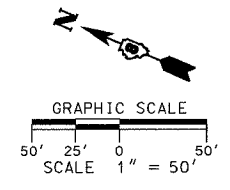
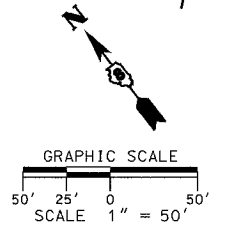

REVISIONS	
NAME	DATE

ILLINOIS DEPARTMENT OF TRANSPORTATION
CONSTRUCTION PLAN - STAGE 2
SHEET 4 OF 7
 F.A.P. 103 (IL. RTE. 13/15)
 SECTION 27-1R - ST. CLAIR CO.
 SCALE: 1" = 50'
 DATE February 11, 2005
 DRAWN BY CRO
 CHECKED BY RCY

J:\2002\020285\0201\cvt\rd\cvt\stage-constr-stage2-03.dgn 2/9/2005 2:42 PM