

F.A. RTE.	SECTION	COUNTY	TOTAL SHEETS	SHEET NO.
103	27-1R	ST. CLAIR	382	56
STA. 211+00.00		TO STA. 243+00.00		
FED. ROAD DIST. NO.	ILLINOIS	FED. AID PROJECT		

CONTRACT NO. 76300

NOTE: CONSTRUCT PROPOSED DITCH FROM STA 210+50 TO 215+50 LT AND PLUG EXISTING 24" PIPE CULVERT AT STA 210+50 LT

NOTE: CONSTRUCT TEMPORARY DITCH FROM STA 221+00 TO 223+50 LT AND PLUG EXISTING 30" PIPE CULVERT AT STA 221+34 LT

PLAN	SURVEYED	DATE
	BY	
	PLOTTED	
	NOTED	
	FILED	
	NO.	

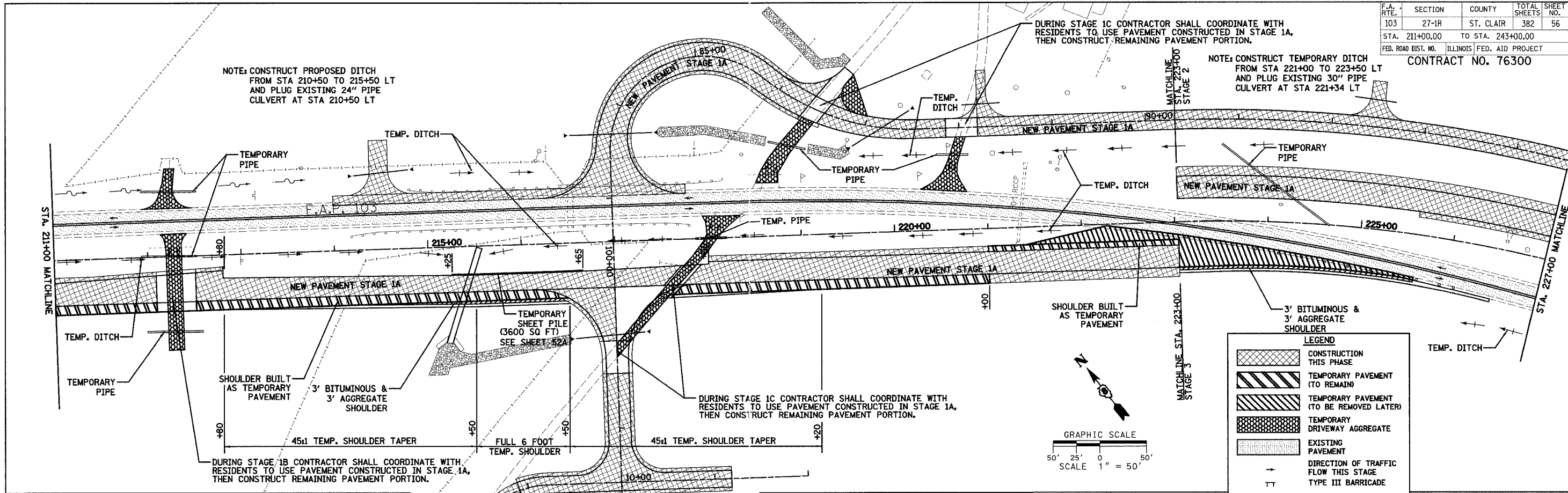

LEGEND

[Cross-hatched pattern]	CONSTRUCTION THIS PHASE
[Diagonal lines /]	TEMPORARY PAVEMENT (TO REMAIN)
[Diagonal lines \]	TEMPORARY PAVEMENT (TO BE REMOVED LATER)
[Stippled pattern]	TEMPORARY DRIVEWAY AGGREGATE
[Dotted pattern]	EXISTING PAVEMENT
[Arrow pointing right]	DIRECTION OF TRAFFIC FLOW THIS STAGE
[T-shaped symbol]	TYPE III BARRICADE
[Circle with cross]	DRUM OR BARRICADE W/ STEADY BURN LIGHTS
[Dashed line]	TEMPORARY DITCH
[Wavy line]	PROPOSED DITCH

PLAN	SURVEYED	DATE
	BY	
	PLOTTED	
	NOTED	
	FILED	
	NO.	

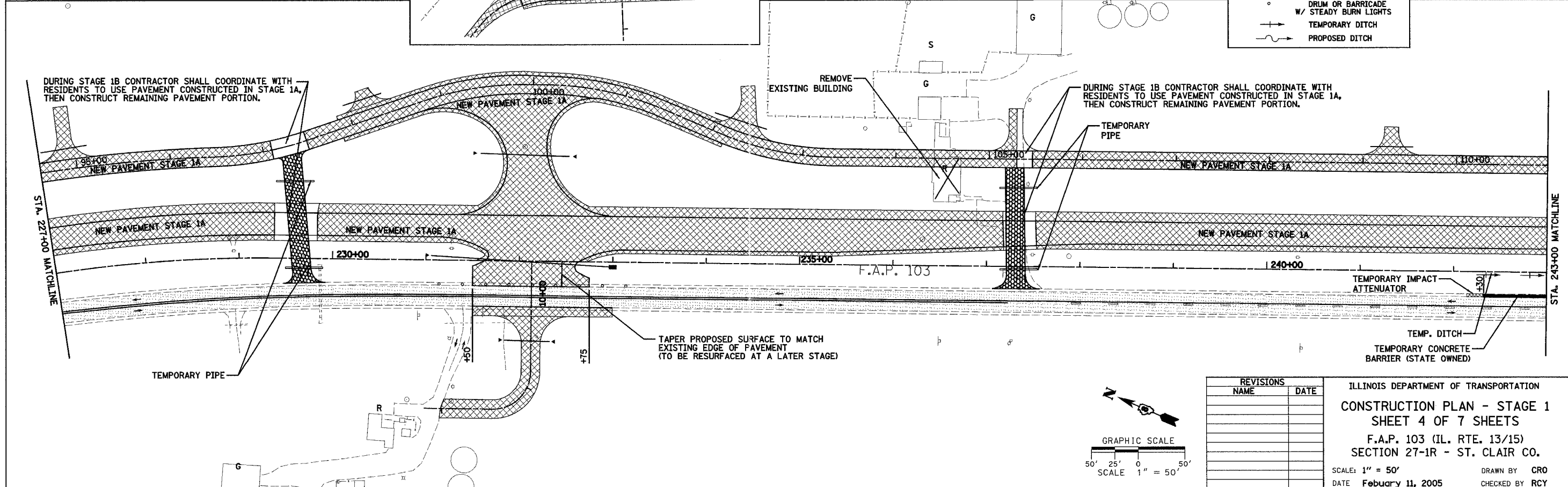

REVISIONS

NAME	DATE

ILLINOIS DEPARTMENT OF TRANSPORTATION
CONSTRUCTION PLAN - STAGE 1
SHEET 4 OF 7 SHEETS
 F.A.P. 103 (IL. RTE. 13/15)
 SECTION 27-1R - ST. CLAIR CO.
 SCALE: 1" = 50'
 DATE: February 11, 2005
 DRAWN BY: CRO
 CHECKED BY: RCY

J:\2005\222585\020501.dwg (1/11/05) 11:03 AM