

F.A.P. RTE.	SECTION	COUNTY	TOTAL SHEETS	SHEET NO.
322	26JI	MARION	6	1

**STATE OF ILLINOIS**  
**DEPARTMENT OF TRANSPORTATION**  
**DIVISION OF HIGHWAYS**  
**PROPOSED**  
**HIGHWAY PLANS**  
**FAP ROUTE 322 (US ROUTE 51)**  
**SECTION 26JI PROJ.NHF-0322(076)**  
**MARION COUNTY**  
**GUARDRAIL & CHANNEL CLEANING**  
 C-97-061-05

FOR INDEX OF SHEETS, SEE SHEET NO. 2

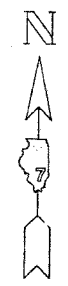
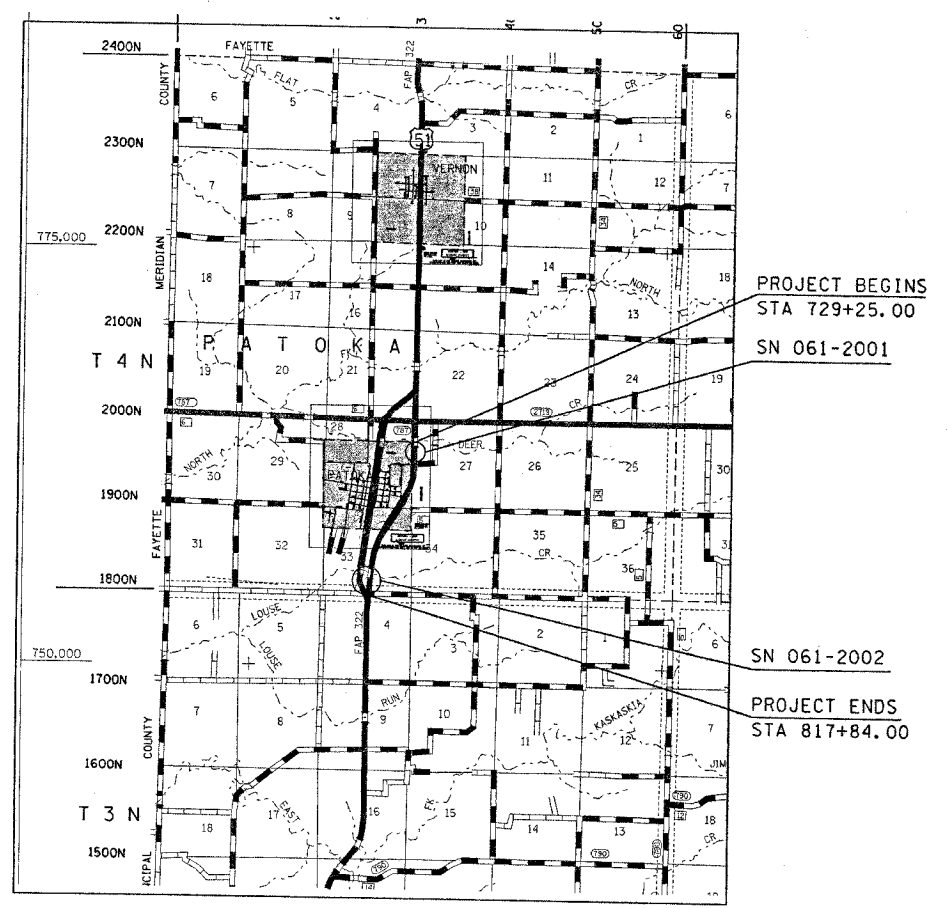

ADT(2003) = 2850

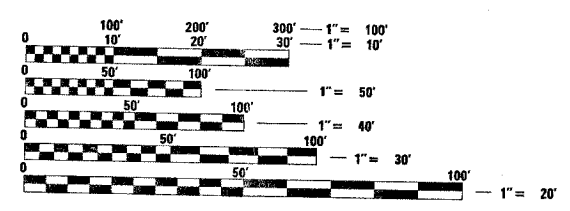

FULL SIZE PLANS HAVE BEEN PREPARED USING STANDARD ENGINEERING SCALES. REDUCED SIZED PLANS WILL NOT CONFORM TO STANDARD SCALES. IN MAKING MEASUREMENTS ON REDUCED PLANS, THE ABOVE SCALES MAY BE USED.

J.U.L.I.E.  
 JOINT UTILITY LOCATION INFORMATION FOR EXCAVATION  
 1-800-892-0123

CONTRACT NO. 74098 TOWNSHIP : PATOKA

GROSS LENGTH = 8859 FEET = 1.7 MILES  
 NET LENGTH = 1238 FEET = 0.2 MILES

STATE OF ILLINOIS  
 DEPARTMENT OF TRANSPORTATION  
 DIVISION OF HIGHWAYS

SUBMITTED June 29 20 05

*Christine M. Reed*  
 DEPUTY DIRECTOR OF HIGHWAYS, REGION ENGINEER

August 19, 20 05  
*Mike Hine*  
 ENGINEER OF DESIGN AND ENVIRONMENT

August 19, 20 05  
*Victor Mosen*  
 DIRECTOR OF HIGHWAYS, CHIEF ENGINEER

**PRINTED BY THE AUTHORITY**  
**OF THE STATE OF ILLINOIS**

PROJECT ENGINEER : MARK DAUGHERTY  
 SQUAD LEADER :  
 DESIGNER : MATT HIRTZEL  
 TELEPHONE : 217/342-3951 EX 313

district  
 6/29/2005  
 ::\projects\74098d\02605pa.dgn  
 GN & I

FAP NO.	SECTION	COUNTY	TOTAL SHEETS	SHEET NO.
322	26-JI	MARION	6	2
FED. ROAD DIST. NO. 1		BLANKS	FED. AID PROJECT NO.	

CONTRACT NO. 74098

**GENERAL NOTES**

THE WORK INCLUDED IN THIS SECTION 26JI CONSISTS OF NEW GUARDRAIL, CHANNEL CLEANING, RIPRAP AND ANY OTHER WORK NECESSARY TO COMPLETE THE SECTION.

ANY SPOIL MATERIAL EXCAVATED, DREDGED OR OTHERWISE PRODUCED MUST NOT BE RETURNED TO THE WATERWAY BUT MUST BE DEPOSITED IN A SELF-CONTAINED AREA IN COMPLIANCE WITH ALL STATE STATUTES, REGULATIONS AND PERMIT REQUIREMENTS WITH NO DISCHARGE TO WATERS OF THE STATE UNLESS A PERMIT HAS BEEN ISSUED BY THE ILLINOIS EPA.

DUE TO A PETROLEUM PIPELINE AT STA. 733+22 AND AT STA. 815+36, NO MACHINERY IS ALLOWED IN THE STREAM IN ORDER TO EXCAVATE MATERIAL. ALL WORK WILL BE DONE FROM THE SHOULDER ABOVE THE STREAM CHANNEL.

RIPRAP SHALL BE PLACED THE SAME DAY THE EXCAVATION OF THE STREAM CHANNEL OCCURS IN ORDER TO MINIMIZE ANY EROSION.

ALL ERODABLE BARE EARTH AREAS DISTURBED DURING CONSTRUCTION SHALL BE FERTILIZED, SEEDED, AND MULCHED WHEN CONSTRUCTION IS COMPLETE. SEEDING SHALL BE CLASS 2 (SPECIAL) AND IS NOT TO BE PAID FOR SEPERATLEY, BUT SHALL BE INCLUDED WITH THE COST OF CHANNEL EXCAVATION.

THE LOCATIONS AND/OR DEPTHS OF UNDERGROUND UTILITIES SHOWN HAVE BEEN TAKEN FROM INFORMATION FURNISHED BY THE UTILITY OWNERS AND MUST BE CONSIDERED APPROXIMATE. FIELD MARKINGS OF FACILITIES IN CRITICAL AREAS MAY BE OBTAINED BY PROVIDING A MINIMUM OF 96 HOURS ADVANCE NOTICE THROUGH THE J.U.L.I.E. SYSTEM BY CALLING 800-892-0123.

THE CONTRACTOR SHALL REPAIR THE AGGREGATE SHOULDER TO ITS EXISTING CONDITION WHEN CONSTRUCTION IS COMPLETE. THIS WORK WILL NOT BE PAID FOR SEPARATELY BUT SHALL BE INCLUDED IN THE COST OF THE PROJECT.

EXCAVATION FOR RIPRAP IS INCLUDED IN THE COST OF CHANNEL EXCAVATION.

**INDEX OF SHEETS**

SHEET NO.	DESCRIPTION
1	COVER SHEET
2	GENERAL NOTES, INDEX OF SHEETS & LIST OF STANDARDS
3	SUMMARY OF QUANTITIES
4	DETAILS
5-6	PLAN SHEETS
	STANDARDS

THE FOLLOWING STANDARDS ARE A PART OF THESE PLANS AND ARE INCLUDED AFTER THE STANDARDS

STD. NO.	DESCRIPTION
000001-04	STANDARD SYMBOLS, ABBREVIATIONS AND PATTERNS
001006	DECIMAL OF AN INCH AND OF A FOOT
630001-05	STEEL PLATE BEAM GUARDRAIL
630301-03	SHOULDER WIDENING FOR TYPE 1 (SPECIAL) GUARDRAIL TERMINALS
635006-02	REFLECTOR AND TERMINAL MARKER PLACEMENT
635011-01	REFLECTOR MARKER AND MOUNTING DETAILS
701001-01	OFF-ROAD OPERATIONS, 2L, 2W, MORE THAN 4.5 m (15') AWAY
701006-02	OFF-ROAD OPERATIONS 2L, 2W, 4.5 m (15') TO 600 mm (24") FROM PAVEMENT EDGE
701201-02	LANE CLOSURE, 2L, 2W, DAY ONLY, FOR SPEEDS >= 45 MPH
702001-05	TRAFFIC CONTROL DEVICES

<table border="1"> <thead> <tr> <th colspan="2">REVISIONS</th> </tr> <tr> <th>NAME</th> <th>DATE</th> </tr> </thead> <tbody> <tr><td> </td><td> </td></tr> <tr><td> </td><td> </td></tr> <tr><td> </td><td> </td></tr> <tr><td> </td><td> </td></tr> <tr><td> </td><td> </td></tr> <tr><td> </td><td> </td></tr> <tr><td> </td><td> </td></tr> <tr><td> </td><td> </td></tr> <tr><td> </td><td> </td></tr> <tr><td> </td><td> </td></tr> </tbody> </table>		REVISIONS		NAME	DATE																					ILLINOIS DEPARTMENT OF TRANSPORTATION  <b>GENERAL NOTES &amp; INDEX OF SHEETS</b>  SCALE: VERT. _____ DATE _____ HORIZ. _____ DRAWN BY _____ CHECKED BY _____
REVISIONS																										
NAME	DATE																									

district  
 7/29/2005  
 ci\projects\74098a\02605pa.dgn  
 SOA

FAP NO.	SECTION	COUNTY	TOTAL SHEETS	SHEET NO.
322	26JI	MARION	6	3
FED. ROAD DIST. NO. 1		BILLINGS	FED. AID PROJECT NO.	

CONTRACT NO. 74098

SUMMARY OF QUANTITIES			TOTAL QUANTITIES	CONSTRUCTION TYPE CODE	
CODE NO	ITEM	UNIT		SFTY-2A 80% FED.	20% STATE
20300100	CHANNEL EXCAVATION	CU YD	305	305	
28100107	STONE RIPRAP, CLASS A4	SQ YD	87	87	
28200200	FILTER FABRIC	SQ YD	87	87	
63000000	STEEL PLATE BEAM GUARD RAIL, TYPE A	FOOT	1862.5	1862.5	
63100167	TRAFFIC BARRIER TERMINAL TYPE 1, SPECIAL (TANGENT)	EACH	8	8	
67100100	MOBILIZATION	L SUM	1	1	
70100450	TRAFFIC CONTROL AND PROTECTION, STANDARD 701201	L SUM	1	1	
78200410	GUARDRAIL MARKERS, TYPE A	EACH	28	28	
78201000	TERMINAL MARKER - DIRECT APPLIED	EACH	8	8	

REVISIONS	
NAME	DATE

ILLINOIS DEPARTMENT OF TRANSPORTATION

**SUMMARY OF QUANTITIES**

SCALE: VERT. \_\_\_\_\_  
 HORIZ. \_\_\_\_\_  
 DATE \_\_\_\_\_

DRAWN BY \_\_\_\_\_  
 CHECKED BY \_\_\_\_\_

district  
 6/29/2005  
 c:\projects\74098d\02605pa.dgn  
**TYP 2**

FAP SYL.	SECTION	COUNTY	TOTAL SHEETS	SHEET NO.
322	26JI	MARION	6	4

FED. ROAD DIST. NO. 1 BALANCE FED. AID PROJECT NO.  
 CONTRACT NO. 74098

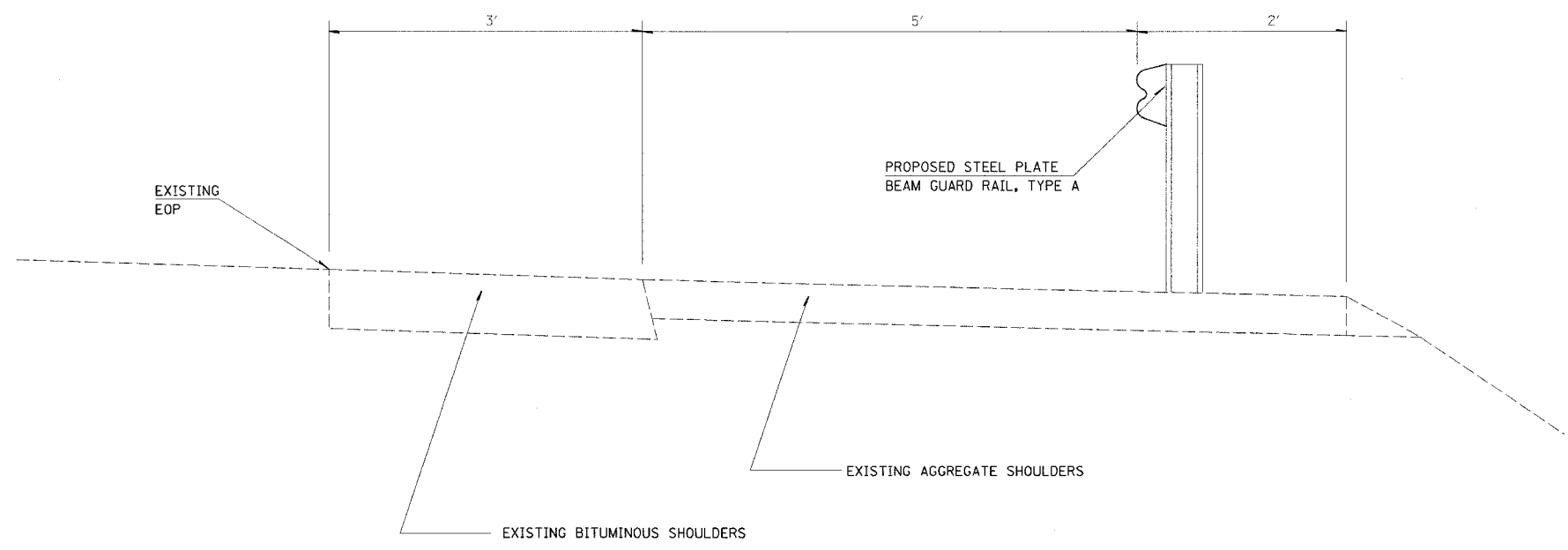

REVISIONS	
NAME	DATE

ILLINOIS DEPARTMENT OF TRANSPORTATION

**DETAILS**

SCALE: VERT.  
 HORIZ.  
 DATE

DRAWN BY  
 CHECKED BY

district  
 6/29/2005  
 c:\projects\74098d\02605pa.dgn  
 PS 2

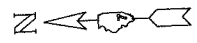

STEEL PLATE BEAM GUARDRAIL, TYPE A	FOOT
LT STA 730+13.75 TO STA 735+51.25	537.5
RT STA 729+75.00 TO STA 736+50.00	675
<b>TOTAL</b>	<b>1212.5</b>

TRAFFIC BARRIER TERMINAL TYPE 1, SPECIAL (TANGENT)	EACH
LT STA 729+63.75	1
LT STA 735+51.25	1
RT STA 729+25.00	1
RT STA 736+50.00	1
<b>TOTAL</b>	<b>4</b>

SN 061-2001 STA 733+22 LT	TOTALS
CHANNEL EXCAVATION	74 CU YD
STONE RIPRAP, CLASS A4	27 SQ YD
FILTER FABRIC	27 SQ YD

SN 061-2001 STA 733+22 RT	TOTALS
CHANNEL EXCAVATION	59 CU YD
STONE RIPRAP, CLASS A4	20 SQ YD
FILTER FABRIC	20 SQ YD

FAP NO.	SECTION	COUNTY	TOTAL SHEETS	SHEET NO.
322	26JI	MARION	6	5

FED. ROAD DIST. NO. 7 ILLINOIS FED. AID PROJECT NO.

CONTRACT NO. 74098

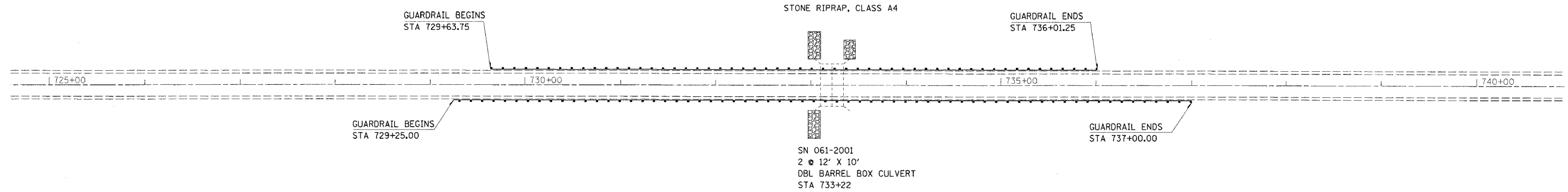

REVISIONS	
NAME	DATE

ILLINOIS DEPARTMENT OF TRANSPORTATION

**STA 725 + 00  
TO  
STA 740 + 00**

SCALE: VERT. \_\_\_\_\_  
 HORIZ. \_\_\_\_\_

DATE \_\_\_\_\_ DRAWN BY \_\_\_\_\_  
 CHECKED BY \_\_\_\_\_

district 6/29/2005  
 c:\projects\74098d\02605pa.dgn  
 PS 3

FAP NO.	SECTION	COUNTY	TOTAL SHEETS	SHEET NO.
322	26JI	MARION	6	6
FED. ROAD DIST. NO. 7		ILLINOIS	FED. AID PROJECT NO.	

CONTRACT NO. 74098

STEEL PLATE BEAM GUARDRAIL, TYPE A	FOOT
LT STA 814+42.50 TO STA 817+30.00	287.5
RT STA 813+71.50 TO STA 817+34.00	362.5
<b>TOTAL</b>	<b>650</b>

SN 061-2002 STA 815+36 LT	TOTALS
CHANNEL EXCAVATION	122 CU YD
STONE RIPRAP, CLASS A4	27 SQ YD
FILTER FABRIC	27 SQ YD

TRAFFIC BARRIER TERMINAL TYPE 1, SPECIAL (TANGENT)	EACH
LT STA 813+92.50	1
LT STA 817+30.00	1
RT STA 813+21.50	1
RT STA 817+34.00	1
<b>TOTAL</b>	<b>4</b>

SN 061-2002 STA 815+36 RT	TOTALS
CHANNEL EXCAVATION	50 CU YD
STONE RIPRAP, CLASS A4	13 SQ YD
FILTER FABRIC	13 SQ YD

EXIST. CURVE C3  
 P.I. STA. = 809+91.13  
 $\Delta = 32^\circ 23' 19''$  (LT)  
 $D = 1^\circ 30' 01''$   
 $R = 3,819.18'$   
 $T = 1,109.16'$   
 $L = 2,158.93'$   
 $E = 157.80'$   
 $\theta = \dots$   
 $T.R. = \dots$   
 $S.E. RUN = \dots$   
 P.C. STA. = 798+81.97  
 P.T. STA. = 820+40.90

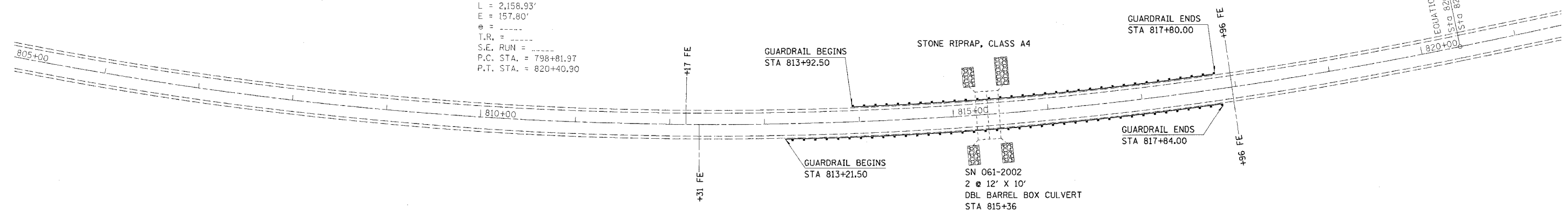

EQUATION:  
 STA 820+40.90 BK =  
 STA 820+41.11 AH

REVISIONS	
NAME	DATE

ILLINOIS DEPARTMENT OF TRANSPORTATION

**STA 805+00  
TO  
STA 820+00**

SCALE: VERT. \_\_\_\_\_  
 HORIZ. \_\_\_\_\_

DATE \_\_\_\_\_ DRAWN BY \_\_\_\_\_  
 CHECKED BY \_\_\_\_\_