

F.A.P. RTE.	SECTION	COUNTY	TOTAL SHEETS	SHEET NO.
322	26JI	MARION	6	1

STATE OF ILLINOIS
DEPARTMENT OF TRANSPORTATION
DIVISION OF HIGHWAYS
PROPOSED
HIGHWAY PLANS
FAP ROUTE 322 (US ROUTE 51)
SECTION 26JI PROJ.NHF-0322(076)
MARION COUNTY
GUARDRAIL & CHANNEL CLEANING
 C-97-061-05

FOR INDEX OF SHEETS, SEE SHEET NO. 2

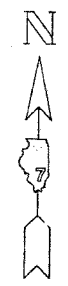
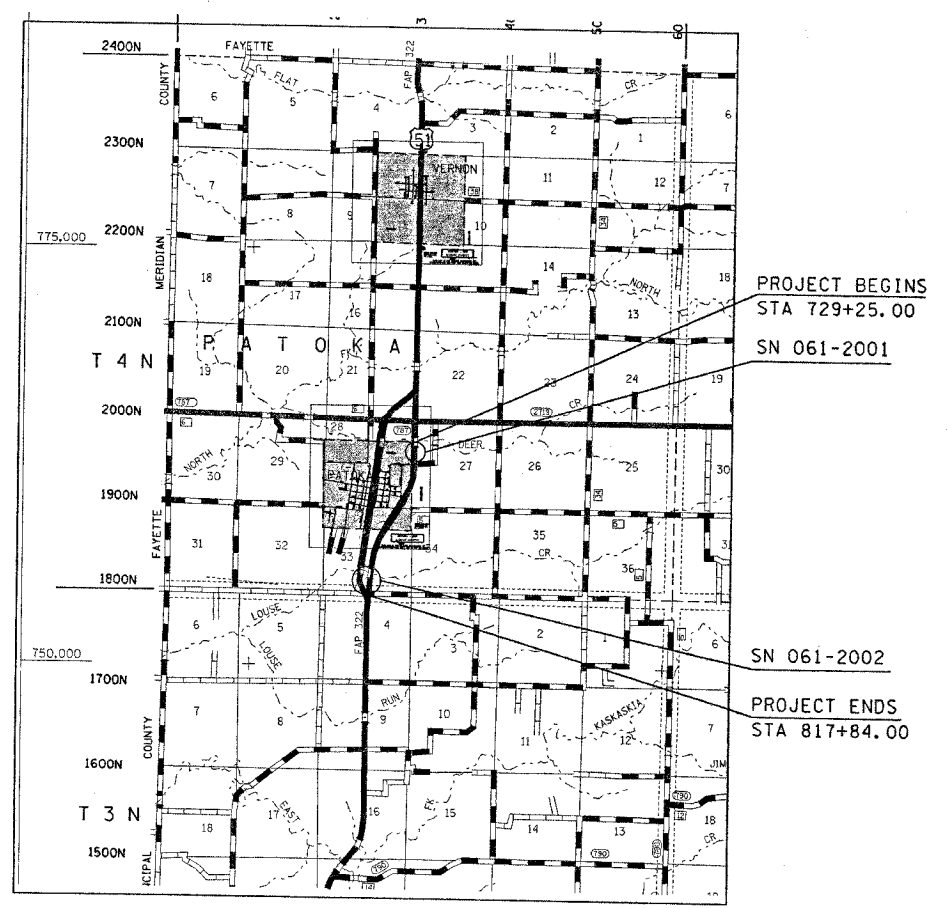

ADT(2003) = 2850

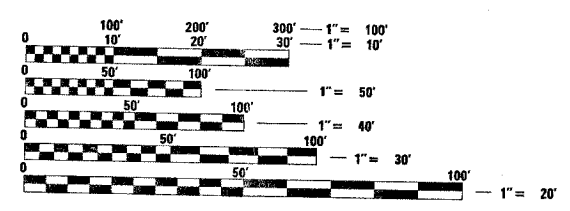

FULL SIZE PLANS HAVE BEEN PREPARED USING STANDARD ENGINEERING SCALES. REDUCED SIZED PLANS WILL NOT CONFORM TO STANDARD SCALES. IN MAKING MEASUREMENTS ON REDUCED PLANS, THE ABOVE SCALES MAY BE USED.

J.U.L.I.E.
 JOINT UTILITY LOCATION INFORMATION FOR EXCAVATION
 1-800-892-0123

CONTRACT NO. 74098 TOWNSHIP : PATOKA

GROSS LENGTH = 8859 FEET = 1.7 MILES
 NET LENGTH = 1238 FEET = 0.2 MILES

STATE OF ILLINOIS
 DEPARTMENT OF TRANSPORTATION
 DIVISION OF HIGHWAYS

SUBMITTED June 29 20 05

Christine M. Reed
 DEPUTY DIRECTOR OF HIGHWAYS, REGION ENGINEER

August 19, 20 05
Mike Hine
 ENGINEER OF DESIGN AND ENVIRONMENT

August 19, 20 05
Victor Mosen
 DIRECTOR OF HIGHWAYS, CHIEF ENGINEER

PRINTED BY THE AUTHORITY
OF THE STATE OF ILLINOIS

PROJECT ENGINEER : MARK DAUGHERTY
 SQUAD LEADER :
 DESIGNER : MATT HIRTZEL
 TELEPHONE : 217/342-3951 EX 313