

FAI ROUTE	SECTION	COUNTY	TOTAL SHEETS	SHEET NO.
74	92(11,12,12-1)RS-1,I	VERMILION	13	1

D-95-024-05  
CONTRACT # 70477

**STATE OF ILLINOIS  
DEPARTMENT OF TRANSPORTATION  
DIVISION OF HIGHWAYS  
PLANS FOR PROPOSED  
HIGHWAY IMPROVEMENT**

FOR INDEX OF SHEETS, SEE SHEET NO. 2  
FOR SUMMARY OF QUANTITIES, SEE SHEET NO. 3

PLAN: 1" = 20'  
PROFILE HORIZ.: N.A.  
PROFILE VERT.: N.A.  
CROSS SECTIONS - HORIZONTAL: 1" = 10' VERTICAL: 1" = 5'

**F.A.I. ROUTE 74 (I-74 EASTBOUND EXIT RAMP)  
SECTION 92(11,12,12-1)RS-1,I  
VERMILION COUNTY  
PROJECT H S -074-6(146)216**

C-95-024-05

**SHOULDER RECONSTRUCTION**

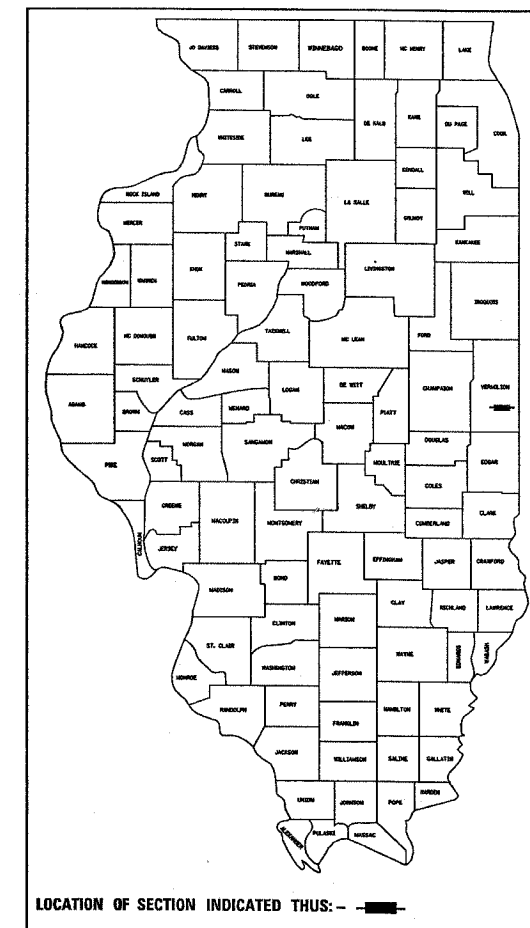

LOCATION OF SECTION INDICATED THUS: - [thick line] -

**DESIGN TRAFFIC**

2003	4,750 ADT
2023	5,200 ADT
PU	4,925 ADT
SU	165 ADT
MU	110 ADT

**DESIGN PERIOD 20**

% PU	94.7
% SU	3.2
% MU	2.1

**TRAFFIC FACTOR =**  
SN = N/A

**DESIGN DESIGNATION  
N.A.**

STRUCTURE NO. 092-0084  
PERRYSVILLE AVE. OVER I-74

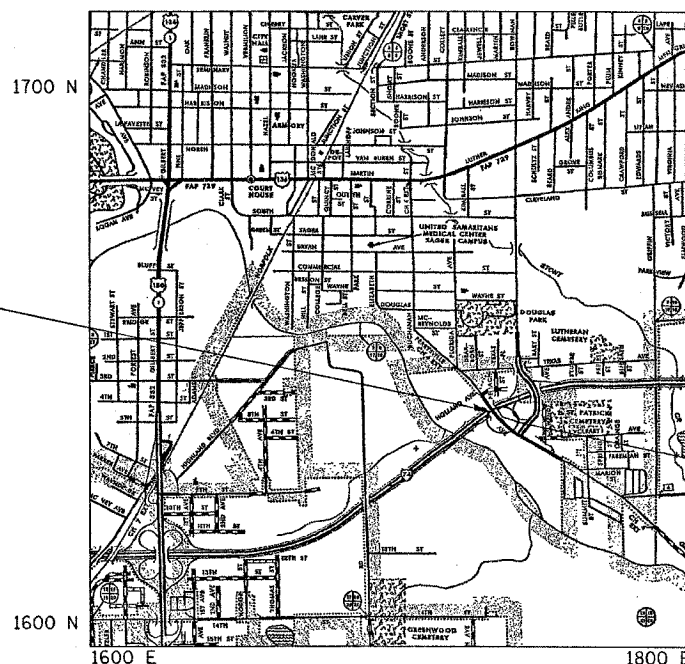

SECTION 92(11,12,12-1)RS-1,I  
INCLUDES SHOULDER RECONSTRUCTION

TOTAL LENGTH OF SECTION & PROJECT = 400.0 FEET = 0.076 MILES  
NET LENGTH OF SECTION & PROJECT = 400.0 FEET = 0.076 MILES

(217) 465 - 4181

PROJECT ENGINEER: SCOTT NEIHART

DESIGNED BY: JEFF ALLEN

STATE OF ILLINOIS  
DEPARTMENT OF TRANSPORTATION  
DIVISION OF HIGHWAYS

SUBMITTED 7/7 2005  
*Joseph R. Coore* REGIONAL ENGINEER

EXAMINED August 19 2005  
*Mike Skae* ENGINEER OF DESIGN AND ENVIRONMENT

APPROVED August 19 2005  
*Victor Moden* DIRECTOR, DIVISION OF HIGHWAYS

FOR UNDERGROUND UTILITY  
LOCATIONS CALL  
TOLL FREE J.U.L.I.E. TELEPHONE NO.  
1-800-892-0123  
DANVILLE TOWNSHIP

PRINTED BY AUTHORITY OF THE STATE OF ILLINOIS

CONTRACT NO. 70477

F.A.I. RTE.	SECTION	COUNTY	TOTAL SHEETS	SHEET NO.
74		VERMILION	13	2

\*92(11,12,12-1)RS-1,1

## GENERAL NOTES

G. N. -100  
ENGLISH UNITS OF MEASUREMENT SHALL GOVERN OVER AND SUPERSEDE ANY METRIC UNITS SHOWN IN THIS CONTRACT. WHERE INCLUDED, METRIC UNITS ARE FOR INFORMATION ONLY.

G. N. -1004.01  
COARSE AGGREGATE GRADATION CA-10 MAY BE USED WHENEVER COARSE AGGREGATE CA-6 IS SPECIFIED IN THE STANDARD SPECIFICATIONS.

G. N. -105.07B  
EXISTING STATE-OWNED AND MAINTAINED UTILITY LINES ARE SHOWN ON THE PLANS TO INDICATE THEIR PRESENCE AND APPROXIMATE LOCATION. THE CONTRACTOR SHALL SECURE AN APPROVED LOCATING FIRM TO LOCATE STATE-OWNED UTILITIES PRIOR TO COMMENCING ANY EXCAVATION IN THE VICINITY OF THESE LINES IN ACCORDANCE TO SECTION 803 OF THE STANDARD SPECIFICATIONS. SHOULD ANY OF THE LINES BE DAMAGED BY THE CONTRACTOR'S OPERATION, THE CONTRACTOR SHALL REPAIR THEM TO THE SATISFACTION OF THE ENGINEER AT NO COST TO THE STATE.

ALSO THERE MAY BE UTILITIES PRESENT WHICH WERE INSTALLED BY THE STATE BUT ARE MAINTAINED BY OTHERS (CITY, TOWN, ETC.) THE APPROXIMATE LOCATIONS OF THESE LINES ARE ALSO SHOWN ON THE PLANS ALONG WITH THE NAME OF THE MAINTAINING AGENCY. THE CONTRACTOR SHALL COORDINATE THE LOCATION OF THESE LINES WITH THE LOCAL AGENCY PRIOR TO COMMENCING ANY EXCAVATION OR BORING IN THEIR VICINITY. SHOULD THESE LINES BE DAMAGED BY THE CONTRACTOR'S OPERATIONS, THE CONTRACTOR SHALL REPAIR THEM TO THE SATISFACTION OF, AND AT NO COST TO, THE LOCAL AGENCY AND THE STATE.

G. N. -105.09A  
ALL ELEVATIONS SHOWN IN THE PLANS ARE BASED ON NORTH AMERICAN VERTICAL DATUM OF 1988. (NAVD 88)

G. N. -202  
GRADING SHALL BE DONE BY HAND AROUND LIGHT POLES, UTILITY POLES, SIGN POSTS, SHRUBS, TREES OR OTHER NATURAL OR MAN-MADE OBJECTS WHERE SHALLOW FILLS OR CUTS ARE ADJACENT TO THE ITEMS. IT IS THE INTENT THAT THE LIMITS OF CONSTRUCTION BE SUCH AS TO PRESERVE IN THE ORIGINAL STATE AS MUCH AREA OF TEMPORARY EASEMENTS AS POSSIBLE. THE DECISION AS TO ITEMS TO REMAIN IN PLACE SHALL BE AS DIRECTED BY THE ENGINEER.

THIS WORK WILL NOT BE PAID FOR SEPARATELY, BUT SHALL BE CONSIDERED INCLUDED IN THE CONTRACT UNIT PRICE PER CUBIC YARD FOR EARTH EXCAVATION AND NO ADDITIONAL COMPENSATION WILL BE ALLOWED.

G. N. -250C  
SEEDING, CLASS 7 AND MULCH, METHOD 2 IS INCLUDED IN THIS CONTRACT TO SEED NEW EARTH SHOULDERS DURING TIME PERIODS WHEN PERMANENT SEEDING IS NOT ALLOWED. SOME OR ALL OF THE CLASS 7 SEEDING AND MULCH WILL BE DELETED IF IT IS POSSIBLE TO PLACE PERMANENT SEEDING ON EARTH SHOULDERS AT THE TIME OF THEIR COMPLETION.

G. N. -406H  
MIXTURE REQUIREMENTS  
THE FOLLOWING MIXTURE REQUIREMENTS ARE APPLICABLE FOR THIS PROJECT:

LOCATION: I-74 BOWMAN RAMP  
MIXTURE USE: BIT SHOULDER  
AC/PG: PG 58-22  
RAP % (MAX.): 30  
DESIGN AIR VOIDS: 3.0 % @ Ndes = 30  
MIX COMP (GRADATION): IL 9.5L  
FRICTION AGGREGATE: MIX C

G. N. -482  
ALL MATERIAL PLACED AS BITUMINOUS SHOULDERS SUPERPAVE SHALL BE COMPACTED TO 94.0-98.4 PERCENT OF THE MAXIMUM THEORETICAL DENSITY. THIS REQUIREMENT SHALL APPLY TO BOTH B.A.M. AND IL 9.5L GRADATION SHOULDER MIXES. THIS MAXIMUM DENSITY SHALL BE DETERMINED FROM THE MOVING AVERAGE OF FOUR TESTS AS IN OTHER QC/QA TESTING. A NUCLEAR GAUGE DENSITY/CORE CORRELATION SHALL BE PERFORMED FOR BOTH THE B.A.M. AND IL 9.5L MIXES USING STANDARD CORRELATION PROCEDURES.

## INDEX OF SHEETS

SHEET NO.	ITEM
1	COVER SHEET
2	GENERAL NOTES, INDEX OF SHEETS & STANDARDS IN THE PLANS
3	SUMMARY OF QUANTITIES
4	PROPOSED TYPICAL CROSS SECTIONS
5	SCHEDULE OF QUANTITIES
6	ROADWAY PLAN SHEET
7	TYPICAL APPLICATION OF PAVEMENT MARKINGS FOR INTERSTATE AND MULTI-LANE DIVIDED HIGHWAYS
8	SPECIAL DETAIL FOR RAMP WORK AREAS
9-13	CROSS SECTIONS

## HIGHWAY STANDARDS IN THE PLANS

280001-02	TEMPORARY EROSION CONTROL SYSTEMS
482011-01	BIT. SHOULDER STRIPS/SHOULDERS WITH RESURFACING OR WIDENING AND RESURFACING PROJECTS
702001-05	TRAFFIC CONTROL DEVICES
000001-04	STANDARD SYMBOLS, ABBREVIATIONS, AND PATTERNS
001006	DECIMAL OF AN INCH AND OF A FOOT

STATE OF ILLINOIS  
DEPARTMENT OF TRANSPORTATION  
DISTRICT FIVE

REVIEWED BY: *D. L. Marshall*  
DISTRICT ENGINEER OF PROGRAM DEVELOPMENT

DATE: 7/7/05

EXAMINED BY: *John H. Hill*  
DISTRICT ENGINEER OF PROJECT IMPLEMENTATION

*James W. Seaberg*  
DISTRICT ENGINEER OF BUREAU OF OPERATIONS

F.A.I. RTE.	SECTION	COUNTY	TOTAL SHEETS	SHEET NO.
74	*	VERMILION	13	3

\*92(11,12,12-1RS-1,1

### SUMMARY OF QUANTITIES

LOCATION OF WORK:

URBAN  
 FAI 74  
 EB EXIT RAMP  
 90% FED.  
 10% STATE

CONSTRUCTION TYPE CODE:

SFTY - 2A

CODE NO	ITEM	UNIT	TOTAL QUANTITY	
20200100	EARTH EXCAVATION	CU YD	5.0	5.0
20400800	FURNISHED EXCAVATION	CU YD	20.0	20.0
25000200	SEEDING CLASS 2	ACRE	0.1	0.1
25000350	SEEDING CLASS 7	ACRE	0.1	0.1
25000400	NITROGEN FERTILIZER NUTRIENT	POUND	9.0	9.0
25000500	PHOSPHORUS FERTILIZER NUTRIENT	POUND	9.0	9.0
25000600	POTASSIUM FERTILIZER NUTRIENT	POUND	9.0	9.0
25100115	MULCH METHOD 2	ACRE	0.1	0.1
28000400	PERIMETER EROSION BARRIER	FOOT	425.0	425.0
40600100	BITUMINOUS MATERIALS PRIME COAT	GAL	20.0	20.0
44001130	BITUMINOUS SHOULDER REMOVAL	SQ YD	197.0	197.0
48100100	AGGREGATE SHOULDERS, TYPE A	TON	15.0	15.0
48202110	BITUMINOUS SHOULDERS SUPERPAVE, 3 1/2 "	SQ YD	197.0	197.0
63500120	DELINEATOR REMOVAL	EACH	4.0	4.0
67100100	MOBILIZATION	L SUM	1.0	1.0
70103815	TRAFFIC CONTROL SURVEILLANCE	CAL DA	5.0	5.0
78003110	PREFORMED PLASTIC PAVEMENT MARKING TAPE TYPE B - LINE 4"	FOOT	400.0	400.0
Z0029650	HIGH TENSION CABLE MEDIAN BARRIER SYSTEM	FOOT	371.5	371.5
	SPECIALITY ITEM			

F.A.I. RTE.	SECTION	COUNTY	TOTAL SHEETS	SHEET NO.
74		VERMILION	13	4

\*92011,12,12-1RS-1,I

### AS-BUILT TYPICAL RAMP CROSS SECTION BOWMAN AVENUE INTERCHANGE

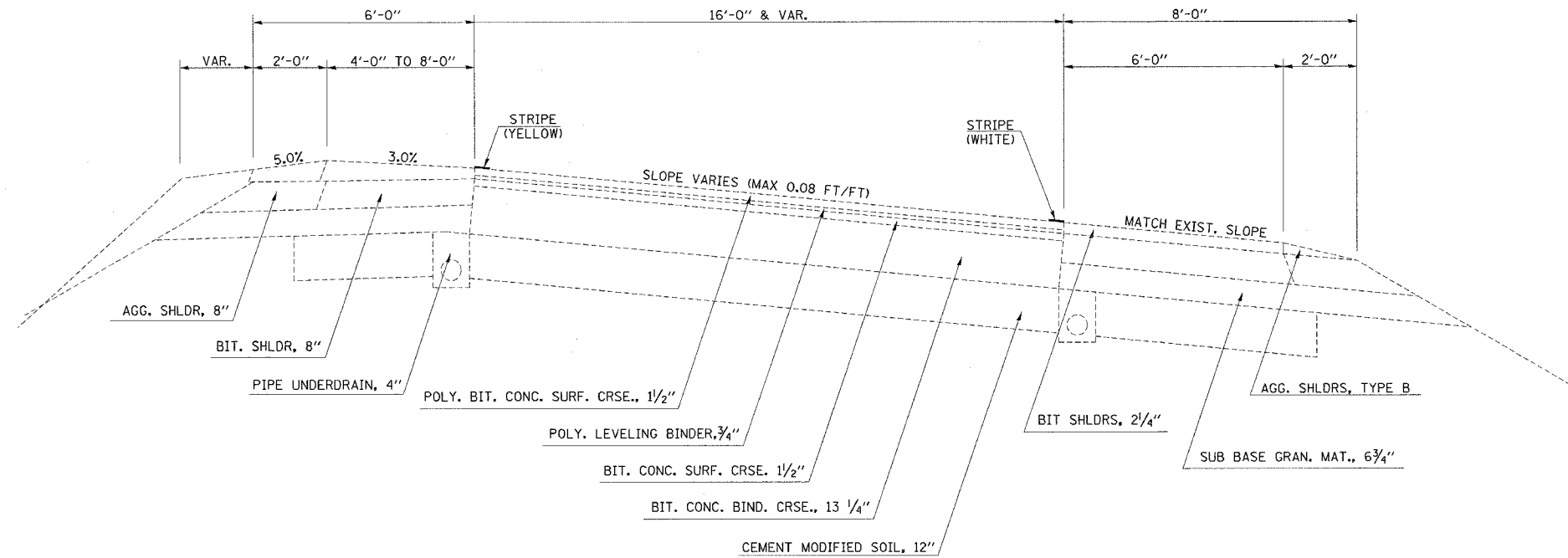

### PROPOSED TYPICAL RAMP CROSS SECTION BOWMAN AVENUE INTERCHANGE

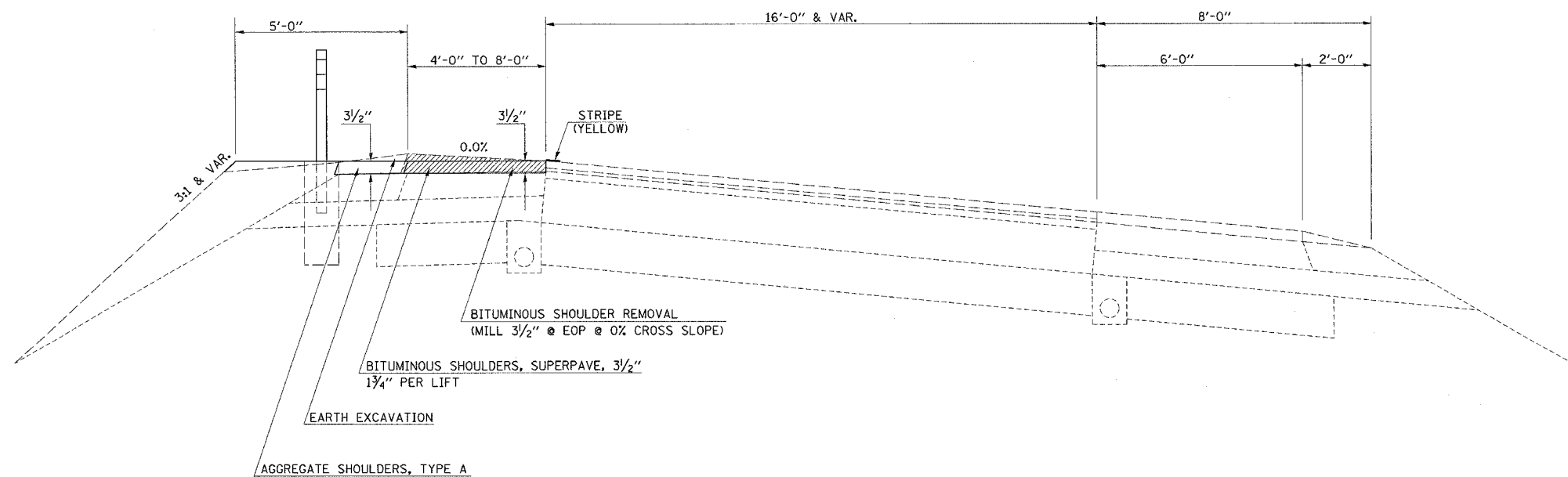

### SCHEDULE OF QUANTITIES

F.A.I. RTE.	SECTION	COUNTY	TOTAL SHEETS	SHEET NO.
74	*	VERMILION	13	5

\*92(11,12,12-1)RS-1,1

<u>PREF PL PM TAPE TB LINE 4</u>		LOCATION	EARTH EXCAVATION CU YD	EARTH EXC ADJ FOR SHRINKAGE	EMBANKMENT CU YD	BALANCE (-) FILL CU YD (2)
<u>LOCATION</u>	<u>FOOT</u>	STA. 11+00 TO 15+00	3.0	2.3	22.0	-19.75
LT. STA. 11+00 - 15+00	400	TOTAL	5.0		25.0	20.0

NOTES:  
 1- NO SHRINKAGE FACTOR APPLIED TO THE EMBANKMENT QUANTITY  
 2- A 25% EXPANSION FACTOR WAS USED IN COMPUTING BORROW QUANTITY  
 5 CUYDS EARTH EXCAVATION  
 25 CUYDS FURNISHED EXCAVATION

<u>BITUMINOUS SHOULDER SUPERPAVE 3 1/2"</u>		
<u>LOCATION</u>		<u>SQ. YD.</u>
LT. 11+39.66 - LT. 14+63.79		197.0

ITEM	QUANTITY	UNIT
SEEDING CLASS 2	0.1	ACRE
SEEDING CLASS 7	0.1	ACRE
NITROGEN FERTILIZER NUTRIENT	9.0	POUND
PHOSPHOROUS FERTILIZER NUTRIENT	9.0	POUND
POTASSIUM FERTILIZER NUTRIENT	9.0	POUND
MULCH METHOD 2	0.1	ACRE

SEEDING, FERTILIZER, AND MULCH METHOD QUANTITIES WERE  
 CALCULATED FROM LOCATIONS OFF OF THE CROSS SECTIONS.

<u>BITUMINOUS SHOULDER REMOVAL</u>		
<u>LOCATION</u>		<u>SQ. YD.</u>
LT. 11+39.66 - LT. 14+63.79		197.0

<u>AGGREGATE SHOULDERS, TYPE A</u>		
<u>LOCATION</u>		<u>TON</u>
LT. 11+39.66 - LT. 14+63.79		15.0

F.A.I. RTE.	SECTION	COUNTY	TOTAL SHEETS	SHEET NO.
74		VERMILION	13	6

9211.12.12-11BS-1.1

# I-74 EB EXIT RAMP



BEGIN HIGH TENSION CABLE  
MEDIAN BARRIER SYSTEM  
(EXPERIMENTAL BRIFEN)  
STATION 11+06, 27.8' LEFT

HIGH TENSION CABLE MEDIAN BARRIER SYSTEM  
(EXPERIMENTAL BRIFEN)  
371.5 FEET, POST SPACING AT 5.25' INTERVALS

PROJECT BEGINS  
STA. 11+00

BEGIN AGG SHLDR, TYPE A  
& BIT SHLD SUPER 3 1/2"  
+39.6

BEGIN PREFORMED PLASTIC PAVEMENT  
MARKING TAPE TYPE B, 4"  
STA. 11+00

EXIST. CURVE 805  
PI STA. = 11+88.81  
 $\Delta = 53^\circ 29' 22''$  (RT)  
D = 12° 44' 06"  
R = 449.91'  
T = 226.72'  
L = 420.02'  
E = 53.90'  
 $e = 0.08\%$   
T.R. = -----  
S.E. RUN = -----  
P.C. STA. = 9+62.09  
P.T. STA. = 13+82.11

END AGG SHLDR, TYPE A  
& BIT SHLD SUPER 3 1/2"  
+76.0

END PREFORMED PLASTIC PAVEMENT  
MARKING TAPE TYPE B, 4"  
STA. 15+00

PROJECT ENDS  
STA. 15+00

BASELINE  
I-74 EB EXIT RAMP

PLT DATE = 04/15/11  
FILE NAME = 110417  
PLOT SCALE = #SCALE#  
USER NAME = #USER#

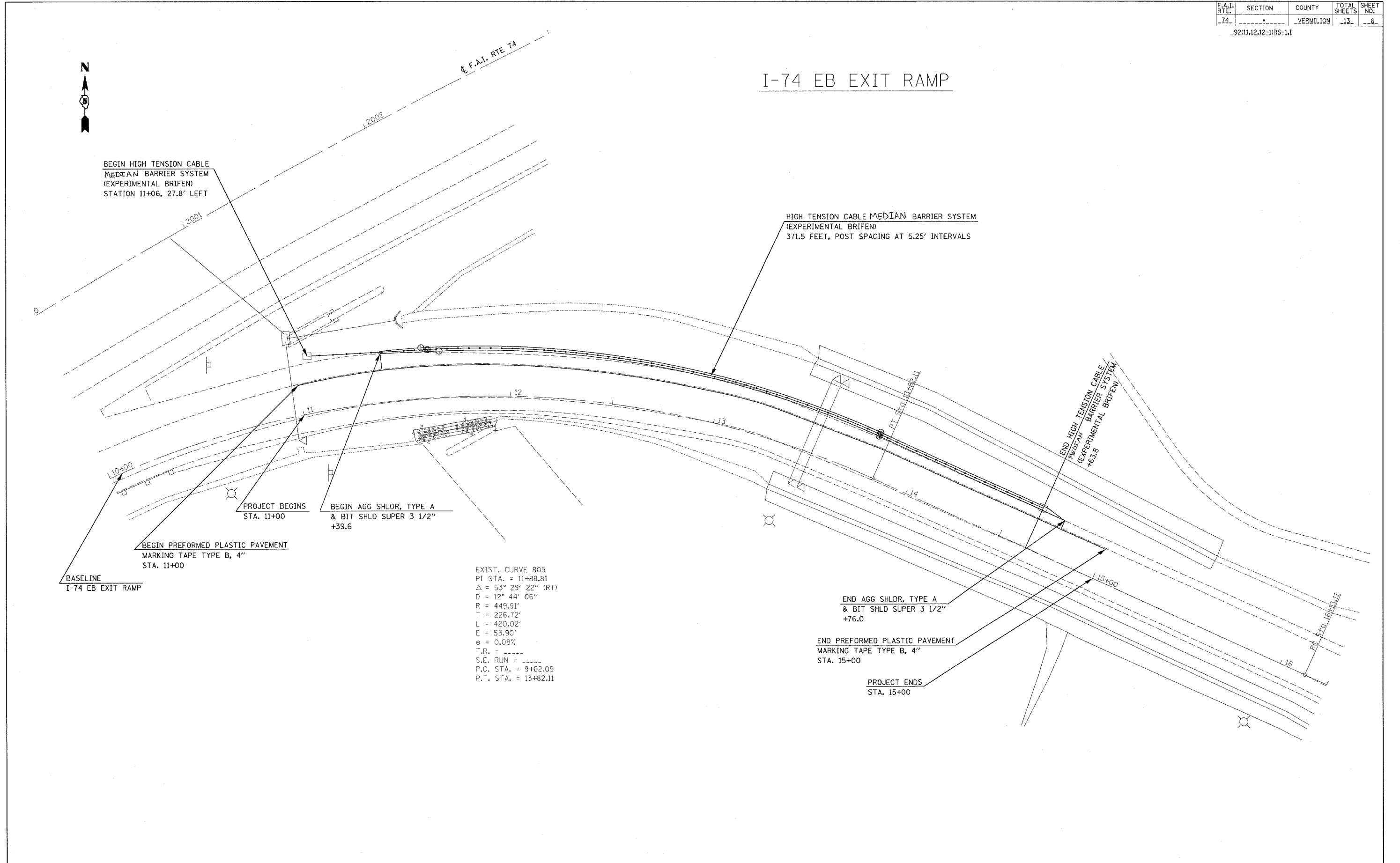

F.A.I. RTE.	SECTION	COUNTY	TOTAL SHEETS	SHEET NO.
74		VERMILION	13	7

\*92(11,12,12-URS-1,1

## TYPICAL APPLICATION OF PAVEMENT MARKINGS FOR INTERSTATE AND MULTI-LANE DIVIDED HIGHWAYS

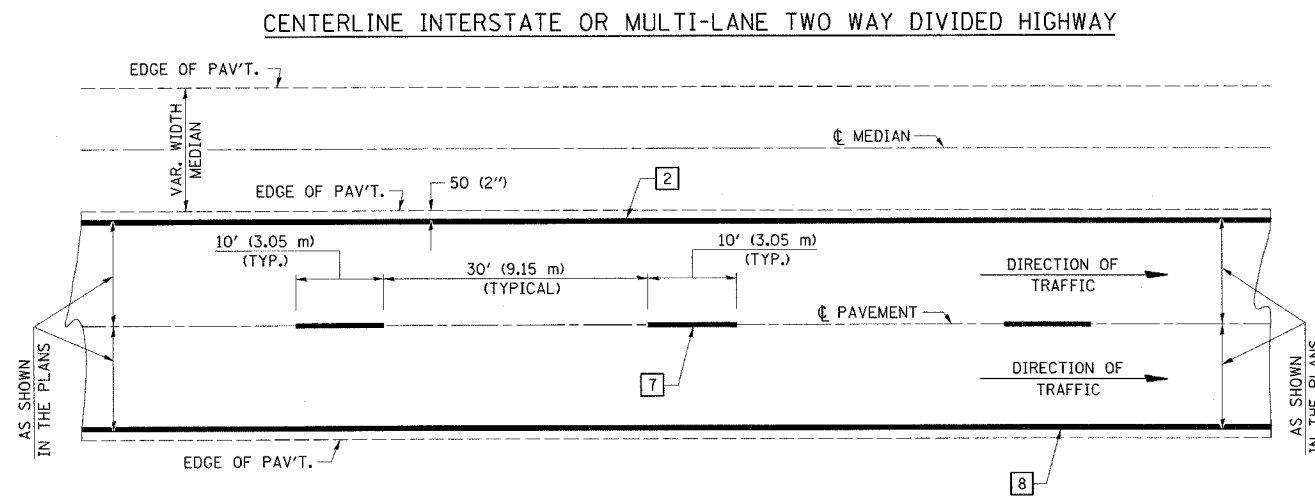
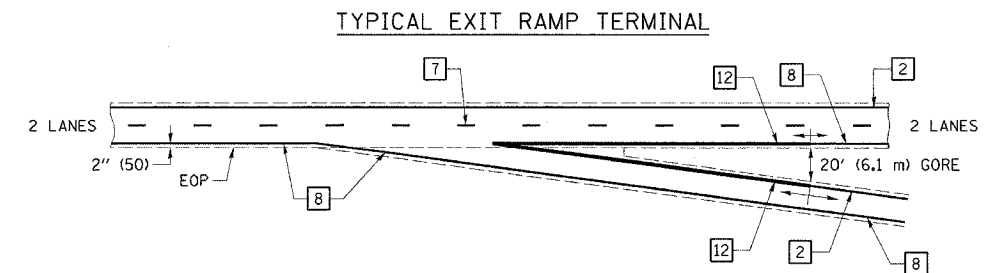
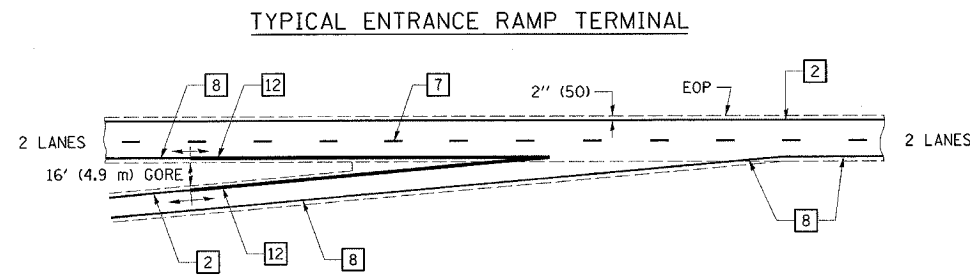

NOTE: PAVEMENT MARKINGS ARE TO BE EXTENDED THROUGH OMISSIONS WHEN APPLICABLE.

NOTE: SEE ARTICLES 780.04 & 781.03 FOR LOCATION OF STRIPES AND MARKERS RELATIVE TO EDGES OR JOINTS.

FOR RAISED REFLECTIVE PAVEMENT MARKERS, REFER TO STANDARD 781001.

### TYPICAL PAVEMENT MARKING LEGEND

- 1 4" (100) SKIP-DASH (YELLOW)
- 2 4" (100) SOLID (YELLOW)
- 3 12" (300) DIAGONAL (YELLOW)
- 4 4" (100) DOUBLE YELLOW (NARROW)
- 5 4" (100) DOUBLE YELLOW (WIDE)
- 6 RESERVED
- 7 4" (100) SKIP-DASH (WHITE)
- 8 4" (100) SOLID (WHITE)
- 9 12" (300) DIAGONAL (WHITE)
- 10 6" (150) CROSS WALK (WHITE)
- 11 24" (600) STOP BAR (WHITE)
- 12 8" (200) SOLID (WHITE)
- 13 4" (100) LANE LINE EXTENSIONS (WHITE)
- 14 RESERVED

### ENTRANCE RAMP TERMINAL with EXCLUSIVE LANE

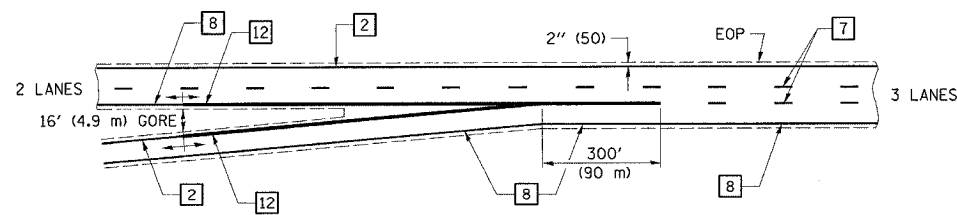

### EXIT RAMP TERMINAL with EXCLUSIVE (auxiliary) LANE

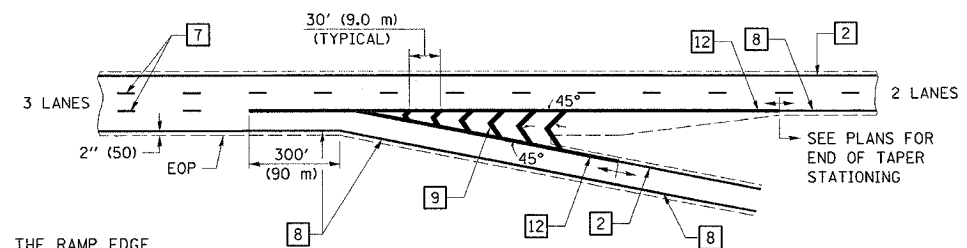

WHEN RAMPS ARE SURFACED, THE RAMP EDGE LINES SHALL BE AS SHOWN IN THE PLANS.

NAME	DATE	REVISIONS
DESIGNED	P.E.E. 03/89	NAME DATE
CHECKED	C.T.D. 04/89	D.L.P. 08/97
CADD NO.	F-5.22	K.A.G. 08/04

ALL DIMENSIONS ARE IN INCHES (MILLIMETERS) UNLESS OTHERWISE SHOWN.

F.A.I. RTE.	SECTION	COUNTY	TOTAL SHEETS	SHEET NO.
74	*	VERMILION	13	8

\*92(11,12,12-1)RS-1.I

### SPECIAL DETAIL FOR RAMP WORK AREAS

TYPICAL APPLICATION OF TRAFFIC CONTROL DEVICES

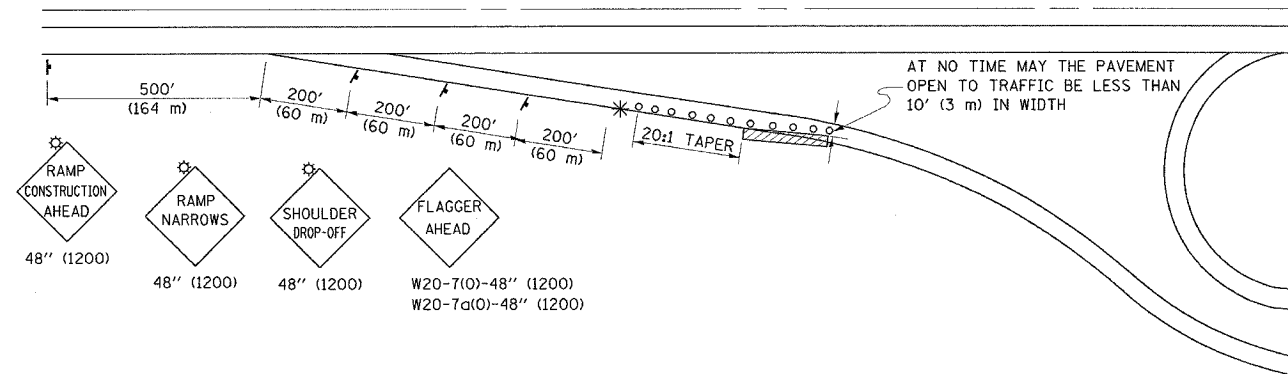

#### SYMBOLS

- ◊ TYPE I OR II BARRICADES OR DRUMS @ 50' (15 m) CTS.
- \* FLAGGER PLACED AS DIRECTED BY THE ENGINEER DURING DAYTIME CONSTRUCTION
- † SIGN ON PORTABLE OR PERMANENT SUPPORT
- ▨ WORK AREA
- ☆ FLASHING LIGHT

#### GENERAL NOTES

1. CONSTRUCTION OPERATIONS SHALL BE CONFINED TO AN AREA NARROW ENOUGH THAT A MINIMUM OF 10' (3 m) OF PAVEMENT SHALL BE OPEN TO TRAFFIC AT ALL TIMES.
2. CONES MAY BE SUBSTITUTED FOR BARRICADES DURING DAY OPERATIONS, AT 25' (7.5 m) SPACING.
3. FLASHING LIGHTS REQUIRED ON SIGNS IF DROP-OFF EXISTS DURING NON-WORKING HOURS.
4. WHEN NO WORK IS BEING PERFORMED, THE FLAGGER WILL NOT BE REQUIRED. IF THE FLAGGER IS NOT PRESENT, THE FLAGGER SIGNS SHALL BE REMOVED OR COVERED.
5. ALL SIGNS SHALL BE POST MOUNTED IF WORK IN THE AREA EXCEEDS FOUR DAYS OF DAYTIME OPERATIONS.
6. LONGITUDINAL DIMENSIONS MAY BE ADJUSTED SLIGHTLY TO FIT FIELD CONDITIONS.
7. ALL VEHICLES, EQUIPMENT, WORKERS (EXCEPT FLAGGER) AND THEIR ACTIVITIES ARE RESTRICTED AT ALL TIMES TO ONE SIDE OF THE PAVEMENT UNLESS OTHERWISE AUTHORIZED BY THE DISTRICT ENGINEER.
8. TYPE I OR II BARRICADES, VERTICAL BARRICADES, OR DRUMS WITH LIGHTS REQUIRED TO MARK HAZARD DROP-OFF.

#### REVISIONS

D.L.P.	NAME	DATE
3-95		08/00
F-5.01	K.A.G.	01/05

ALL DIMENSIONS ARE IN INCHES (MILLIMETERS) UNLESS OTHERWISE SHOWN.





F-A-I RTE.	SECTION	COUNTY	TOTAL SHEETS	SHEET NO.
74	211212385-1	VERMILION	13	10
STA. 12+00.00		TO STA. 12+50.00		
FED. ROAD DIST. NO. ILLINOIS FED. AID PROJECT				

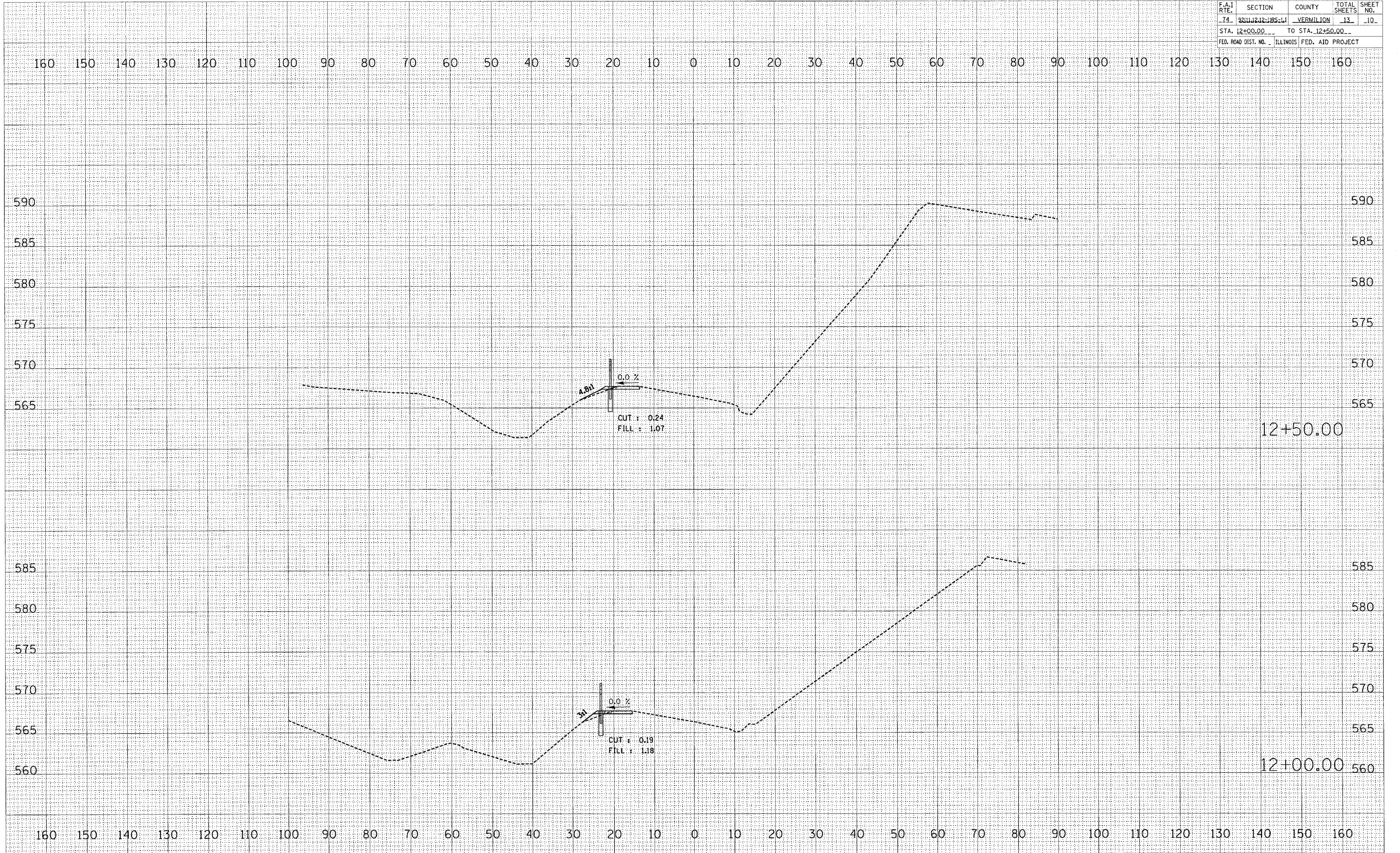

DATE	BY

DATE	BY

PLOT DATE = 04/01/88  
 FILE NAME = 40477  
 PLOT SCALE = 1"=40'  
 USER NAME = JWB



CONTRACT NO. 70477				
F.A. RTE.	SECTION	COUNTY	TOTAL SHEETS	SHEET NO.
74	2211J212-JRS-L1	VERMILION	13	11
STA. 13+00.00		TO STA. 13+50.00		
FED. ROAD DIST. NO. ILLINOIS		FED. AID PROJECT		

DATE	BY

DATE	BY

PLOT DATE \* DATE \*  
 PLOT SCALE \* SCALE \*  
 PLOT NAME \* USER \*  
 NO. \* USER \*

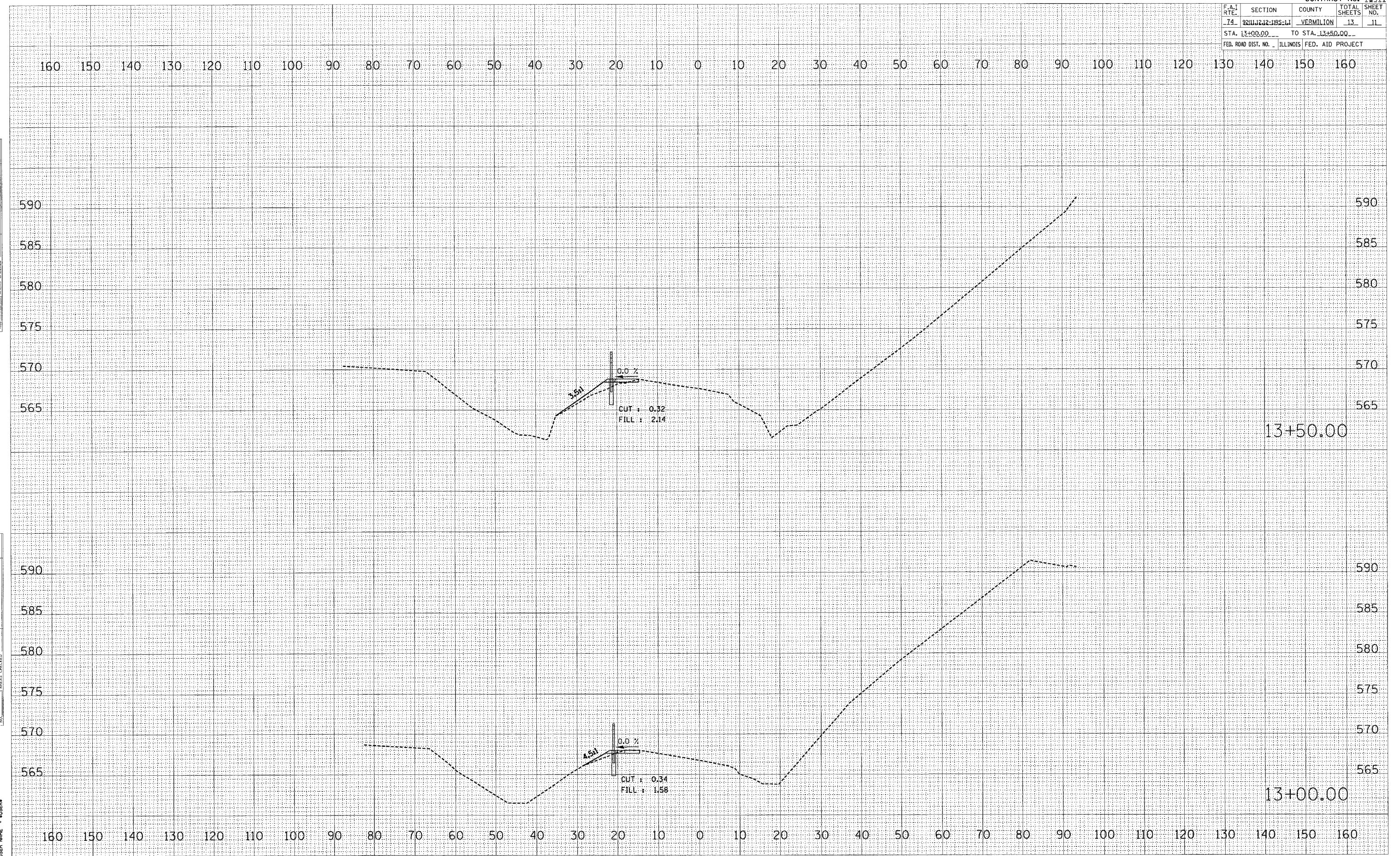





F.A.I. RTE.	SECTION	COUNTY	TOTAL SHEETS	SHEET NO.
74	9211+212-1RS-L1	VERMILION	13	13
STA. 15+00.00		TO STA. 15+00.00		
FED. ROAD DIST. NO. ILLINOIS FED. AID PROJECT				

160 150 140 130 120 110 100 90 80 70 60 50 40 30 20 10 0 10 20 30 40 50 60 70 80 90 100 110 120 130 140 150 160

DATE \_\_\_\_\_ BY \_\_\_\_\_  
FINAL SURVEYED SURVEYED  
BOOK PLOTTED PLOTTED  
NO. AREA CHECKED AREA CHECKED

DATE \_\_\_\_\_ BY \_\_\_\_\_  
ORIGINAL SURVEYED SURVEYED  
BOOK PLOTTED PLOTTED  
NO. AREA CHECKED AREA CHECKED

PLOT DATE = 8/2/85  
FILE NAME = 850802  
USER NAME = AUBER

