

F.A.I. RTE.	SECTION	COUNTY	TOTAL SHEETS	SHEETS NO.
55	(32-1)J	GRUNDY	4	1
F.H.W.A. REG. 5		ILLINOIS	PROJECT	

D-93-065-05

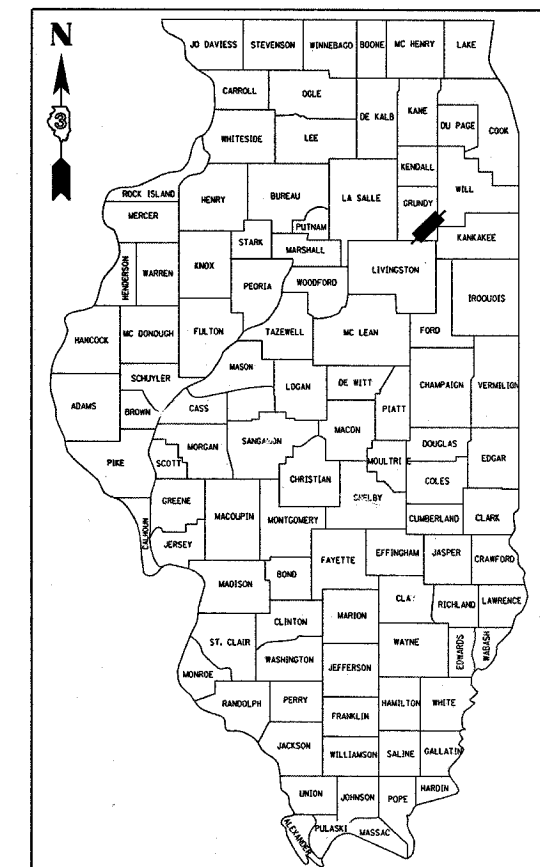

LOCATION OF SECTION INDICATED THUS:

FUNCTION CLASSIFICATION

INTERSTATE

2004 ADT = 22600

P.V. = 68.6 % S.U. = 6.2 % M.U. = 25.2 %

INDEX OF SHEETS

- 1 COVERSHEET
- 2 GENERAL NOTES & TYPICAL
- 3 SUMMARY
- 4 DETAILS

HIGHWAY STANDARDS

- 701106-01 OFF-ROAD OPERATIONS, MULTILANE, MORE THAN 4.5 m (15') AWAY
- 701400-02 APPROACH TO LANE CLOSURE, FREEWAY/EXPRESSWAY
- 701401-03 LANE CLOSURE, FREEWAY/EXPRESSWAY
- 702001-05 TRAFFIC CONTROL DEVICES

STATE OF ILLINOIS DEPARTMENT OF TRANSPORTATION DIVISION OF HIGHWAYS PLANS FOR PROPOSED FEDERAL AID HIGHWAY

F.A.I. ROUTE 55 (I-55NB) SECTION (32-1)J

GRUNDY COUNTY

C - 93 - 112 - 05

PROJECT DESCRIPTION

INSTALL HIGH TENSION CABLE MEDIAN BARRIER SYSTEM

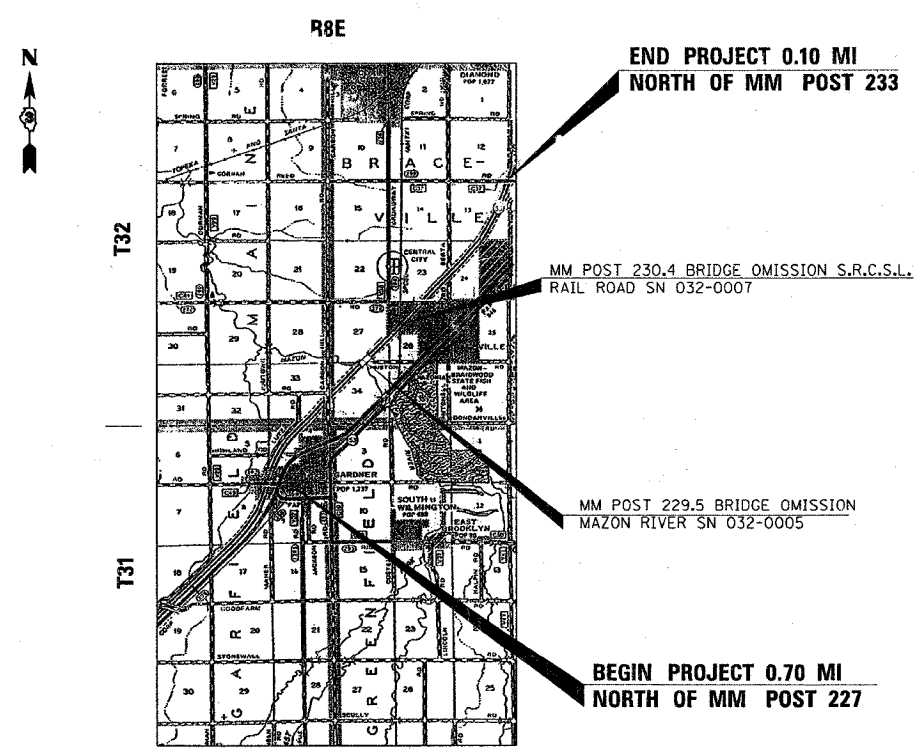

LOCATION MAP
NOT TO SCALE

GROSS LENGTH = 28,512 FT. = 5.40 MI.
NET LENGTH = 27,199 FT. = 5.15 MI.

MICROFILMED _____
REEL NUMBER _____
AWARDED _____
RESIDENT ENGINEER _____
AS BUILT CHANGES WERE MADE
ON THE FOLLOWING SHEETS _____

JULIE 1-800-892-0123

DISTRICT 3 NO. (815) 434-6131

PROJECT ENGINEER: DAN DRAPER
UNIT CHIEF: PAT BRABOY
TOWNSHIP: GARFIELD, MAIN, BRACEVILLE

CONTRACT NO. 66605

STATE OF ILLINOIS
DEPARTMENT OF TRANSPORTATION
DIVISION OF HIGHWAYS

SUBMITTED JUNE 30 20 05
Gary L. Mounts
DEPUTY DIRECTOR OF HIGHWAYS, REGION ENGINEER

August 19, 20 05
Mike Hine
ENGINEER OF DESIGN AND ENVIRONMENT

August 19, 20 05
Victor Mader
DIRECTOR OF HIGHWAYS, CHIEF ENGINEER

PRINTED BY THE AUTHORITY
OF THE STATE OF ILLINOIS

6/30/2005 c:\p\p\lects\ed0505\cover.sht.dgn