

(FOR CONTINUATION, SEE WEST HALF OF INTERCHANGE SHEET E8)

F.A. I. RTE.	SECTION	COUNTY	TOTAL SHEETS	SHEET NO.
290	0305-302K-L-3	COOK	55	22
STA.	TO STA.			
FED. ROAD DIST. NO.	ILLINOIS FED. AID PROJECT			

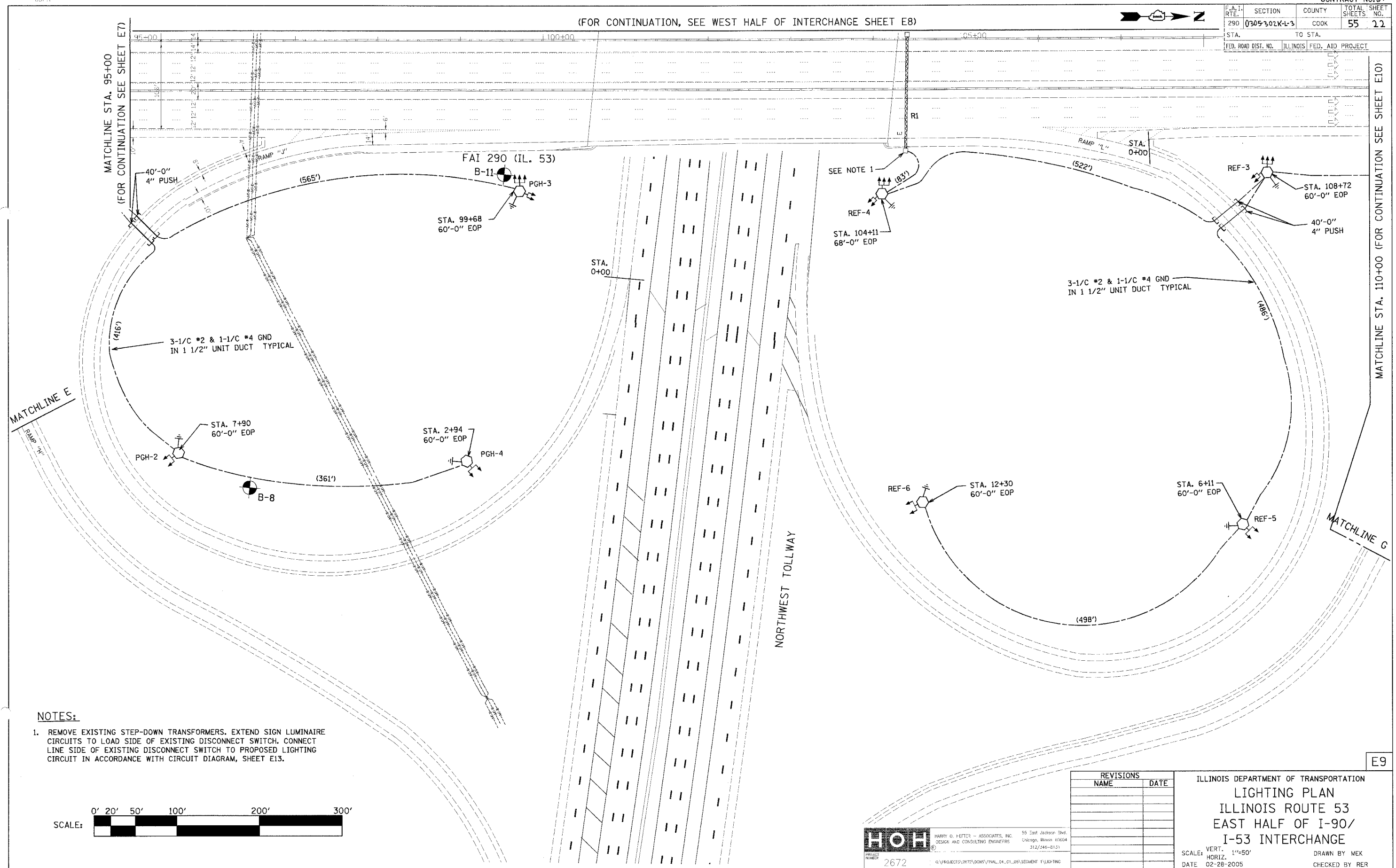

- NOTES:**
1. REMOVE EXISTING STEP-DOWN TRANSFORMERS. EXTEND SIGN LUMINAIRE CIRCUITS TO LOAD SIDE OF EXISTING DISCONNECT SWITCH. CONNECT LINE SIDE OF EXISTING DISCONNECT SWITCH TO PROPOSED LIGHTING CIRCUIT IN ACCORDANCE WITH CIRCUIT DIAGRAM, SHEET E13.

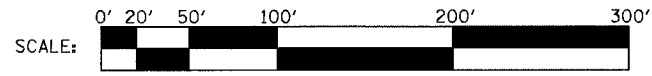

PLOT DATE = 04/05/2005
 FILE NAME = #FILE#
 PLOT SCALE = #SCALE#
 REFERENCE = #REF#

HOH HARRY O. FETTER - ASSOCIATES, INC. 55 East Jackson Blvd.
 DESIGN AND CONSULTING ENGINEERS Chicago, Illinois 60604
 312/546-6131

PROJECT NUMBER: 2672
 FILE PATH: @:\PROJECTS\2672\DOWN\FINAL_04_01_05\SEGMENT 1\LIGHTING

REVISIONS	
NAME	DATE

ILLINOIS DEPARTMENT OF TRANSPORTATION
LIGHTING PLAN
 ILLINOIS ROUTE 53
 EAST HALF OF I-90/
 I-53 INTERCHANGE

SCALE: VERT. 1"=50'
 HORIZ. 1"=50'
 DATE 02-28-2005

DRAWN BY MEK
 CHECKED BY RER