

RTE.	SECTION	COUNTY	TOTAL SHEETS	SHEET NO.
305	2004-108 BR	COOK	72	37
STA.		TO STA.		
FED. ROAD DIST. NO.		ILLINOIS	FED. AID PROJECT:	
CONTRACT NO. 62853				

- NOTE 1: THE CONTRACTOR SHALL REMOVE THE EXISTING 4" CONDUIT ATTACHED TO STRUCTURE AND REPLACE IT WITH A 4" CONDUIT TO BE EMBEDDED IN THE PROPOSED PARAPET WALL. THE EXISTING CABLES AFFECTED BY THE REMOVAL OF EXISTING CONDUIT SHALL BE REMOVED AND NEW CABLES SHALL BE INSTALLED IN THEIR PLACE AS SHOWN IN THE CABLE DIAGRAM. THIS WORK SHALL BE DONE AS SHOWN IN THE PLANS AND AS DIRECTED BY THE ENGINEER. THE CONDUIT AND JUNCTION BOXES (IF ANY) REMOVAL WILL NOT BE PAID FOR SEPARATELY BUT SHALL BE INCIDENTAL TO THE STRUCTURAL REMOVAL PAY ITEMS.
- NOTE 2: REMOVE 250' OF 3/C CABLE (2 CABLES), 250' OF 3/C NO. 20 CABLE (2 CABLES), 625' OF 5/C CABLE (5 CABLES), 500' OF 7/C CABLE (4 CABLES), AND 625' OF 1 PAIR LEAD-IN CABLE (5 CABLES) BETWEEN CONTROLLER CABINET AND THIS HANDHOLE (TOTAL 2250')
- NOTE 3: REMOVE 118' OF 3/C CABLE (1 CABLE) FOR AVIATION OBSTRUCTION RED LIGHT, 149' OF 5/C CABLE (1 CABLE), AND 160' OF 7/C CABLE (1 CABLE) BETWEEN HANDHOLE IN SOUTHEAST CORNER OF WB FRONTAGE ROAD AND THE MAST ARM POLE. ALSO REMOVE 87' OF 1 PAIR LEAD-IN CABLE (1 CABLE) BETWEEN THE HANDHOLES. (TOTAL 514')
- NOTE 4: REMOVE 176' OF 3/C CABLE (1 CABLE), 176' OF 3/C NO. 20 CABLE (1 CABLE) 311' OF 5/C CABLE (2 CABLES), AND 170' OF 7/C CABLE (1 CABLE) BETWEEN HANDHOLE IN SOUTHEAST CORNER OF WB FRONTAGE ROAD AND THIS MAST ARM POLE. (TOTAL 833')
- NOTE 5: REMOVE 238' OF 7/C CABLE (2 CABLES) BETWEEN HANDHOLE IN SOUTHEAST CORNER OF WB FRONTAGE ROAD AND THE MAST ARM POLE. (TOTAL 238')
- NOTE 6: REMOVE 249' OF 3/C CABLE (1 CABLE), 249' OF 3/C NO. 20 CABLE (1 CABLE), AND 497' OF 5/C CABLE (2 CABLES), BETWEEN HANDHOLE IN SOUTHEAST CORNER OF WB FRONTAGE ROAD AND THE MAST ARM POLE. (TOTAL 995')
- NOTE 7: REMOVE 451' OF 1 PAIR LEAD-IN CABLE (1 CABLE) BETWEEN THE HANDHOLE IN THE SOUTHEAST CORNER OF WB FRONTAGE ROAD AND THIS HANDHOLE. (TOTAL 451')

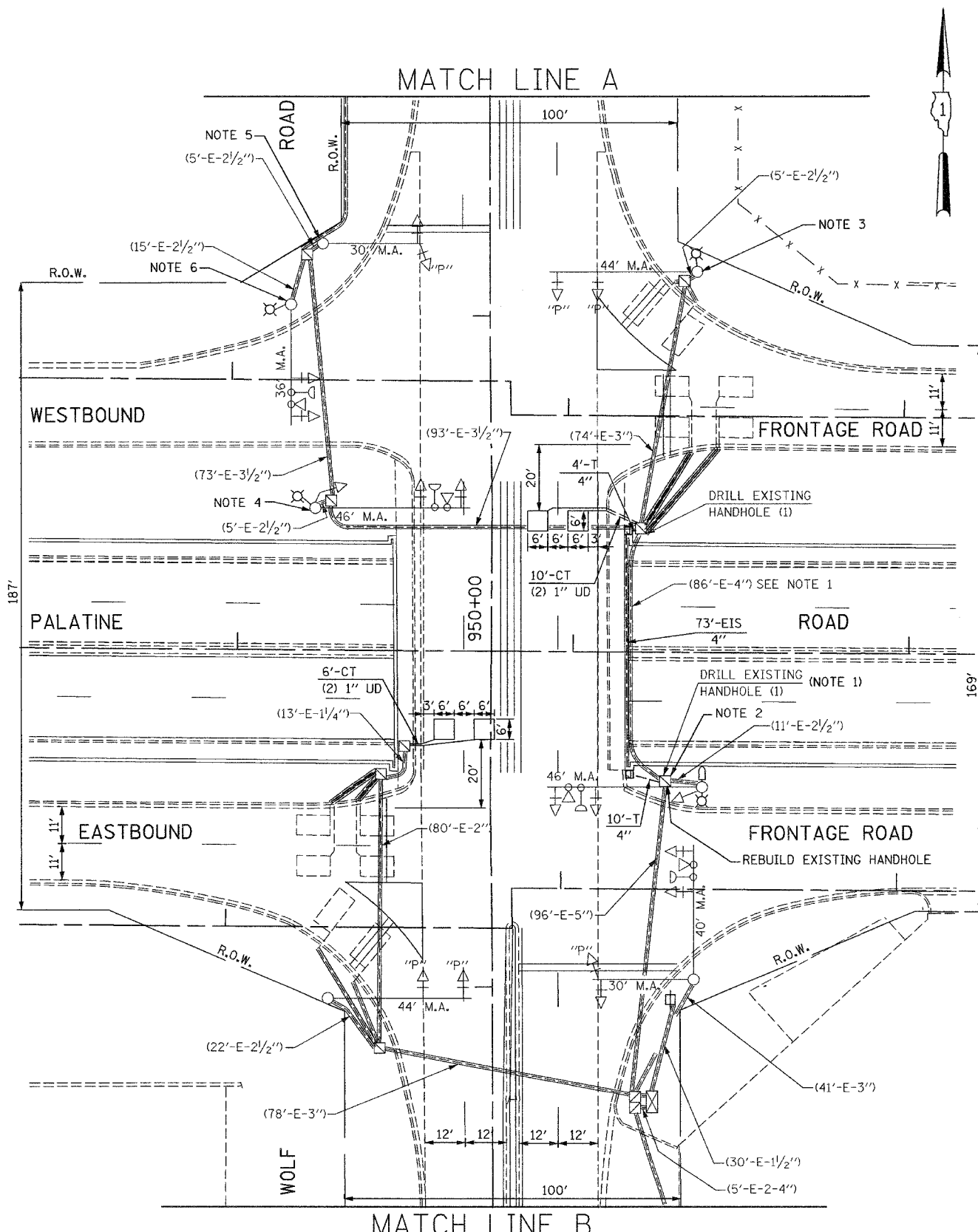

**TRAFFIC SIGNAL LEGEND**

	PROPOSED	EXISTING
CONTROLLER	[Symbol]	[Symbol]
SERVICE INSTALLATION	[Symbol]	[Symbol]
SIGNAL HEAD	[Symbol]	[Symbol]
SIGNAL HEAD WITH BACKPLATE	[Symbol]	[Symbol]
SIGNAL HEAD, PEDESTRIAN	[Symbol]	[Symbol]
SIGNAL POST	[Symbol]	[Symbol]
MAST ARM ASSEMBLY AND POLE, STEEL	[Symbol]	[Symbol]
MAST ARM ASSEMBLY AND POLE, ALUMINUM	[Symbol]	[Symbol]
COMBINATION MAST ARM ASSEMBLY AND POLE, STEEL WITH LUMINAIRE	[Symbol]	[Symbol]
UNIT DUCT	[Symbol]	[Symbol]
COMMON TRENCH	[Symbol]	[Symbol]
HANDHOLE	[Symbol]	[Symbol]
HEAVY DUTY HANDHOLE	[Symbol]	[Symbol]
DOUBLE HANDHOLE	[Symbol]	[Symbol]
GALVANIZED STEEL CONDUIT IN TRENCH OR PUSHED	[Symbol]	[Symbol]
PEDESTRIAN PUSHBUTTON DETECTOR	[Symbol]	[Symbol]
DETECTOR LOOP	[Symbol]	[Symbol]
CAST IRON JUNCTION BOX	[Symbol]	[Symbol]
EMERGENCY VEHICLE SYSTEM DETECTOR	[Symbol]	[Symbol]
CONFIRMATION BEACON	[Symbol]	[Symbol]
SIGNAL HEAD, OPTICALLY PROGRAMMED	[Symbol]	[Symbol]
CONDUIT SPLICE	[Symbol]	[Symbol]
WOOD POLE	[Symbol]	[Symbol]
RACEWAY FOR MAGNETIC DETECTOR, TYPE I OR TYPE II	[Symbol]	[Symbol]
VEHICLE DETECTOR, NON COMPENSATED MAGNETIC TYPE	[Symbol]	[Symbol]
RAILROAD CONTROL CABINET	[Symbol]	[Symbol]
TELEPHONE CONNECTION	[Symbol]	[Symbol]
ILLUMINATED SIGN, FIBER OPTIC "NO LEFT TURN"	[Symbol]	[Symbol]
ILLUMINATED SIGN, FIBER OPTIC "NO RIGHT TURN"	[Symbol]	[Symbol]
MICROWAVE VEHICLE SENSOR	[Symbol]	[Symbol]
AVIATION RED OBSTRUCTION LIGHT	[Symbol]	[Symbol]
AVIATION PHOTOELECTRIC CONTROL	[Symbol]	[Symbol]
STAINLESS STEEL JUNCTION BOX ATTACHED TO STRUCTURE	[Symbol]	[Symbol]

**GO** GANDHI AND ASSOCIATES, INC.  
ENGINEERS AND PLANNERS  
6035 N. NORTHWEST HIGHWAY  
SUITE 303  
CHICAGO, ILLINOIS 60631 TEL: (773) 774-5910

J:\projects\projects 2000\palatine\signal plans (november 2004)\wolf\08-wolf\outhphoto\_ext1st1.dgn  
09 MAR 2005  
19:33:28

REVISIONS	
NAME	DATE

ILLINOIS DEPARTMENT OF TRANSPORTATION  
PALATINE ROAD: WISCONSIN CENTRAL RR TO  
US 45/ILL 21 (Milwaukee Ave.)

EXISTING TRAFFIC SIGNAL PLAN MODIFICATION  
WOLF ROAD AT EAST AND WESTBOUND  
FRONTAGE ROADS TO AND FROM PALATINE ROAD  
SHEET 1 OF 2

SCALE: 1"=20'  
DATE: 01/14/2005

DRAWN BY: JF/BC  
DESIGNED BY: PKG/RRM  
CHECKED BY: PKG/RRM