

F.A.P. RTE.	SECTION	COUNTY	TOTAL SHEETS	SHEET NO.
305	2004-108 BR	COOK	72	18

CONTRACT NO. 62853

MAINTENANCE OF TRAFFIC STAGING

PRE-STAGE

CONSTRUCT TEMPORARY PAVEMENT AS NEEDED FOR STAGE 1 RAMPS.

STAGE 1 - SUGGESTED TRAFFIC PLAN

WEST OF RAILROAD: CLOSE SOUTH FRONTAGE ROAD AT WHEELING ROAD, EXCEPT FOR LOCAL TRAFFIC. PLACE AND MAINTAIN BARRICADES ON NORTH FRONTAGE ROAD EAST OF LAST DRIVEWAY ACCESS.

EAST OF RAILROAD: PLACE AND MAINTAIN BARRICADES ON SOUTH FRONTAGE ROAD JUST EAST OF WORK ZONE. PROVIDE TWO-WAY TRAFFIC ON NORTH FRONTAGE ROAD FROM ALLSTATE DRIVEWAY TO SOUTH DRIVE. CLOSE NORTH FRONTAGE ROAD WEST OF THE ALLSTATE DRIVEWAY.

SUGGESTED WORK ZONES:
EAST AND WEST FRONTAGE ROAD BRIDGES OVER PALATINE ROAD.

STAGE 2A & 2B - SUGGESTED TRAFFIC PLAN

WOLF ROAD:
MAINTAIN ONE LANE OF TRAFFIC FROM EACH DIRECTION APPROACHING INTERSECTION WITH PALATINE ROAD AND ACROSS THE BRIDGE. PROVIDE TEMPORARY BARRIER WALL OUTSIDE OF THE TRAFFIC FOR STAGE 2A.

SUGGESTED WORK ZONES:
STAGE 2A: REPLACE THE THREE OUTER BEAMS ON BOTH SIDE OF THE BRIDGE.

STAGE 2B: CONSTRUCT THE CONCRETE OVERLAY ON THE OUTSIDE OF THE BRIDGE.

STAGE 3 - SUGGESTED TRAFFIC PLAN

WOLF ROAD:
MAINTAIN ONE LANE OF TRAFFIC EACH DIRECTION APPROACHING THE INTERSECTION WITH PALATINE ROAD. RUN THE TRAFFIC ALONG THE OUTSIDE EDGES OF THE BRIDGE.

SUGGESTED WORK ZONES:
CONSTRUCT THE REPAIRS AND CONCRETE OVERLAY ON THE INSIDE OF THE BRIDGE.

GENERAL NOTES - TRAFFIC CONTROL

THE CONTRACTOR SHALL NOTIFY JAMES SHERIDAN AT CITY OF PROSPECT HEIGHTS AT 847-398-6070 X 209 AND RICHARD GLENZ AT VILLAGE OF WHEELING AT 847-459-2985 ONE WEEK PRIOR TO EACH MAINTENANCE OF TRAFFIC STAGE AND ONE DAY PRIOR TO LANE CLOSURES ON THE FRONTAGE ROADS.

EAST AND WEST FRONTAGE ROAD BRIDGE SHALL BE OPEN TO TRAFFIC PRIOR TO DETOURING EXPRESS LANES FOR THE REMOVAL OF WOLF ROAD BRIDGE BEAMS.

TYPE II BARRICADES WHEN USED FOR APPROACH TAPERS AND TRAFFIC SHIFTS. AS INDICATED ON THE STATE STANDARDS OR SHOWN ON THE PLANS SHALL BE DIRECTION INDICATOR BARRICADES.

DRUMS/BARRICADES SHALL BE SPACED AT 50' C-C ON TANGENTS, 25' C-C ON TAPERS, AND 12' C-C ON RADII.

THE OVERLAY OF WOLF ROAD BRIDGE SHALL BE PERFORMED HALF AT A TIME IN ORDER TO MAINTAIN PEDESTRIAN ACCESS ACROSS THE BRIDGE ON THE HALF NOT UNDER CONSTRUCTION.

MILLING AND RESURFACING THE WOLF ROAD APPROACH PAVEMENTS AND FRONTAGE ROAD INTERSECTIONS SHALL BE PERFORMED AFTER BRIDGE CONSTRUCTION IS COMPLETE. LANE CLOSURES SHALL BE PER HIGHWAY STANDARD 701602.

ALL MAINTENANCE OF TRAFFIC SHALL BE INCLUDED IN THE COST OF TRAFFIC CONTROL AND PROTECTION SPECIAL EXCEPT THE COST OF TEMPORARY PAVEMENT MARKING, TEMPORARY PAVEMENT, CONCRETE BARRIER AND ATTENUATORS.

THE CONTRACTOR IS ADVISED THAT IN THE EVENT OF SNOW, HE/SHE WILL BE RESPONSIBLE FOR THE IMMEDIATE REMOVAL OF ANY MAINTENANCE OF TRAFFIC PROTECTIVE DEVICES REQUIRED FOR HIS/HER OPERATIONS THAT WOULD INTERFERE WITH SNOW REMOVAL OPERATIONS PERFORMED BY THE STATE OR LOCAL AGENCY.

ACCESS TO DRIVEWAYS WITHIN PROJECT LIMITS IS TO BE PROVIDED AT ALL TIMES.

THE CONTRACTOR SHALL COORDINATE CONSTRUCTION ACTIVITIES WITH THE RESPECTIVE UTILITIES AND THE LOCAL AGENCIES INVOLVED.

TEMPORARY SIGNING:

- A. THE CONTRACTOR SHALL NOT MOUNT SIGNS ON EXISTING SIGNS.
- B. EXACT SIGN LOCATIONS WILL BE DETERMINED BY THE RESIDENT ENGINEER IN THE FIELD.
- C. EXISTING TRAFFIC CONTROL SIGNS AND MESSAGES THAT ARE IN CONFLICT WITH THE PROPOSED MAINTENANCE OF TRAFFIC SHALL BE TEMPORARILY COVERED OR MODIFIED WITH TEMPORARY OVERLAY AS SHOWN ON PLANS AND AS DIRECTED BY THE ENGINEER

D. ALL TEMPORARY SIGNS AS SHOWN ON THE MOT PLAN SHEETS AND HIGHWAY STANDARDS FOR THE TRAFFIC CONTROL SHALL NOT BE PAID SEPARATELY BUT SHALL BE INCLUDED IN THE PRICE FOR "TRAFFIC CONTROL AND PROTECTION (SPECIAL)"

LEGEND

- DRUMS W/STEADY BURN LIGHTS
- ←+ DIRECTION INDICATOR BARRICADE
- ← TRAFFIC LANE
- ↓ TRAFFIC SIGN (AS NOTED)
- ▨ TEMPORARY PAVEMENT
- TEMPORARY CONCRETE BARRIER
- ▩ WORK ZONE
- ⌈ TYPE III BARRICADE WITH FLASHING LIGHT
- ↑ ARROW BOARD
- ⊞ TYPE II BARRICADE W/STEADY BURN LIGHT

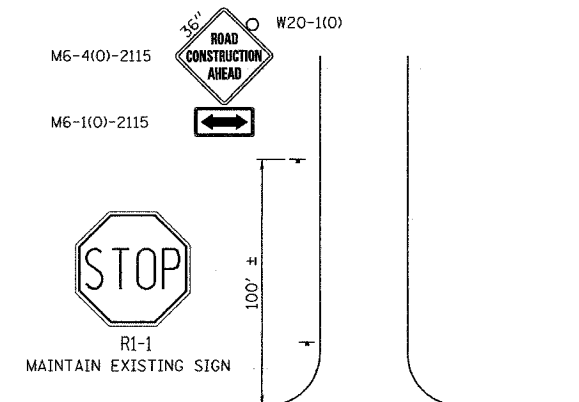

TYPICAL SIGNING AT ALL CROSS STREETS INTERSECTING THE TRAFFIC CONTROL ZONE

REVISIONS	
NAME	DATE

ILLINOIS DEPARTMENT OF TRANSPORTATION
PALATINE ROAD UNDER WCR, UNDER W. FRONTAGE RD.,
UNDER E. FRONTAGE RD. & UNDER WOLF RD.

**MAINTENANCE OF TRAFFIC
STAGING NOTES AND LEGEND**

SCALE: NONE
DATE: 02/05

DRAWN BY: ACE/CAD
CHECKED BY: TAE

AMERICAN
CONSULTING ENGINEERS