

F.A.I. RTE.	SECTION	COUNTY	TOTAL SHEETS	SHEET NO.
94/90		COOK	598	437
STA.	TO STA.			
FED. ROAD DIST. NO.	ILLINOIS	FED. AID PROJECT		
62302	(1818, ETC.	2324.6-1PR-9		

SOUTHBOUND LOCAL LANES PROFILE GRADE

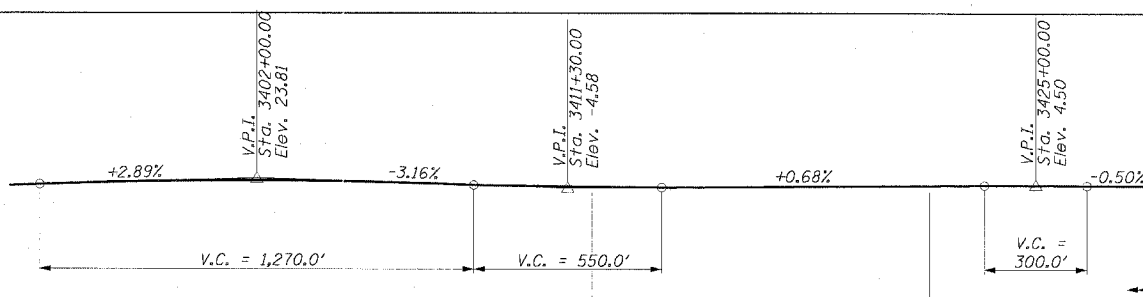

SOUTHBOUND EXPRESS LANES PROFILE GRADE

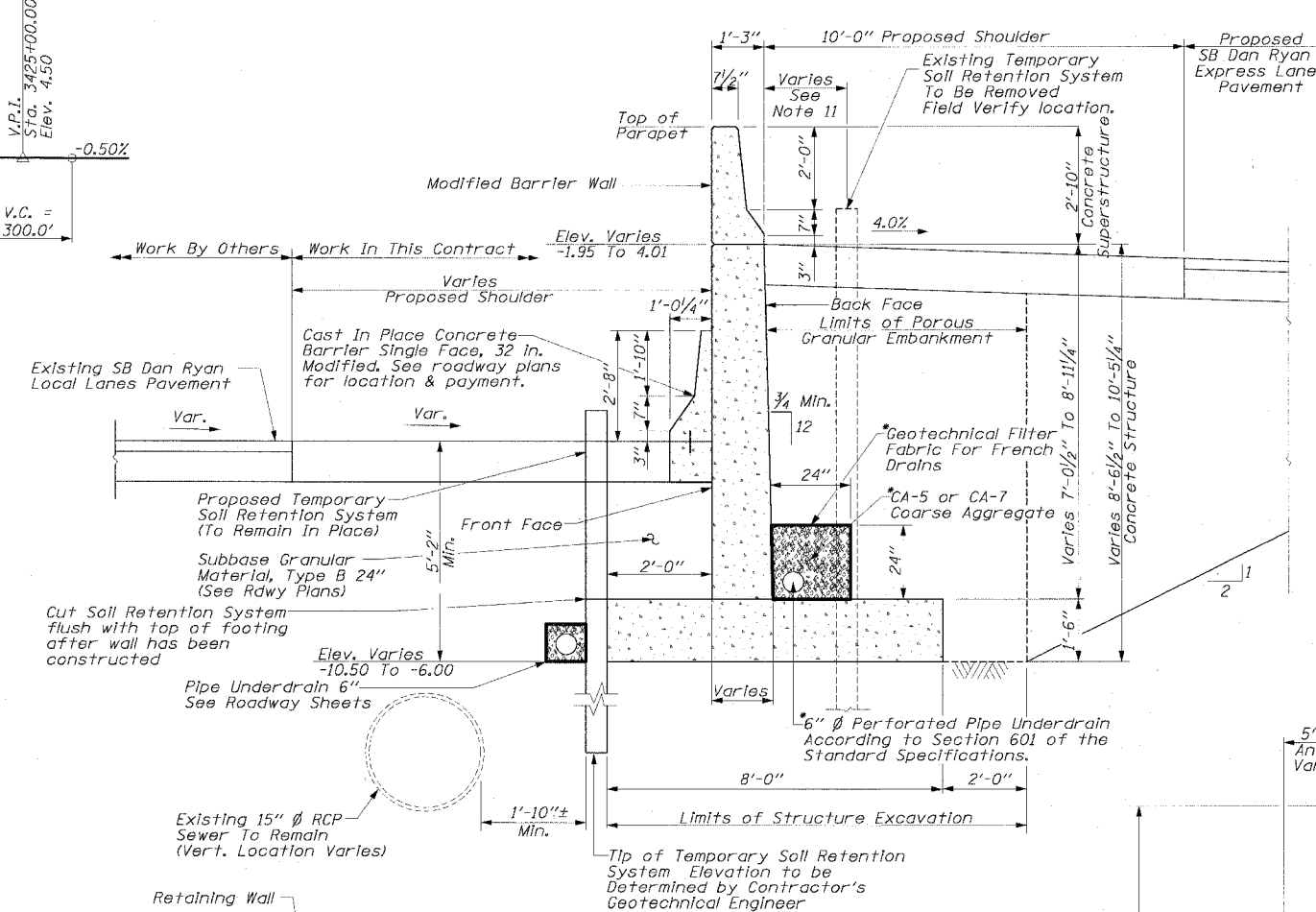
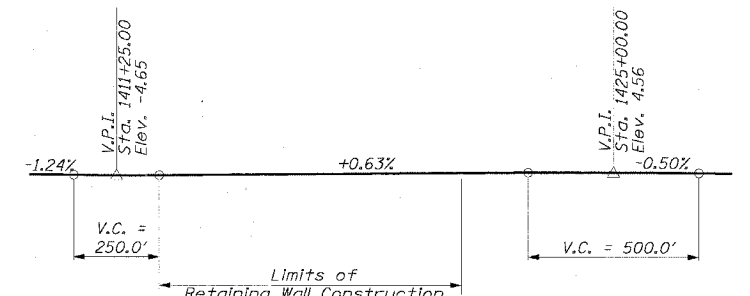

TYPICAL SECTION B-B

Cost Included with Pay Item
Pipe Underdrains for Structures, 6"

TOTAL BILL OF MATERIAL

ITEM	Unit	Quantity
Porous Granular Embankment	Cu. Yd.	965
Structure Excavation	Cu. Yd.	2,695
Concrete Structures	Cu. Yd.	865.0
Concrete Superstructure	Cu. Yd.	86.0
Protective Coat	Sq. Yd.	1,570
Reinforcement Bars, Epoxy Coated	Pounds	109,910
Pipe Underdrains for Structures 6"	Foot	1,100
Temporary Soil Retention System (to Remain In Place)	Sq. Ft.	16,000

NOTES:

- Construction joints shall be provided at 30'-0" intervals and expansion joints at 90'-0" intervals, unless otherwise noted. Reinforcing steel shall be placed continuously through construction joints.
- The back face of Retaining Walls shall be waterproofed according to Article 503.18 of the Standard Specifications.
- A protective coat shall be applied according to Section 503 of the Standard Specifications to all concrete surfaces not in contact with soil.
- Existing utilities in conflict with retaining wall shall be abandoned or relocated according to directions given on the Roadway Plans.
- All exposed concrete edges shall have a 3/4" by 45° chamfer except where shown otherwise. Chamfer on vertical edges shall be continued a minimum of 1 foot below the finished ground line.
- Reinforcement bars shall conform to the requirements of AASHTO M31, M42 or M53 Grade 60.
- Reinforcement bars bending dimensions are out to out.
- Reinforcement bars designated "E" shall be epoxy coated.
- The Contractor shall submit a temporary soil retention system design including plan details and calculations for review and acceptance by the Engineer.
- All construction joints shall be bonded.
- Existing Temporary Soil Retention System is to be removed as needed to construct the retaining wall and the proposed pavement. Portions of the existing temporary soil retention system may be left in place with the approval of the Engineer. Its location varies and it may be located at either side of the proposed wall. The cost of removal is to be included in the cost of Structure Excavation.

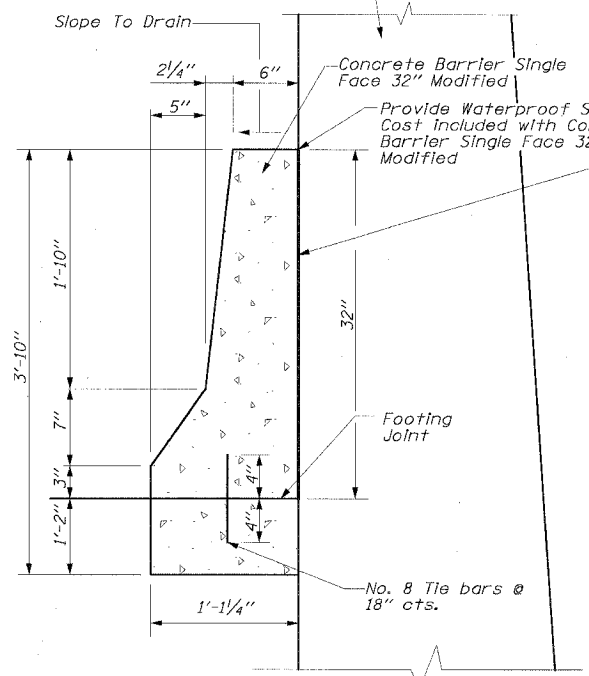

CONCRETE BARRIER SINGLE FACE, 32 IN. MODIFIED
(Used Adjacent to Retaining Wall)

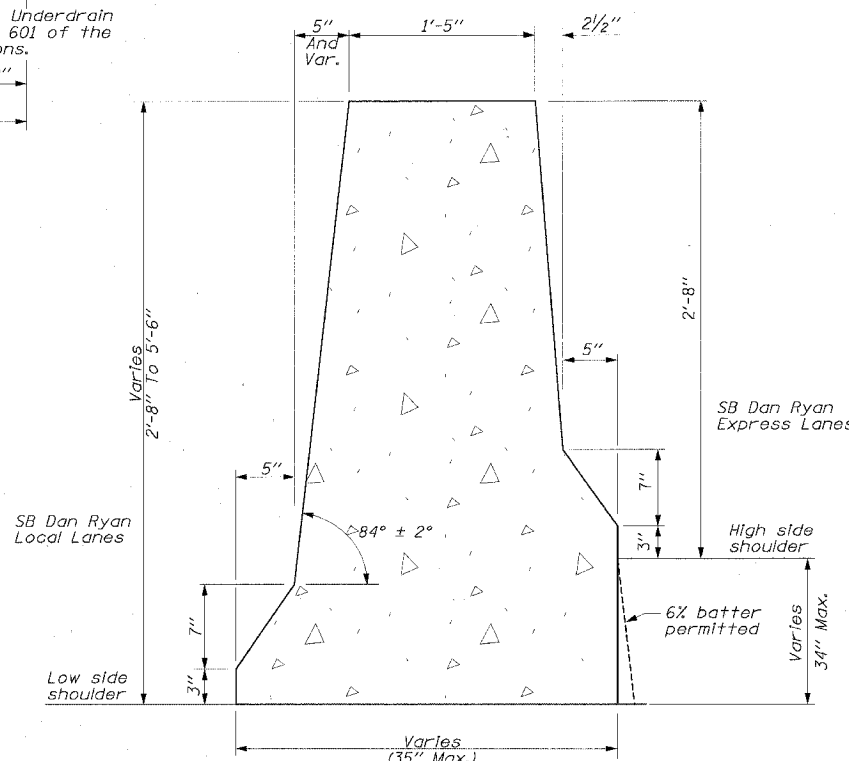

SECTION A-A
(See Standard 637001-02)

REVISIONS	NAME	DATE

ILLINOIS DEPARTMENT OF TRANSPORTATION
F.A.I. 94/90 (DAN RYAN EXPRESSWAY)
31ST STREET TO 71ST STREET
SB EXPRESS LANE RECONSTRUCTION
RETAINING WALL SEL
BARRIER WALL DETAILS
STRUCTURE NO. NONE

SCALE: NOT TO SCALE
DATE: 1/1/05

DRAWN BY: ABW
CHECKED BY: EL

Edwards AND Kelcey
ONE NORTH FRANKLIN
CHICAGO, IL 60606
PHONE: (312) 251-3000
FAX: (312) 251-3015
WEB: WWW.EKCORP.COM

06/24/2005 12:45:51 PM