

EXISTING CONDITIONS & REMOVALS

F.A.I.	SECTION	COUNTY	TOTAL SHEETS	SHEET NO.
94/90	*	COOK	598	210
STA.	TO STA.			
FED. ROAD DIST. NO.	ILLINOIS FED. AID PROJECT			
62302	• (1818, ETC., 2324.6-1P)R-9			

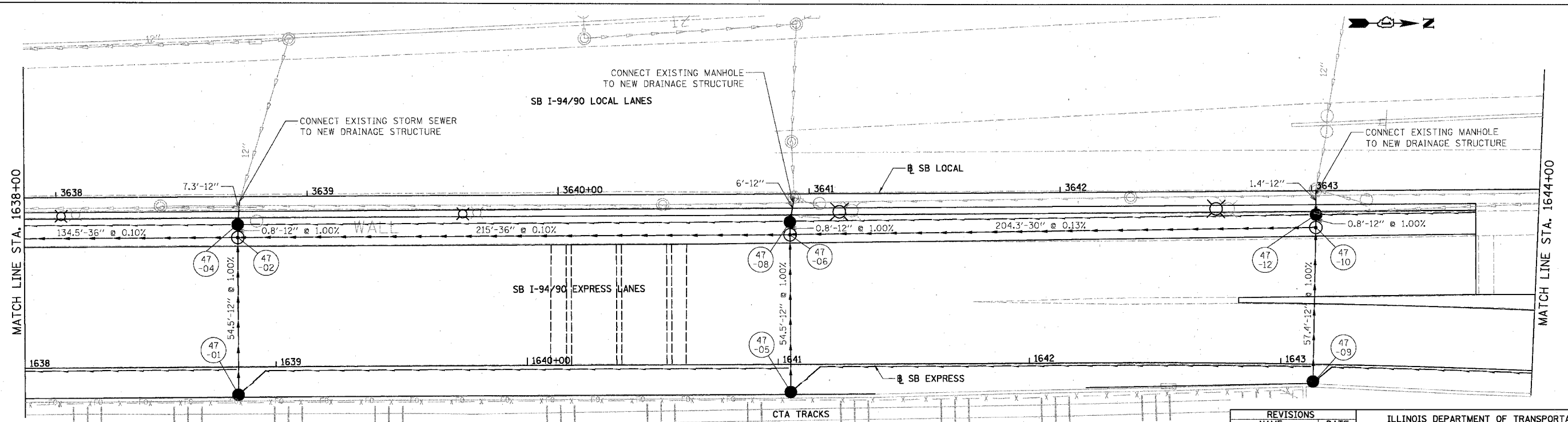

BOWMAN, BARRETT & ASSOCIATES INC
CONSULTING ENGINEERS
Chicago, Illinois
312.228.0100
www.bbandainc.com

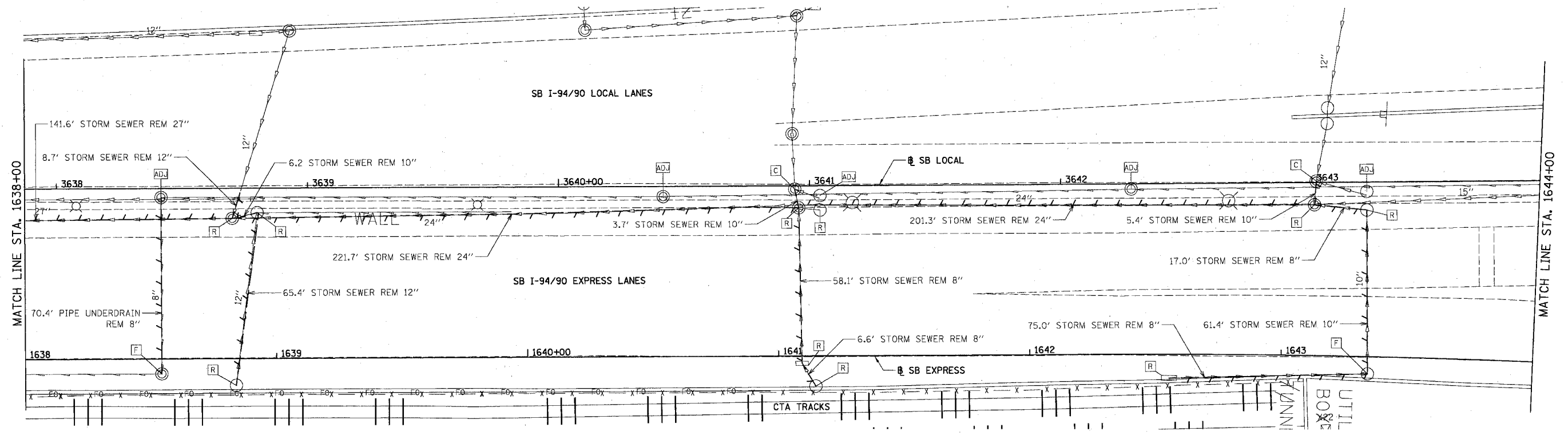
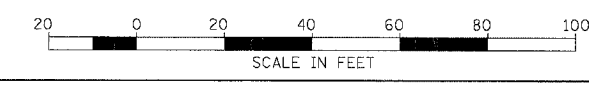

PROPOSED CONDITIONS

REVISIONS	NAME	DATE

ILLINOIS DEPARTMENT OF TRANSPORTATION
F.A.I. 94/90 (DAN RYAN EXPRESSWAY)
31ST STREET TO 71ST STREET
SB EXPRESS LANE RECONSTRUCTION
DRAINAGE AND UTILITIES PLAN
SOUTHBOUND STA. 1638+00 TO STA. 1644+00
SCALE: 1"=20'
DATE: 07/07/05
DRAWN BY: OC
CHECKED BY: DDM

DU-47

06/29/2005 12:58:22 PM