

EXISTING CONDITIONS & REMOVALS

F.A.I.	SECTION	COUNTY	TOTAL SHEETS	SHEET NO.
94/90	*	COOK	598	208
STA.		TO STA.		
62302		ILLINOIS FED. AID PROJECT		
FED. ROAD DIST. NO. • (1818, ETC, 2324.6-1)PR-9				

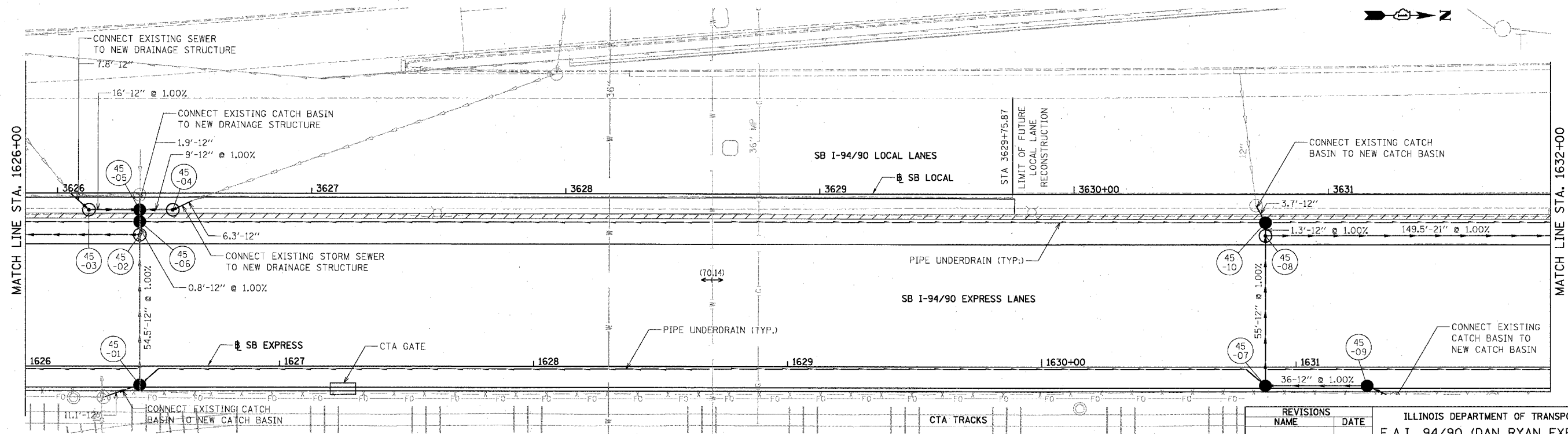

BOWMAN, BARRETT & ASSOCIATES INC.  
CONSULTING ENGINEERS  
Chicago, Illinois  
312.228.0100  
www.bbandainc.com

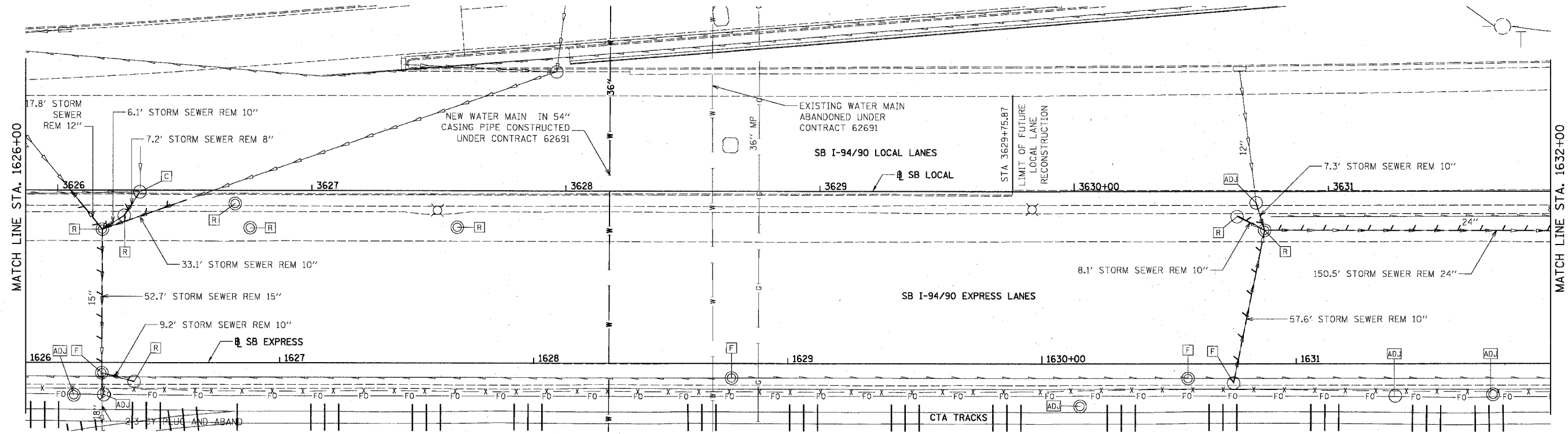
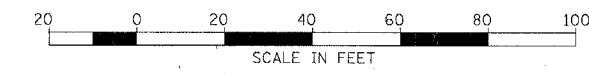

PROPOSED CONDITIONS

REVISIONS NAME	DATE

ILLINOIS DEPARTMENT OF TRANSPORTATION  
F.A.I. 94/90 (DAN RYAN EXPRESSWAY)  
31ST STREET TO 71ST STREET  
SB EXPRESS LANE RECONSTRUCTION  
DRAINAGE AND UTILITIES PLAN  
SOUTHBOUND STA. 1626+00 TO STA. 1632+00  
SCALE: 1"=20'  
DATE: 07/07/05  
DRAWN BY: CC  
CHECKED BY: DDM

DU-45

12/5/2005 12:55:22 PM