

F.A.I.	SECTION	COUNTY	TOTAL SHEETS	SHEET NO.
94/90		COOK	598	111
STA.	TO STA.			
FED. ROAD DIST. NO.	ILLINOIS	FED. AID PROJECT		
62302	*118, ETC, 2324.6-1PR-9			

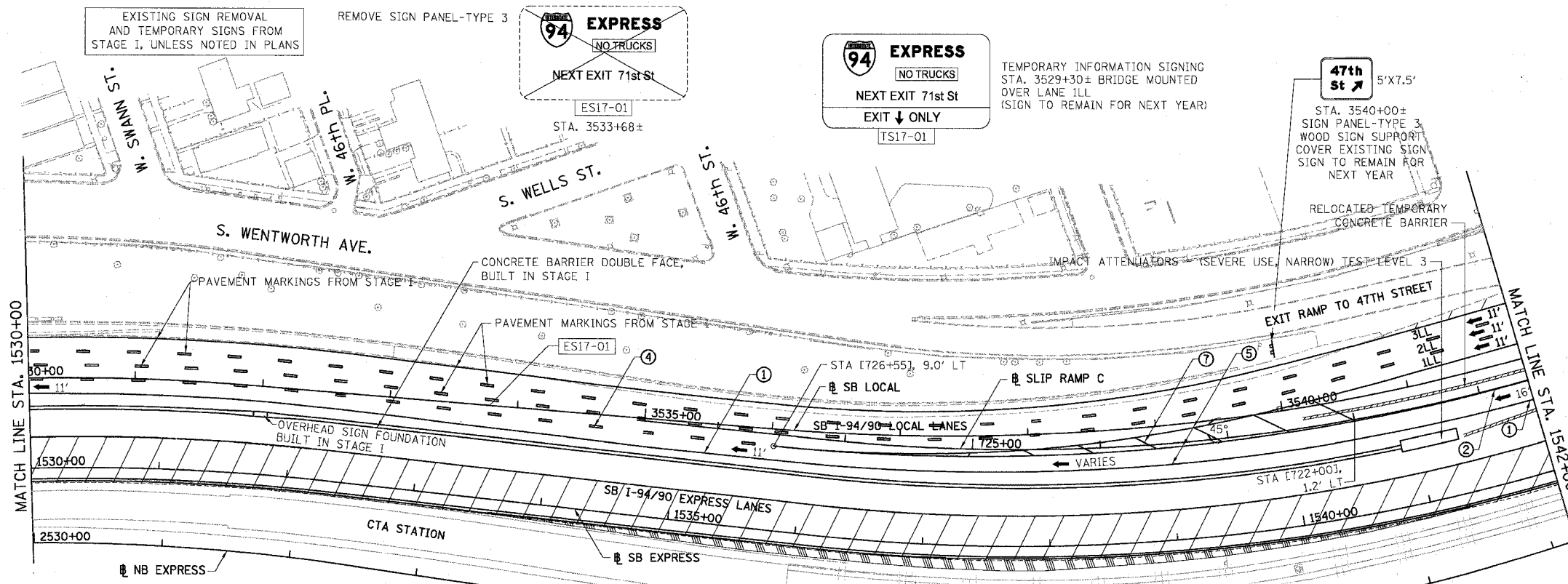

LEGEND

- WORK ZONE
- TEMPORARY PAVEMENT
- ILL TRAFFIC LANE & DIRECTION OF TRAFFIC
- DRUM OR BARRICADE TYPE II WITH STEADY BURN LIGHT
- IMPACT ATTENUATORS, TEMPORARY (NON-REDIRECTIVE), TEST LEVEL 3
- BARRICADE TYPE III
- TEMPORARY CONCRETE BARRIER
- LINE 4" (YELLOW EDGE LINE)
- LINE 4" (WHITE EDGE LINE)
- LINE 4" (SKIP DASH, 6' SKIP - 2' DASH, WHITE)
- LINE 5" (SKIP DASH, 30' SKIP - 10' DASH, WHITE)
- LINE 8" (WHITE GORE LINE)
- LINE 8" (SKIP DASH, 12' SKIP - 3' DASH, WHITE)
- LINE 12" (DIAGONAL, 30' C-C)
- LINE 12" (DIAGONAL, 500' C-C)
- LETTERS AND SYMBOLS
- EXISTING SIGNS
- TEMPORARY SIGNS

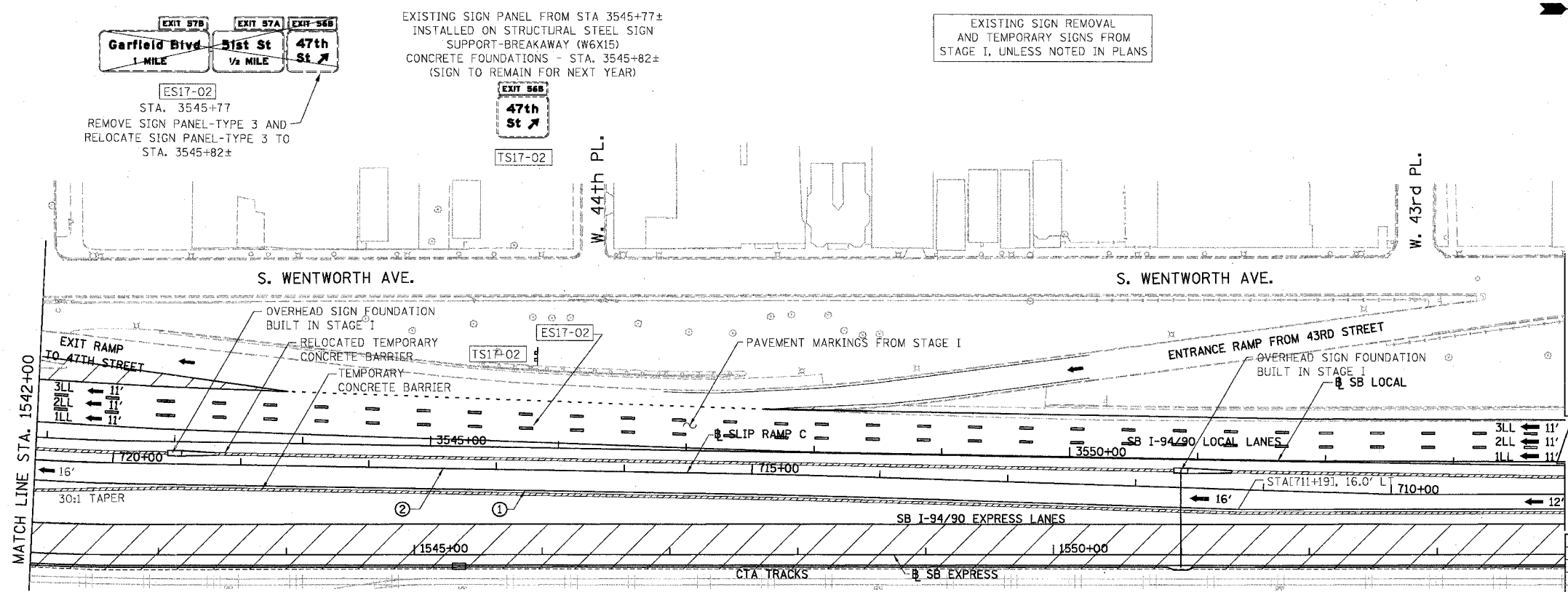

STATIONING

- +++ STATION PROVIDED FROM THE I-90/94 EXPRESS LANES
- (+++ STATION PROVIDED FROM THE I-90/94 LOCAL LANES
- [+++ STATION PROVIDED FROM THE SLIP RAMP

NOTE:

ALL PAVEMENT MARKINGS ON THIS SHEET WILL BE PAVEMENT MARKING TAPE, TYPE III, UNLESS OTHERWISE NOTED.

MOT-26

REVISIONS	DATE

ILLINOIS DEPARTMENT OF TRANSPORTATION
F.A.I. 94/90 (DAN RYAN EXPRESSWAY)
 31ST STREET TO 71ST STREET
 SB EXPRESS LANE RECONSTRUCTION
 MAINTENANCE OF TRAFFIC PLAN STAGE 2
 SOUTHBOUND STA. 1530+00 TO STA. 1554+00
 SCALE: 1"=50'
 DATE: 07/07/05
 DRAWN BY: RA
 CHECKED BY: RS

BOWMAN, BARRETT & ASSOCIATES INC
 CONSULTING ENGINEERS
 Chicago, Illinois
 312.228.0100
 www.bbainc.com

