

F.A.I.	SECTION	COUNTY	TOTAL SHEETS	SHEET NO.
94/90	*	COOK	598	105
STA. 1626+00		TO STA.		
FED. ROAD DIST. NO.	ILLINOIS	FED. AID PROJECT		
62302	*1818, ETC, 2324.6-1PIR-9			

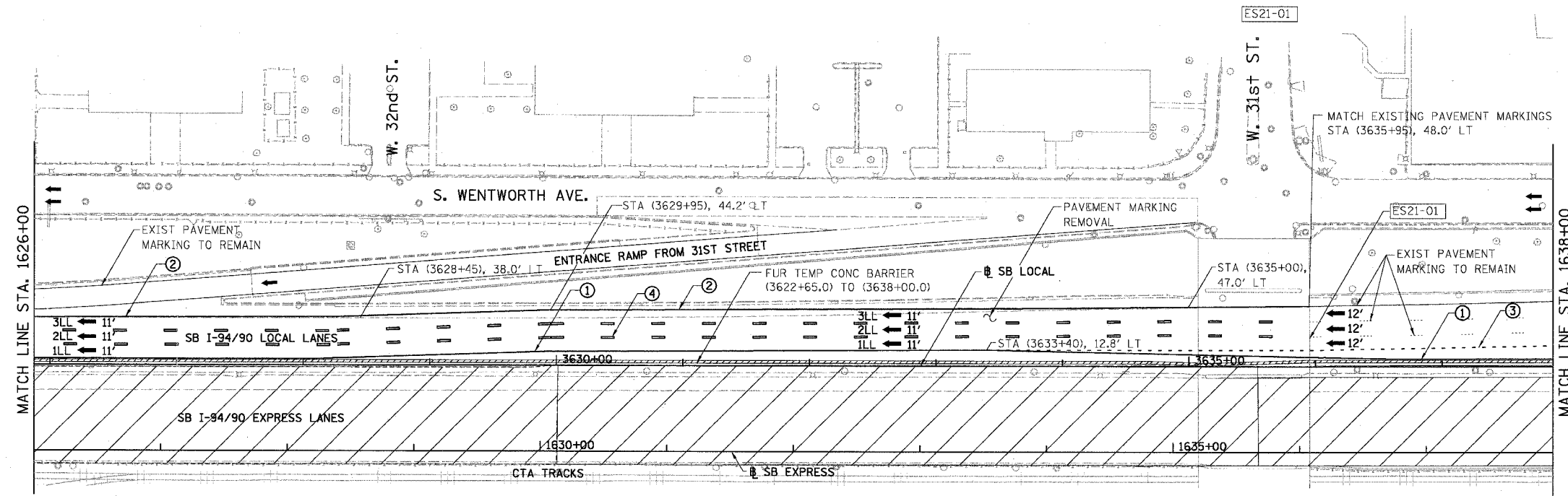

EXIT 55B
Pershing Rd
1/2 MILE

EXIT 55A
35th St
1/4 MILE



- LEGEND**
- WORK ZONE
 - TEMPORARY PAVEMENT
 - ILL TRAFFIC LANE & DIRECTION OF TRAFFIC
 - DRUM OR BARRICADE TYPE II WITH STEADY BURN LIGHT
 - IMPACT ATTENUATORS, TEMPORARY (NON-REDIRECTIVE), TEST LEVEL 3
 - BARRICADE TYPE III
 - TEMPORARY CONCRETE BARRIER
 - ① LINE 4" (YELLOW EDGE LINE)
 - ② LINE 4" (WHITE EDGE LINE)
 - ③ LINE 4" (SKIP DASH, 6' SKIP - 2' DASH, WHITE)
 - ④ LINE 5" (SKIP DASH, 30' SKIP - 10' DASH, WHITE)
 - ⑤ LINE 8" (WHITE GORE LINE)
 - ⑥ LINE 8" (SKIP DASH, 12' SKIP - 3' DASH, WHITE)
 - ⑦ LINE 12" (DIAGONAL, 30' C-C)
 - ⑧ LINE 12" (DIAGONAL, 500' C-C)
 - ⑨ LETTERS AND SYMBOLS
 - ESX-XX EXISTING SIGNS
 - TSX-XX TEMPORARY SIGNS

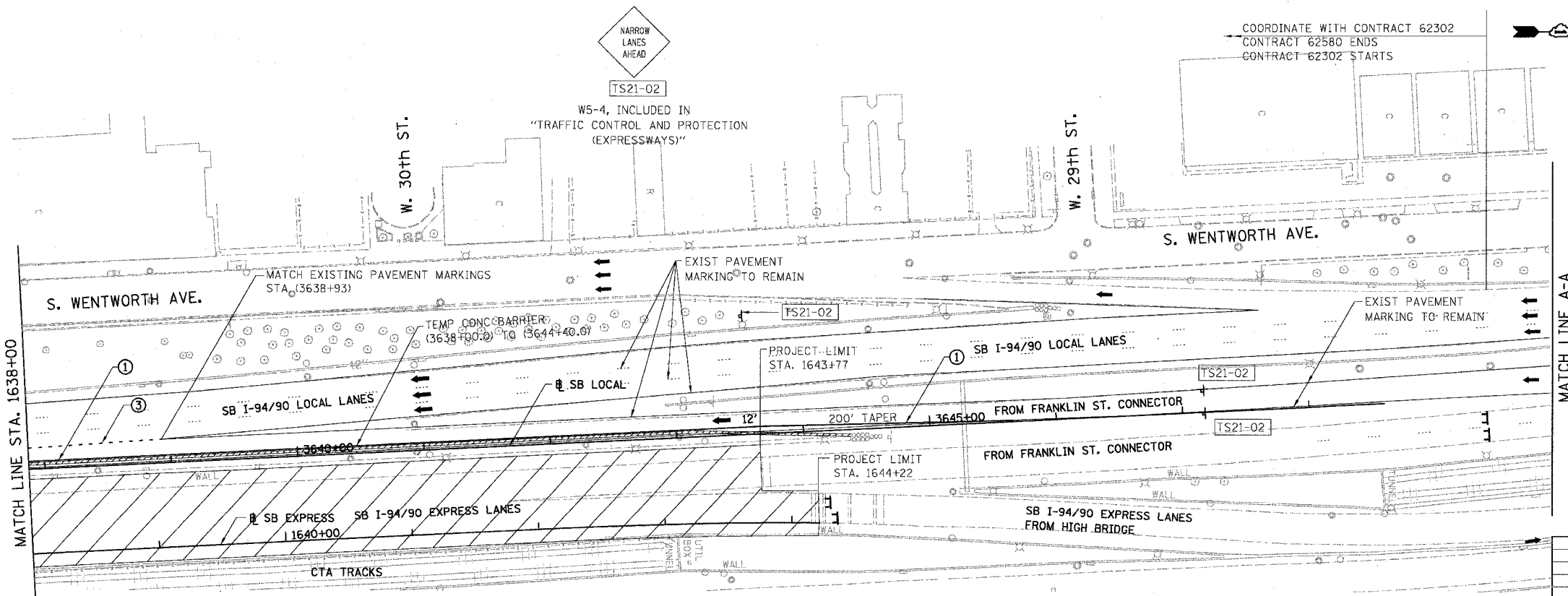

- STATIONING**
- +++.** STATION PROVIDED FROM THE I-90/94 EXPRESS LANES
 - (+**.**.) STATION PROVIDED FROM THE I-90/94 LOCAL LANES
 - [+**.**.] STATION PROVIDED FROM THE SLIP RAMP

NOTE:
ALL PAVEMENT MARKINGS ON THIS SHEET WILL BE PAVEMENT MARKING TAPE, TYPE III, UNLESS OTHERWISE NOTED.

BOWMAN, BARRETT & ASSOCIATES INC.
CONSULTING ENGINEERS
Chicago, Illinois
312.228.0100
www.bbainc.com

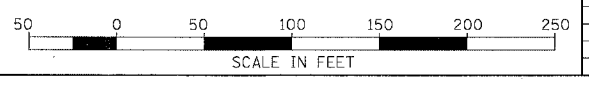

REVISIONS NAME	DATE

MOT-20

ILLINOIS DEPARTMENT OF TRANSPORTATION
F.A.I. 94/90 (DAN RYAN EXPRESSWAY)
31ST STREET TO 71ST STREET
SB EXPRESS LANE RECONSTRUCTION
MAINTENANCE OF TRAFFIC PLAN STAGE 1
SOUTHBOUND STA. 1626+00 TO STA.

SCALE: 1"=50'
DATE: 01/07/05

DRAWN BY: RA
CHECKED BY: RS

16-660-0000-001-INS-SHEET 15/660-15/107/04/05