

STATE OF ILLINOIS
DEPARTMENT OF TRANSPORTATION

F.A.I. RTE.	SECTION	COUNTY	TOTAL SHEETS	SHEET NO.
57	D7 BRIDGE REPAIRS 2027-7	COLES	13	1
		ILLINOIS	CONTRACT NO. 74E43	

FOR INDEX OF SHEETS, SEE SHEET NO. 2
ADT: 3650

PROPOSED HIGHWAY PLANS

FAI ROUTE 57 (I-57) SECTION D7 BRIDGE REPAIRS 2027-7 BRIDGE DECK OVERLAY COLES COUNTY

C-97-081-26

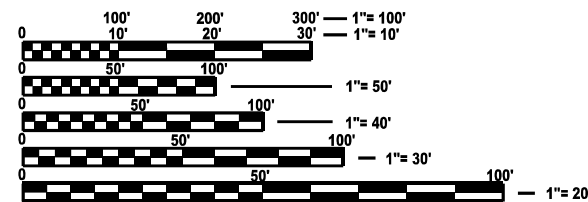
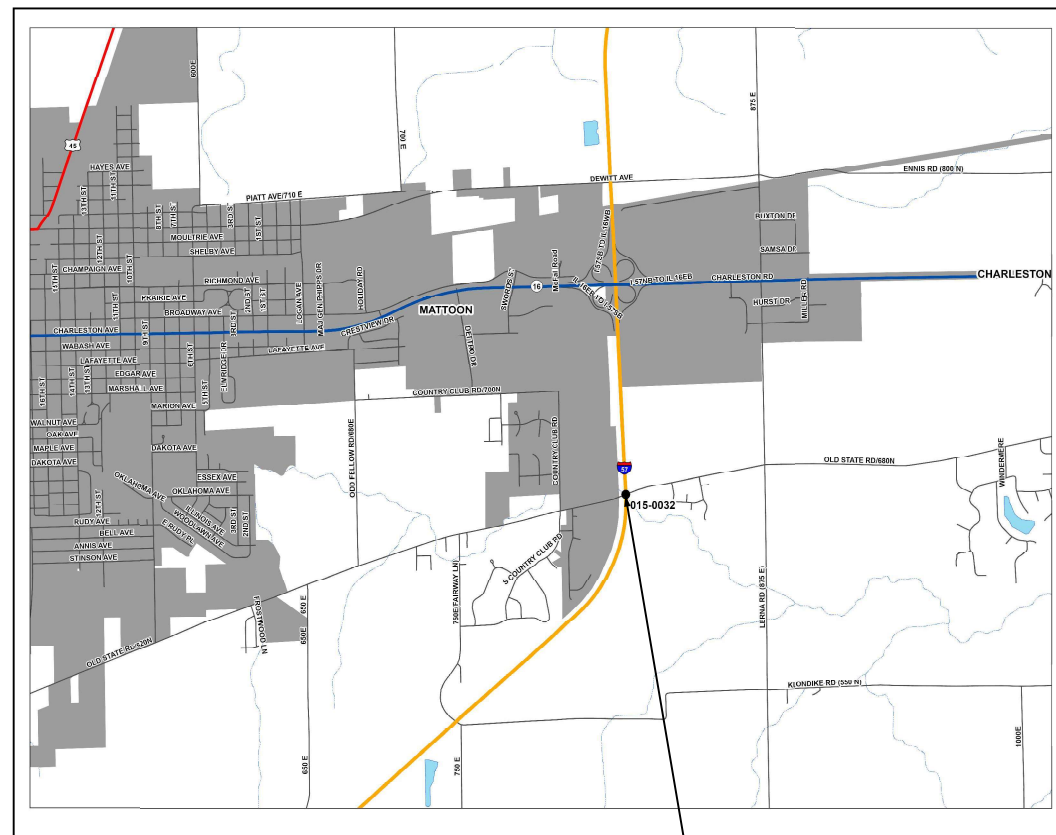
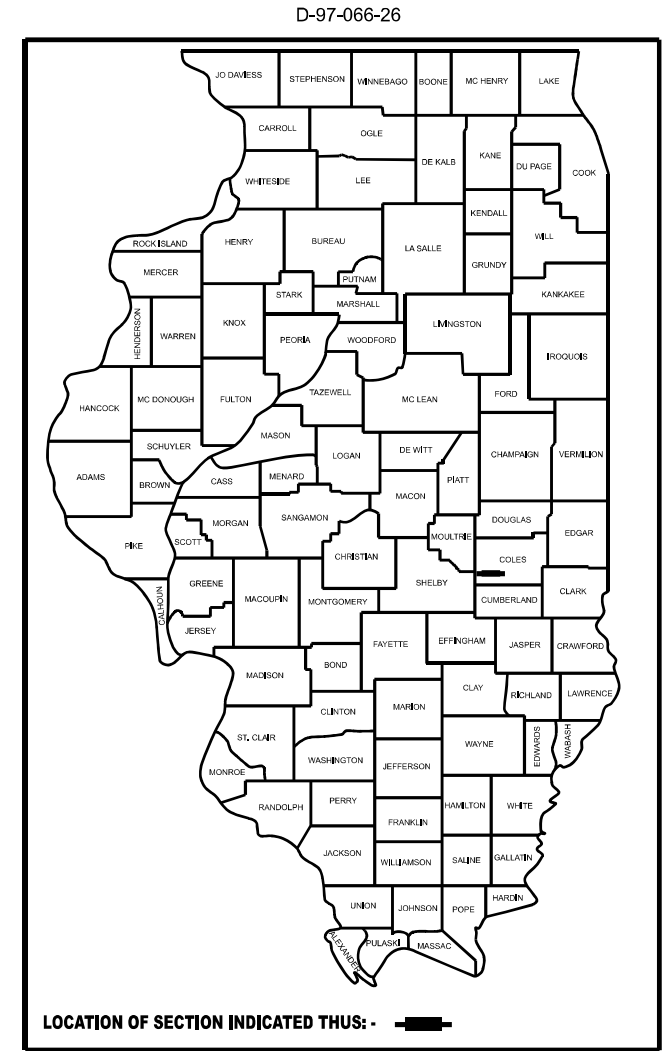

FULL SIZE PLANS HAVE BEEN PREPARED USING STANDARD ENGINEERING SCALES. REDUCED SIZED PLANS WILL NOT CONFORM TO STANDARD SCALES. IN MAKING MEASUREMENTS ON REDUCED PLANS, THE ABOVE SCALES MAY BE USED.

J.U.L.I.E.
JOINT UTILITY LOCATION INFORMATION FOR EXCAVATION
1-800-892-0123
OR 811

PROJECT ENGINEER: MATT BOWER
PROJECT MANAGER: LEVI LUND

CONTRACT NO. 74E43

GROSS LENGTH = 434.00 FT. = 0.082 MILE
NET LENGTH = 434.00 FT. = 0.082 MILE

STATE OF ILLINOIS
DEPARTMENT OF TRANSPORTATION

SUBMITTED May 14, 2026
Teresa C. Price
REGIONAL ENGINEER

June 26, 2026
Scott A. Etkin
ENGINEER OF DESIGN AND ENVIRONMENT

June 26, 2026
John J. Barry
DIRECTOR OF HIGHWAYS PROJECT IMPLEMENTATION

PRINTED BY THE AUTHORITY
OF THE STATE OF ILLINOIS

100% STATE 100% STATE

CODE NO.	ITEM	UNIT	TOTAL QUANTITY	ROADWAY	BRIDGE
				0059	0059
				URBAN	S.N. 015-0032
40600290	BITUMINOUS MATERIALS (TACK COAT)	POUND	563	260	303
40600982	HOT-MIX ASPHALT SURFACE REMOVAL - BUTT JOINT	SQ YD	173	173	
40604052	HOT-MIX ASPHALT SURFACE COURSE, IL-9.5, MIX "C", N70	TON	105	48	57
48102100	AGGREGATE WEDGE SHOULDER, TYPE B	TON	11	11	
67100100	MOBILIZATION	L SUM	1	1	
70100450	TRAFFIC CONTROL AND PROTECTION, STANDARD 701201	L SUM	1	1	
70107025	CHANGEABLE MESSAGE SIGN	CAL DA	84	84	
70300100	SHORT TERM PAVEMENT MARKING	FOOT	44	20	24
70300150	SHORT TERM PAVEMENT MARKING REMOVAL	SQ FT	14	6	8
* 78001110	PAINT PAVEMENT MARKING - LINE 4"	FOOT	977	450	527
X7011800	TRAFFIC CONTROL AND PROTECTION, STANDARD BLR 21	L SUM	1	1	

* SPECIALTY ITEM

MODEL: .sct [Sheet]
FILE NAME: c:\pw\work\pav\lund\1218518\ID74E43-shh.sct.dgn

REV - MS

USER NAME = levi.lund	DESIGNED -	REVISED -	STATE OF ILLINOIS DEPARTMENT OF TRANSPORTATION	SUMMARY OF QUANTITIES				F.A.I RTE.	SECTION	COUNTY	TOTAL SHEETS	SHEET NO.
	DRAWN -	REVISED -		57	D7 BRIDGE REPAIRS 2027-7	COLES	13	3				
	CHECKED -	REVISED -						CONTRACT NO. 74E43				
PLOT DATE = 4/15/2026	DATE -	REVISED -		SCALE:	SHEET 1	OF 1	SHEETS	STA.	TO STA.	ILLINOIS	FED. AID PROJECT	

EXISTING TYPICAL CROSS SECTION

STA 47+83.00 TO STA 48+83.00
STA 51+17.00 TO STA 52+17.00

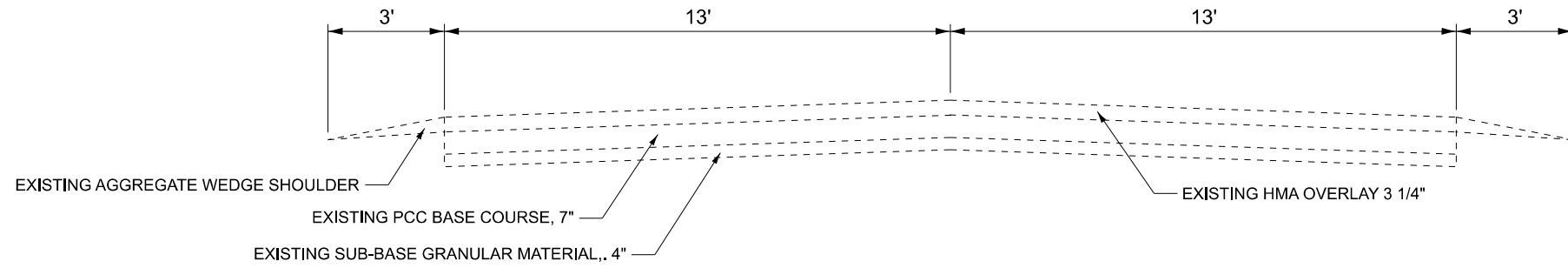

PROPOSED TYPICAL CROSS SECTION

STA 47+83.00 TO STA 48+83.00
STA 51+17.00 TO STA 52+17.00

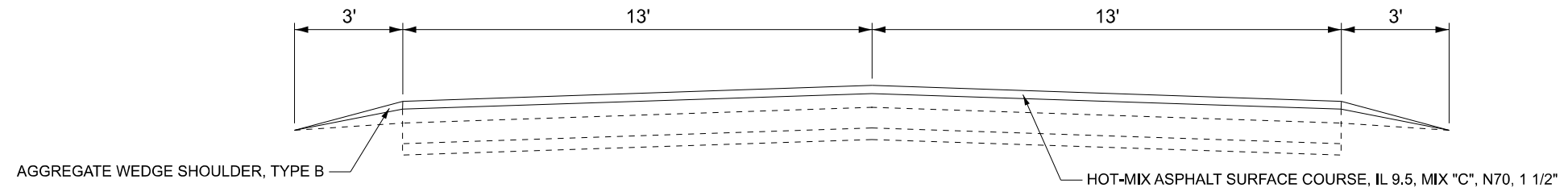

MODEL: Typical (Sheet)
FILE NAME: c:\p\work\project\und\1218518\1218518\74E43-sh-typical.dgn

USER NAME = levi.lund	DESIGNED -	REVISED -
	DRAWN -	REVISED -
	CHECKED -	REVISED -
PLOT DATE = 4/15/2026	DATE -	REVISED -

**STATE OF ILLINOIS
DEPARTMENT OF TRANSPORTATION**

TYPICAL CROSS SECTION

SCALE: SHEET 1 OF 1 SHEETS STA. TO STA.

F.A.I RTE.	SECTION	COUNTY	TOTAL SHEETS	SHEET NO.
57	D7 BRIDGE REPAIRS 2027-7	COLES	13	4
CONTRACT NO. 74E43			ILLINOIS FED. AID PROJECT	

MODEL: Schedule (Sheet)
 FILE NAME: c:\pw\work\revision\und\1218518\74E43-sh-schedule.dgn

PAVING SCHEDULE						
SCHEDULE			BITUMINOUS MATERIALS (TACK COAT)	HOT MIX ASPHALT SURFACE COURSE, IL-9.5, MIX "C", N70	HOT-MIX ASPHALT SURFACE REMOVAL, BUTT JOINT	AGGREGATE WEDGE SHOULDER, TYPE B
STA	TO	STA	(POUND)	(TON)	(SQ YD)	(TONS)
47+83.00		48+83.00	130.0	24	86.7	5.7
48+83.00		51+17.00	303.0	57		
51+17.00		52+17.00	130.0	24	86.7	5.7
			563	105	173	11

STRIPING SCHEDULE					
SCHEDULE			SHORT TERM PAVEMENT MARKING	SHORT TERM PAVEMENT MARKING REMOVAL	PAINT PAVEMENT MARKING - LINE 2"
STA	TO	STA	(FOOT)	(FOOT)	(FOOT)
47+83.00		48+83.00	10	3.3	225
48+83.00		51+17.00	24	7.8	527
51+17.00		52+17.00	10	3.3	225
			44	14	977

USER NAME = lvi.lund	DESIGNED -	REVISED -
	DRAWN -	REVISED -
	CHECKED -	REVISED -
PLOT DATE = 4/15/2026	DATE -	REVISED -

**STATE OF ILLINOIS
 DEPARTMENT OF TRANSPORTATION**

SCHEDULE OF QUANTITIES

SCALE: SHEET 1 OF 1 SHEETS STA. TO STA.

F.A.I RTE.	SECTION	COUNTY	TOTAL SHEETS	SHEET NO.
57	D7 BRIDGE REPAIRS 2027-7	COLES	13	5
CONTRACT NO. 74E43				
ILLINOIS FED. AID PROJECT				

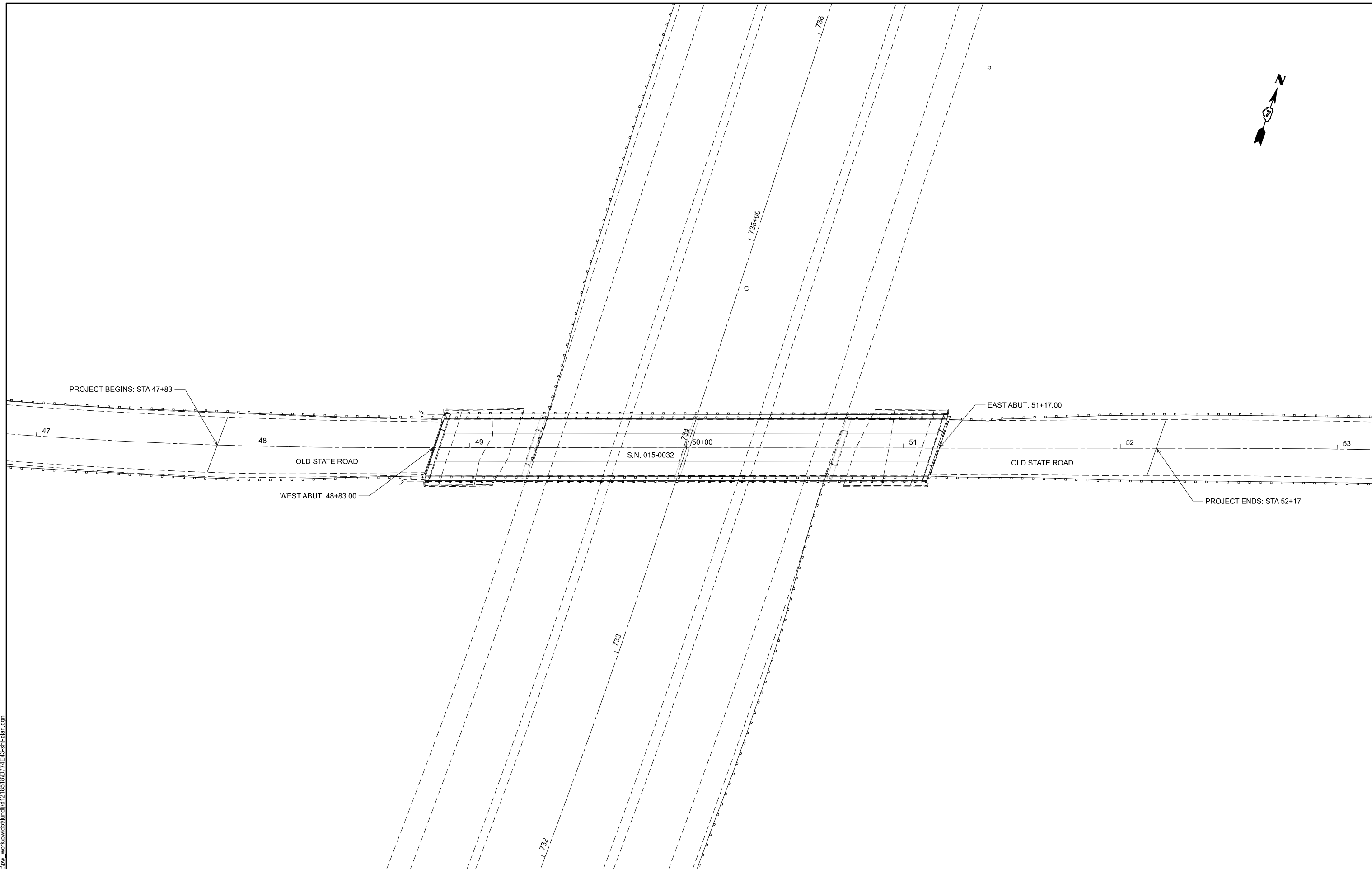

MODEL: Plan (Sheet)
 FILE NAME: c:\pw\work\project\und\1218518\74E43-shr-plan.dgn

USER NAME = levi.lund	DESIGNED -	REVISED -
	DRAWN -	REVISED -
	CHECKED -	REVISED -
PLOT DATE = 4/15/2026	DATE -	REVISED -

**STATE OF ILLINOIS
DEPARTMENT OF TRANSPORTATION**

PLAN SHEET			
SCALE:	SHEET 1	OF 1	SHEETS
	STA.		TO STA.

F.A.I RTE.	SECTION	COUNTY	TOTAL SHEETS	SHEET NO.
57	D7 BRIDGE REPAIRS 2027-7	COLES	13	6
CONTRACT NO. 74E43				
ILLINOIS FED. AID PROJECT				

STRUCTURE 015-0032 carries Old State Rd. (C.H. 7) over Interstate 57.
 The existing four span, steel multi-beam structure was built in 1965. The proposed project consists of a new bituminous wearing surface. Traffic will be detoured during construction.

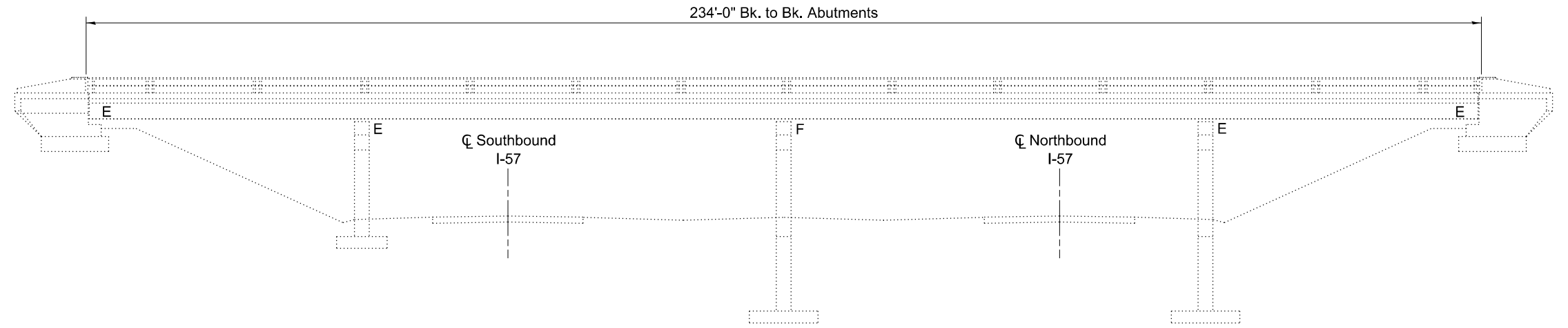

ELEVATION

DESIGN SPECIFICATIONS

2002 AASHTO Standard Specifications for Highway Bridges

DESIGN STRESSES

Existing Construction

$f'_c = 1,400$ psi

$f_y = 20,000$ psi (Reinforcement)

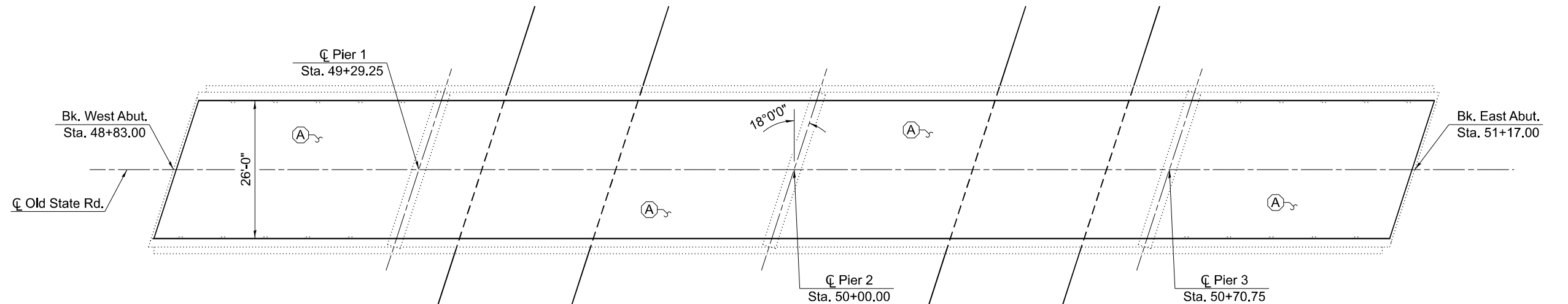

LIMITS OF HMA OVERLAY
 Length - 233'-0" End to End Deck
 Width - 26'-0" Curb to Curb

PLAN

(A) - Construct New HMA Overlay

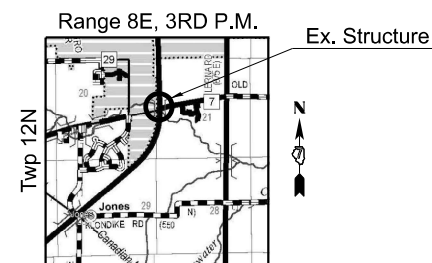

LOCATION SKETCH

MODEL: 015-0032 Sheet 1 [Sheet]
 FILE NAME: c:\pw\work\project\amed\1218528\0774E43_015-0032 Sheets.dgn

USER NAME = dalton.jane	DESIGNED - D. Lane	REVISED -
	DRAWN - D. Lane	REVISED -
	CHECKED - B. Deters	REVISED -
PLOT DATE = 4/15/2026	DATE - April 2026	REVISED -

STATE OF ILLINOIS
 DEPARTMENT OF TRANSPORTATION

GENERAL PLAN & ELEVATION
 S.N. 015-0032

SCALE: SHEET 1 OF 2 SHEETS STA. TO STA.

F.A.I. RTE.	SECTION	COUNTY	TOTAL SHEETS	SHEET NO.
57	D7 BRIDGE REPAIRS 2027-7	COLES	13	7
CONTRACT NO. 74E43				
ILLINOIS FED. AID PROJECT				

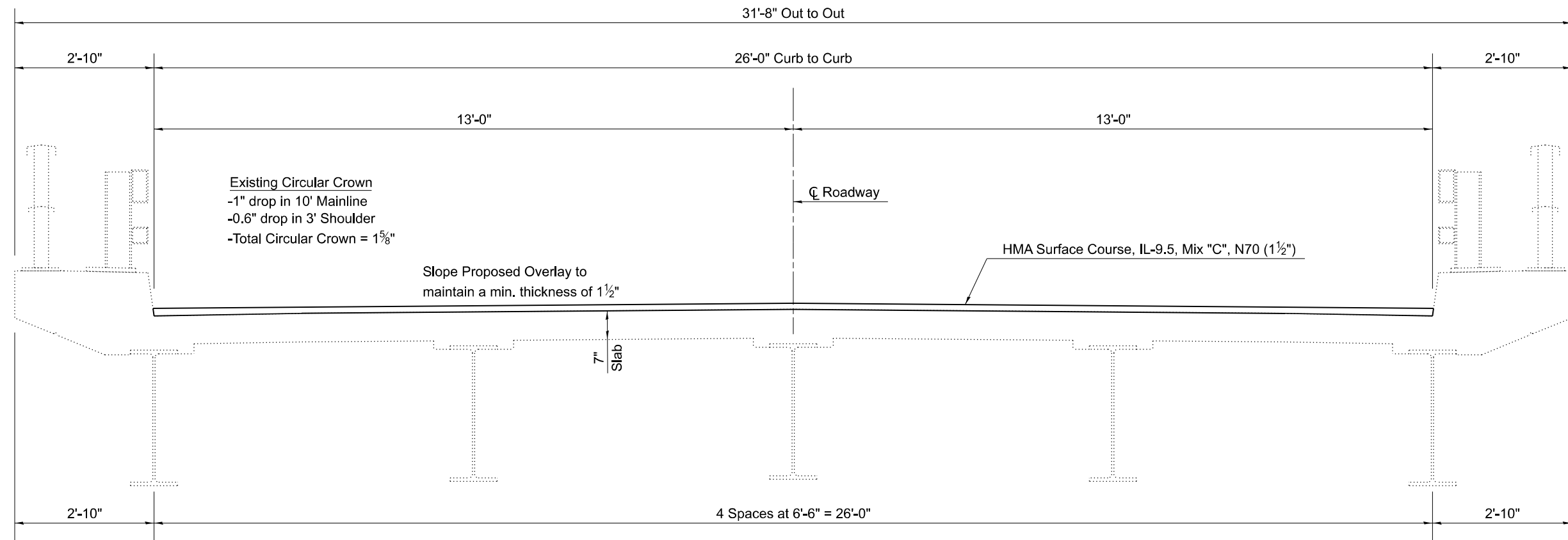

CROSS SECTION
Looking East

GENERAL NOTES

Plan dimensions and details relative to the existing structure have been taken from existing plans and are subject to nominal construction variations. The Contractor shall field verify existing dimensions and details affecting new construction and make necessary approved adjustments prior to construction or ordering of materials. Such variations shall not be cause for additional compensation for a change in scope of the work, however, the Contractor will be paid for the quantity actually furnished at the unit price bid for the work.

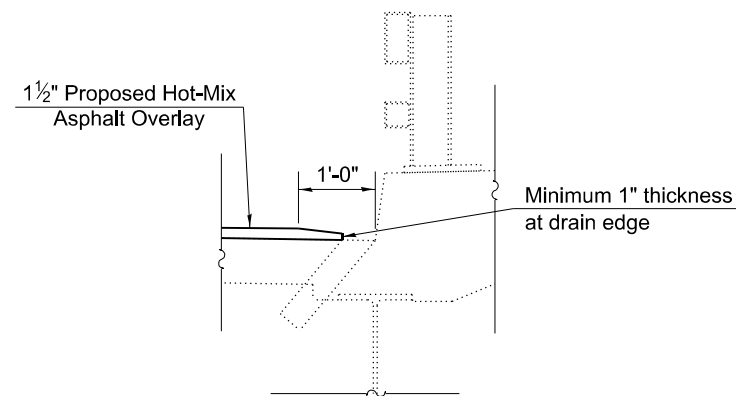

FLOOR DRAIN PRESERVATION

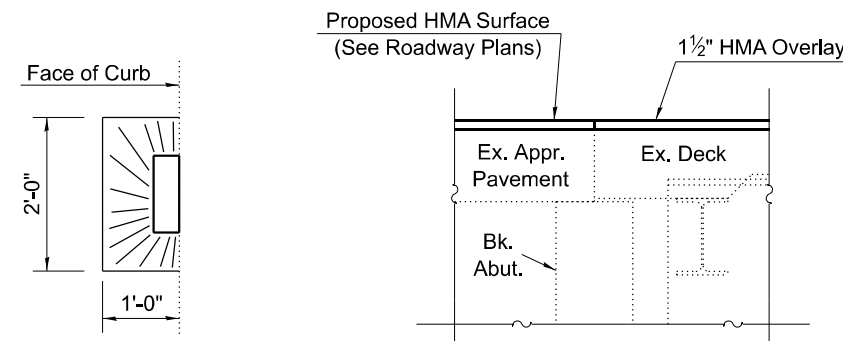

SECTION THRU ABUTMENT

TOP PLAN OF FLOOR DRAIN

TOTAL BILL OF MATERIALS

ITEM	UNIT	QUANTITY
Bituminous Materials (Tack Coat)	Pound	303
Hot Mix Asphalt Surface Course, IL-9.5, Mix "C", N70	Ton	57

MODEL: 015-0032 Sheet 2 [Sheet]
FILE NAME: c:\pw\work\project\amed\1218528\0774E43_015-0032 Sheets.dgn

USER NAME = dalton.jane	DESIGNED - D. Lane	REVISED -
	DRAWN - D. Lane	REVISED -
	CHECKED - B. Deters	REVISED -
PLOT DATE = 4/15/2026	DATE - April 2026	REVISED -

STATE OF ILLINOIS
DEPARTMENT OF TRANSPORTATION

CROSS SECTION, GENERAL NOTES, & BILL OF MATERIALS
S.N. 015-0032

SCALE: SHEET 2 OF 2 SHEETS STA. TO STA.

F.A.I. RTE.	SECTION	COUNTY	TOTAL SHEETS	SHEET NO.
57	D7 BRIDGE REPAIRS 2027-7	COLES	13	8
CONTRACT NO. 74E43			ILLINOIS FED. AID PROJECT	

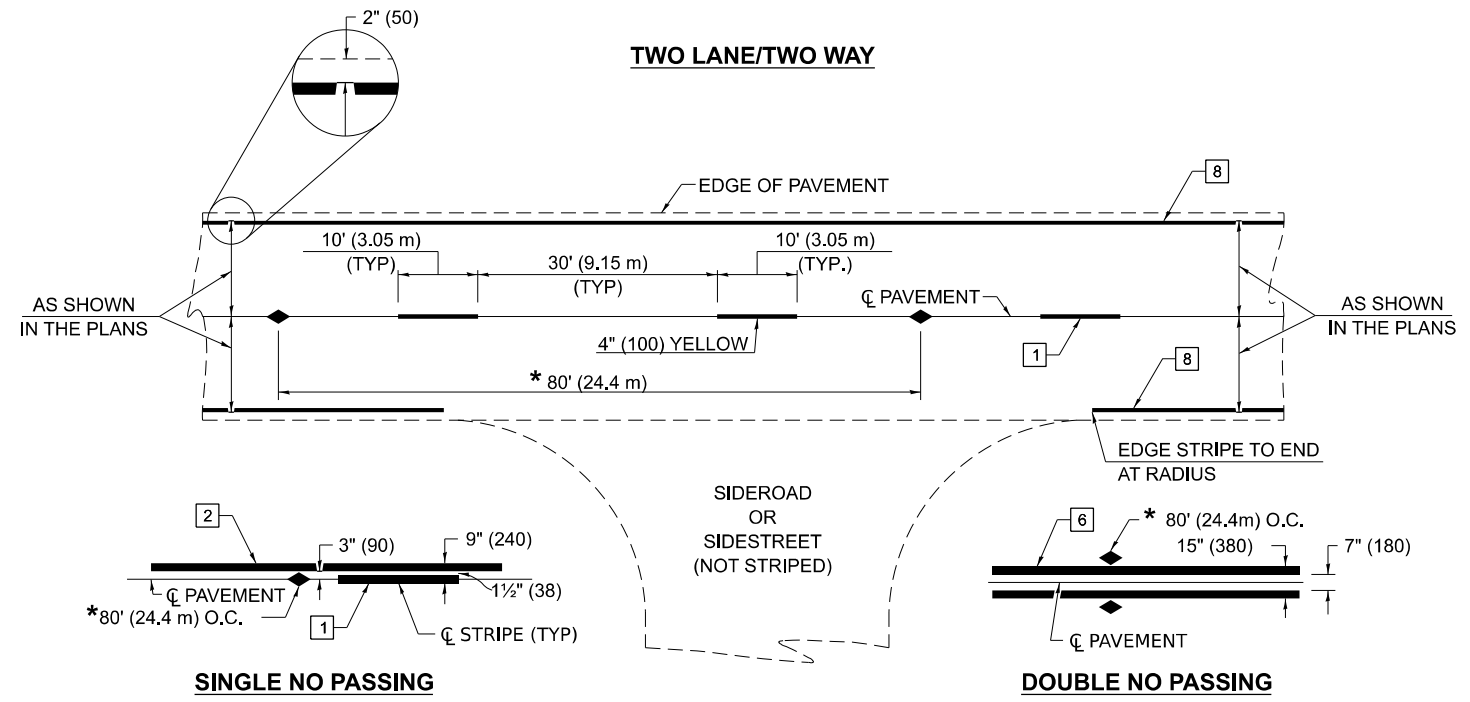

* REDUCE TO 40' (12.2 m) O.C. ON CURVES WITH POSTED OR ADVISORY SPEEDS OF 45 MPH (70 km/h) OR LESS.

PAVEMENT MARKERS LEGEND

- 1 4" (100) SKIP-DASH (YELLOW)
- 2 4" (100) SOLID (YELLOW)
- 3 12" (300) DIAGONAL (YELLOW)
- 4 4" (100) DOUBLE YELLOW (NARROW)
- 5 12" (300) SOLID (WHITE)
- 6 4" (100) DOUBLE YELLOW (WIDE)
- 7 6" (150) SKIP-DASH (WHITE)
- 8 4" (100) SOLID (WHITE)
- 9 12" (300) DIAGONAL (WHITE)
- 10 6" (150) SOLID (WHITE)
- 11 24" (600) STOP BAR (WHITE)
- 12 8" (200) SOLID (WHITE)
- 13 4" (100) PARKING (WHITE)

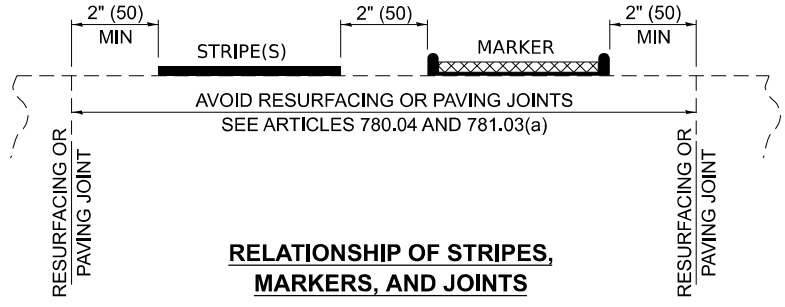
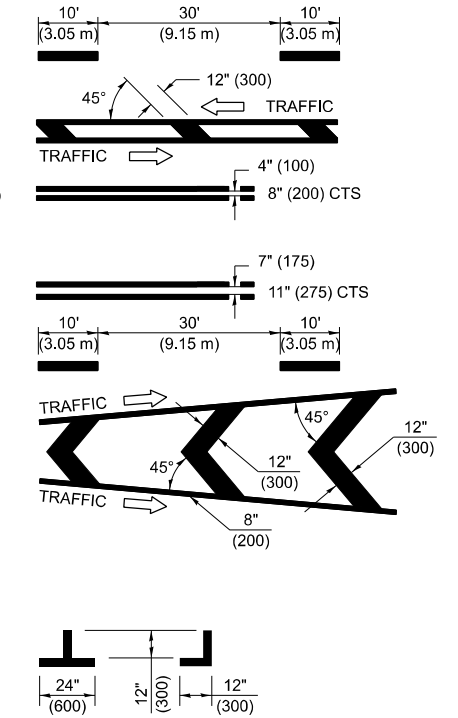

TYPICAL PAVEMENT MARKERS LEGEND

- ◆ TWO-WAY AMBER MARKER
- ▶ ONE-WAY AMBER MARKER
- ▷ ONE-WAY CRYSTAL MARKER

RAISED REFLECTIVE PAVEMENT MARKERS

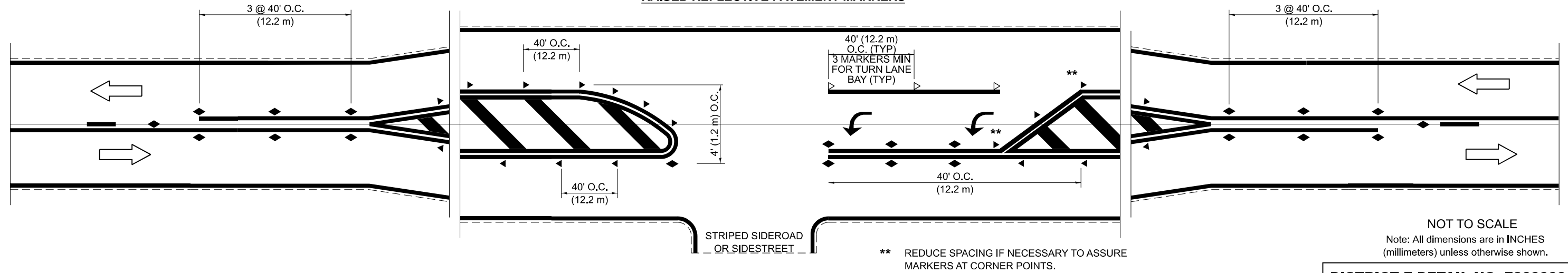

NOT TO SCALE
Note: All dimensions are in INCHES (millimeters) unless otherwise shown.

MODEL: details (Sheet)
FILE NAME: c:\pawork\pawork\mtd\1218518\074E43-sh-detailed.dgn

USER NAME = levi.lund	DESIGNED -	REVISED -
	DRAWN -	REVISED -
	CHECKED -	REVISED -
PLOT DATE = 4/15/2026	DATE -	REVISED -

**STATE OF ILLINOIS
DEPARTMENT OF TRANSPORTATION**

PAVEMENT MARKING DETAILS

SCALE: SHEET 1 OF 5 SHEETS STA. TO STA.

DISTRICT 7 DETAIL NO. 78000001

F.A.I. RTE.	SECTION	COUNTY	TOTAL SHEETS	SHEET NO.
57	D7 BRIDGE REPAIRS 2027-7	COLES	13	9
CONTRACT NO. 74E43				
ILLINOIS FED. AID PROJECT				

URBAN LEFT TURN

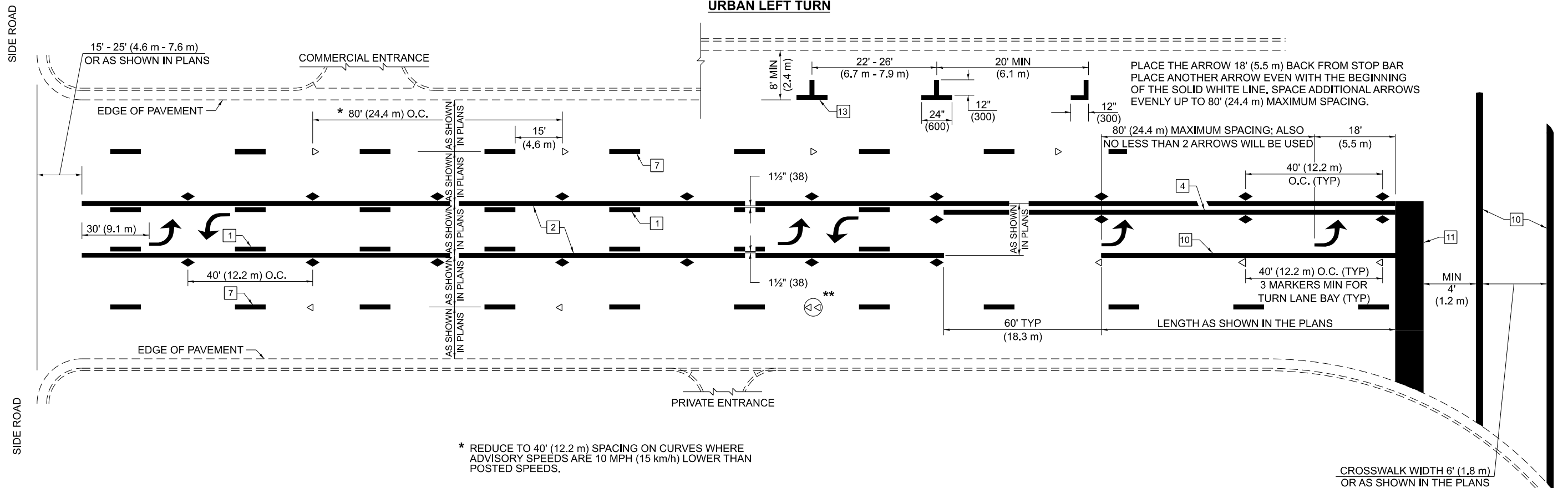

* REDUCE TO 40' (12.2 m) SPACING ON CURVES WHERE ADVISORY SPEEDS ARE 10 MPH (15 km/h) LOWER THAN POSTED SPEEDS.

** DOUBLE LANE LINE MARKERS SHALL BE SPECIFIED AND SPACED AS SHOWN IN HIGHWAY STANDARD 781001 FOR MULTI-LANE DIVIDED AND UNDIVIDED HIGHWAYS.

PAVEMENT MARKING LEGEND

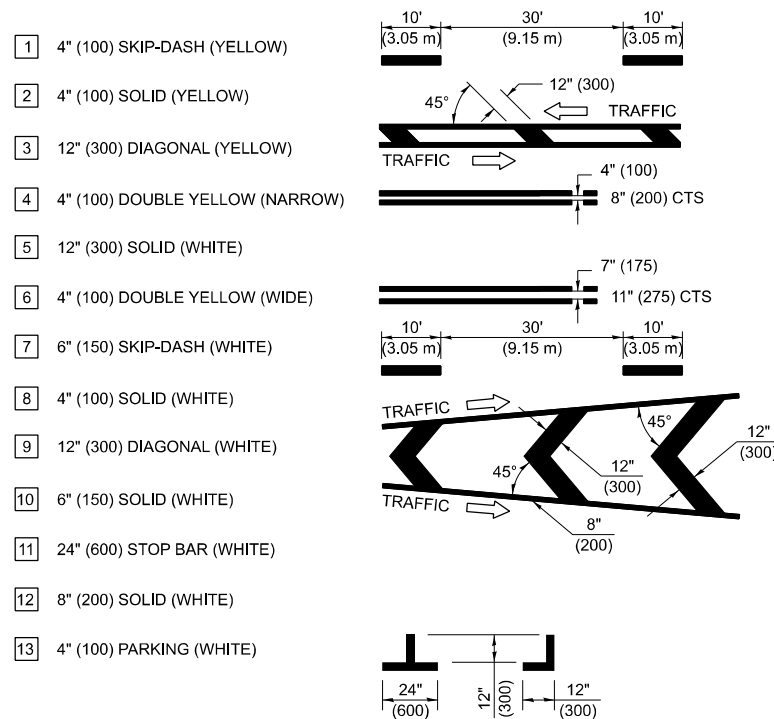

GENERAL NOTES

- TURN ARROW PAIRS SHALL BE PLACED AT 250' (75 m) INTERVALS AND SHALL BE EVENLY SPACED BETWEEN BOTH ENDS OF THE BIDIRECTIONAL LEFT TURN LANE USE A MINIMUM OF TWO PAIRS PER BLOCK.
- THE SOLID YELLOW PAVEMENT MARKING [2] SHOULD GENERALLY START OR END NEAR THE RADIUS POINT OF EACH STREET RETURN EXCEPT WHERE ONE OR BOTH ENDS WOULD INCLUDE STOP BARS.
- THE SKIP-DASH PAVEMENT MARKING [1] OR [7] SHOULD BE CENTERED BETWEEN BOTH ENDS OF EACH CITY BLOCK AND SHALL BE PLACED SO THEY LINE UP ACROSS FROM EACH OTHER.
- USE LARGE ARROW SIZE FOR BOTH RURAL AND URBAN LOCATIONS. (SEE SECTION 780 FOR SYMBOLS TABLE)
- LANE LINE EXTENSIONS SHALL BE THE SAME COLOR AND WIDTH AS THE LANE LINE BEING EXTENDED.
- ALL WHITE SKIP-DASH LINES SHALL BE 6" IN WIDTH.

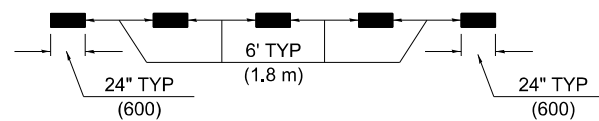

LANE LINE EXTENSIONS

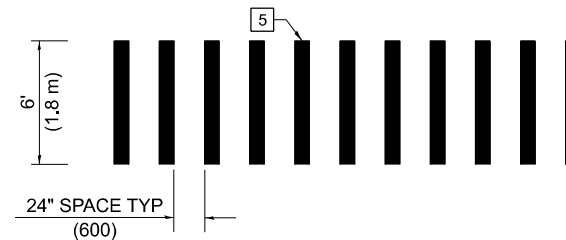

**CROSSWALK DETAIL
(DECATUR CITY LIMITS ONLY)**

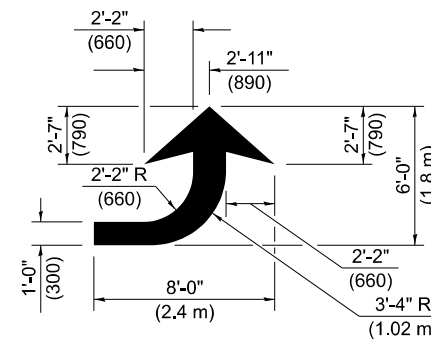

LEFT ARROW

REVERSE FOR RIGHT ARROW
AREA = 15.6 SQ.FT. (1.47 m²)
(WHITE)

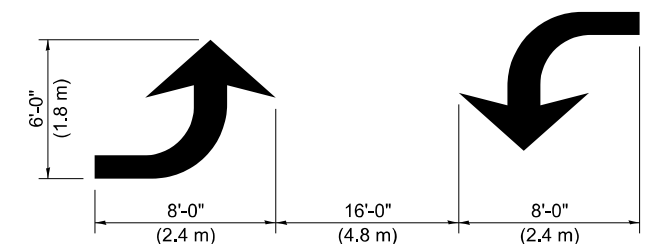

**TYPICAL DOUBLE
TURN ARROWS (WHITE)**

NOT TO SCALE

Note: All dimensions are in INCHES (millimeters) unless otherwise shown.

DISTRICT 7 DETAIL NO. 78000001

USER NAME = IeviJund	DESIGNED -	REVISED -
	DRAWN -	REVISED -
	CHECKED -	REVISED -
PLOT DATE = 4/15/2026	DATE -	REVISED -

**STATE OF ILLINOIS
DEPARTMENT OF TRANSPORTATION**

PAVEMENT MARKING DETAILS

SCALE: SHEET 2 OF 5 SHEETS STA. TO STA.

F.A.I RTE.	SECTION	COUNTY	TOTAL SHEETS	SHEET NO.
57	D7 BRIDGE REPAIRS 2027-7	COLES	13	10
CONTRACT NO. 74E43				
ILLINOIS FED. AID PROJECT				

MODEL: details-1 (Sheet)
FILE NAME: c:\paw\work\project\dm\1218518\0774E43-sh-detailed.dgn

SUPPLEMENTAL PAVEMENT MARKING TREATMENT FOR RAILROAD-HIGHWAY GRADE CROSSING

PAVEMENT MARKING LEGEND

- 1 4" (100) SKIP-DASH (YELLOW)
 - 2 4" (100) SOLID (YELLOW)
 - 3 12" (300) DIAGONAL (YELLOW)
 - 4 4" (100) DOUBLE YELLOW (NARROW)
 - 5 12" (300) SOLID (WHITE)
 - 6 4" (100) DOUBLE YELLOW (WIDE)
 - 7 6" (150) SKIP-DASH (WHITE)
 - 8 4" (100) SOLID (WHITE)
 - 9 12" (300) DIAGONAL (WHITE)
 - 10 6" (150) SOLID (WHITE)
 - 11 24" (600) STOP BAR (WHITE)
 - 12 8" (200) SOLID (WHITE)
 - 13 4" (100) PARKING (WHITE)
-

PAVEMENT MARKINGS AT RAILROAD-HIGHWAY GRADE CROSSING

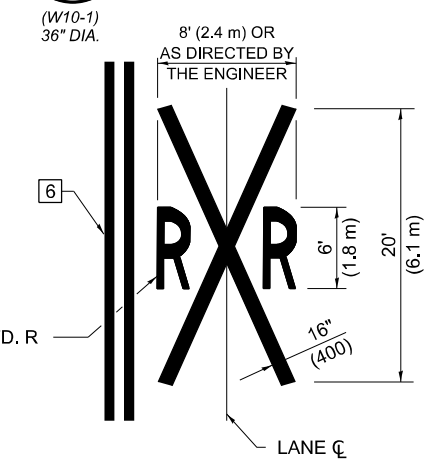
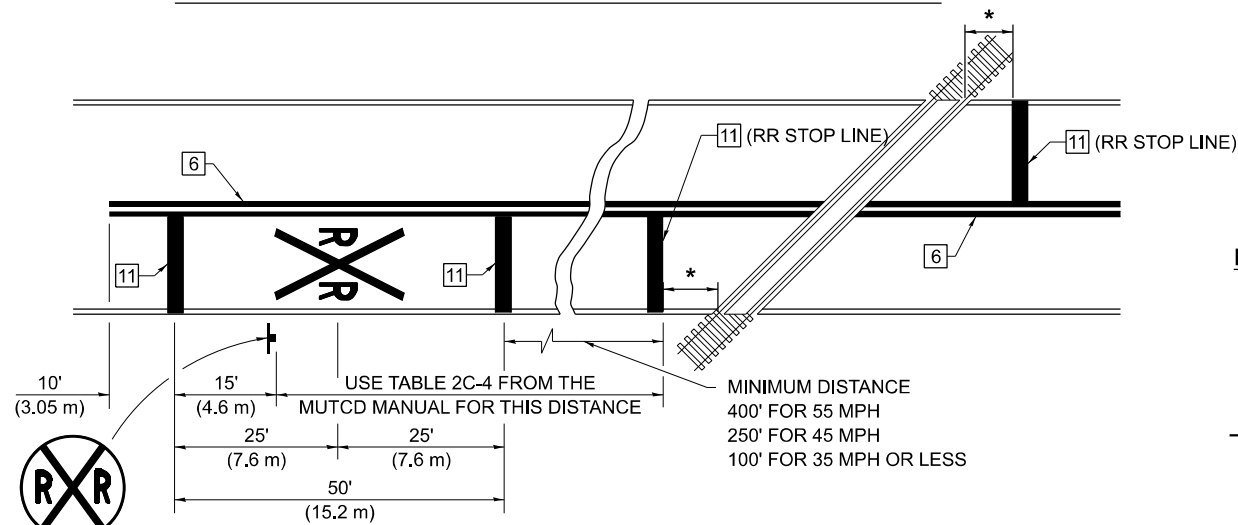

NOTES

THE TRAVERSE SPREAD OF THE "X" MAY VARY ACCORDING TO LANE WIDTH.

ON MULTI-LANE ROADS, THE STOP LINES SHALL EXTEND ACROSS ALL APPROACH LANES AND SEPARATE RXR SYMBOLS SHALL BE PLACED ADJACENT TO EACH OTHER IN EACH LANE.

WHEN THE PAVEMENT MARKING SYMBOLS IS USED, A PORTION OF THE SYMBOL SHOULD BE LOCATED DIRECTLY ADJACENT TO THE ADVANCE WARNING SIGN (W10-1) AS PLACED BY TABLE II-1, CONDITION B OF THE MUTCD.

RAILROAD CROSSING WITH NON-SIGNALIZED INTERSECTION

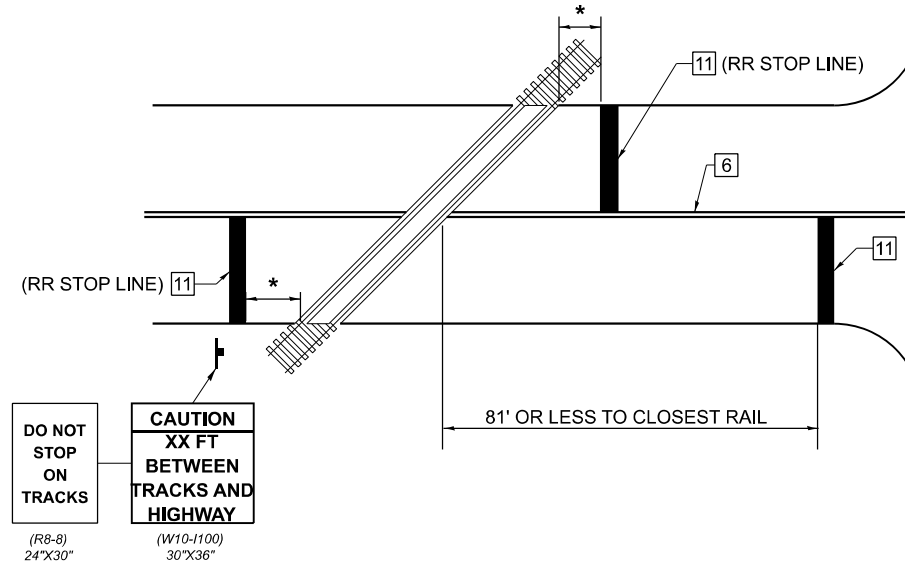

RAILROAD CROSSING WITH INTERCONNECT ONLY

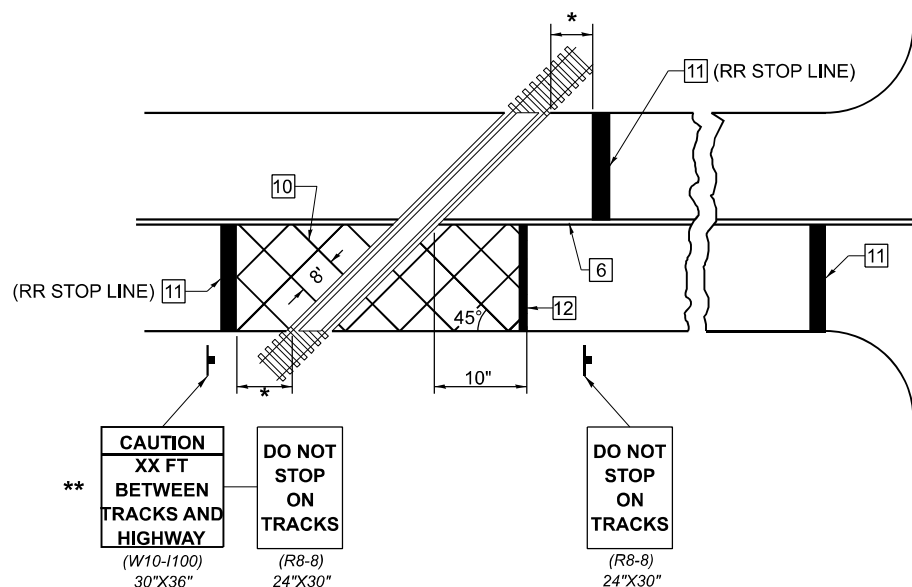

RAILROAD CROSSING WITH INTERCONNECT AND PRE-SIGNALS

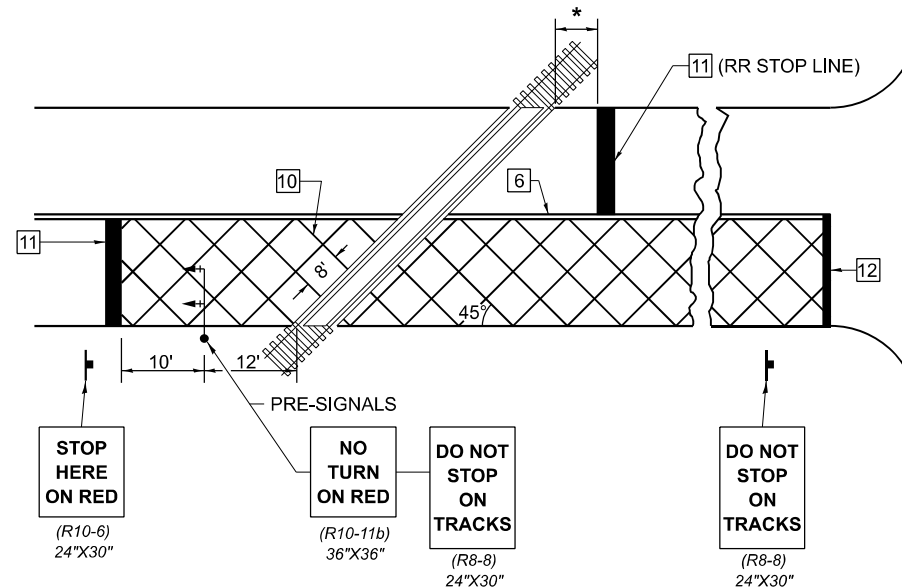

GENERAL NOTES

- SUPPLEMENTAL PAVEMENT MARKINGS TO BE INSTALLED ONLY ON APPROACHES TO INTERSECTIONS CONTROLLED BY TRAFFIC SIGNALS WHICH ARE INTERCONNECTED WITH THE RAILROAD WARNING SIGNALS.
- EXTEND PAVEMENT MARKINGS TO THE INTERSECTION ONLY WHERE PRE-SIGNALS ARE USED.
- WHEN PEDESTRIAN SIGNALS ARE PRESENT WITH INTERCONNECTED SIGNALS, WARNING SIGN W10-1101 (18"X24") SHALL BE PLACED NEAR EACH PEDESTRIAN SIGNAL HEAD. COUNTDOWN PEDESTRIAN SIGNAL HEADS SHALL NOT BE UTILIZED ALONG WITH INTERCONNECTED SIGNALS.
- PLEASE REFER TO THE IDOT BUREAU OF OPERATION MEMO OPS T-06 DATED DECEMBER 1, 2020 FOR ADDITIONAL INFORMATION.

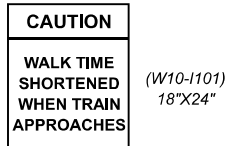

- * 15' FROM NEAR RAIL OR 8' FROM AND PARALLEL TO GATE IF PRESENT
- ** WARNING SIGN W10-1100 SHALL BE USED AS AN INTERIM MEASURE AT INTERCONNECTED SIGNAL LOCATIONS WHERE PRE-SIGNALS ARE TO BE INSTALLED IN THE FUTURE. THIS SIGN SHALL BE REMOVED WHEN THE PRE-SIGNALS ARE INSTALLED AND THE PAVEMENT MARKINGS ARE EXTENDED TO THE INTERSECTION.

NOT TO SCALE
Note: All dimensions are in INCHES (millimeters) unless otherwise shown.

DISTRICT 7 DETAIL NO. 78000001

USER NAME = levi.lund	DESIGNED -	REVISED -
	DRAWN -	REVISED -
	CHECKED -	REVISED -
PLOT DATE = 4/15/2026	DATE -	REVISED -

STATE OF ILLINOIS
DEPARTMENT OF TRANSPORTATION

PAVEMENT MARKING DETAILS

SCALE: SHEET 4 OF 5 SHEETS STA. TO STA.

F.A.I. RTE.	SECTION	COUNTY	TOTAL SHEETS	SHEET NO.
57	D7 BRIDGE REPAIRS 2027-7	COLES	13	12
CONTRACT NO. 74E43				
ILLINOIS FED. AID PROJECT				

MODEL: details-3 (Sheet)
FILE NAME: c:\paw\work\pavmark\mtd\1218518\074E43-sh-detailed.dgn

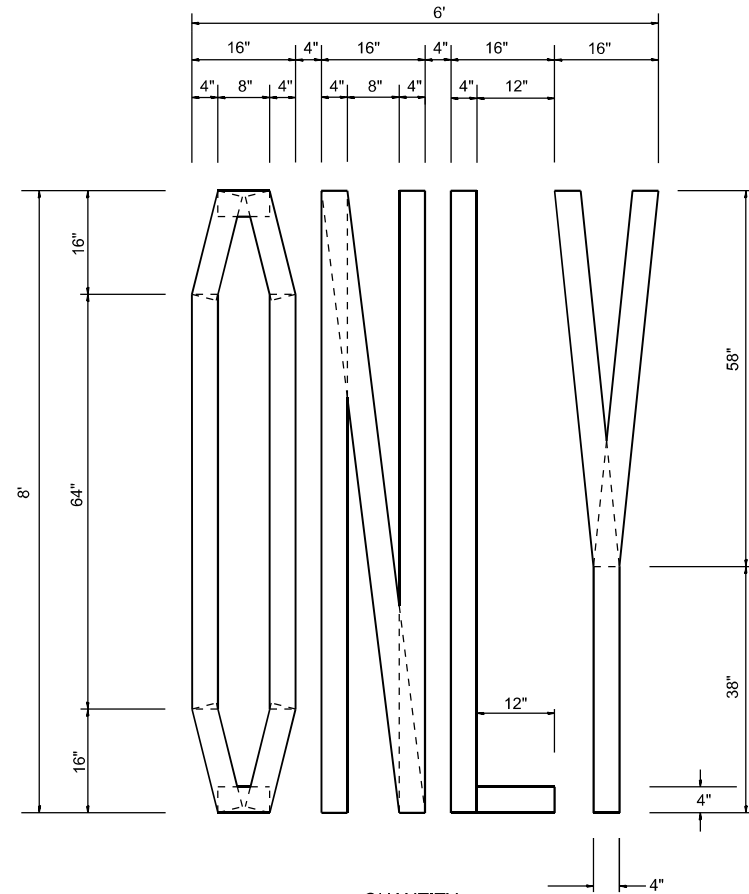

QUANTITY
4" LINE = 63.2 FT
21.0 SQ FT

SHORT TERM STOP BAR

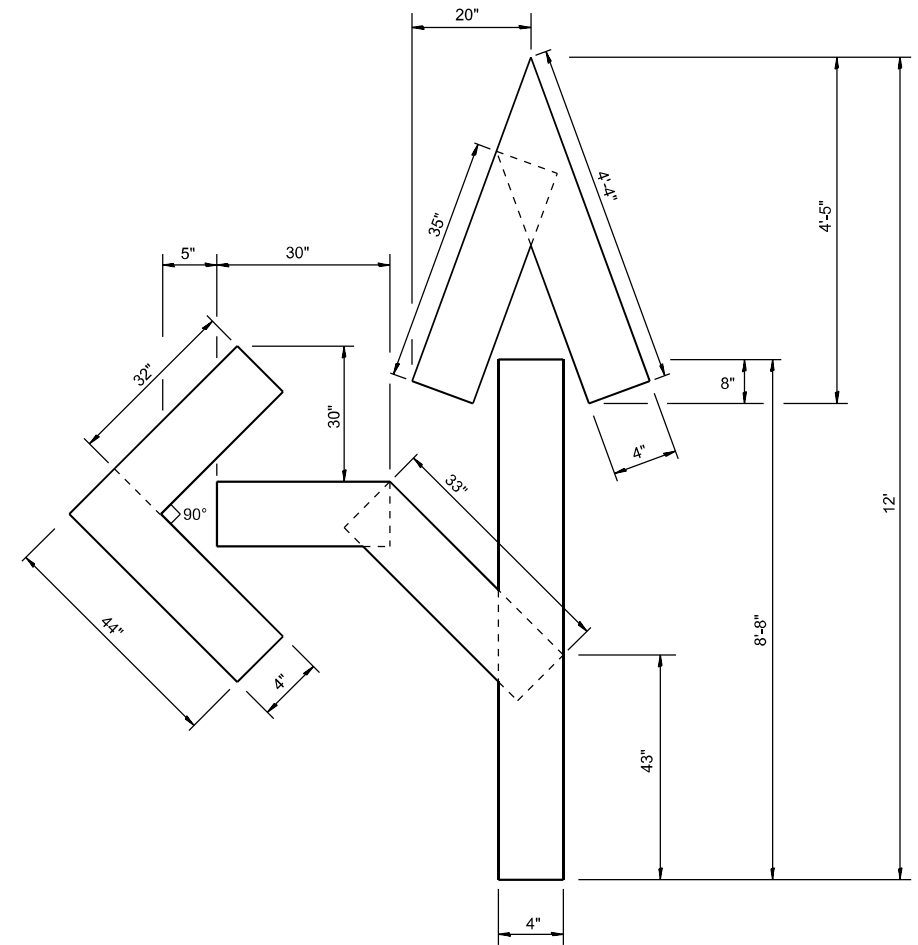

QUANTITY
4" LINE = 27.5 FT
9.2 SQ FT

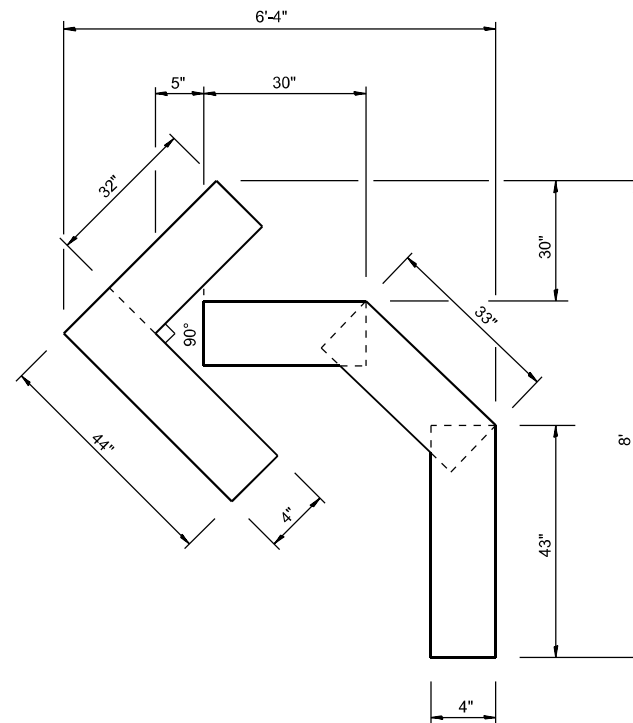

QUANTITY
4" LINE = 15.2 FT
5.0 SQ FT

NOT TO SCALE

DISTRICT 7 DETAIL NO. 7030001

MODEL: details-4 (Sheet)
FILE NAME: c:\pwwork\revit\coll\mod\1218518\ID74E43-shh-details.dgn

USER NAME = levi.lund	DESIGNED -	REVISED -
	DRAWN -	REVISED -
	CHECKED -	REVISED -
PLOT DATE = 4/15/2026	DATE -	REVISED -

**STATE OF ILLINOIS
DEPARTMENT OF TRANSPORTATION**

SHORT TERM PAVEMENT MARKING DETAILS

SCALE: SHEET 5 OF 5 SHEETS STA. TO STA.

F.A.I. RTE.	SECTION	COUNTY	TOTAL SHEETS	SHEET NO.
57	D7 BRIDGE REPAIRS 2027-7	COLES	13	13
CONTRACT NO. 74E43				
ILLINOIS FED. AID PROJECT				