

MAY 05, 2005 9:35 PM RAW  
 I:\AIRPORTS\TAYLORVILLE\828-CORRYWAY\AIRPORT\_SHEETS\R-191STK.DWG - TAXI 11+50 TO 15+50

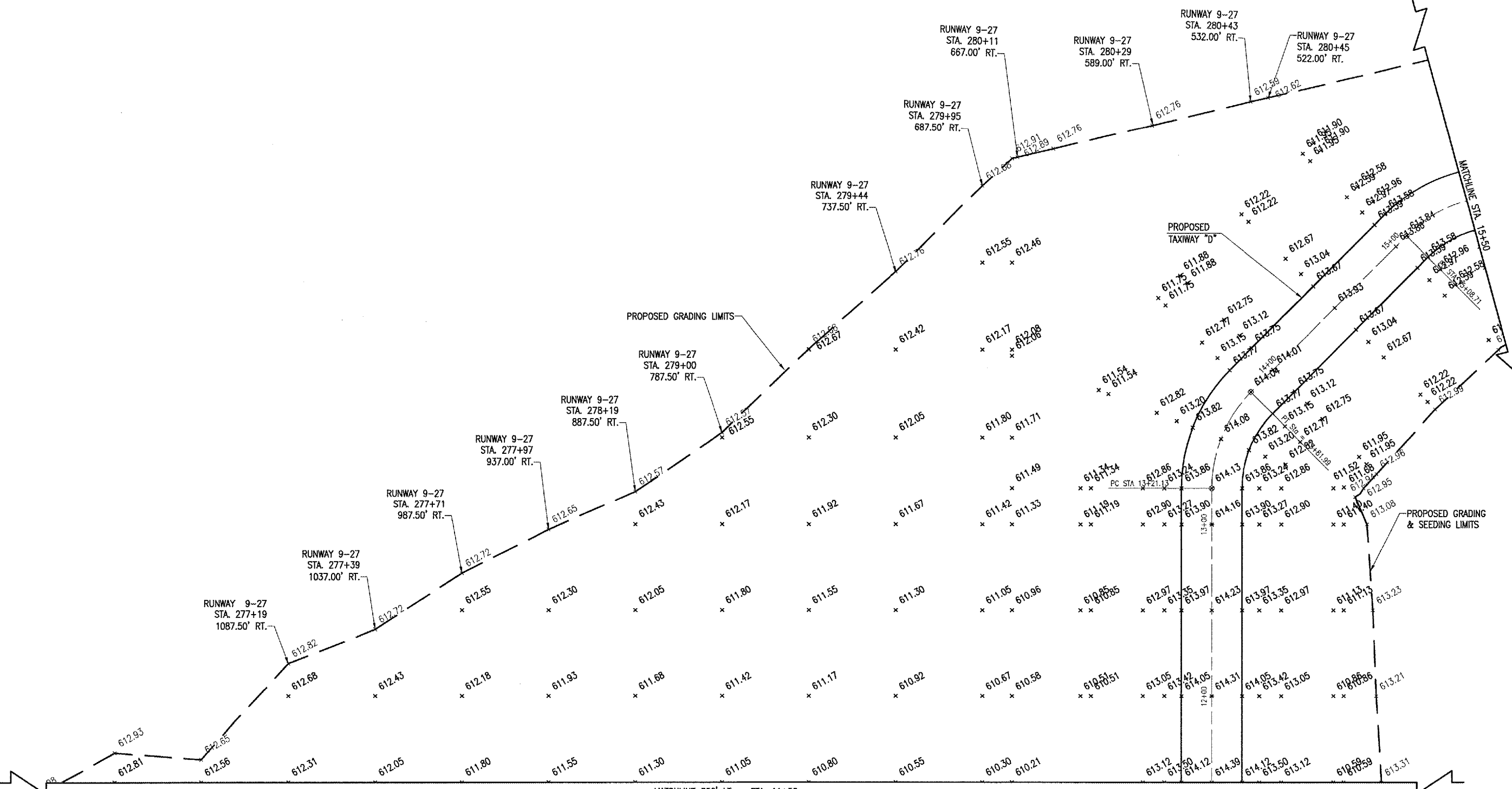

MATCHLINE 350' LT. = STA. 11+50

**LEGEND**

- EXISTING IMPROVEMENTS
- PROPOSED IMPROVEMENTS
- PROPOSED GRADING & SEEDING LIMITS
- XXX.XX EXISTING GRADE
- XXX.XX PROPOSED GRADE

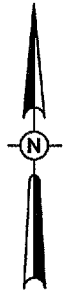
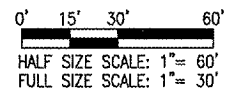

DATE	REVISION	BY

**TAYLORVILLE MUNICIPAL AIRPORT**  
**TAYLORVILLE, ILLINOIS**

IL. PROJ. NO. 828-CORRYWAY-0800  
 R-191STK.DWG  
 Scale: 1" = 30'  
 Date: 02/10/05

LAYOUT	MLB	02/10/05
DRAWN	XXX	00/00/05
REVIEWED	CAH	03/28/05

A.I.P. PROJ.: 3-17-0100-B7  
 I.L. PROJ.: TAZ-3166

Hanson Professional Services Inc.  
 1525 South Sixth Street  
 Springfield, Illinois 62703-2886  
 Offices Nationwide

**CONSTRUCT**  
**RUNWAY 9-27**

**PROPOSED**  
**STAKING PLAN**  
 STA. 11+50 TO STA. 15+50