

REVISIONS		
NUMBER	BY	DATE

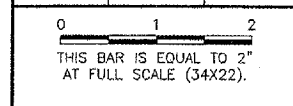

**PEKIN MUNICIPAL AIRPORT  
 PEKIN, TAZEWELL COUNTY, ILLINOIS**

**REHABILITATE AND MARK THE PARALLEL TAXIWAY**

**CONSTRUCTION ACTIVITY PLAN  
 PHASE 3**

© Copyright, CMT, Inc.  
**CMT**  
 CRAWFORD, MURPHY & TILLY, INC.  
 CONSULTING ENGINEERS  
 License No. 184-000613

DESIGN BY:	SMS
DRAWN BY:	CMT
CHECKED BY:	SMS
APPROVED BY:	SMS
DATE:	04/22/2005
JOB No:	04069-02-00
IL PROJECT:	C15-3434
A.I.P. PROJECT:	3-17-0078-BB
SHEET 7 OF 13 SHEETS	

ILL. STATE HWY. 29

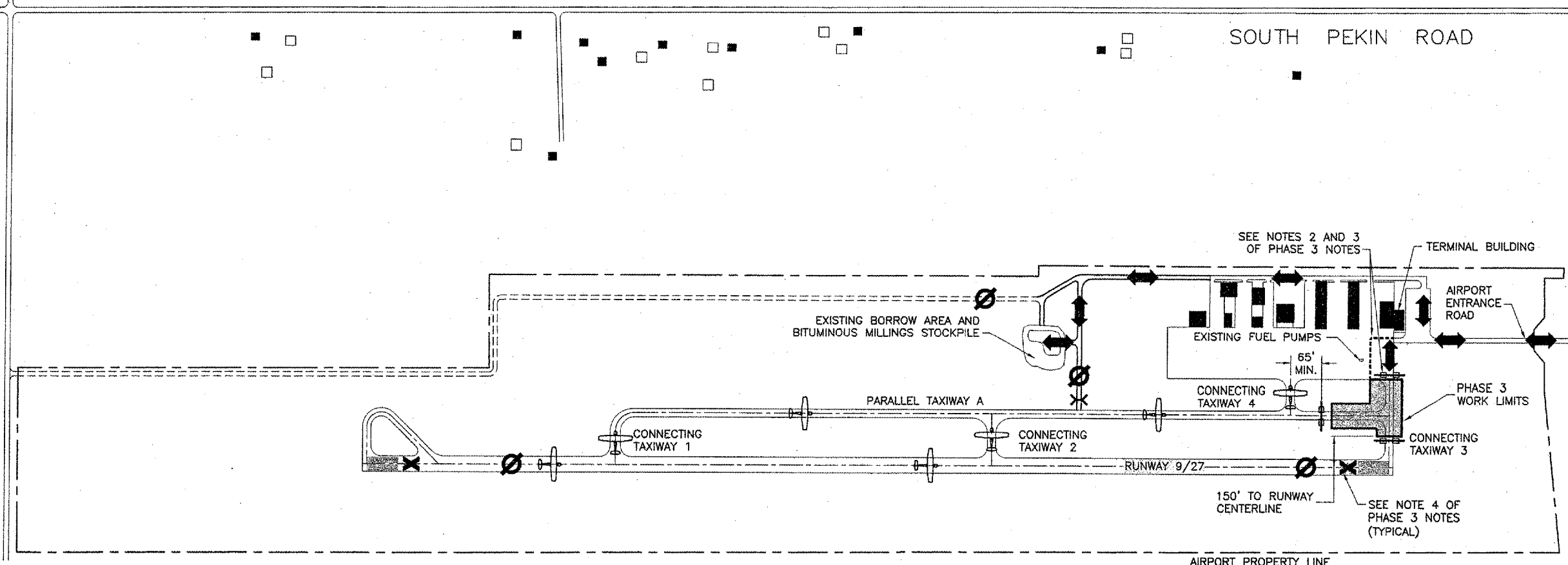

**PHASE 3 NOTES**

- ACCESS FOR PHASE 3 SHALL BE AS SHOWN.
- THE CONTRACTOR SHALL BE ALLOWED ACCESS THROUGH THE AIRCRAFT PARKING RAMP AS SHOWN ONLY DURING THIS PHASE. THE CONTRACTOR SHALL KEEP ALL TRUCKS, EQUIPMENT AND MATERIALS INSIDE THESE LIMITS UNLESS PRIOR PERMISSION IS GRANTED BY THE AIRPORT.
- THE CONTRACTOR SHALL MAINTAIN A LINE OF BARRICADES AROUND HIS ACCESS AREA ON THE APRON TO PREVENT ACCESS BY AIRCRAFT TO THE WORKSITE DURING THE DAY. AT THE END OF THE WORKING DAY, BARRICADES SHALL BE RELOCATED TO THE ENTRANCE TO CONNECTING TAXIWAY 3 ALONG THE EDGE OF THE APRON AS SHOWN.
- THE CONTRACTOR SHALL PLACE THE RUNWAY CLOSURE MARKERS OVER THE RUNWAY DESIGNATION MARKING BEFORE WORKS BEGINS FOR THE DAY AND REMOVE THEM AT THE END OF THE DAY.
- BARRICADES TO BE PLACED AT THE ENTRANCE TO CONNECTING TAXIWAY 3 FROM RUNWAY 9/27 TO BE PLACED A MINIMUM OF 150' FROM RUNWAY 9/27 CENTERLINE AT THE END OF THE WORK DAY AND WHEN THE RUNWAY IS OPEN TO AIR TRAFFIC. THE BARRICADES MAY BE MOVED DURING THE DAY TO FACILITATE CONSTRUCTION OPERATIONS PROVIDED THE RUNWAY IS CLOSED.
- ALL OPEN EXCAVATIONS WITHIN 150 FEET OF THE RUNWAY 9/27 CENTERLINE MUST BE BACKFILLED TO WITHIN 3 INCHES OF THE SURROUNDING SURFACE BEFORE RUNWAY 9/27 MAY BE REOPENED TO TRAFFIC. IF BACKFILL IS NOT FEASIBLE, THE EXCAVATIONS MAY BE COVERED WITH STEEL ROAD PLATES CAPABLE OF SUPPORTING A 25,000 POUND SINGLE WHEEL GEAR AIRCRAFT. THE GROSS WEIGHT ON ONE MAIN GEAR EQUALS 11,875 POUNDS. OPEN EXCAVATIONS INCLUDE ANY PAVEMENT REMOVAL FOR CRACK REPAIR AND SUBGRADE OR SHOULDER REMOVAL FOR CRACK REPAIR OPERATIONS. THE COST OF THIS WORK SHALL BE INCIDENTAL TO THE CRACK REPAIR OR OTHER ASSOCIATED ITEMS.
- THE CONTRACTOR SHALL HAVE A MAXIMUM OF 7 CALENDAR DAYS TO COMPLETE PHASE 3.

**LEGEND**

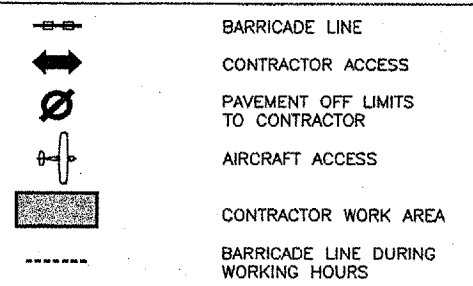

**AIRFIELD CLOSURE TABLE - PHASE 3**

AIRFIELD PAVEMENTS OPEN TO TRAFFIC	CLOSED TO TRAFFIC	
	LONG-TERM	DAILY
RUNWAY 9/27 AND TURNAROUND TAXIWAY, 3:30 PM TO 7 AM	CONNECTING TAXIWAY NO. 3 PARALLEL TAXIWAY A FROM STA. 48+50 TO STA. 51+80	AIRFIELD CLOSED 7AM TO 3:30 PM
CONNECTING TAXIWAY NO. 1 CONNECTING TAXIWAY NO. 2 CONNECTING TAXIWAY NO. 4		