

ROUTE NO.	SECTION	COUNTY	TOTAL SHEETS	SHEET NO.
T.R. 90	02-01175-00-BR	UNION	18	14
FED. ROAD DIST. NO.	ILLINOIS FEDERAL PROJECT			

CONTRACT NO. 99213

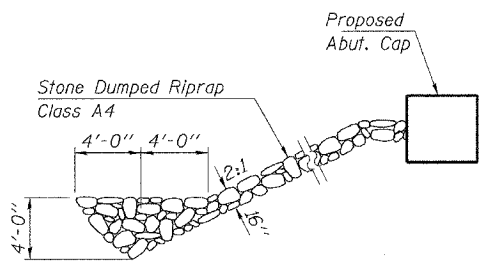
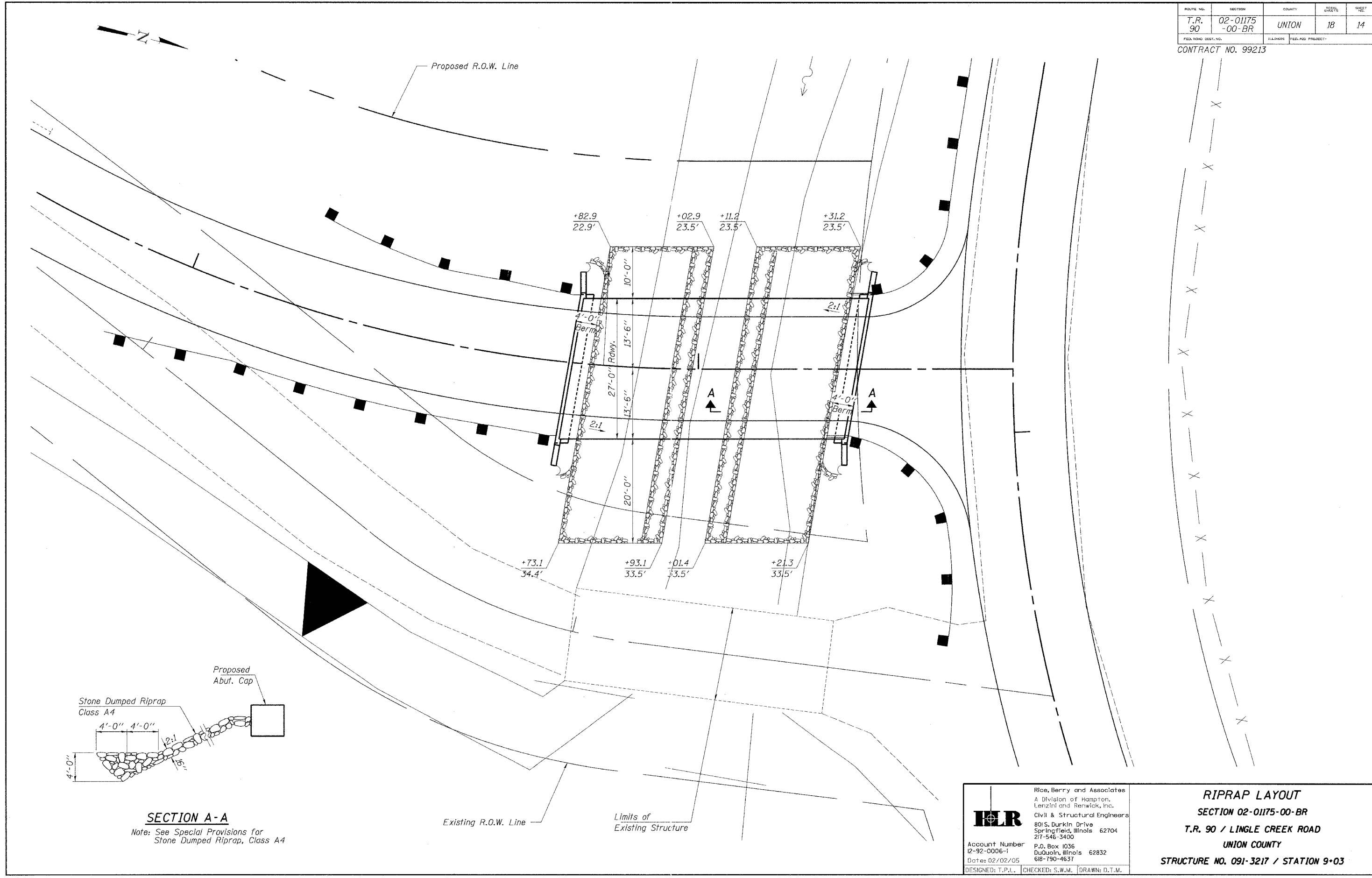

HLR
 Rice, Berry and Associates
 A Division of Hampton, Lenzini and Renwick, Inc.
 Civil & Structural Engineers
 801 S. Durkin Drive
 Springfield, Illinois 62704
 217-546-3400
 P.O. Box 1036
 DuQuoin, Illinois 62832
 618-190-4637
 Account Number 12-92-0006-1
 Date: 02/02/05
 DESIGNED: T.P.L. CHECKED: S.W.M. DRAWN: D.T.M.

RIPRAP LAYOUT
SECTION 02-01175-00-BR
T.R. 90 / LINGLE CREEK ROAD
UNION COUNTY
STRUCTURE NO. 091-3217 / STATION 9+03