

F.A.U. RDUTE	SECTION	COUNTY	TOTAL SHEETS	SHEET NUMBER
9732	00-DD102-00-FP	JACKSON	27	27
JOB NO.	99-033-03	PROJECT NO.	M-5008(17)	
CITY OF CARBONDALE		CONTRACT NO. 99175		

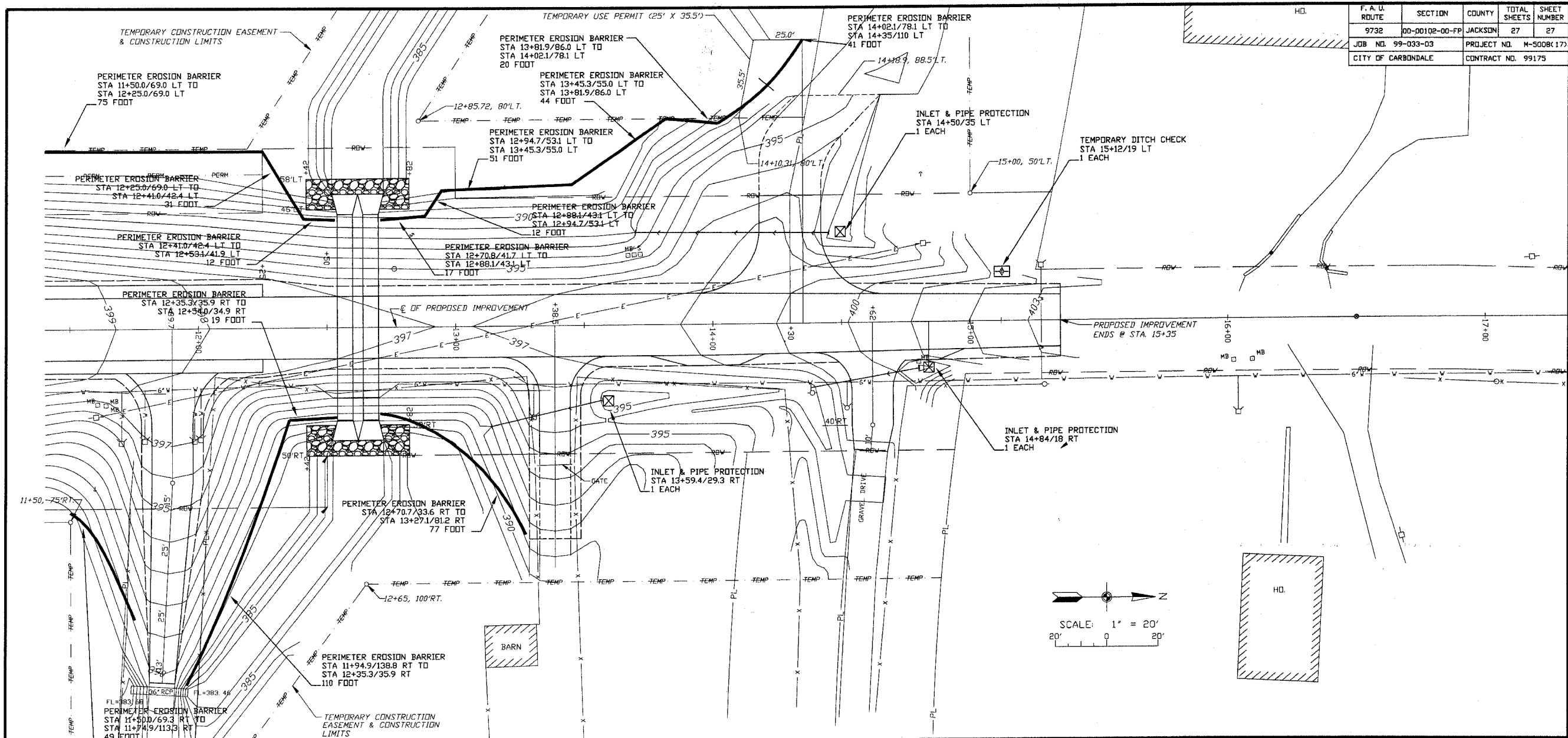

BEGIN STATION	END STATION	FOOT
0+53.5/84.2 LT	1+03.3/41.7 LT	70
1+16.5/39.5 LT	1+62.8/68.6 LT	58
1+61.3/57.3 RT	1+85.9/25.1 RT	41
4+32.2/64.5 LT	6+50.0/38.1 LT	243
6+50.0/38.6 LT	686.0/148.3 LT	132
10+00.7/45.0 LT	10+67/68 LT	71
10+67/68 LT	11+50.0/88 LT	83
9+38/130 RT	9+50/70 RT	62
9+50/70 RT	11+50.0/70 RT	200
11+50.0/69.0 LT	12+25.0/69.0 LT	75
12+25.0/69.0 LT	12+41.0/42.4 LT	31
12+41.0/42.4 LT	12+53.1/41.9 LT	12
12+70.8/41.7 LT	12+88.1/43.1 LT	17
12+88.1/43.1 LT	12+94.7/53.1 LT	12
12+94.7/53.1 LT	13+45.3/55.0 LT	51
13+45.3/55.0 LT	13+81.9/86.0 LT	44
13+81.9/86.0 LT	14+02.1/78.1 LT	20
14+02.1/78.1 LT	14+35/110 LT	41
11+50.0/69.3 RT	11+74.9/113.3 RT	49
11+94.9/138.8 RT	12+35.3/35.9 RT	110
12+35.3/35.9 RT	12+54.0/34.9 RT	19
12+70.7/33.6 RT	13+27.1/81.2 RT	77

TOTAL: 1,518

BEGIN STATION	END STATION	FOOT
1+09.2/42.0 LT		1
2+69.4/41.9 LT		1
3+35.8/41.2 LT		1
7+21.7/108.1 LT		1
7+24.8/82.5 LT		1
7+29.2/60.6 LT		1
7+71.3/28.3 LT		1
8+30.7/28.2 LT		1
9+02.3/31.2 LT		1
9+43.0/32.2 LT		1
9+81.4/33.1 LT		1
7+90.4/30.1 RT		1
8+45.2/27.6 RT		1
8+95.7/27.0 RT		1
9+41.0/21.0 LT		1
9+73.0/26.9 RT		1
15+12/19 LT		1

TOTAL: 17

BEGIN STATION	END STATION	EACH
1+89.9/36.3 RT		1
7+26.5/31.0 RT		1
13+59.4/29.3 RT		1
14+50/35 LT		1
14+84/18 RT		1
		TOTAL: 5

CIP NO. ST0107 - REED STATION ROAD NORTH  
 EROSION CONTROL PLAN  
 STA. 11+50 TO STA. 16+50