

STATE OF ILLINOIS  
DEPARTMENT OF TRANSPORTATION

ROUTE NO.	SECTION	COUNTY	STATION	SHEET	SHEET NO. 11 22 SHEETS
F.A.P. 322	*	UNION	39	28	
FED. ROAD DIST. NO. 7	ILLINOIS	FED. AID PROJECT-	* (11-IVB)-1 CONTRACT NO. 98488		

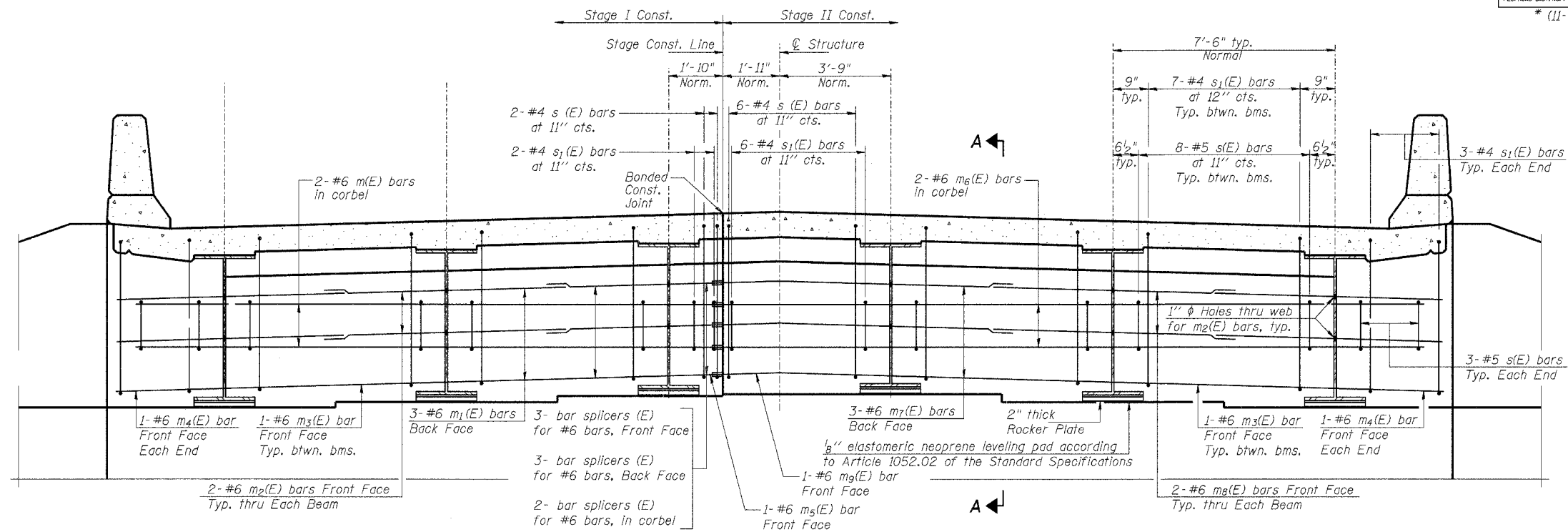

DIAPHRAGM ELEVATION AT ABUTMENT

Notes:  
Reinforcement bars in diaphragm are billed with superstructure on sheet 10 of 22.  
Concrete in diaphragm is included with Concrete Superstructure on sheet 10 of 22.  
For details of bars s(E) & s<sub>1</sub>(E) see sheet 10 of 22.  
The s(E) and s<sub>1</sub>(E) bars shall be placed parallel to the beams. Spacing for these bars shall be at right angles to the beams.  
For anchor bolt details see sheet 14 of 22.

MIN. BAR LAP

#6 bar = 2'-9"

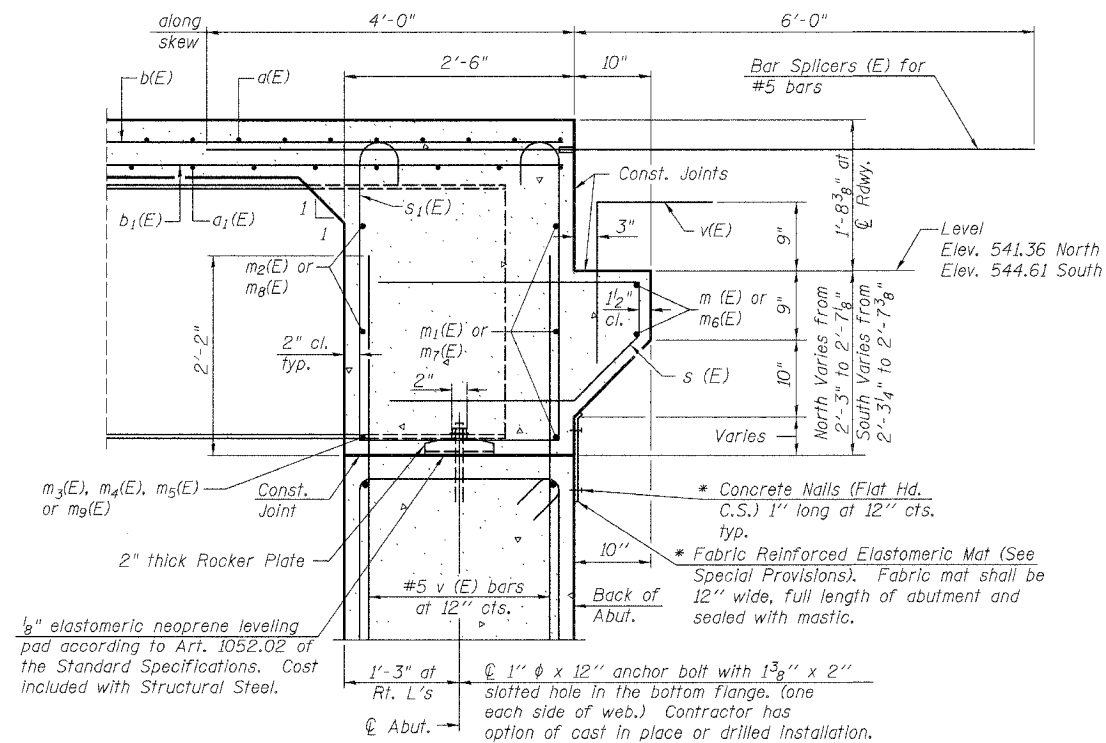

SECTION A-A

Dimensions at right angles to abutment, except as shown.  
\* Cost included with Concrete Superstructure.

ABUTMENT DETAILS  
U.S. ROUTE 51 OVER TRIBUTARY TO  
DRURY CREEK AND CN/IC RAILROAD  
FAP 322 - SECTION (11-IVB)-1  
UNION COUNTY  
STATION 583+74.84  
STRUCTURE NO. 091-0073

02/15/2005

DESIGNED	GLH
CHECKED	TML
DRAWN	RJN
CHECKED	TML

SI-DSI 9-01-03