

F.A.P. RTE.	SECTION	COUNTY	TOTAL SHEETS	SHEET NO.
322	(11-1VB)-1	UNION	39	12
STA. 580+00		TO STA. 581+50		
FED. ROAD DIST. NO. 7		ILLINOIS		
		FED. AID PROJECT		
		CONTRACT NO. 38488		

ORIGINAL SURVEY	DATE
SURVEYED	BY
NOTE BOOK	NO.
AREAS CHECKED	

FINAL SURVEY	DATE
SURVEYED	BY
NOTE BOOK	NO.
AREAS CHECKED	

PLOT DATE = 3/24/2005  
 FILE NAME = c:\projects\322\11-1VB\12-17 3-sec 011-0272.dgn  
 USER NAME = dlh@starnet.com

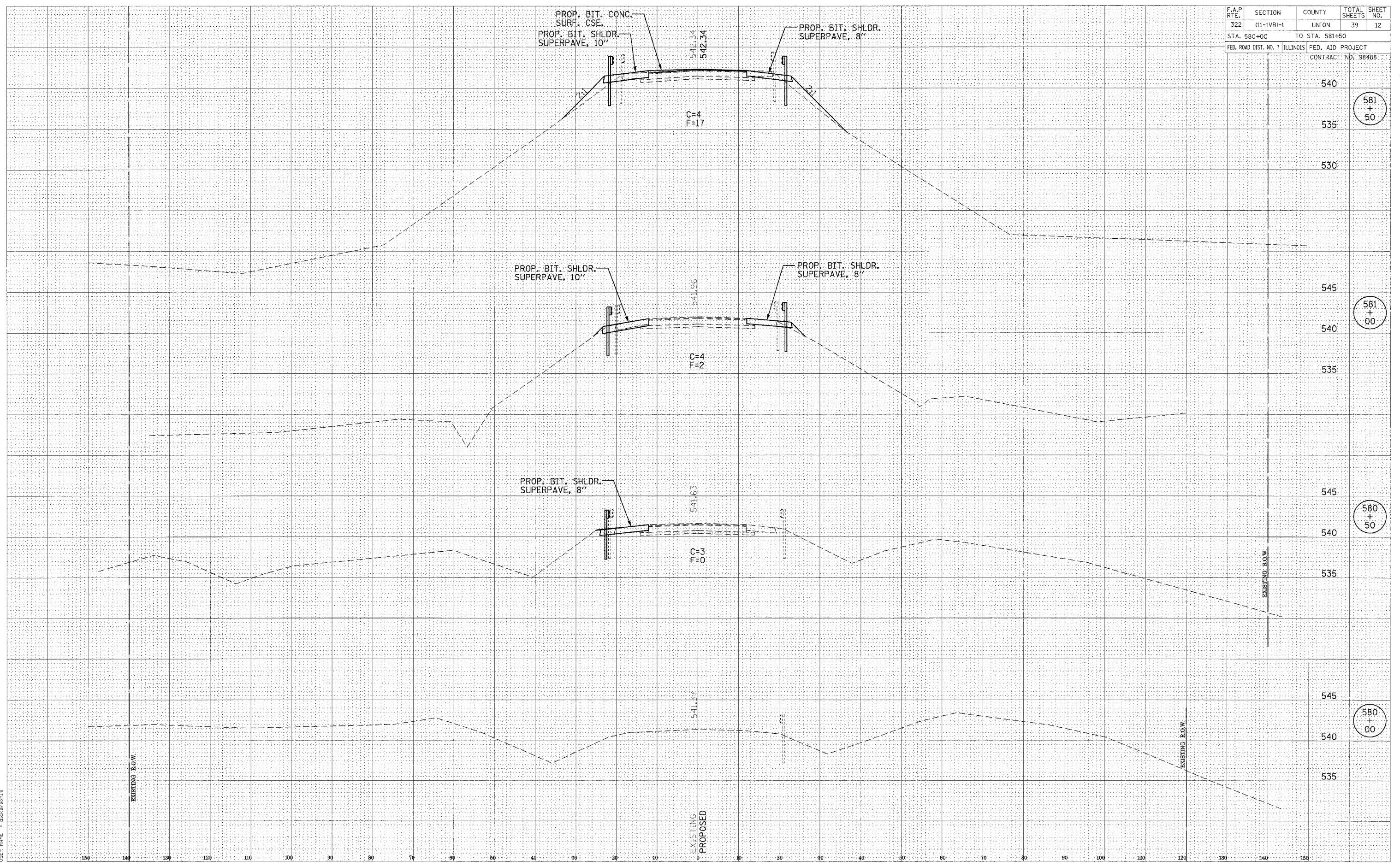

581 + 50

581 + 00

580 + 50

580 + 00

CROSS SECTIONS OF ROADWAY PROPOSED U.S. ROUTE 51 BRIDGE OVER DRURY CREEK AND CNIC RAILROAD