

FAP ROUTE	SECTION	COUNTY	TOTAL SHEETS	SHEET NO.
322	(11-1VB)-1	UNION	39	7
STA.	TO STA.		CONTRACT NO. 98488	

SUGGESTED SEQUENCE OF OPERATIONS

PRE STAGE I

INSTALL WIDE LOAD SIGNING AND ERECT SIGNALS AND SIGNING AS REQUIRED FOR STAGE I AND STAGE II CONDITIONS IN ACCORDANCE WITH THE SPECIAL PROVISION FOR TRAFFIC CONTROL AND PROTECTION STANDARD 701201 AND COVER UNTIL BARRIER PLACEMENT BEGINS.

REMOVE PARTIAL EXISTING SHOULDER FOR STAGE I TRAFFIC AND PLACE BITUMINOUS CONCRETE BASE COURSE WIDENING, SUPERPAVE 10".

PLACE TEMPORARY PAVEMENT MARKINGS ON THE WEST SIDE FOR STAGE I TRAFFIC USING TRAFFIC CONTROL AND PROTECTION STANDARD 701321 AND REMOVE EXISTING PAVEMENT MARKINGS BETWEEN TEMPORARY STOP BARS.

STAGE I



SAW CUT EXISTING BRIDGE DECK ALONG THE STAGE REMOVAL LINE AND DRIVE TEMPORARY SHEET PILING.

IMPLEMENT STAGE I TRAFFIC CONTROL BY PLACING TEMPORARY BRIDGE RAIL, TEMPORARY CONCRETE BARRIERS, IMPACT ATTENUATORS AND BARRELS TO ROUTE TRAFFIC OVER THE WEST LANE OF THE EXISTING BRIDGE.

REMOVE EAST PORTION OF THE EXISTING BRIDGE DECK, EXISTING PIERS, ABUTMENT BACK WALLS, UPPER PORTION OF WINGWALLS AND GUARDRAIL.

CONSTRUCT THE EAST (STAGE I) PORTION OF THE BRIDGE ABUTMENTS, WINGWALLS, PIERS, DECK, GRANULAR BACKFILL, BRIDGE APPROACH PAVEMENTS, TRAFFIC BARRIER TERMINALS, AND GUARD RAIL. REMOVE EXISTING SHOULDERS AND PLACE BITUMINOUS SHOULDERS SUPERPAVE FOR STAGE II TRAFFIC.

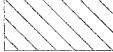
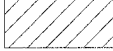
INSTALL TEMPORARY PAVEMENT MARKINGS ON THE WEST SIDE

-  BITUMINOUS CONCRETE BASE COURSE WIDENING, SUPERPAVE 10"
-  BITUMINOUS SHOULDERS SUPERPAVE, 8" THICKNESS
-  BITUMINOUS SHOULDERS SUPERPAVE, 10" THICKNESS

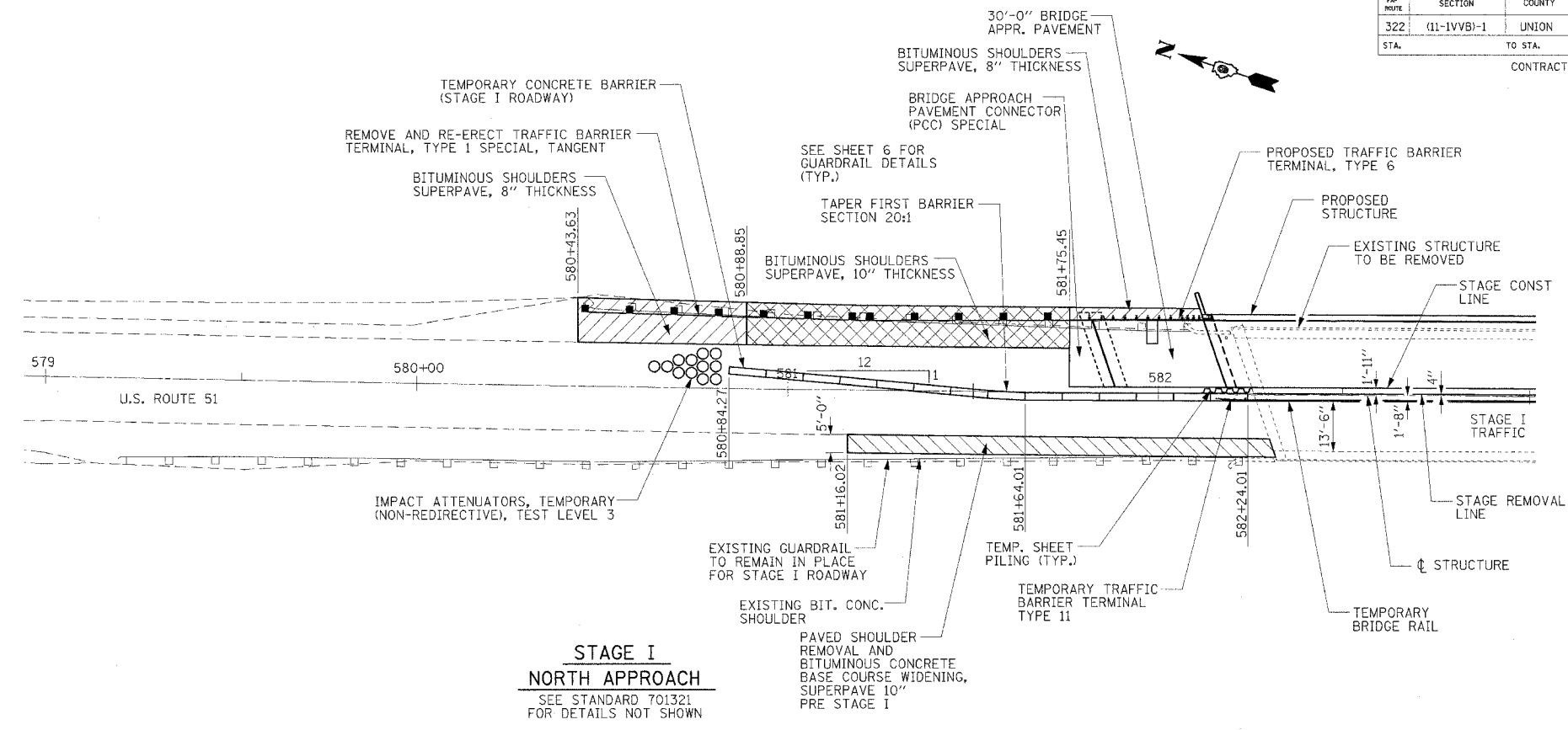

**STAGE I
NORTH APPROACH**
SEE STANDARD 701321
FOR DETAILS NOT SHOWN

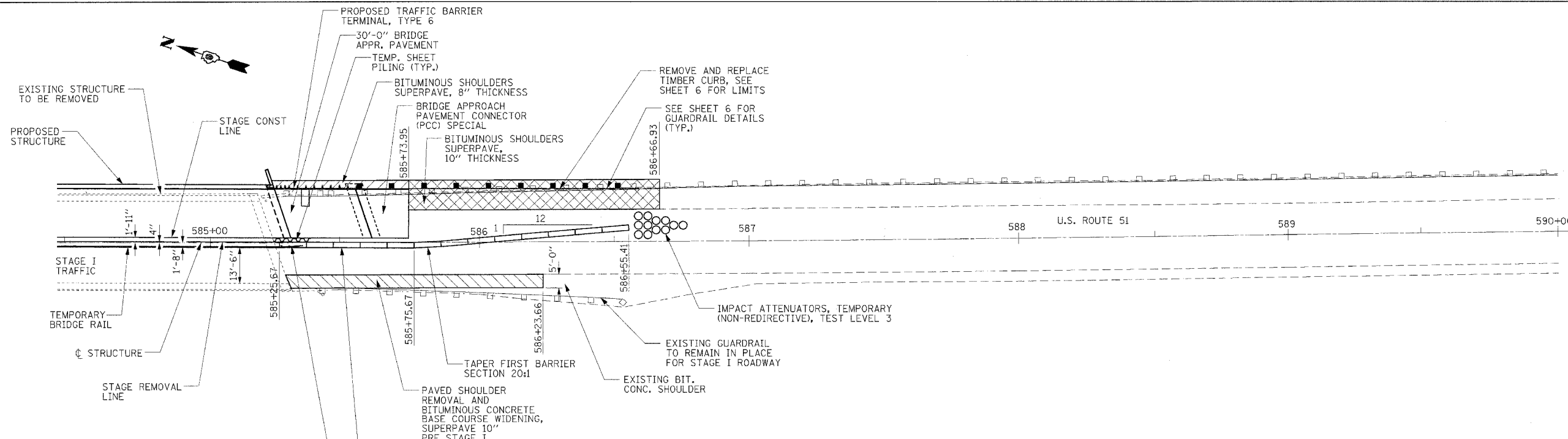

**STAGE I
SOUTH APPROACH**
SEE STANDARD 701321
FOR DETAILS NOT SHOWN

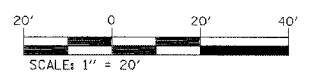

ILLINOIS DEPARTMENT OF TRANSPORTATION
**PLAN VIEW
STAGE I TRAFFIC**
FAP ROUTE 322
SECTION (11-1VB)-1
UNION COUNTY
DRAWN BY: J. NIEDERHOFER

REVISIONS	
NAME	DATE

PLAN	DATE
SUBMITTED	BY
NOTED	BY
CHECKED	BY
DATE	BY
NO.	ADD FILE NAME

PLOT DATE = 3/25/2026
FILE NAME = c:\projects\11-1vb\7-b_roadway staging 091-4073.dgn
PLOT SCALE = 28.000 / 1 IN.
USER NAME = jucker@idm