

INDEX OF SHEETS

- 1 COVER SHEET
- 2 GENERAL NOTES, AND LEGEND
- 3 SUMMARY OF QUANTITIES
- 4 TYPICAL SECTIONS - EXISTING
- 5 TYPICAL SECTIONS - PROPOSED
- 6-7 QUANTITY SCHEDULES
- 8-12 MAINTENANCE OF TRAFFIC - ADVANCED WARNING SIGNS & STAGES OF CONSTRUCTION
- 13 PLAN AND PROFILE SHEETS
- 14-15 DRAINAGE SHEETS
- 16-17 INTERSECTION GEOMETRIC DETAIL SHEETS
- 18 PAVEMENT MARKING SHEETS
- 19 REMOVAL SHEETS
- 20-23 TRAFFIC SIGNAL SHEETS
- 24 MISCELLANEOUS DETAIL SHEET
- 25-28 CROSS SECTIONS

STANDARDS

STD. NO.	
000001-04	780001-01
001001	805001
001006	814001
280001-02	857001
420001-05	877001-02
420111-01	878001-03
420701-01	880006
424001-03	886001
442101-05	886006
602701	BLR 22-4
606001-02	
666001	
701301-02	
701311-02	
701501-03	
701606-04	
701701-04	
701801-03	
702001-05	
720016-01	

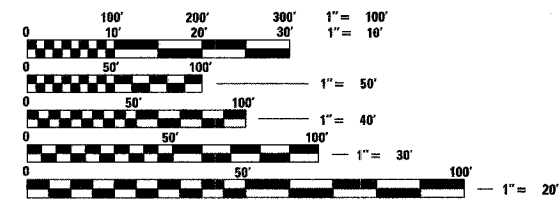

FULL SIZE PLANS HAVE BEEN PREPARED USING STANDARD ENGINEERING SCALES, REDUCED SIZED PLANS WILL NOT CONFORM TO STANDARD SCALES, IN MAKING MEASUREMENTS ON REDUCED PLANS, THE ABOVE SCALES MAY BE USED.

J.U.L.I.E.
JOINT UTILITY LOCATION INFORMATION FOR EXCAVATION
1-800-892-0123

CONTRACT NO. 97251

DESIGN DESIGNATION
FUNCTIONAL CLASSIFICATION: MINOR ARTERIAL
ADT: 10,600 (2006) 14,575 (2026)
DHV: 1169 (2026)
DESIGN SPEED: 30 MPH

STATE OF ILLINOIS
DEPARTMENT OF TRANSPORTATION
DIVISION OF HIGHWAYS
CITY OF GRANITE CITY
F.A.U. 9089 (20TH STREET) RECONSTRUCTION
PHASE I
MADISON COUNTY
FEDERAL PROJECT NO. M-5011 (178)
JOB. NO. C-98-350-04
SECTION NO. 02-00180-01-PV

PLAN 1" = 20'
PROFILE HORIZ. 1" = 20'
PROFILE VERT. 1" = 5'
CROSS SECTIONS 1" = 10' HORIZ.
1" = 5' VERT.

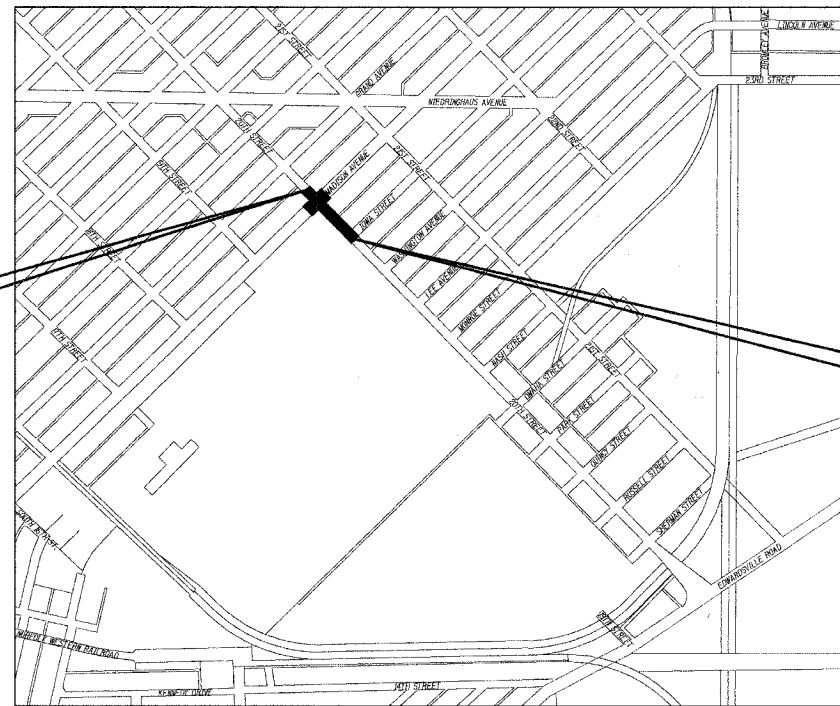

BEGIN PROJECT
STATION 106 + 00.00

END PROJECT
STATION 110 + 34.87

LOCATION MAP

SCALE: 1" = 600'

NET LENGTH OF PROJECT: 434.87 FEET - 0.082 MILES
SECTION 19, T. 3 N., R. 9 W., 3RD P.M.

F.A.U. RTE.	SECTION	COUNTY	TOTAL SHEETS	SHEET NO.
9089	02-00180-01-PV	MADISON	28	1
FED. ROAD DIST. NO.		ILLINOIS	FED. AID PROJECT	
CONTRACT NO. 97251				

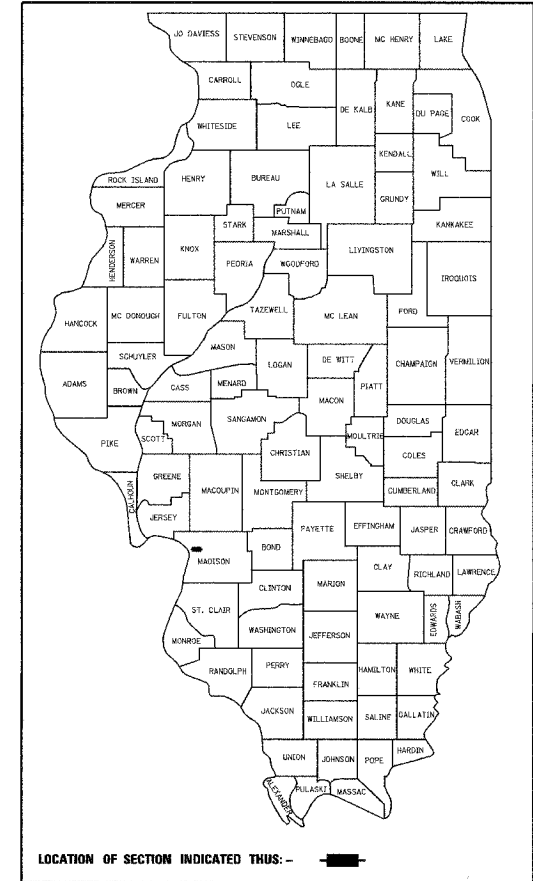

STATE OF ILLINOIS
DEPARTMENT OF TRANSPORTATION
DIVISION OF HIGHWAYS

APPROVED March 15 20 05
Carol J. [Signature]
LOCAL AGENCY OFFICIAL

PASSED April 8 20 05
Jennifer [Signature]
LOCAL ROADS AND STREETS ENGINEER

APPROVED April 9 20 05
Mary C. [Signature]
MARY C. LAMIE, P.E.
DEPUTY DIRECTOR OF HIGHWAYS
REGION FIVE ENGINEER



Expires 11-30-05

Brian F. Kulick 3/15/05
BRIAN F. KULICK, P.E. No. 49936 DATE
(Printed by Authority of the State of Illinois)
Job No. E030204



Juneau Associates, Inc. P.C.
CONSULTING ENGINEERS AND LAND SURVEYORS

2100 State Street, P.O. Box 1325
Granite City, Illinois 62040
Phone: (618) 877-1400 / (618) 452-5535
Fax: (618) 452-5541

100 North Research Drive
Edwardsville, Illinois 62025
Phone: (618) 659-0900 / (618) 659-0800
Fax: (618) 659-0841