

ROUTE	SECTION	COUNTY	TOTAL SHEETS	SHEET NO.
FAS 738	01-00072-00-BR	GREENE	28	3

FEDERAL AID PROJECT
CONTRACT NO. 97249

REVISION	DATE
1	
2	
3	
4	
5	

PROJECT MANAGER: DAVID M. MARTH
ENR. AT RECORD: DAVID M. MARTH
RES. NO. 012-248586
SUPERVISOR: MIKE SCHEMELTON
RES. NO.

GREENE COUNTY
HIGHWAY DEPARTMENT

ACCOUNT: BRPP BRIDGE
DATE: JANUARY 31, 2005
DESIGNED BY: DAVID M. MARTH
CHECKED BY: DAVID M. MARTH
APPROVED BY: DAVID M. MARTH

FAS 738 OVER
HURRICANE CREEK

SECTION 01-00072-00-BR

DRAWING
SHEET
OF

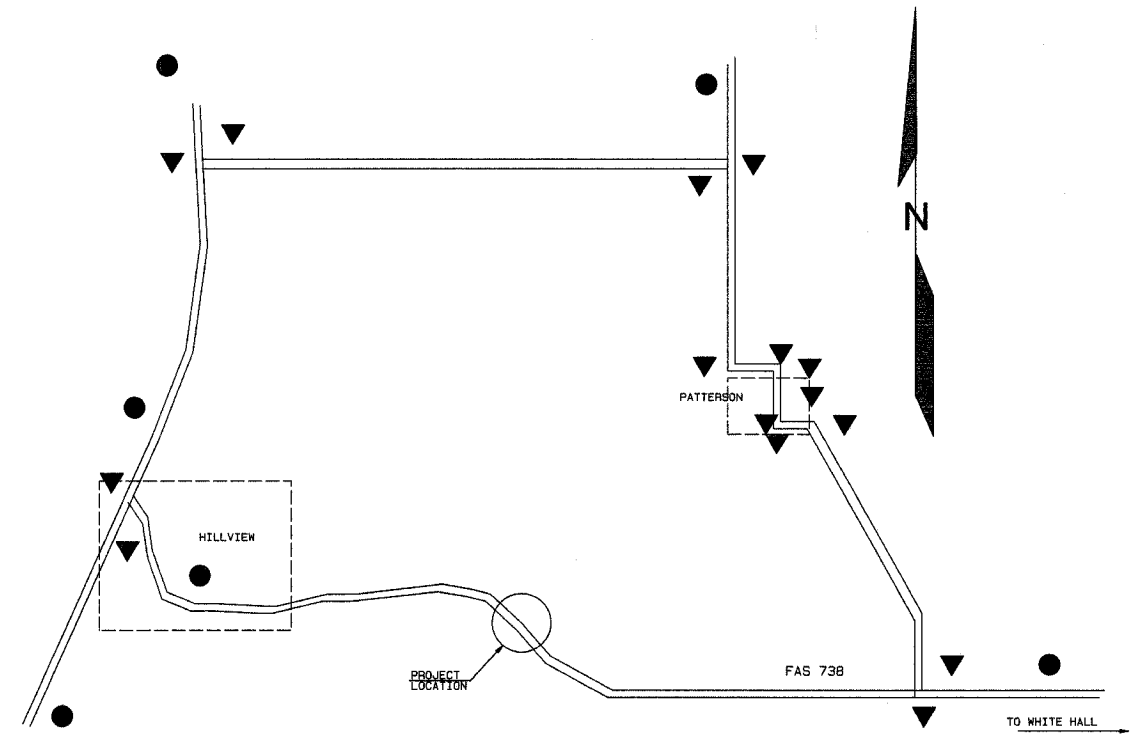

DETOUR SIGNING DETAIL

LEGEND

- DETOUR AHEAD SIGNS
- DETOUR SIGNS W/ ARROWS

SCHEDULE OF QUANTITIES FOR DETOUR TRAFFIC CONTROL AND MAINTENANCE

ITEM NO.	ITEM	UNIT	QUANTITY
40200800	AGGREGATE SURF. CSE. TYPE B	TON	1800
40300200	BITUMINOUS MATERIALS (PRIME COAT)	TON	33
40300400	BITUMINOUS MATERIALS (COVER AND SEAL COAT)	TON	208
40300600	SEAL COAT AGGREGATE	TON	2080
70101830	TRAFFIC CONT. & PROT. STD. BLR 21	L.SUM	1
*70102550	TRAF. CONT. & PROT. FOR TEMP. DETOUR	EACH	1

*See Special Provisions

NOTES

1. The Contractor shall maintain the roadway surface of the detour route throughout the duration of the contract as directed by the Engineer. This may include but is not limited to patching, aggregate surface/base repair and seal coating.
2. The Contractor shall repair all damaged areas and seal coat all local detour routes upon completion of construction and closure of detour route.
3. The contractor shall maintain all detour route signing as shown in the plans and specified in the special provisions.
4. The Aggregate Surface Course, Bituminous Materials (Prime Coat), Bituminous Materials (Cover and Seal Coats) and Seal Coat Aggregate quantities have been placed in the contract to repair and restore the temporary detour route during and after completion of construction of the bridge as directed by the Engineer.
5. No additional compensation will be given for frequency of repairs needed as directed by the Engineer.

DETOUR ROUTE DETAILS, QUANTITIES AND REQUIREMENTS

DETOUR ROUTE DETAIL,
CONSTRUCTION DETAILS AND QUANTITY SCHEDULES
FAS 738 OVER HURRICANE CREEK
SECTION 01-00072-00-BR
GREENE COUNTY