

**DESIGN CLASSIFICATION**

ROAD CLASSIFICATION = MAJOR COLLECTOR  
 2004 ADT = 2400  
 2024 DESIGN ADT = 3025  
 DESIGN SPEED 50 MPH  
 DESIGN SPEED 60 MPH

**CONTRACT NO. 97248**

**SCALES**

PLAN REFER TO INDIVIDUAL SHEETS  
 PROFILE HOR. REFER TO INDIVIDUAL SHEETS  
 PROFILE VERT. REFER TO INDIVIDUAL SHEETS  
 CROSS SECTIONS HOR. 1" = 10'  
 CROSS SECTIONS VERT. 1" = 5'

**INDEX OF SHEETS**

SHEET NUMBER	DESCRIPTION
1	COVER
2	TYPICAL SECTIONS
3	GENERAL NOTES AND SCHEDULES
4	SUMMARY OF QUANTITIES
5	LOCATION MAP, STRIPING, BUTT JOINT DETAILS
6-7	SIDEROAD, ENTRANCE, MAILBOX TURNOUT SCHEDULE
8-10	PLAN & PROFILE
11	INTERSECTION PLAN
12-27	CROSS-SECTIONS

**LIST OF STANDARDS**

EROSION CONTROL	280001-02
DRAINAGE	606301-02
	606001-02
BRIDGES AND CULVERTS	542401
TRAFFIC CONTROL	701006-02
	701011-01
	701201-02
	701301-02
	701306-01
	701311-02
	701326-02
	702001-05
PAVEMENT MARKING	780001-01
	781001-02

**UTILITIES**

CALL J.U.L.I.E. BEFORE YOU DIG  
 800-892-0123

**SCHEDULE OF STATION EQUATIONS**

BK. STA. 3+32.3 - AHEAD STA. 3+40.21  
 BK. STA. 32+41.18 - AHEAD STA. 31+64.15

**LOCATION MAP**

SCALE: 1" = 2 MILE  
 GROSS LENGTH OF PROJECT 26537.28 FEET  
 5.026 MILES  
 NET LENGTH OF PROJECT 26606.39 FEET  
 5.039 MILES

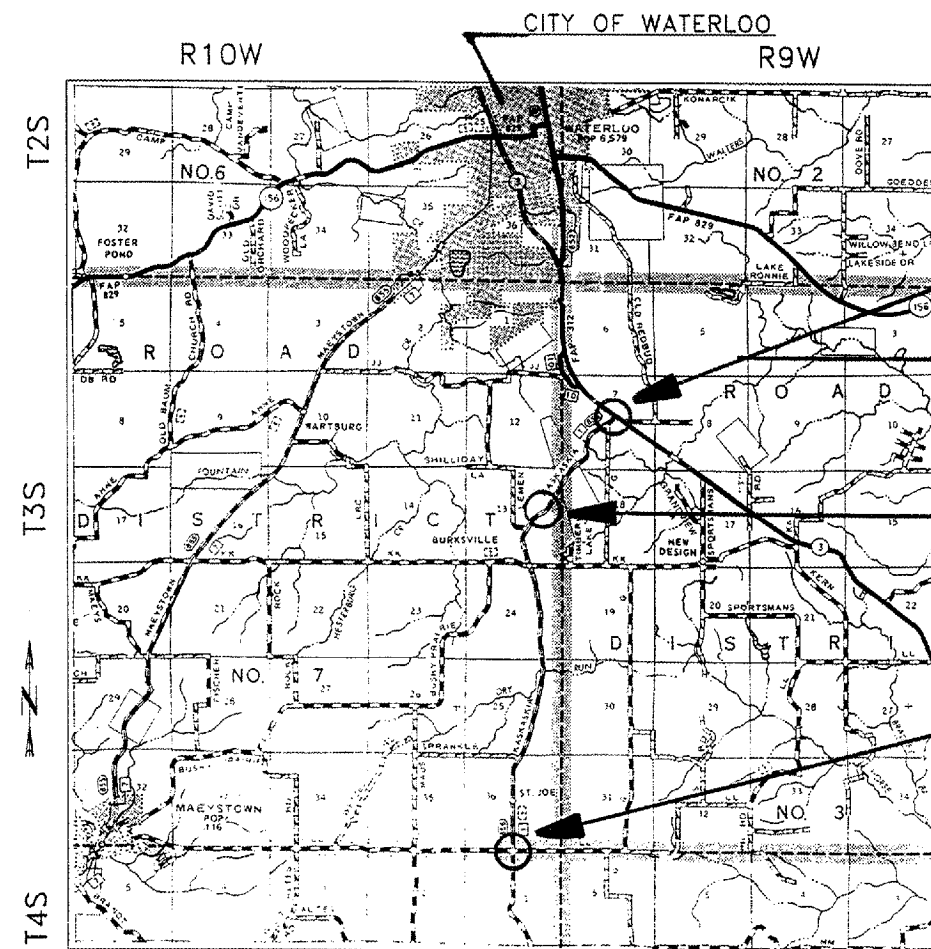

BEGIN PROJECT  
 STA. 0+00

IL RTE. 3  
 STA. 1876+87.08 TO  
 STA. 1883+76.34

REALIGNMENT  
 STA. 51+00 TO  
 STA. 69+00

END PROJECT  
 STA. 265+87

DRAWN BY \_\_\_\_\_ DATE 1-12-05  
 CHECKED BY \_\_\_\_\_ DATE 1-12-05

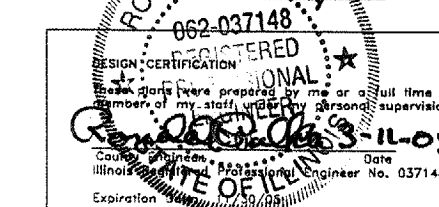

ROUTE NO	SECTION	COUNTY	TOTAL SHEETS	SHEET NO.
FAS 856 C.H.1	02-00041 -01-RS	MONROE	27	1

FEDERAL AID PROJECT  
 CONTRACT NO. 97248



LOCATION OF SECTION INDICATED THUS: [Symbol]

APPROVED *March 11 2005*  
*Ronald A. Polka*  
 LOCAL AGENCY OFFICIAL

PASSED *April 8 2005*  
*Jennifer Obertus*  
 DISTRICT ENGINEER OF LOCAL ROADS & STREETS

APPROVED *April 8 2005*  
*Mary C. Jamie*  
 MARY C. JAMIE, P.E.  
 DEPUTY DIRECTOR OF HIGHWAYS  
 REGION FIVE ENGINEER

STATE OF ILLINOIS  
 DEPARTMENT OF TRANSPORTATION