

CONTRACT NO. 97245

**THOUVENOT,  
WADE &  
MOERCHEN, INC.**  
ENGINEERS • SURVEYORS • PLANNERS



**CORPORATE OFFICE**  
4940 OLD COLLINSVILLE RD.  
SWANSEA, ILLINOIS 62226  
TEL (618) 624-4488  
FAX (618) 624-6688  
corp@twm-inc.com

**WATERLOO OFFICE**  
118 EAST THIRD STREET  
WATERLOO, ILLINOIS 62298  
TEL (618) 939-5050  
FAX (618) 939-3938  
waterloo@twm-inc.com

**ST. LOUIS OFFICE**  
1001 CRAIG ROAD, SUITE 260  
ST. LOUIS, MISSOURI 63146  
TEL (314) 236-5052  
FAX (314) 872-2194  
stlou@twm-inc.com

PROFESSIONAL REGISTRATIONS	LICENSE NO.
ILLINOIS PROFESSIONAL DESIGN FIRM	184-00220
PROFESSIONAL ENGINEERING CORP.	62-03378
PROFESSIONAL STRUCTURAL ENGR. CORP.	01-005202
ILLINOIS PROF. LAND SURVEYING CORP.	048-000029
MISSOURI PROFESSIONAL ENGR. CORP.	NC 001528
MISSOURI LAND SURVEYING CORP.	NE 000346

SEAL

Renewed Date: \_\_\_\_\_  
Signature Date: \_\_\_\_\_

**STATEMENT OF RESPONSIBILITY**  
I hereby confirm that the document herein to be authorized by my seal is restricted to this sheet, and I hereby disclaim any responsibility for all other drawings, specifications, estimates, reports or other documents or instruments relating to or intended to be utilized for any other part of the architectural, engineering or survey project.

PLAN	DATE
BY: _____	_____
DATE: _____	_____
BY: _____	_____
DATE: _____	_____

PROFILE	DATE
BY: _____	_____
DATE: _____	_____
BY: _____	_____
DATE: _____	_____

ST/MS  
#/TIMES

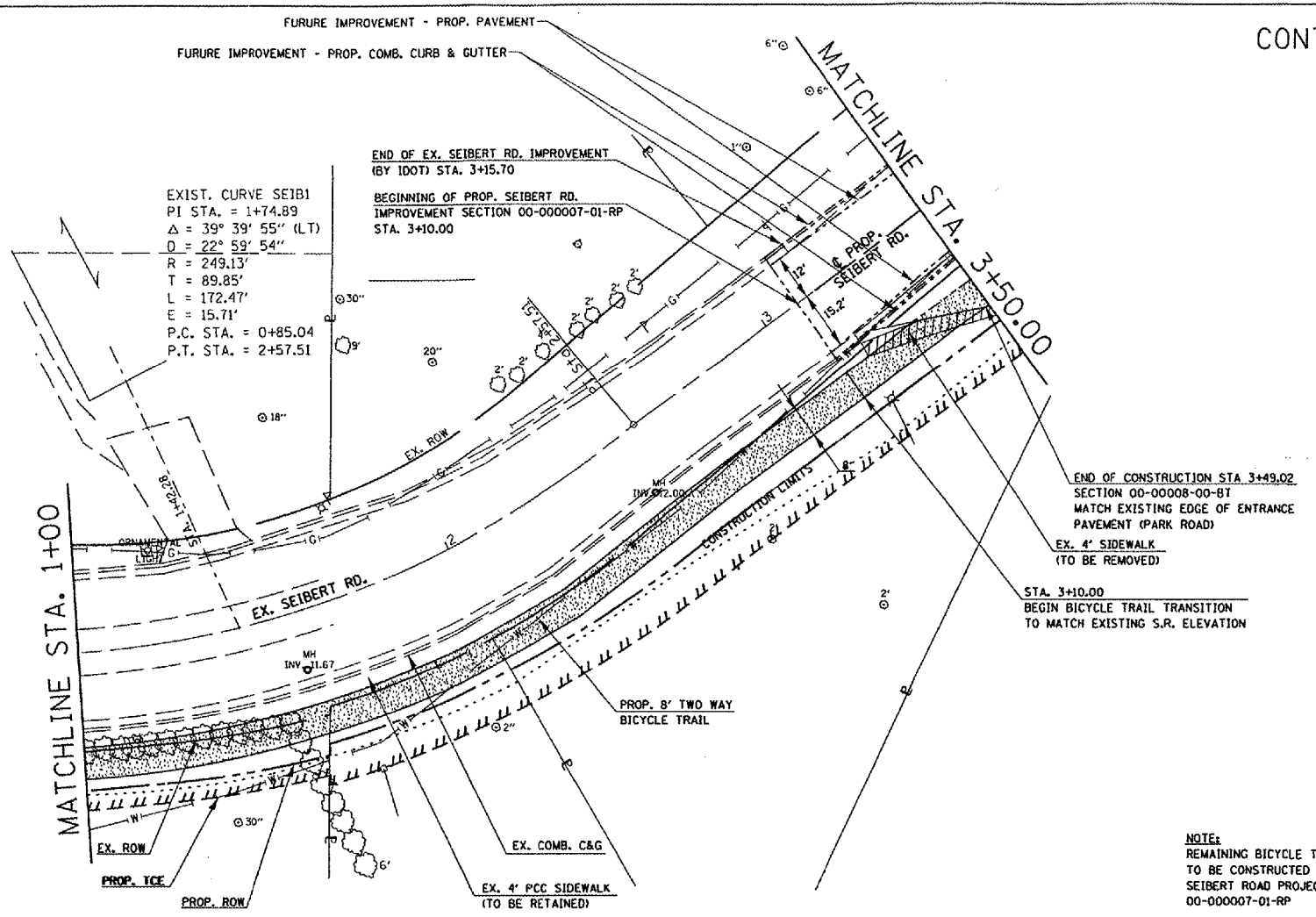

BICYCLE ROUTE  
 SIDEWALK REMOVAL

NOTE:  
REMAINING BICYCLE TRAIL  
TO BE CONSTRUCTED WITH  
SEIBERT ROAD PROJECT  
00-000007-01-RP

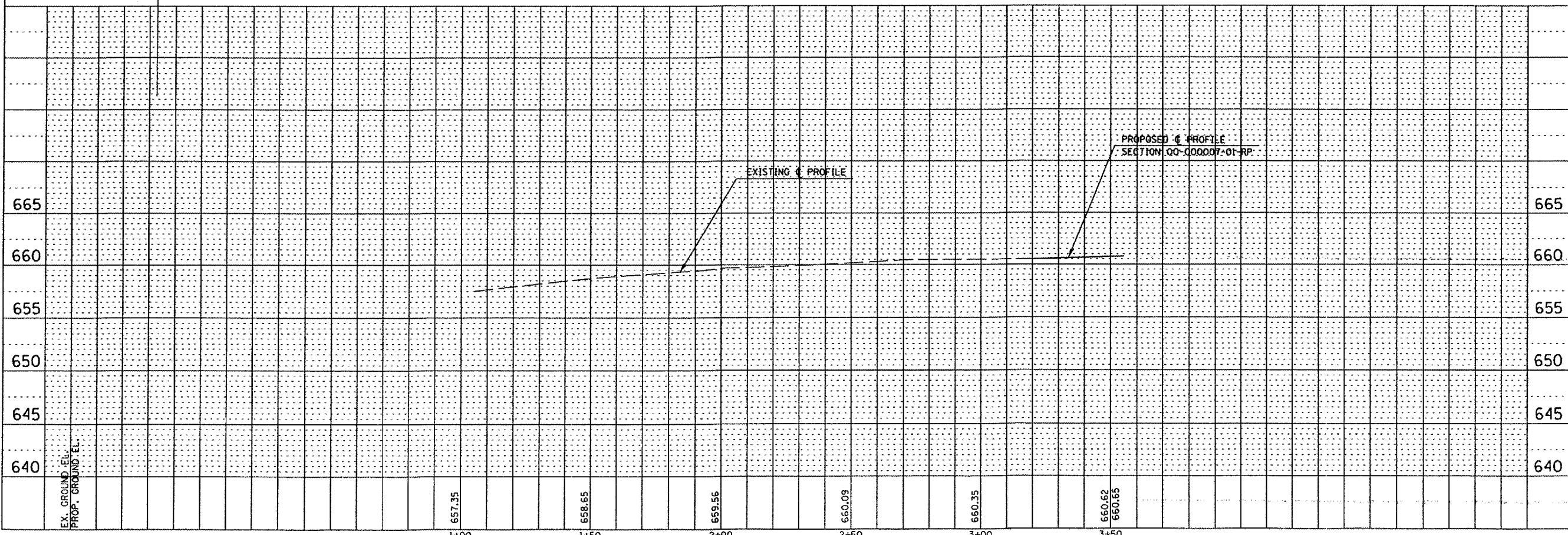
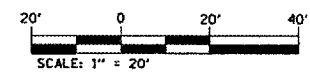

TITLE: **PLAN AND PROFILE SHEETS  
SEIBERT RD.**

PROJECT: **BIKE TRAIL  
VILLAGE OF SHILOH  
ST. CLAIR COUNTY, ILLINOIS**

REV.	DATE	DESCRIPTION
△	/ /	
△	/ /	

DRAWN BY:	SJK	SHEET
DESIGNED BY:		13
CHECKED BY:		
CONTRACT NUMBER:		
PROJECT NUMBER:	99751	OF 37 SHEETS
<input checked="" type="checkbox"/> ISSUED FOR REVIEW		<input type="checkbox"/> ISSUED FOR BIDDING
<input type="checkbox"/> ISSUED FOR CONSTR.		<input type="checkbox"/> RECORD DRAWING