

CONTRACT NO. 97245

**THOUVENOT, WADE & MOERCHEN, INC.**  
ENGINEERS SURVEYORS PLANNERS



**CORPORATE OFFICE**

4940 OLD COLLINSVILLE RD.  
SWANSEA, ILLINOIS 62226  
TEL (618) 624-4488  
FAX (618) 624-6688  
corp@twm-inc.com

**WATERLOO OFFICE**

118 EAST THIRD STREET  
WATERLOO, ILLINOIS 62298  
TEL (618) 939-5050  
FAX (618) 939-3938  
waterloo@twm-inc.com

**ST. LOUIS OFFICE**

NOO CRAIG ROAD, SUITE 260  
ST. LOUIS, MISSOURI 63146  
TEL (314) 236-5052  
FAX (314) 872-2194  
stlouis@twm-inc.com

PROFESSIONAL REGISTRATIONS LICENSE NO.

ILLINOIS PROFESSIONAL DESIGN FIRM 084-00720  
PROFESSIONAL ENGINEERING CORP. 62-00570  
PROFESSIONAL STRUCTURAL ENGR. CORP. 81-005202  
ILLINOIS PROF. LAND SURVEYING CORP. 048-000029

MISSOURI PROFESSIONAL ENGR. CORP. MC 00158  
MISSOURI LAND SURVEYING CORP. MC 000346

SEAL

Renewal Date: \_\_\_\_\_  
Signature Date: \_\_\_\_\_

**STATEMENT OF RESPONSIBILITY**  
I, hereby confirm that the document herein to be authenticated by my seal is restricted to this sheet, and I hereby disclaim any responsibility for all other drawings, specifications, estimates, reports or other documents or instruments relating to or intended to be utilized for any other part of the architectural, engineering or survey project.

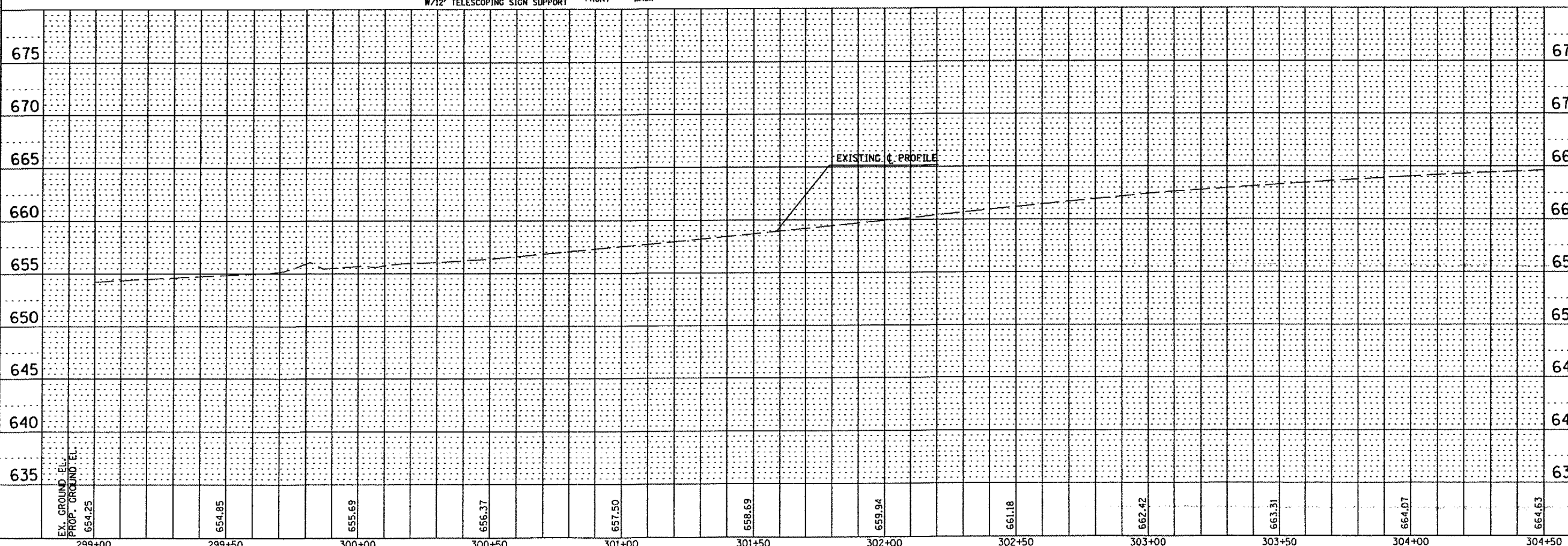
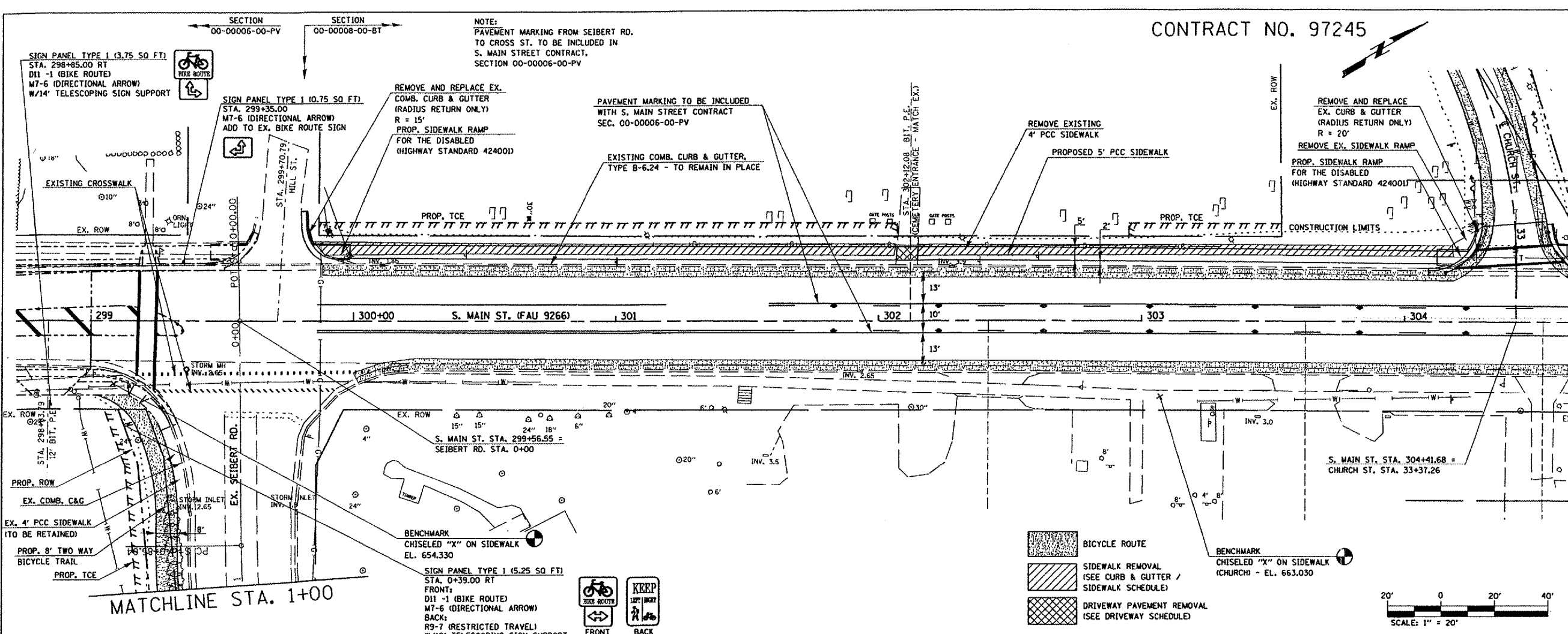

TITLE: **PLAN AND PROFILE SHEETS**  
PROJECT: **BIKE TRAIL VILLAGE OF SHILOH ST. CLAIR COUNTY, ILLINOIS**

REV.	DATE	DESCRIPTION
△	/ /	
△	/ /	

DRAWN BY:	SGK	SHEET
DESIGNED BY:		12
CHECKED BY:		
CONTRACT NUMBER:		
PROJECT NUMBER:	99781	OF 37 SHEETS
<input checked="" type="checkbox"/> ISSUED FOR REVIEW <input type="checkbox"/> ISSUED FOR BIDDING <input type="checkbox"/> ISSUED FOR CONSTR. <input type="checkbox"/> RECORD DRAWING		

DATE	BY	REVISIONS
		1. REVISED
		2. PLOTTED
		3. CHECKED
		4. STRUCTURE
		5. NOTATION
		6. CRED

DATE	BY	REVISIONS
		1. REVISED
		2. PLOTTED
		3. CHECKED
		4. STRUCTURE
		5. NOTATION
		6. CRED

DATE	BY	REVISIONS
		1. REVISED
		2. PLOTTED
		3. CHECKED
		4. STRUCTURE
		5. NOTATION
		6. CRED