

F.A.P. RTE.	SECTION	COUNTY	TOTAL SHEETS	SHEET NO.
750	(112,113) Y, WRS	FAYETTE	159	149
STA.	TO STA.			
FED. ROAD DIST. NO. 7		ILLINOIS		FED. AID PROJECT
CONTRACT NO. 94927				

FINAL SURVEY
 SURVEYED PLOTTED
 NOTE BOOK TEMPLATE
 NO. AREAS CHECKED

ORIGINAL SURVEY
 SURVEYED PLOTTED
 NOTE BOOK TEMPLATE
 NO. AREAS CHECKED

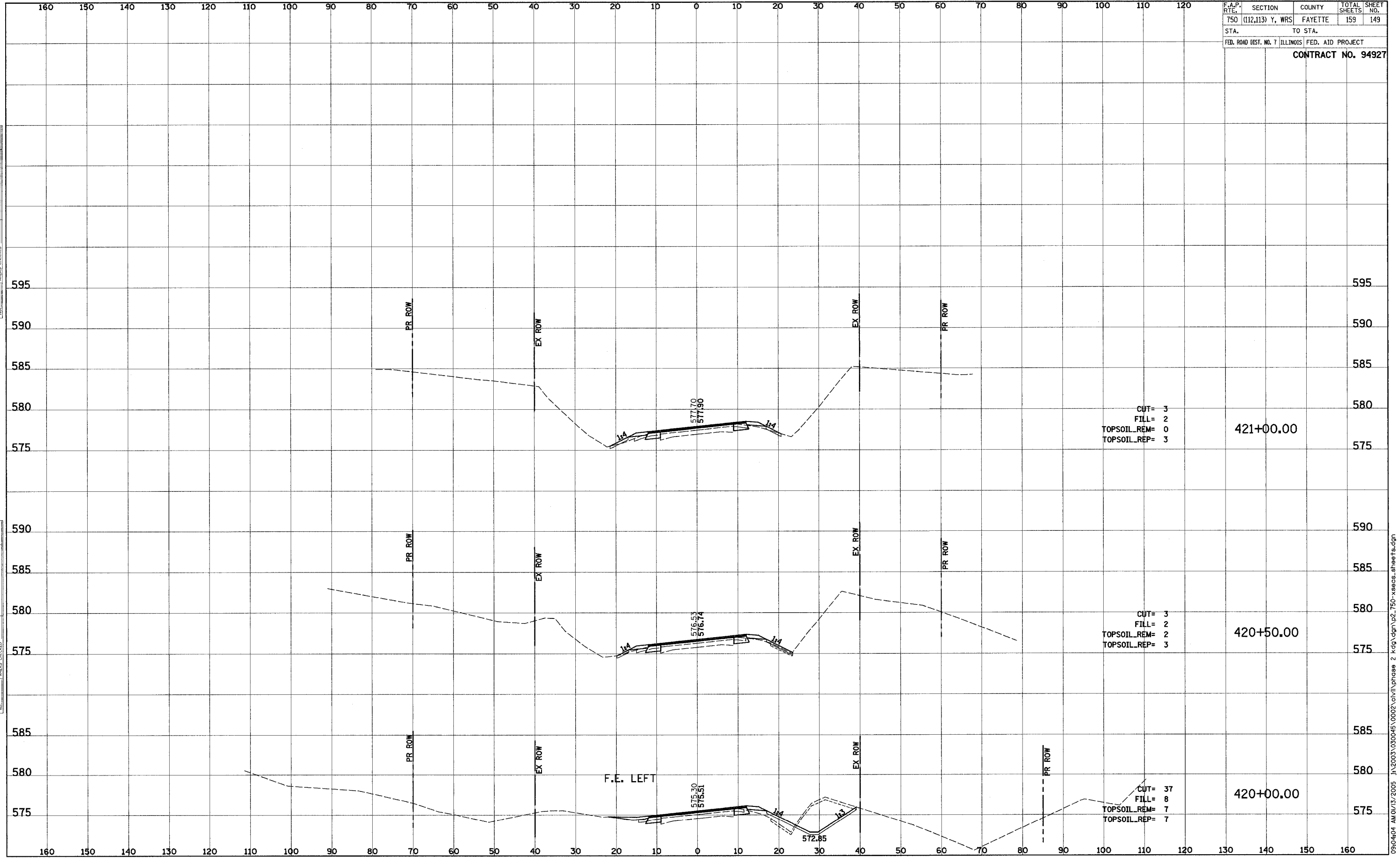

09/04/04 AM 01/13/2005 J:\2003\030045\0002\civil\phase 2 kdg\dn\p2_750-xsecs.sheets.dgn