

F.A.P. RTE.	SECTION	COUNTY	TOTAL SHEETS	SHEET NO.
750	(112,113) Y, WRS	FAYETTE	159	27
STA. 404+48	TO STA. 436+00			
FED. ROAD DIST. NO. 7		ILLINOIS	FED. AID PROJECT	

CONTRACT NO. 94927

PLAN	SURVEYED	DATE
NOTE BOOK	ALIGNMENT CHECKED	
NO.	RT. OF WAY CHECKED	
	PROP. FILE MARK	

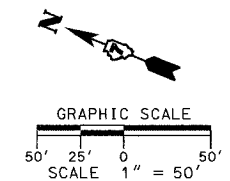
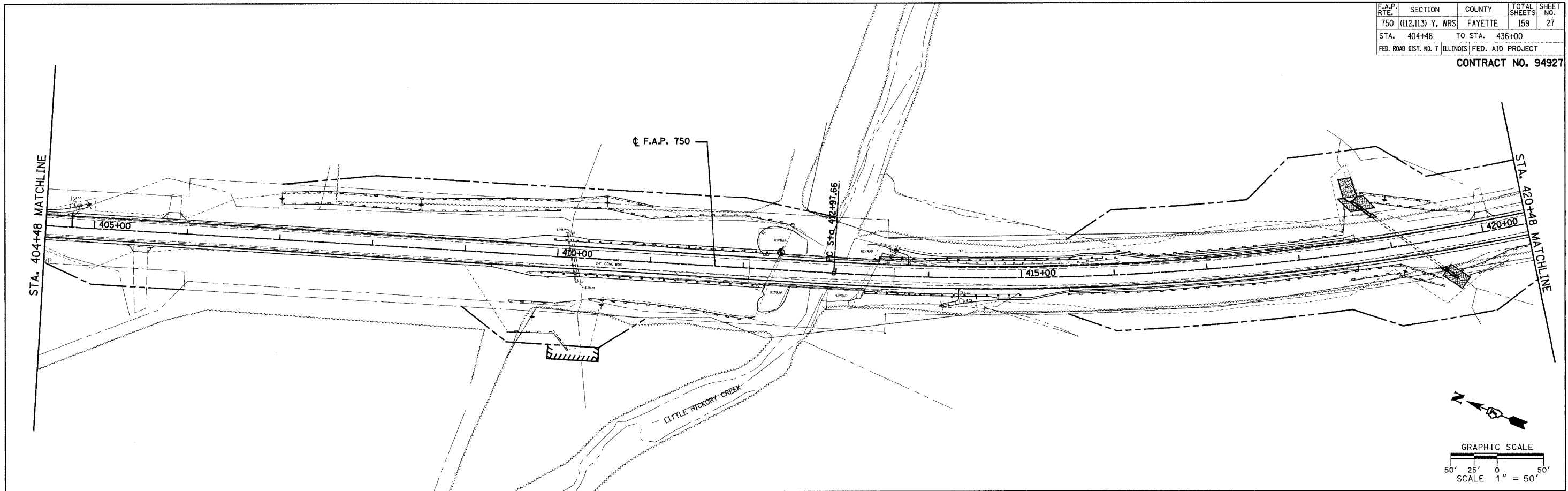

PLAN	SURVEYED	DATE
NOTE BOOK	ALIGNMENT CHECKED	
NO.	RT. OF WAY CHECKED	
	PROP. FILE MARK	

TEMPORARY EROSION CONTROL LEGEND

- RIPRAP TO REMAIN AFTER CONSTRUCTION
- TEMPORARY DITCH CHECK, STRAW BALES
- EROSION CONTROL FIBER BLANKET, 6 FT. WIDE MINIMUM
- PERIMETER EROSION BARRIER, SILT FILTER FENCE OR OTHER AS APPROVED BY THE ENGINEER
- INLET AND PIPE PROTECTION, STRAW BALES OR SILT FILTER FENCE

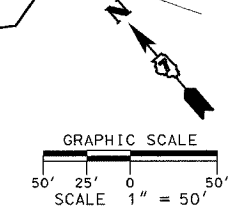
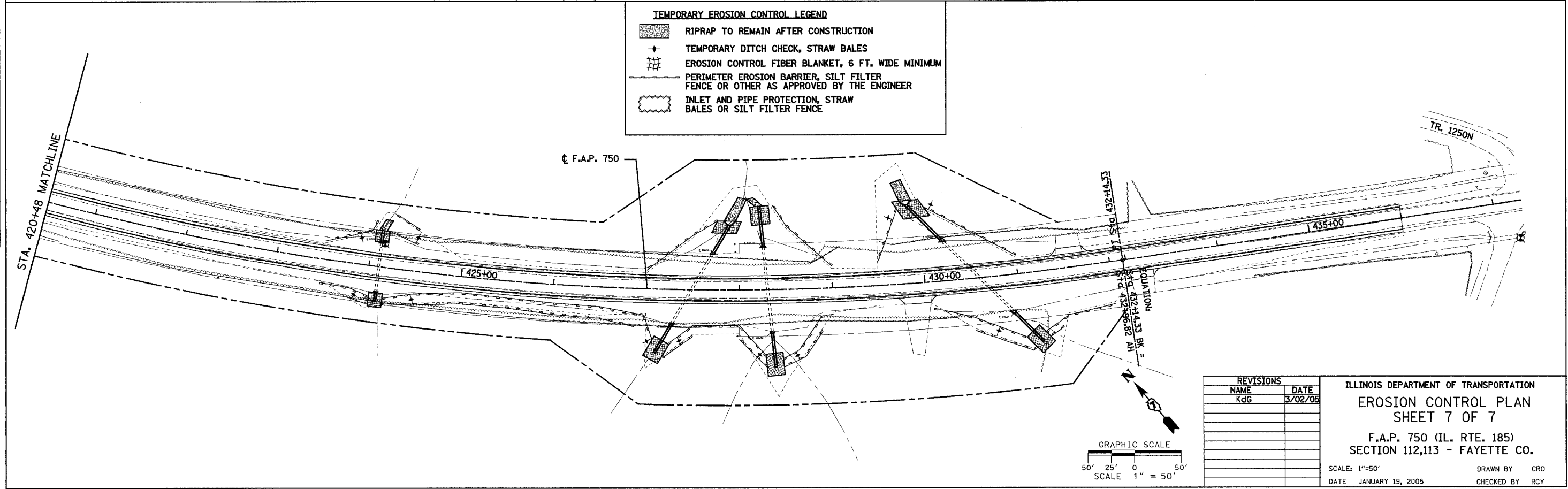

REVISIONS	
NAME	DATE
KdG	3/02/05

ILLINOIS DEPARTMENT OF TRANSPORTATION
EROSION CONTROL PLAN
SHEET 7 OF 7
 F.A.P. 750 (IL. RTE. 185)
 SECTION 112,113 - FAYETTE CO.
 SCALE: 1"=50'
 DATE: JANUARY 19, 2005
 DRAWN BY: CRO
 CHECKED BY: RCY

J:\2003\030045\0002\civil\phase 2 kdg\dgn\p2_ero750_7.dgn 12:33:29 PM 3/2/2005