

teesleyck
 4/4/2005
 c:\projects\94866d\d02204pa.dgn
 PS 6

FAP ATE	SECTION	COUNTY	TOTAL SHEETS	SHEET NO.
322	26RS-2	MARION	18	13
FED. ROAD DIST. NO. 7		ILLINOIS	FED. AID PROJECT NO.	

CONTRACT NO. 94866



EXIST. CURVE C2
 PI STA. = 765+51.21
 Δ = 30° 46' 23" (RT)
 D = 1° 29' 58"
 R = 3,821.07'
 T = 1,051.53'
 L = 2,052.26'
 E = 142.05'
 e = -----
 T.R. = -----
 S.E. RUN = -----
 P.C. STA. = 754+99.68
 P.T. STA. = 775+51.94

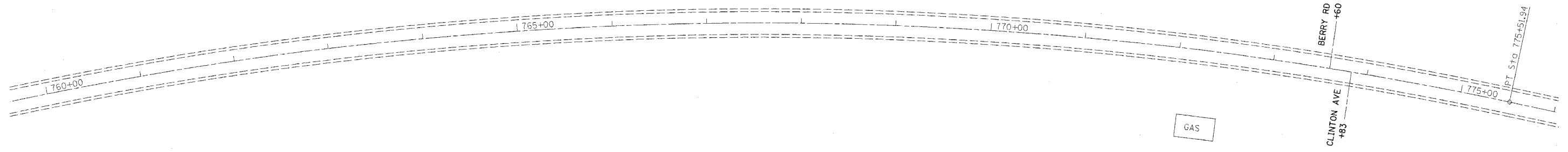

REVISIONS	
NAME	DATE

ILLINOIS DEPARTMENT OF TRANSPORTATION

**STA 760+00
 TO
 STA 775+00**

SCALE: VERT.
 HORIZ.
 DATE

DRAWN BY
 CHECKED BY