

FINAL SURVEY	SURVEYED	BY	DATE
NOTE BOOK NO.	FLIPPED		
	TEMPLATE		
	AREAS CHECKED		

ORIGINAL SURVEY	SURVEYED	BY	DATE
NOTE BOOK NO.	FLIPPED		
	TEMPLATE		
	AREAS CHECKED		

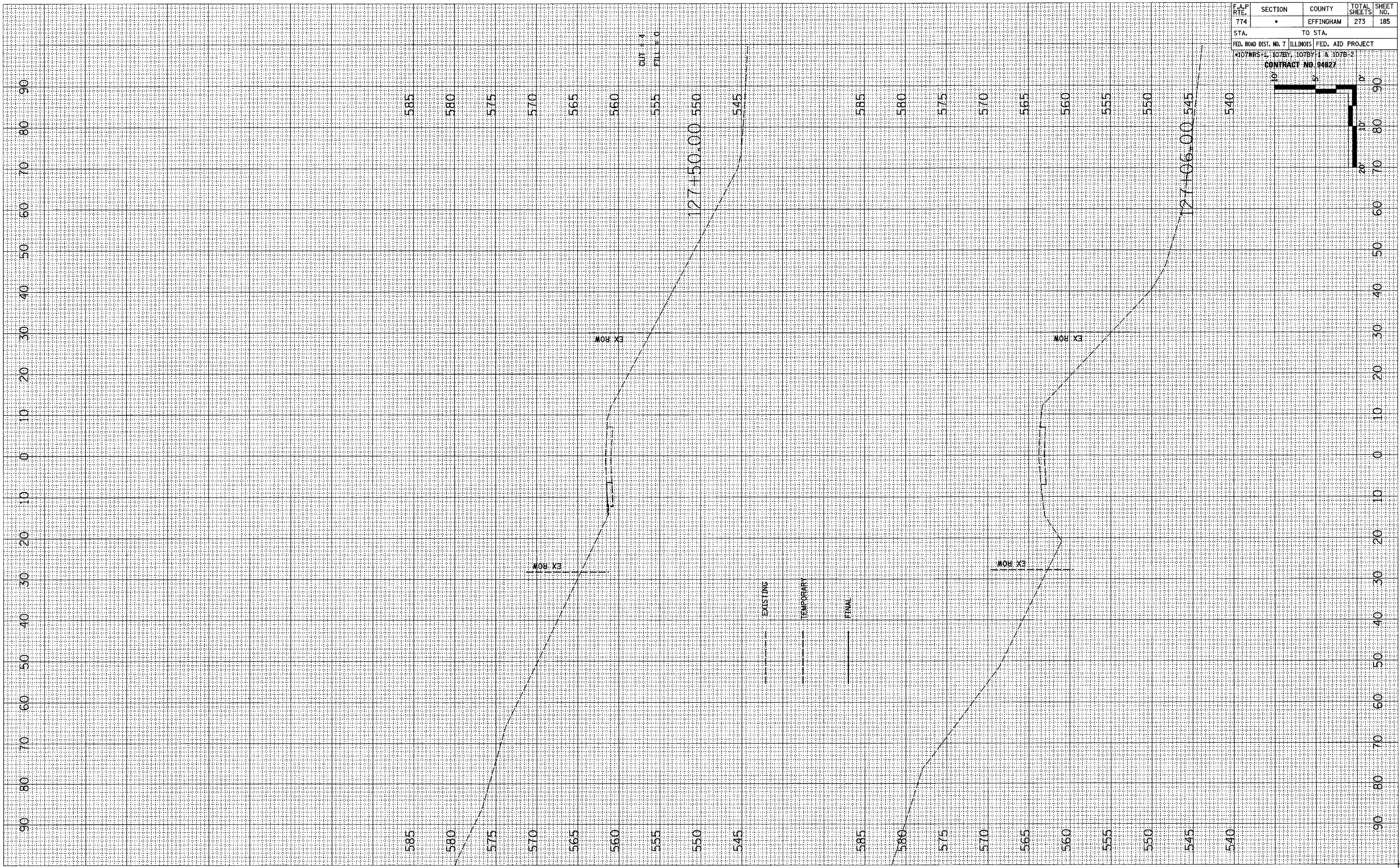

F.A.P. RTE.	SECTION	COUNTY	TOTAL SHEETS	SHEET NO.
774	*	EFFINGHAM	273	185
STA.		TO STA.		
FED. ROAD DIST. NO. 7 ILLINOIS FED. AID PROJECT				
107WRS-1, 107BY, 107BY-1 & 107B-2				
CONTRACT NO 94827				

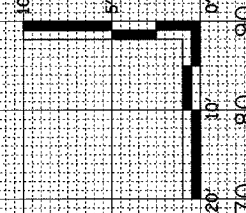

1/2" = 10' (VERTICAL) 1" = 100' (HORIZONTAL)