

F.A.P. RTE.	SECTION	COUNTY	TOTAL SHEETS	SHEET NO.
774		EFFINGHAM	273	40
FED. ROAD DIST. NO. 7		ILLINOIS	FED. AID PROJECT	
107WRS-1, 107BY, 107BY-1 & 107B-2		CONTRACT NO. 94827		

- NOTES:**
1. MAINTAIN 2 LANE 2 WAY TRAFFIC ON IL ROUTE 32/33 THROUGHOUT DURATION OF STAGE II CONSTRUCTION.
 2. FOR PROPOSED STAGE II TRAFFIC CONTROL TYPICAL SECTIONS, SEE SHEETS 14, 15 AND 16 OF 23.
 3. ALL TRAFFIC CONTROL ITEMS FOR STAGE II TO BE INCLUDED IN THE COST OF "TRAFFIC CONTROL AND PROTECTION (SPECIAL), LOCATION 2.", EXCEPT THE FOLLOWING WILL BE PAID FOR SEPARATELY:
 - TEMPORARY CONCRETE BARRIERS (RELOCATE)
 - IMPACT ATTENUATORS
 - ALL SHORT TERM AND TEMPORARY PAVEMENT MARKINGS
 - TEMPORARY RAMPS
 4. UTILIZE STAGE CONSTRUCTION TO MAINTAIN ACCESS TO ALL PRIVATE AND COMMERCIAL ENTRANCES AND PUBLIC ACCESS ROADWAYS DURING STAGE II CONSTRUCTION.
 5. SEE SPECIAL PROVISIONS FOR ADDITIONAL TRAFFIC CONTROL INFORMATION.

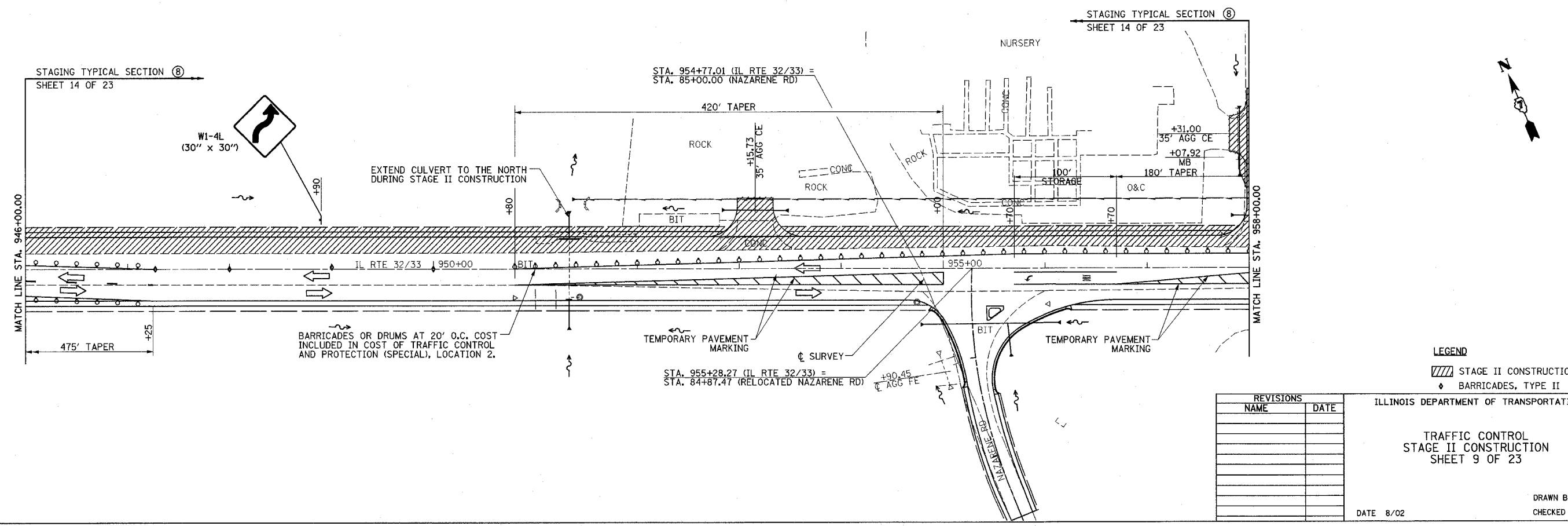
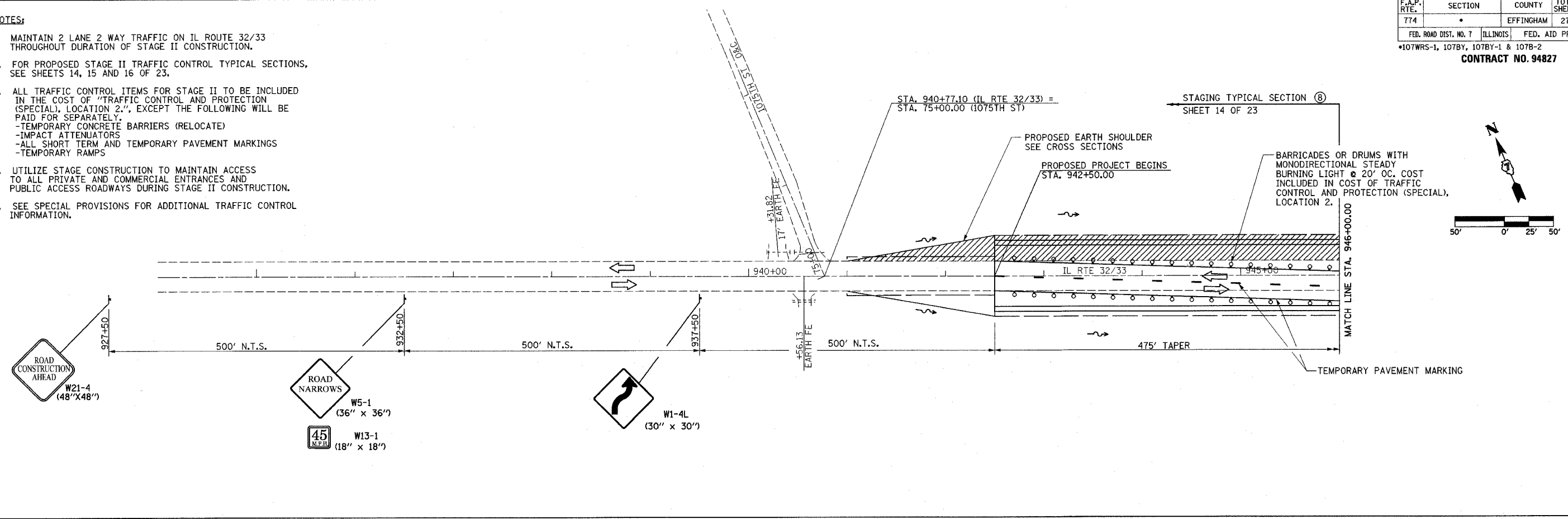

REVISIONS	
NAME	DATE

LEGEND

▨ STAGE II CONSTRUCTION

◆ BARRICADES, TYPE II

ILLINOIS DEPARTMENT OF TRANSPORTATION

TRAFFIC CONTROL
STAGE II CONSTRUCTION
SHEET 9 OF 23

DATE 8/02

DRAWN BY ASB
CHECKED BY RDW