

F.A.P. RTE.	SECTION	COUNTY	TOTAL SHEETS	SHEET NO.
774	.	EFFINGHAM	273	32
FED. ROAD DIST. NO. 7		ILLINOIS	FED. AID PROJECT	
107WRS-1, 107BY, 107BY-1 & 107B-2		CONTRACT NO. 94827		

NOTE: TYPICAL SECTION ① NOT USED

**NOTES:**

- PRE-STAGE I: PRIOR TO MAINLINE WIDENING OPERATIONS, MILL AND PLACE LEVELING BINDER PER THE TYPICALS FROM STA. 942+50.00 TO STA. 40+10.00.
- MAINTAIN 2 LANE 2 WAY TRAFFIC ON IL ROUTE 32/33 THROUGHOUT DURATION OF STAGE 1 CONSTRUCTION.
- FOR PROPOSED STAGE I TRAFFIC CONTROL TYPICAL SECTIONS, SEE SHEETS 6, 7 AND 8 OF 23.
- ALL TRAFFIC CONTROL ITEMS FOR STAGE I TO BE INCLUDED IN THE COST OF "TRAFFIC CONTROL AND PROTECTION (SPECIAL), LOCATION 1.", EXCEPT THE FOLLOWING WILL BE PAID FOR SEPARATELY:
  - TEMPORARY CONCRETE BARRIERS (STATE OWNED)
  - IMPACT ATTENUATORS
  - ALL SHORT TERM AND TEMPORARY PAVEMENT MARKINGS
  - TEMPORARY RAMPS
- UTILIZE STAGE CONSTRUCTION TO MAINTAIN ACCESS TO ALL PRIVATE AND COMMERCIAL ENTRANCES AND PUBLIC ACCESS ROADWAYS DURING STAGE I CONSTRUCTION.
- SEE SPECIAL PROVISIONS FOR ADDITIONAL TRAFFIC CONTROL INFORMATION.

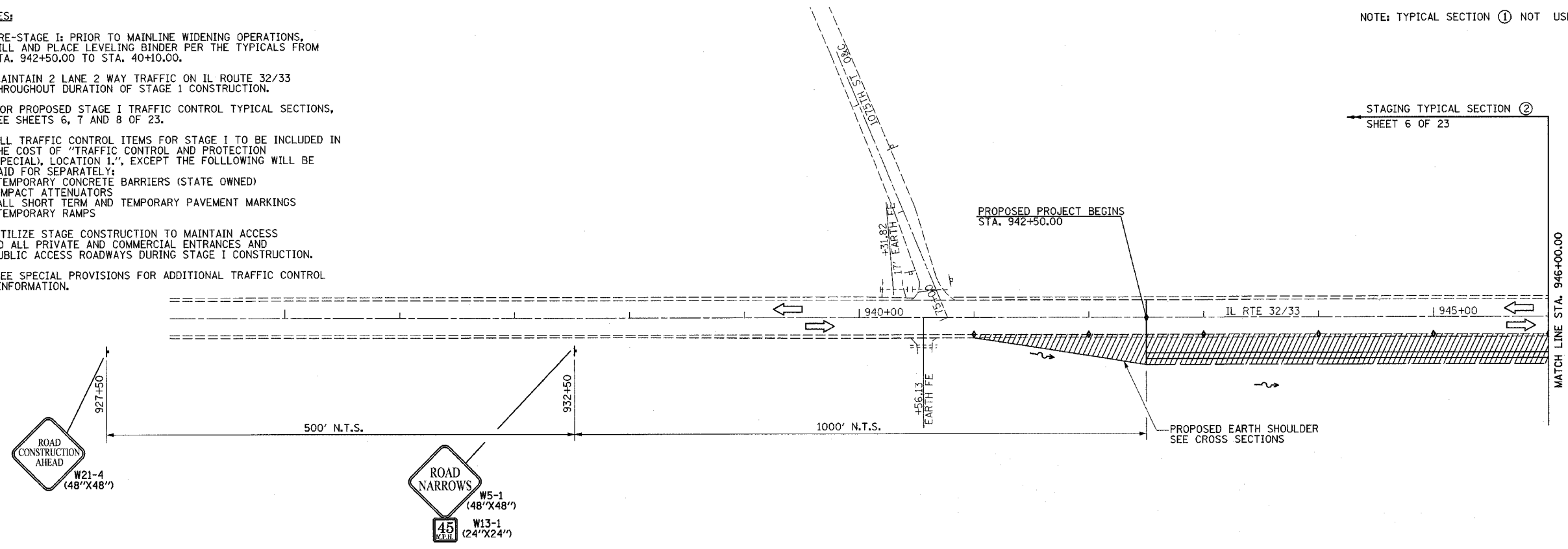

STAGING TYPICAL SECTION ②  
SHEET 6 OF 23

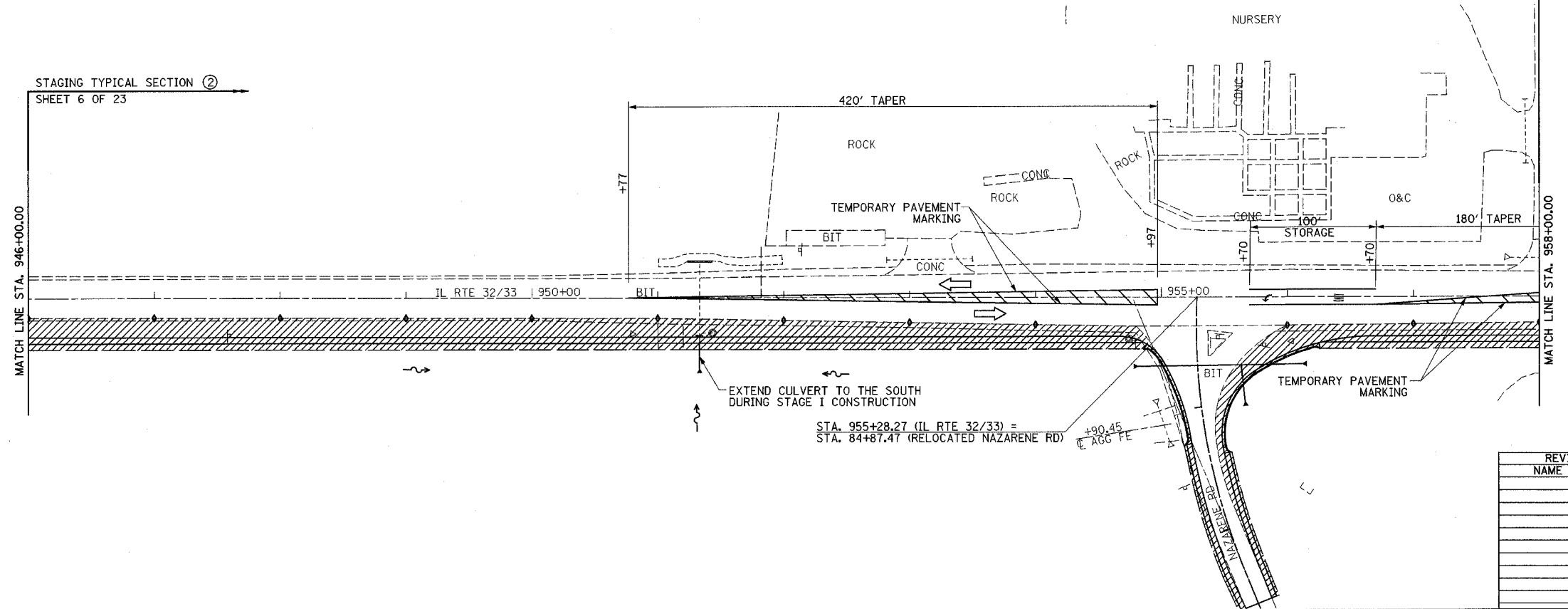

**LEGEND**  
 [Hatched Box] STAGE 1 CONSTRUCTION  
 [Diamond] BARRICADES, TYPE II

REVISIONS	
NAME	DATE

ILLINOIS DEPARTMENT OF TRANSPORTATION  
  
 TRAFFIC CONTROL  
 STAGE I CONSTRUCTION  
 SHEET 1 OF 23  
  
 DATE 8/02  
 DRAWN BY ASB  
 CHECKED BY RDW